

F.A.P. RTE.	SECTION	COUNTY	TOTAL SHEETS	SHEET NO.
808	(3R,3)RS	CHAMPAIGN	47	20
STA.		TO STA.		
FED. ROAD DIST. NO.	ILLINOIS	FED. AID PROJECT		

TIE POINT LAYOUT

P.O.T. #1 STA. 169+08.29

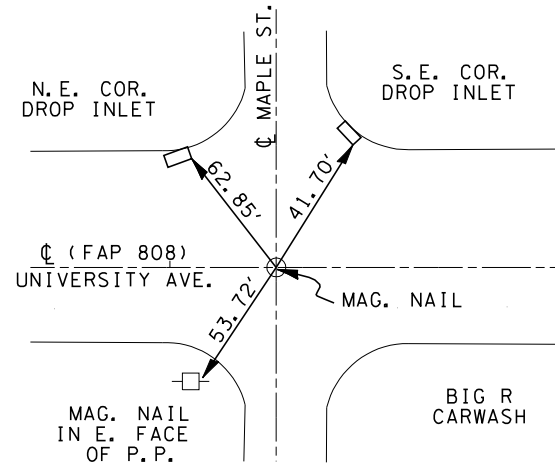

**STA. EQ. #2
12+84.23 AH = 175+08.29 BK**

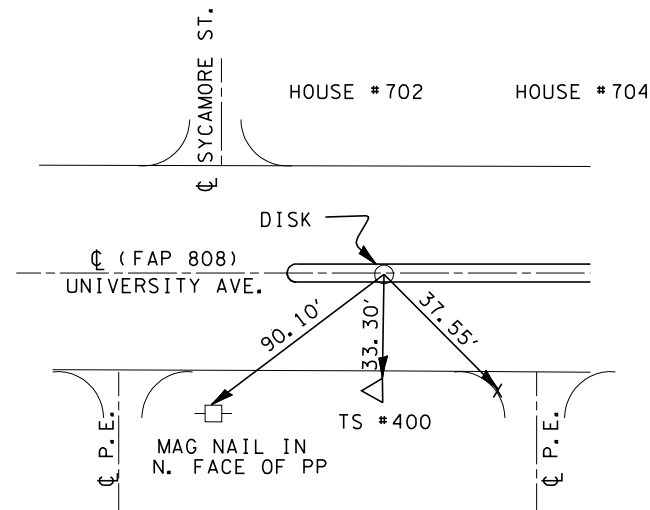

PC #3 STA. 20+00.04

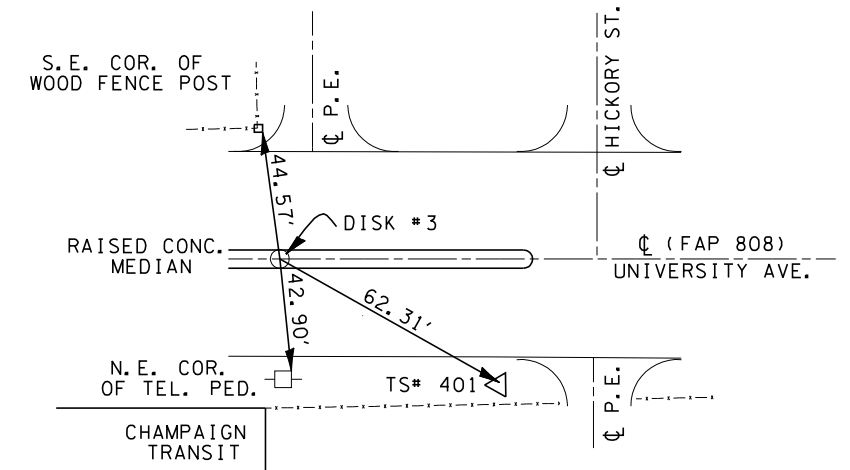

P.I. #14 23+00.04 LT 15.79'

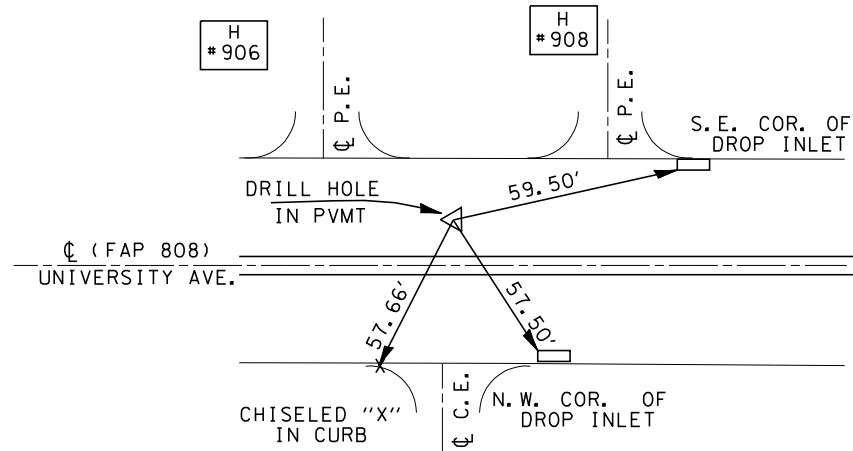

PSM#4 & P.T. #15 STA. 26+00.04

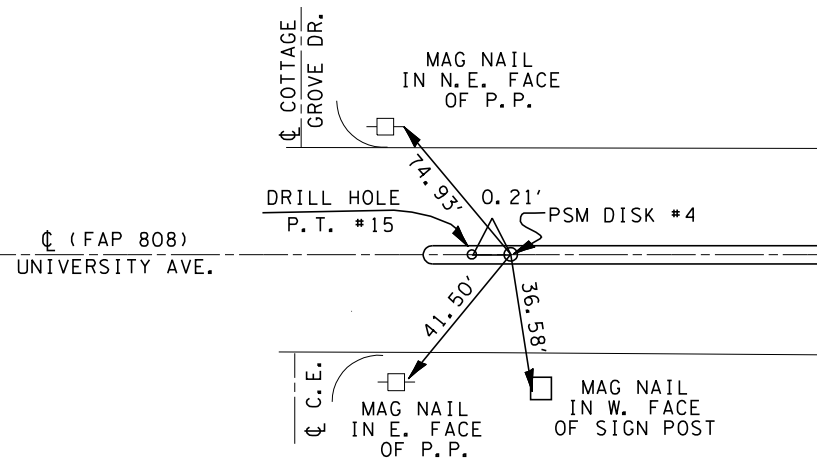

P.C. #5 STA. 29+20.37

