

F.A.P. RTE.	SECTION	COUNTY	TOTAL SHEETS	SHEET NO.
709	104BR-1	CHAMPAIGN	24	9
STA.		TO STA.		
FED. ROAD DIST. NO.	ILLINOIS	FED. AID PROJECT		

SEC 31, TWP 22N, R 7E, 3RD PM

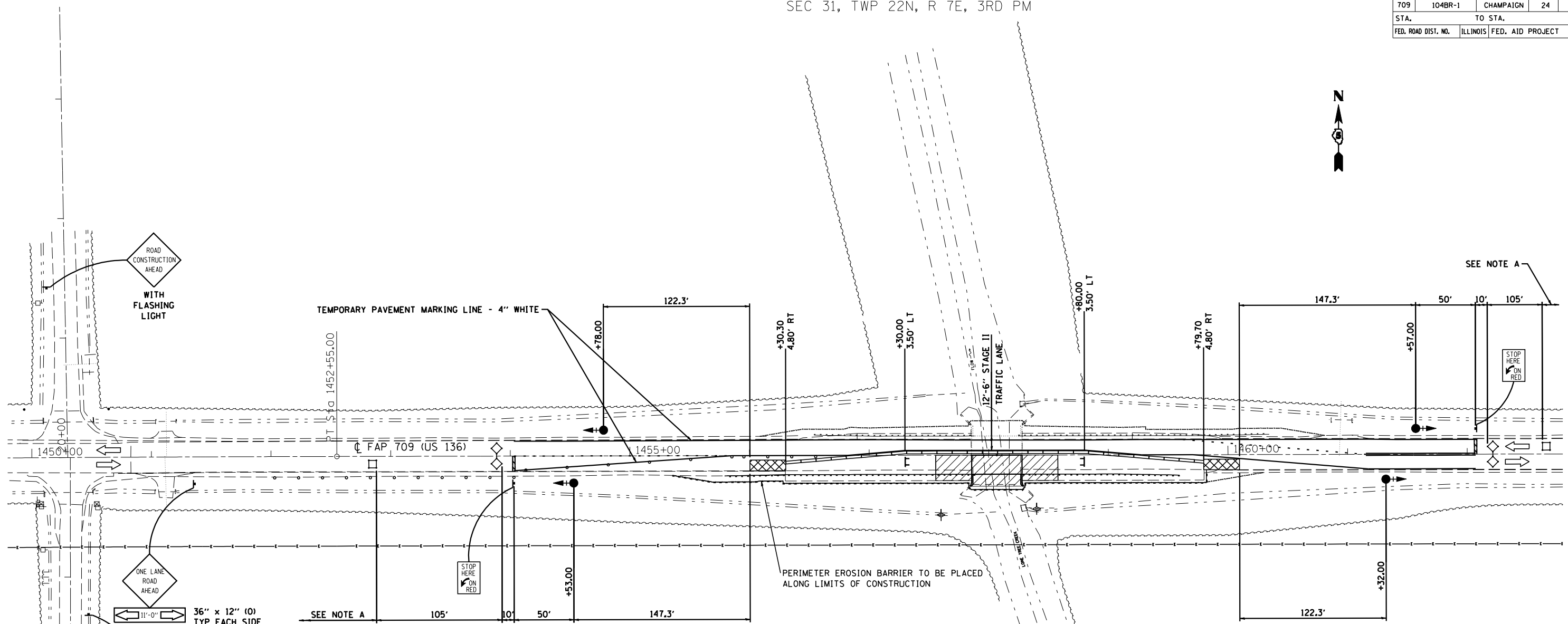

SEC 6, TWP 21N, R 7E, 3RD PM

LEGEND

- WORK AREA
- SIGN (SEE STD 701321)
- DRUM WITH STEADY BURNING LIGHT
- TRAFFIC SIGNAL
- TEMPORARY CONCRETE BARRIER
- IMPACT ATTENUATOR, TEMPORARY (NON-DIRECTIVE)
- TYPE III BARRICADE W/ LIGHTS
- DETECTOR LOOPS
- DIRECTION OF TRAFFIC

NOTE A

REMAINDER OF SIGNING ACCORDING TO STANDARD 701321 EXCEPT PLACE SIGN W20-4(0)-48 EAST OF THE INTERSECTION AS SHOWN, AND AS DIRECTED BY THE ENGINEER

ALL SIGNING, NOT INCLUDING MAX WIDTH SIGNING, AND PAVEMENT MARKING SHOWN OR ACCORDING TO STANDARD 701321 IS INCLUDED IN THE COST OF TRAFFIC CONTROL AND PROTECTION STANDARD 701321

STAGE II SEQUENCE OF CONSTRUCTION

- PLACE MAX WIDTH SIGN AS SHOWN ON SHEET 7 OF 24
- RELOCATE BARRIER WALL AND IMPACT ATTENUATORS AND INSTALL OTHER TRAFFIC CONTROL MEASURES FOR STAGE II AS REQUIRED BY STANDARD 701321
- ONCE TRAFFIC IS DIRECTED TO STAGE II TRAFFIC LANES COMPLETE STAGE II STRUCTURAL WORK, PAVEMENT AND SHOULDER RESURFACING, GUARDRAIL REMOVAL, CONSTRUCT PROPOSED TYPE 6A END SECTION AND SPBGR AND REINSTALL TBT TY 1, SPECIAL (TANGENT)

REVISIONS	
NAME	DATE

ILLINOIS DEPARTMENT OF TRANSPORTATION

STAGE II TRAFFIC CONTROL PLAN
US 136 OVER LONE TREE CREEK
FAP ROUTE 709, SECTION 104BR-1
CHAMPAIGN COUNTY

COOMBE-BLOXDORF P.C.
Engineers / Land Surveyors
Springfield, Illinois
Design Firm License No. 184-002703

SCALE: 1"=40'
DATE: 04/19/06
DRAWN BY CFC
CHECKED BY REG

PLOT DATE = 10/17/2006
 FILE NAME = c:\projects\0505682\submit_10.13.06\dgn\stage-ii-print.dgn
 PLOT SCALE = 84.7855 / IN
 USER NAME = kgjrb