

F.A.P. RTE.	SECTION	COUNTY	TOTAL SHEETS	SHEET NO.
711	(115R)BR	VERMILION	43	11
STA.		TO STA.		
FED. ROAD DIST. NO.	ILLINOIS	FED. AID PROJECT		

SEC 1, T21N, R14W, 2ND PM

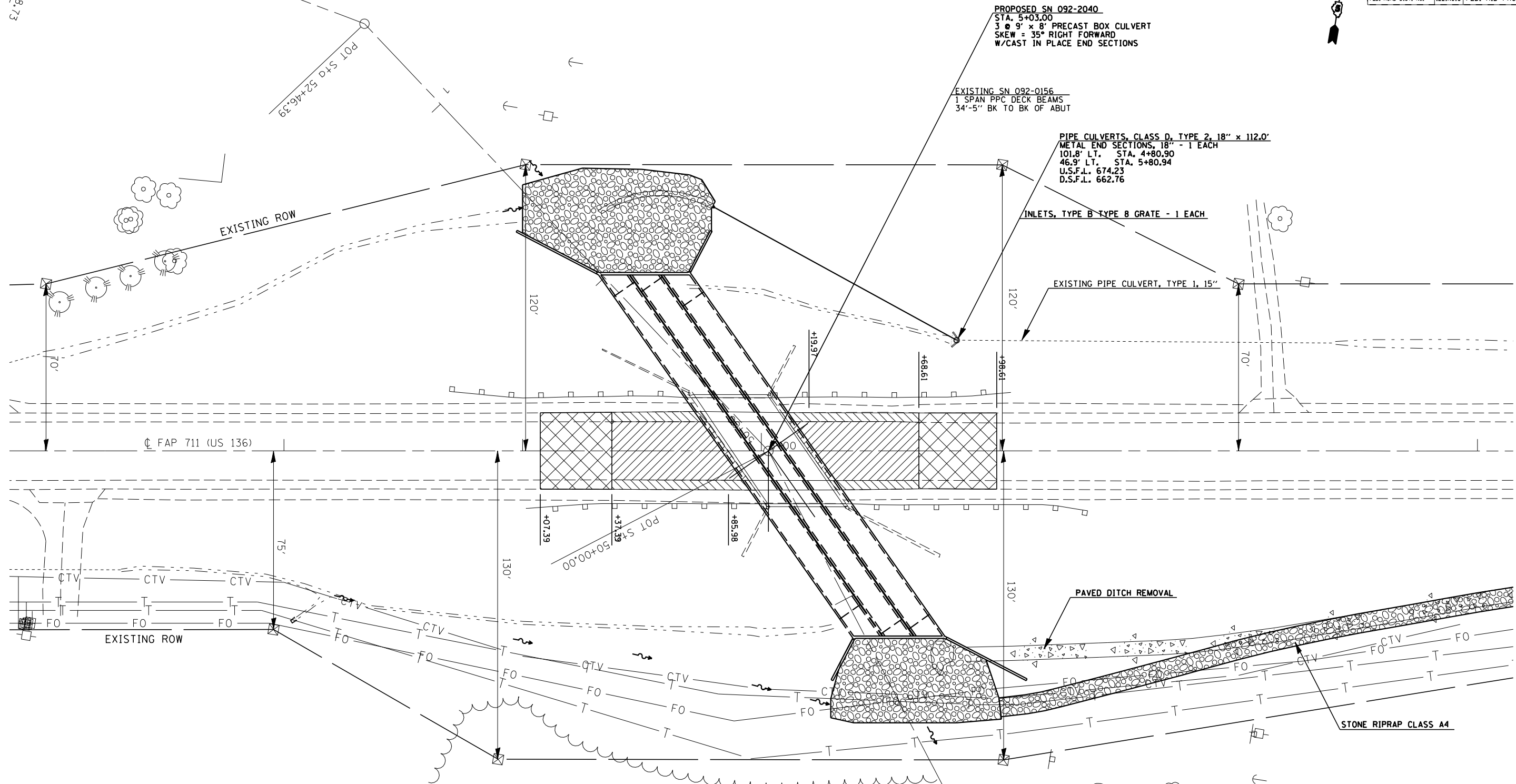

18.73



- APPROACH SLAB REMOVAL
- HOT-MIX ASPHALT SURFACE REMOVAL - BUTT JOINT
- PAVED SHOULDER REMOVAL

BM 2003-1A: CHISELED "□" TOP NW WING @
1ST BRIDGE EAST OF ARMSTRONG ROAD
STA. 4+69.91, 24.52' LT, ELEV. 681.16

REVISIONS	
NAME	DATE

ILLINOIS DEPARTMENT OF TRANSPORTATION

FAP 711 (US 136)
ROADWAY PLAN

SCALE: VERT. _____
HORIZ. _____

DATE _____

DRAWN BY _____
CHECKED BY _____

PLOT DATE = 10/24/2005
 FILE NAME = c:\projects\4595702 (v8)\plan\shere.lgdg
 PLOT SCALE = 42.3525' / IN.
 USER NAME = stults,j