

F.A. RTE.	SECTION	COUNTY	TOTAL SHEETS	SHEET NO.
•	••	MACOUPIN	24	1

• FAS 728 & FAU 8136
 •• D 6 RESURFACING 2007-1

D-96-524-03

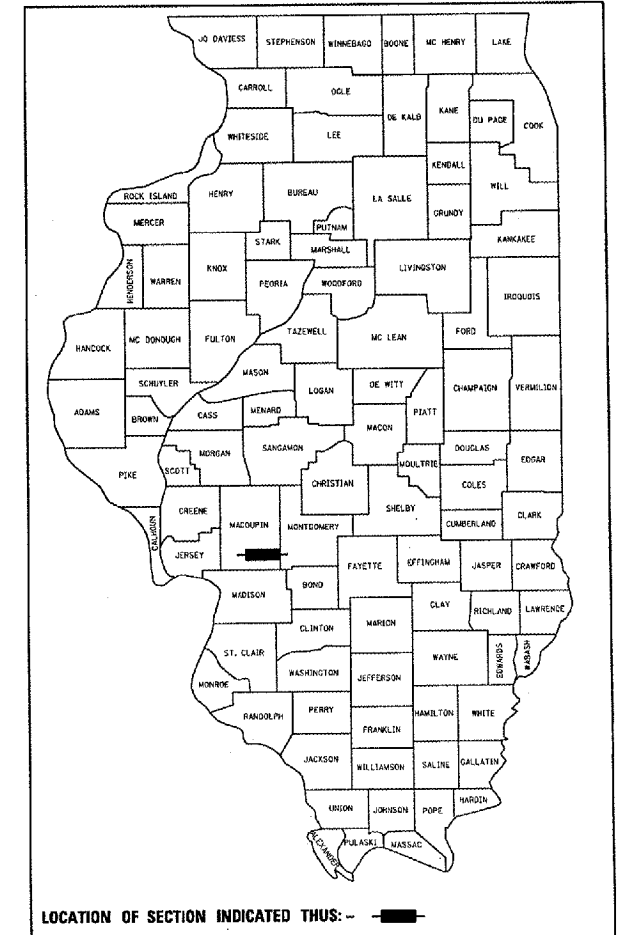

STATE OF ILLINOIS
 DEPARTMENT OF TRANSPORTATION
 DIVISION OF HIGHWAYS

**PROPOSED
 HIGHWAY PLANS**

FAS ROUTE 728 (IL 138)
 & FAU ROUTE 8136 (STAUNTON RD)
 SECTION D 6 RESURFACING 2007-1
 PROJECT: RS-M-0005 (528)
 MACOUPIN COUNTY
 C-96-527-07

INDEX OF SHEETS

- 1 COVER SHEET
- 2 GENERAL NOTES
- 3-4 SUMMARY OF QUANTITIES
- 5-7 TYPICAL SECTIONS
- 8-12 SCHEDULES OF QUANTITIES
- 13-19 PLAN SHEETS
- 20-21 BUTT JOINT DETAIL
- 22-24 SIDEROAD DETAIL

HIGHWAY STANDARDS

- | | |
|-----------|-----------|
| 420001-06 | 701306-01 |
| 442201-02 | 701311-02 |
| 701001-01 | 701501-03 |
| 701006-02 | 702001-06 |
| 701011-01 | 780001-01 |
| 701201-02 | 781001-02 |
| 701301-02 | 000001-04 |

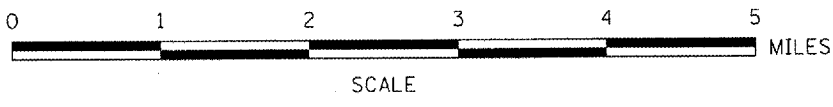
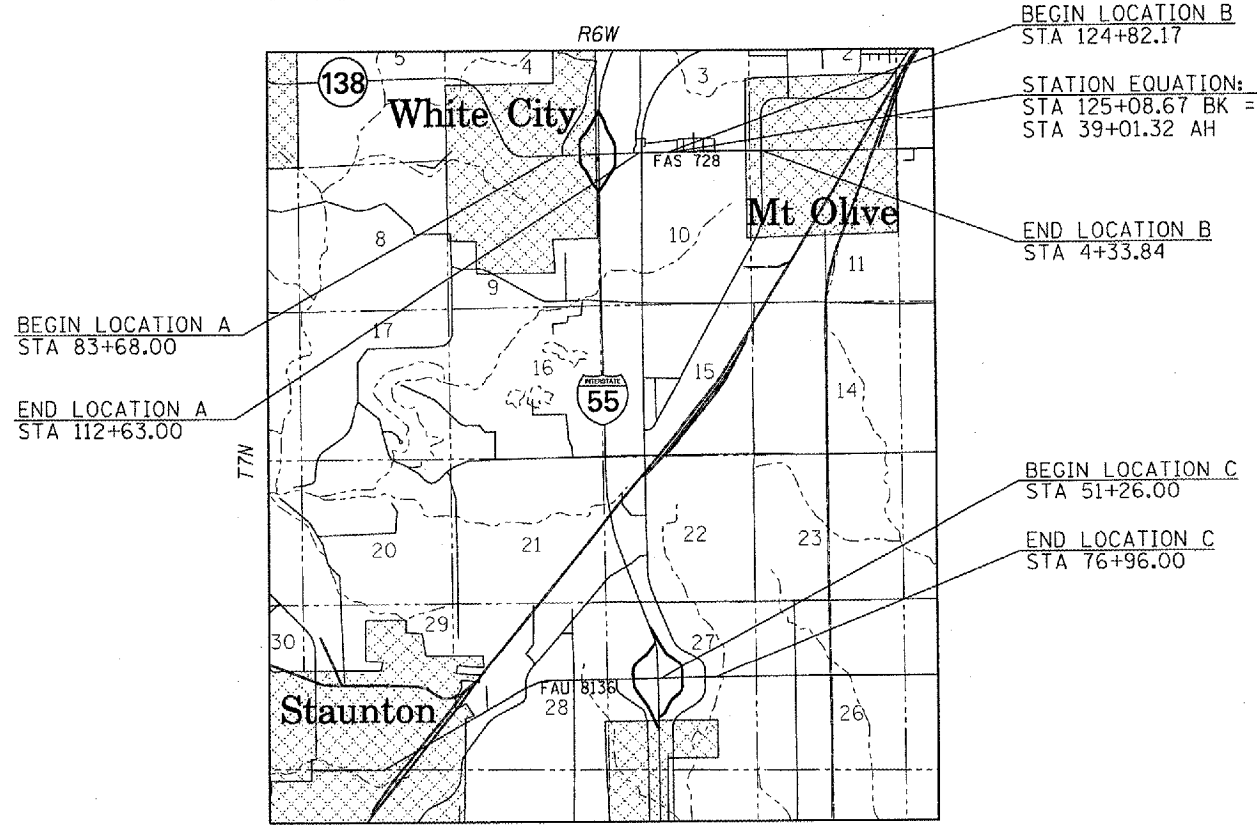

GROSS LENGTH OF PROJECT = 8,958.98 FEET = 1.70 MILES
 NET LENGTH OF PROJECT = 8,684.98 FEET = 1.64 MILES

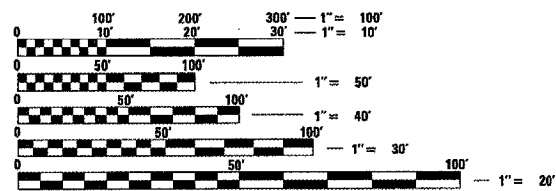

FULL SIZE PLANS HAVE BEEN PREPARED USING STANDARD ENGINEERING SCALES. REDUCED SIZED PLANS WILL NOT CONFORM TO STANDARD SCALES. IN MAKING MEASUREMENTS ON REDUCED PLANS, THE ABOVE SCALES MAY BE USED.

J.U.L.I.E.
 JOINT UTILITY LOCATION INFORMATION FOR EXCAVATION
 1-800-892-0123

CONTRACT NO. 72792

STATE OF ILLINOIS
 DEPARTMENT OF TRANSPORTATION
 DIVISION OF HIGHWAYS

SUBMITTED October 24, 2006

Chas. M. Rood
 DEPUTY DIRECTOR OF HIGHWAYS, REGION ENGINEER

December 8, 2006
Eric E. Harn
 INTERIM ENGINEER OF DESIGN AND ENVIRONMENT

December 8, 2006
Milton R. Sees P.E.
 DIRECTOR OF HIGHWAYS, CHIEF ENGINEER

**PRINTED BY THE AUTHORITY
 OF THE STATE OF ILLINOIS**

PROJECT ENGINEER: SAL MADONIA (217) 782-4761
 SQUAD LEADER: JEFFREY P. MYERS (217) 524-7940