

F.A.P. RTE.	SECTION	COUNTY	TOTAL SHEETS	SHEET NO.
320	24TS-3	LOGAN	6	1

STATE OF ILLINOIS
DEPARTMENT OF TRANSPORTATION
DIVISION OF HIGHWAYS

**PROPOSED
HIGHWAY PLANS**

FAP ROUTE 320 (IL 10)
SECTION 24TS-3
PROJECT: HSIP-0320 (031)
LOGAN COUNTY

FOR INDEX OF SHEETS, SEE SHEET NO. 2

D-96-528-06



C-96-513-07

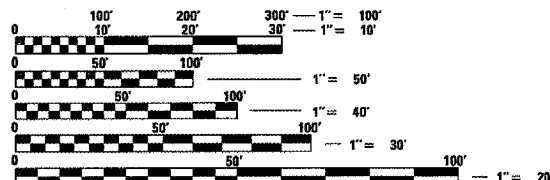
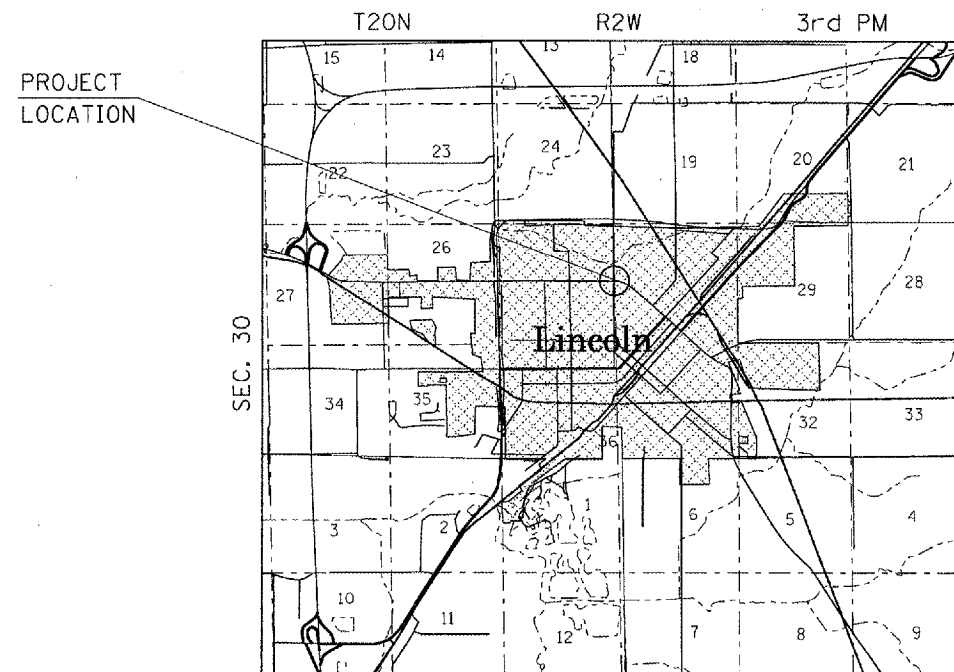

FULL SIZE PLANS HAVE BEEN PREPARED USING STANDARD ENGINEERING SCALES. REDUCED SIZED PLANS WILL NOT CONFORM TO STANDARD SCALES. IN MAKING MEASUREMENTS ON REDUCED PLANS, THE ABOVE SCALES MAY BE USED.

J.U.L.I.E.
JOINT UTILITY LOCATION INFORMATION FOR EXCAVATION
1-800-892-0123

ADT

AVERAGE	11,400		
2005	11,500	PV	93.0%
2006	11,700	SU	3.0%
2026	14,100	MU	4.0%

TOTAL LENGTH OF SECTION = 0.01 MILES

PROJECT ENGINEER: JOHN NEGANGARD 217-782-6990
SQUAD LEADER: MICHAEL HIRSCH 217-782-8693

CONTRACT NO. 72A54

STATE OF ILLINOIS
DEPARTMENT OF TRANSPORTATION
DIVISION OF HIGHWAYS

SUBMITTED *December 8, 2006*

Christina M. Reader
DEPUTY DIRECTOR OF HIGHWAYS, REGION ENGINEER

Eric E. Horn
INTERIM ENGINEER OF DESIGN AND ENVIRONMENT

December 8, 2006
Milton R. Sees P.E.
DIRECTOR OF HIGHWAYS, CHIEF ENGINEER

**PRINTED BY THE AUTHORITY
OF THE STATE OF ILLINOIS**