

F.A.P. RTE.	SECTION	COUNTY	TOTAL SHEETS	SHEET NO.
320	24 TS-3	LOGAN	6	4
STA.		TO STA.		
FED. ROAD DIST. NO.	ILLINOIS	FED. AID PROJECT		

TRAFFIC SIGNAL QUANTITIES

LOCATION: WOODLAWN & UNION

QUANTITY	UNIT	ITEM
1	EACH	MAINTENANCE OF EXISTING TRAFFIC SIGNAL INSTALLATION
32.0	FOOT	ELECTRIC CABLE IN CONDUIT, SIGNAL, NO. 14 7/C
2	EACH	TRAFFIC SIGNAL POST, ALUMINUM, 14 FT.
2	EACH	TRAFFIC SIGNAL POST, ALUMINUM, 15 FT.
11	EACH	TRAFFIC SIGNAL BACKPLATE
8	EACH	PEDESTRIAN PUSHBUTTON
1	EACH	REMOVE EXISTING TRAFFIC SIGNAL EQUIPMENT
389.5	FOOT	ELECTRIC CABLE IN CONDUIT, GROUND, #6 1/C (GREEN)
4	EACH	SIGNAL HEAD, POLYCARBONATE, LED, 1-FACE, 3-SECTION, BRACKET MOUNTED
4	EACH	SIGNAL HEAD, POLYCARBONATE, LED, 1-FACE, 3-SECTION, MAST ARM MOUNTED
2	EACH	SIGNAL HEAD, POLYCARBONATE, LED, 1-FACE, 4-SECTION, MAST ARM MOUNTED
2	EACH	SIGNAL HEAD, POLYCARBONATE, LED, 2-FACE, 3-SECTION, BRACKET MOUNTED
2	EACH	SIGNAL HEAD, POLYCARBONATE, LED, 2-FACE, 1-3 SECTION, 1-4 SECTION BRACKET MOUNTED
4	EACH	PEDESTRIAN SIGNAL HEAD, POLYCARBONATE, LED, 1-FACE, BRACKET MOUNTED
2	EACH	PEDESTRIAN SIGNAL HEAD, POLYCARBONATE, LED, 2-FACE, BRACKET MOUNTED

REMOVE EXISTING TRAFFIC SIGNAL EQUIPMENT SHALL CONSIST OF:

4	EACH	TRAFFIC SIGNAL POSTS
12	EACH	SIGNAL HEAD ASSEMBLY
8	EACH	PEDESTRIAN SIGNAL HEAD
8	EACH	PEDESTRIAN PUSHBUTTON

REMOVED SIGNAL EQUIPMENT SHALL BE TAKEN TO A LOCATION TO BE DETERMINED BY THE CITY OF LINCOLN. CONTACT TRACY JACKSON: 732-4655

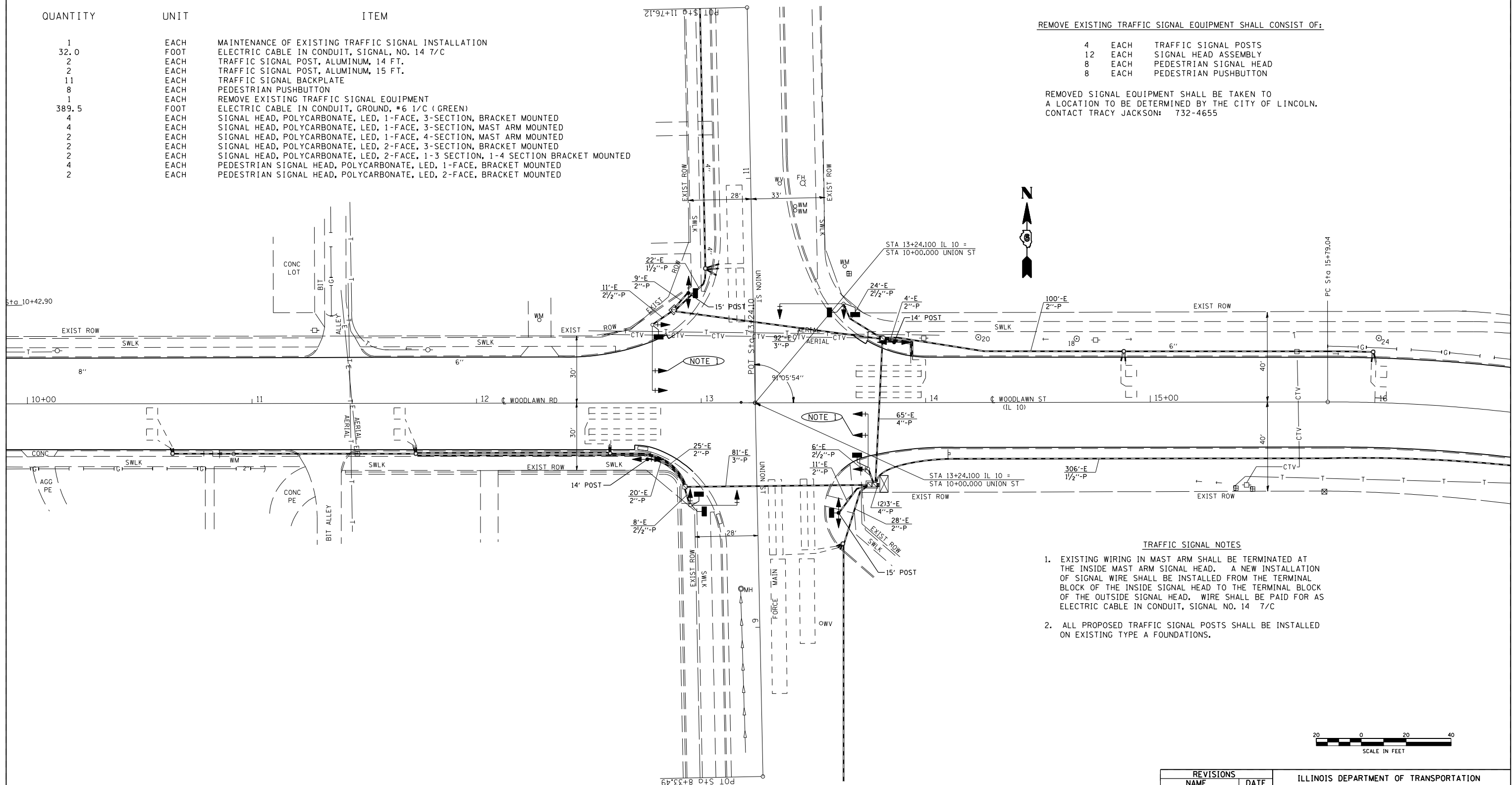

TRAFFIC SIGNAL NOTES

- EXISTING WIRING IN MAST ARM SHALL BE TERMINATED AT THE INSIDE MAST ARM SIGNAL HEAD. A NEW INSTALLATION OF SIGNAL WIRE SHALL BE INSTALLED FROM THE TERMINAL BLOCK OF THE INSIDE SIGNAL HEAD TO THE TERMINAL BLOCK OF THE OUTSIDE SIGNAL HEAD. WIRE SHALL BE PAID FOR AS ELECTRIC CABLE IN CONDUIT, SIGNAL NO. 14 7/C
- ALL PROPOSED TRAFFIC SIGNAL POSTS SHALL BE INSTALLED ON EXISTING TYPE A FOUNDATIONS.

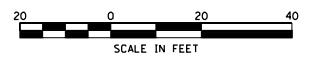

REVISIONS	
NAME	DATE

ILLINOIS DEPARTMENT OF TRANSPORTATION
PROPOSED TRAFFIC SIGNALS
 FAP 320 (ILLINOIS 10)
 SECTION 24 TS-3

SCALE: VERT. _____
 HORIZ. _____
 DATE: SEPT '06
 DRAWN BY: KDA
 CHECKED BY: _____