

F.A.P. RTE.	SECTION	COUNTY	TOTAL SHEETS	SHEET NO.
320	24TS-3	LOGAN	6	1

STATE OF ILLINOIS  
DEPARTMENT OF TRANSPORTATION  
DIVISION OF HIGHWAYS

**PROPOSED  
HIGHWAY PLANS**

FAP ROUTE 320 (IL 10)  
SECTION 24TS-3  
PROJECT: HSIP-0320 (031)  
LOGAN COUNTY

D-96-528-06

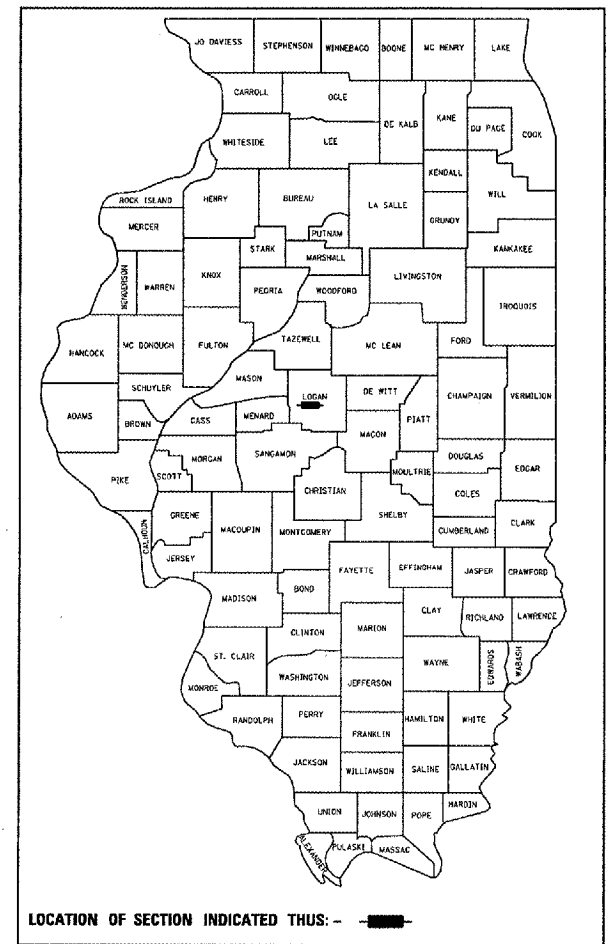

FOR INDEX OF SHEETS, SEE SHEET NO. 2

C-96-513-07

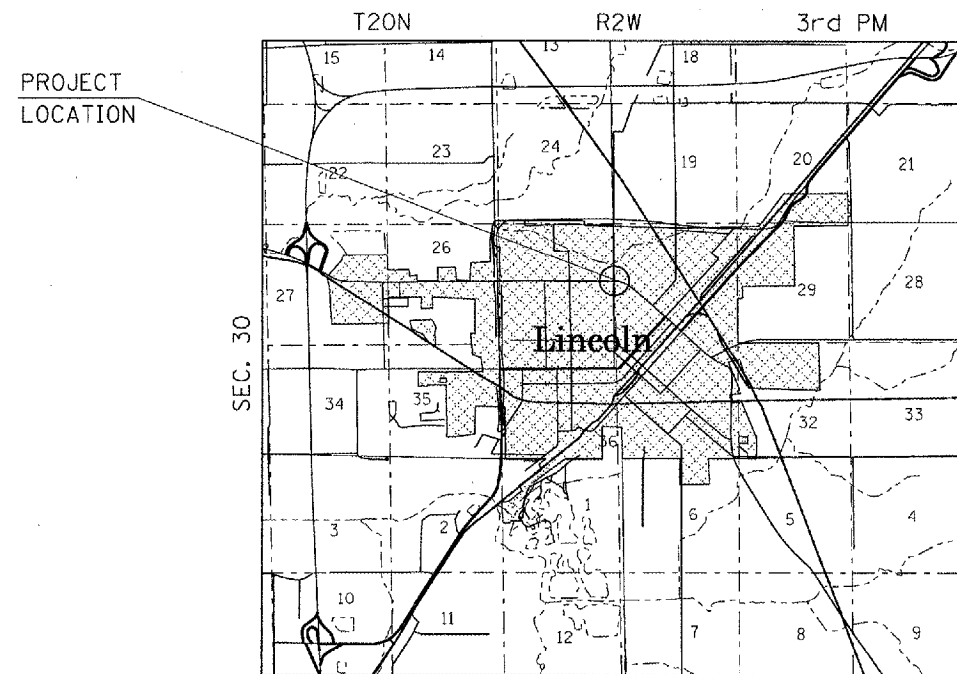

ADT

AVERAGE	11,400		
2005	11,500	PV	93.0%
2006	11,700	SU	3.0%
2026	14,100	MU	4.0%

TOTAL LENGTH OF SECTION = 0.01 MILES

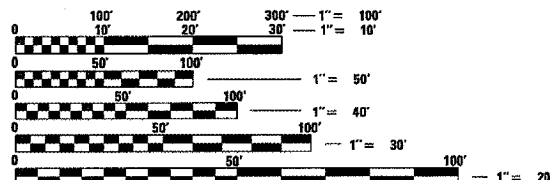

FULL SIZE PLANS HAVE BEEN PREPARED USING STANDARD ENGINEERING SCALES. REDUCED SIZED PLANS WILL NOT CONFORM TO STANDARD SCALES. IN MAKING MEASUREMENTS ON REDUCED PLANS, THE ABOVE SCALES MAY BE USED.

J.U.L.I.E.  
JOINT UTILITY LOCATION INFORMATION FOR EXCAVATION  
1-800-892-0123

CONTRACT NO. 72A54

PROJECT ENGINEER: JOHN NEGANGARD 217-782-6990  
SQUAD LEADER: MICHAEL HIRSCH 217-782-8693

STATE OF ILLINOIS  
DEPARTMENT OF TRANSPORTATION  
DIVISION OF HIGHWAYS

SUBMITTED *December 8, 2006*

*Christina M. Reader*  
DEPUTY DIRECTOR OF HIGHWAYS, REGION ENGINEER

*Eric E. Horn*  
INTERIM ENGINEER OF DESIGN AND ENVIRONMENT

*December 8, 2006*  
*Milton R. Sees P.E.*  
DIRECTOR OF HIGHWAYS, CHIEF ENGINEER

**PRINTED BY THE AUTHORITY  
OF THE STATE OF ILLINOIS**

F.A.P. RTE.	SECTION	COUNTY	TOTAL SHEETS	SHEET NO.
320	24TS-3	LOGAN	6	2
STA.		TO STA.		
FED. ROAD DIST. NO.	ILLINOIS	FED. AID PROJECT		

INDEX OF SHEETS

- 1. COVER SHEET
- 2. INDEX OF SHEETS
- 3. SUMMARY OF QUANTITIES
- 4. PROPOSED TRAFFIC SIGNALS
- 5. PROPOSED CABLE DIAGRAM
- 6. LEGEND FOR TRAFFIC SIGNAL DETAILS

COMMITMENTS

COMMITMENTS ARE NOT TO BE ALTERED WITHOUT THE WRITTEN APPROVAL OF ALL PARTIES TO WHICH THE COMMITMENT WAS MADE.

NO COMMITMENTS

HIGHWAY STANDARDS

- 000001-04
- 701801-03
- 702001-00
- 873001-01
- 701701-04

GENERAL NOTES

WHERE SECTION OR SUBSECTION MONUMENTS ARE ENCOUNTERED, THE ENGINEER SHALL BE NOTIFIED BEFORE SUCH MONUMENTS ARE REMOVED. THE CONTRACTOR SHALL PROTECT AND CAREFULLY PRESERVE ALL PROPERTY MARKS, MONUMENTS, AND PERMANENT SURVEY MARKERS UNTIL THE OWNER, AND AUTHORIZED SURVEYOR OR AGENT HAS WITNESSES OR OTHERWISE REFERENCED THEIR LOCATION.

ANY REFERENCE TO A STANDARD IN THE PLANS SHALL BE INTERPRETED TO MEAN THE EDITION, AS INDICATED BY THE SUB-NUMBER LISTED IN THE INDEX OF SHEETS, OR THE COPY OF THE STANDARD INCLUDED IN THE PLANS.

THE LOCATIONS OF EXISTING WATER MAINS, GAS MAINS, SEWERS, ELECTRIC POWER LINES, TELEPHONE LINES AND OTHER UTILITIES AS SHOWN ON THE PLANS ARE BASED ON THE BEST INFORMATION AVAILABLE, BUT THEY ARE NOT GUARANTEED. ALL UTILITY LOCATIONS SHOWN ARE SUPPLIED BY THE UTILITY COMPANIES. IT IS THE CONTRACTOR'S RESPONSIBILITY TO ASCERTAIN THEIR EXACT LOCATION FROM THE UTILITY COMPANIES AND BY FIELD INSPECTION.

ACCESS MUST BE MAINTAINED TO ALL EXISTING PROPERTIES DURING CONSTRUCTION PER ARTICLE 107.09 UNLESS ARRANGEMENTS ARE MADE IN WRITING BY THE CONTRACTOR WITH THE PROPERTY OWNERS WITH A COPY TO THE ENGINEER FOR SHORT-TERM CLOSURES.

THE NOMINAL THICKNESS FOR BASE AND SURFACE COURSES ARE SHOWN ON THE TYPICAL SECTIONS, STANDARDS, SCHEDULES, OR SPECIAL DETAILS. THE CONSTRUCTED THICKNESS OF THE ABOVE ITEM SHALL NOT BE LESS THAN 90 PERCENT OF OF THE NOMINAL THICKNESS AT ANY LOCATION.

THE THICKNESS OF THE BITUMINOUS MIXTURE SHOWN ON THE PLANS IS THE NOMINAL THICKNESS. DEVIATIONS FROM THE NOMINAL THICKNESS WILL BE PERMITTED WHEN SUCH DEVIATION OCCUR DUE TO IRREGULARITIES IN THE EXISTING SURFACE OR BASE ON WHICH THE BITUMINOUS MIXTURE IS PLACED.

ALL ELEVATIONS SHOWN ON PLANS ARE ESTABLISHED FROM U.S.G.S MEAN SEAL LEVEL DATUM.

CONTINUOUS PAVING OPERATIONS ON THE MAIN ROADWAY SHALL BE MAINTAINED AT ALL TIMES DURING THE CONSTRUCTION OF THE BITUMINOUS SURFACE. NO INTERRUPTIONS FOR SIDE ROADS, ENTRANCE, TURN LANES, ETC. WILL BE ALLOWED.

EXAMINED <u>Oct 24</u> 20 <u>04</u>
<i>WR Jones</i>
PROGRAM IMPLEMENTATION ENGINEER
EXAMINED <u>October 24</u> 20 <u>06</u>
<i>William E. Masters</i>
PROGRAM DEVELOPMENT ENGINEER

DISTRICT SIX	
EXAMINED <u>October 24</u> 20 <u>06</u>	
<i>Paul J. Hunt</i>	
OPERATIONS ENGINEER	

REVISIONS		ILLINOIS DEPARTMENT OF TRANSPORTATION INDEX OF SHEETS, STANDARDS LIST, COMMITMENTS, & GENERAL NOTES
NAME	DATE	
		SCALE: VERT. HORIZ. DATE 10-24-06
DRAWN BY TMJ		CHECKED BY VTY
DATE 10-24-06		

F.A.P. RTE.	SECTION	COUNTY	TOTAL SHEETS	SHEET NO.
320	24TS-3	LOGAN	6	3
STA.		TO STA.		
FED. ROAD DIST. NO.		ILLINOIS FED. AID PROJECT		

**URBAN**

LOCATION  
IL 10  
AT UNION ST.  
IN LINCOLN  
90% FEDERAL  
5% STATE  
5% CITY OF  
LINCOLN  
Y031-IF

Code No.	Item	Unit	Total	
67100100	MOBILIZATION	L SUM	1	1
70102635	TRAFFIC CONTROL AND PROTECTION, STANDARD 701701	L SUM	1	1
85000200	MAINTENANCE OF EXISTING TRAFFIC SIGNAL INSTALLATION	EACH	1	1
87301255	ELECTRIC CABLE IN CONDUIT, SIGNAL, NO. 14 7/C	FOOT	32	32
87502680	TRAFFIC SIGNAL POST, ALUMINUM, 14 FT.	EACH	2	2
87502690	TRAFFIC SIGNAL POST, ALUMINUM, 15 FT.	EACH	2	2
88200100	TRAFFIC SIGNAL BACKPLATE	EACH	11	11
88800100	PEDESTRIAN PUSH-BUTTON	EACH	8	8
89502375	REMOVE EXISTING TRAFFIC SIGNAL EQUIPMENT	EACH	1	1
<b>X0323153</b>	ELECTRIC CABLE IN CONDUIT, GROUND, #6 1/C (GREEN)	FOOT	390	390
88040070	SIGNAL HEAD, POLYCARBONATE, LED, 1-FACE, 3-SECTION, BRACKET MOUNTED	EACH	4	4
88040090	SIGNAL HEAD, POLYCARBONATE, LED, 1-FACE, 3-SECTION, MAST ARM MOUNTED	EACH	4	4
88040120	SIGNAL HEAD, POLYCARBONATE, LED, 1-FACE, 4-SECTION, MAST ARM MOUNTED	EACH	2	2
88040230	SIGNAL HEAD, POLYCARBONATE, LED, 2-FACE, 3-SECTION, BRACKET MOUNTED	EACH	2	2
88040250	SIGNAL HEAD, POLYCARBONATE, LED, 2-FACE, 1-3 SECTION, 1-4 SECTION BRACKET MOUNTED	EACH	2	2
88102810	PEDESTRIAN SIGNAL HEAD, POLYCARBONATE, LED, 1-FACE, BRACKET MOUNTED	EACH	4	4
88102830	PEDESTRIAN SIGNAL HEAD, POLYCARBONATE, LED, 2-FACE, BRACKET MOUNTED	EACH	2	2

PLT DATE : 10/25/2006  
 FILE NAME : J:\652065\at\urbaenquandgn  
 PLOT SCALE : 42.3521 / IN  
 USER NAME : leahtlwr1

REVISIONS	
NAME	DATE

ILLINOIS DEPARTMENT OF TRANSPORTATION  
**INDEX OF SHEETS, STANDARDS LIST,  
 COMMITMENTS, & GENERAL NOTES**

SCALE: VERT.  
 HORIZ.  
 DATE 10-24-06

DRAWN BY: TMJ  
 CHECKED BY: VTY

F.A.P. RTE.	SECTION	COUNTY	TOTAL SHEETS	SHEET NO.
320	24 TS-3	LOGAN	6	4
STA.		TO STA.		
FED. ROAD DIST. NO.	ILLINOIS	FED. AID PROJECT		

TRAFFIC SIGNAL QUANTITIES

LOCATION: WOODLAWN & UNION

QUANTITY	UNIT	ITEM
1	EACH	MAINTENANCE OF EXISTING TRAFFIC SIGNAL INSTALLATION
32.0	FOOT	ELECTRIC CABLE IN CONDUIT, SIGNAL, NO. 14 7/C
2	EACH	TRAFFIC SIGNAL POST, ALUMINUM, 14 FT.
2	EACH	TRAFFIC SIGNAL POST, ALUMINUM, 15 FT.
11	EACH	TRAFFIC SIGNAL BACKPLATE
8	EACH	PEDESTRIAN PUSHBUTTON
1	EACH	REMOVE EXISTING TRAFFIC SIGNAL EQUIPMENT
389.5	FOOT	ELECTRIC CABLE IN CONDUIT, GROUND, #6 1/C (GREEN)
4	EACH	SIGNAL HEAD, POLYCARBONATE, LED, 1-FACE, 3-SECTION, BRACKET MOUNTED
4	EACH	SIGNAL HEAD, POLYCARBONATE, LED, 1-FACE, 3-SECTION, MAST ARM MOUNTED
2	EACH	SIGNAL HEAD, POLYCARBONATE, LED, 1-FACE, 4-SECTION, MAST ARM MOUNTED
2	EACH	SIGNAL HEAD, POLYCARBONATE, LED, 2-FACE, 3-SECTION, BRACKET MOUNTED
2	EACH	SIGNAL HEAD, POLYCARBONATE, LED, 2-FACE, 1-3 SECTION, 1-4 SECTION BRACKET MOUNTED
4	EACH	PEDESTRIAN SIGNAL HEAD, POLYCARBONATE, LED, 1-FACE, BRACKET MOUNTED
2	EACH	PEDESTRIAN SIGNAL HEAD, POLYCARBONATE, LED, 2-FACE, BRACKET MOUNTED

REMOVE EXISTING TRAFFIC SIGNAL EQUIPMENT SHALL CONSIST OF:

4	EACH	TRAFFIC SIGNAL POSTS
12	EACH	SIGNAL HEAD ASSEMBLY
8	EACH	PEDESTRIAN SIGNAL HEAD
8	EACH	PEDESTRIAN PUSHBUTTON

REMOVED SIGNAL EQUIPMENT SHALL BE TAKEN TO A LOCATION TO BE DETERMINED BY THE CITY OF LINCOLN. CONTACT TRACY JACKSON: 732-4655

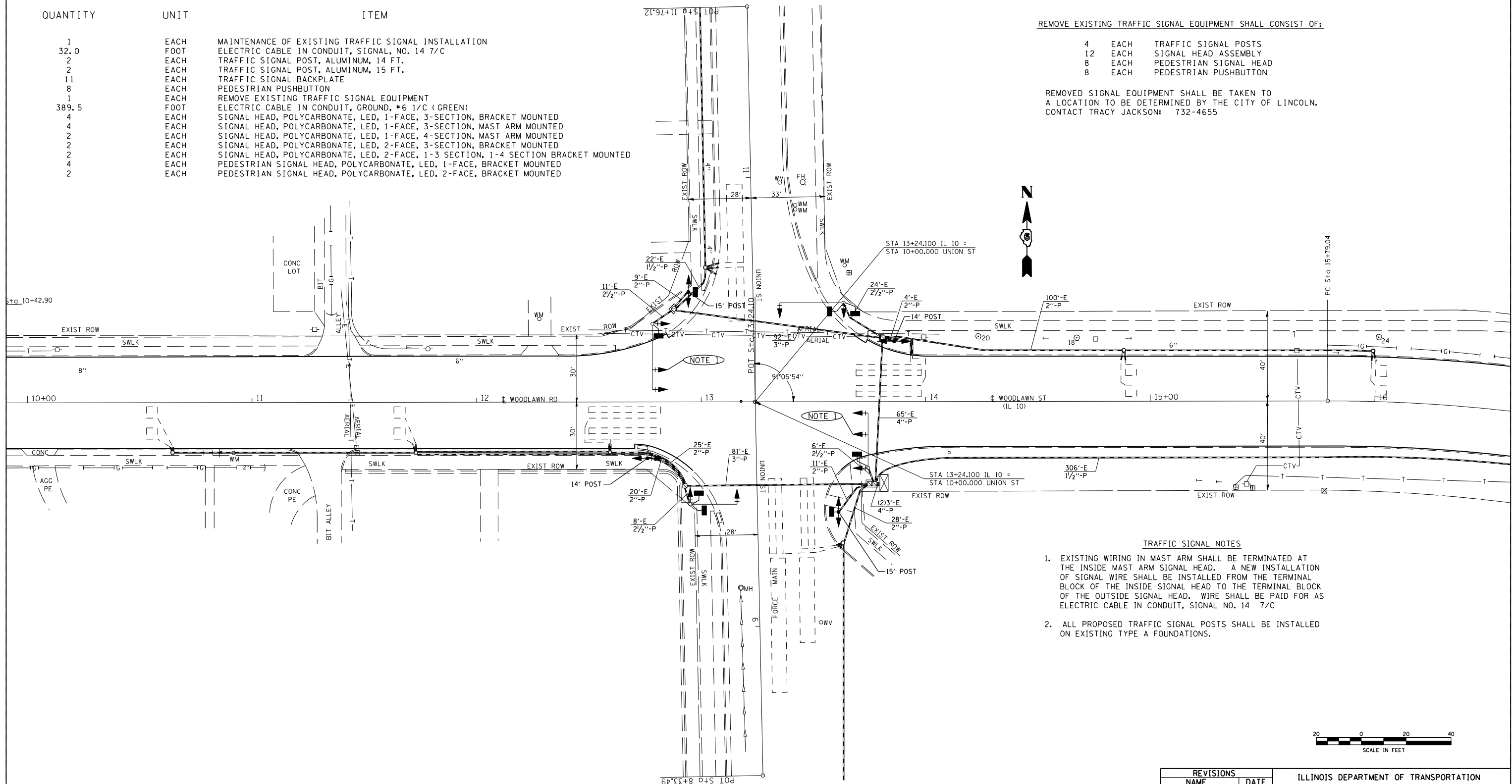

TRAFFIC SIGNAL NOTES

- EXISTING WIRING IN MAST ARM SHALL BE TERMINATED AT THE INSIDE MAST ARM SIGNAL HEAD. A NEW INSTALLATION OF SIGNAL WIRE SHALL BE INSTALLED FROM THE TERMINAL BLOCK OF THE INSIDE SIGNAL HEAD TO THE TERMINAL BLOCK OF THE OUTSIDE SIGNAL HEAD. WIRE SHALL BE PAID FOR AS ELECTRIC CABLE IN CONDUIT, SIGNAL NO. 14 7/C
- ALL PROPOSED TRAFFIC SIGNAL POSTS SHALL BE INSTALLED ON EXISTING TYPE A FOUNDATIONS.



REVISIONS	
NAME	DATE

ILLINOIS DEPARTMENT OF TRANSPORTATION  
**PROPOSED TRAFFIC SIGNALS**  
 FAP 320 (ILLINOIS 10)  
 SECTION 24 TS-3  
 SCALE: VERT. \_\_\_\_\_  
 HORIZ. \_\_\_\_\_  
 DATE: SEPT '06  
 DRAWN BY: KDA  
 CHECKED BY: \_\_\_\_\_

PLOT DATE = 10/25/2006  
 FILE NAME = c:\projects\652806\ts\_sheets.dgn  
 PLOT SCALE = 42.3525 / IN.  
 USER NAME = laughlin-1

F.A.P. RTE.	SECTION	COUNTY	TOTAL SHEETS	SHEET NO.
320	24 TS-3	LOGAN	6	5
STA.		TO STA.		
FED. ROAD DIST. NO.	ILLINOIS	FED. AID PROJECT		

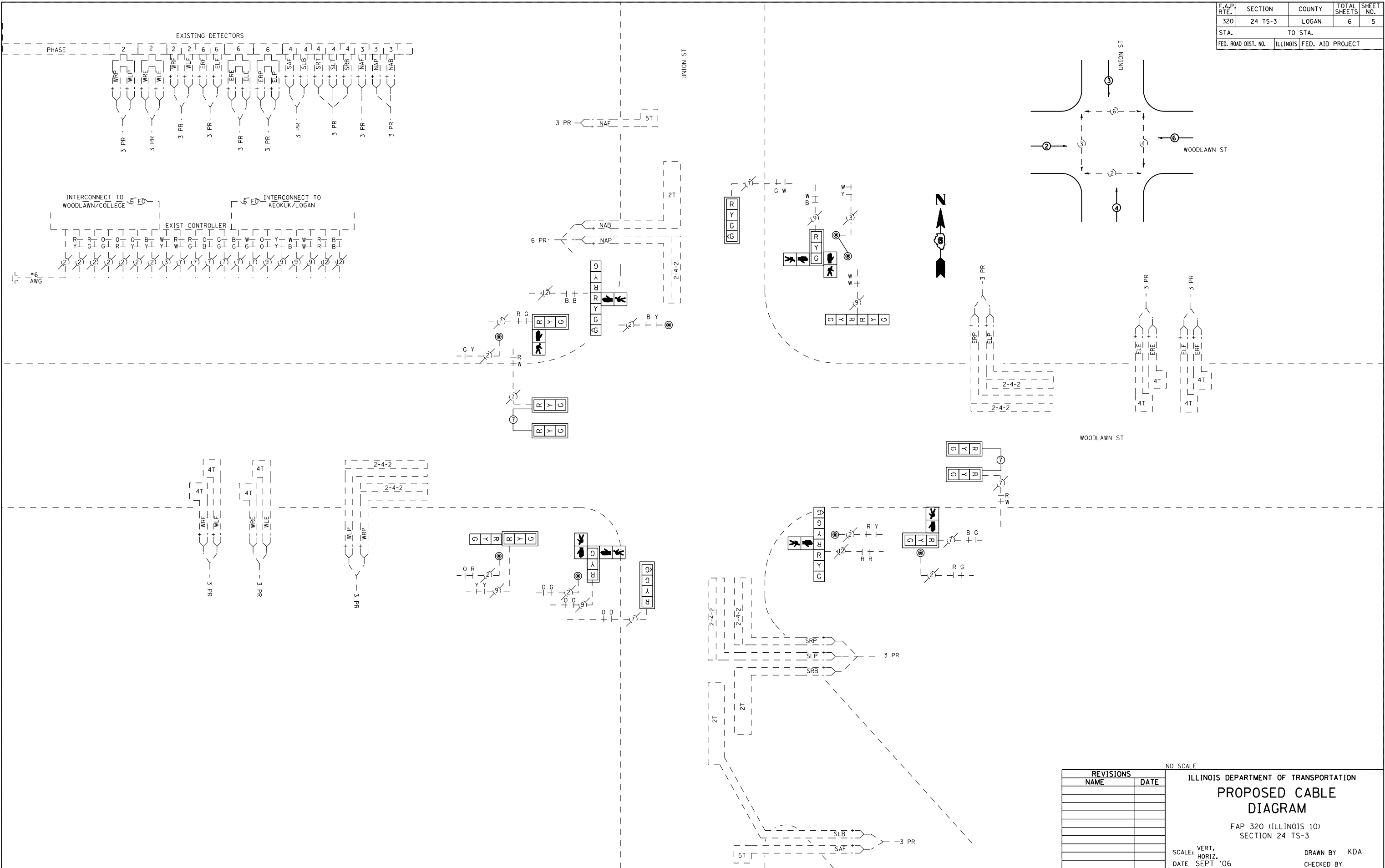

PLOT DATE = 10/25/2006  
 FILE NAME = c:\projects\652806\ts\_sheets.dgn  
 PLOT SCALE = 4.23524 / IN.  
 USER NAME = laughlin-1

REVISIONS	
NAME	DATE

NO SCALE  
 ILLINOIS DEPARTMENT OF TRANSPORTATION  
**PROPOSED CABLE DIAGRAM**  
 FAP 320 (ILLINOIS 10)  
 SECTION 24 TS-3  
 SCALE: VERT. \_\_\_\_\_  
 HORIZ. \_\_\_\_\_  
 DATE: SEPT '06  
 DRAWN BY: KDA  
 CHECKED BY: \_\_\_\_\_

F.A.P. RTE.	SECTION	COUNTY	TOTAL SHEETS	SHEET NO.
320	24 TS-3	LOGAN	6	6
STA.		TO STA.		
FED. ROAD DIST. NO.	ILLINOIS	FED. AID PROJECT		

**TRAFFIC SIGNAL PLAN LEGEND**

EXISTING	PROPOSED	DESCRIPTION
		SIGNAL HEAD
		SIGNAL HEAD WITH BACKPLATE
		TEMPORARY SIGNAL HEAD
		PEDESTRIAN SIGNAL HEAD
		PEDESTRIAN PUSHBUTTON DETECTOR
		DETECTOR LOOP
		QUADRAPOLE DETECTOR LOOP
		SIGNAL POST
		ALUMINUM MAST ARM ASSEMBLY AND POLE
		STEEL MAST ARM ASSEMBLY AND POLE
		WOOD POLE
		WOOD POLE WITH GUY
		SERVICE INSTALLATION
		CONTROLLER
		HANDHOLE
		HEAVY DUTY HANDHOLE
		DOUBLE HANDHOLE
		JUNCTION BOX
		GULFBOX JUNCTION
		AERIAL CABLE
		CONDUIT LENGTH - CONSTRUCTION (T=TRENCH P=PUSHED A=AUGERED E=EXISTING) SIZE - TYPE (S=STEEL P=PVC F=FIBER DUCT U=UNI-DUCT)
		CONDUIT SPLICE
		SPAN WIRE / TETHER WIRE
		21 SIDEWALK REMOVAL IN SQ M (50 FT)
		9 PC CONC SDWLK 100 mm IN SQ M (50 YD)
		12 PC CONC SDWLK 100 mm SPECIAL IN SQ M ( 50 YD)

**TRAFFIC SIGNAL WIRING DIAGRAM LEGEND**

EXISTING	PROPOSED	DESCRIPTION
		200 mm (8") SIGNAL SECTION
		300 mm (12") SIGNAL SECTION
		DIRECTIONAL SIGNAL SECTION
		225 mm ( 9") PEDESTRIAN SIGNAL FACE
		300 mm (12") PEDESTRIAN SIGNAL FACE
		SIGNAL FACE WITH BACKPLATE
		PROGRAMMED SIGNAL SECTION
		SIGNAL SECTION WITH LOUVRE
		DUAL-INDICATION SIGNAL SECTION
		INDUCTION DETECTOR LOOP
		QUADRAPOLE DETECTOR LOOP
		DIRECT-CONNECTED LOOP LEAD-IN ( TWISTED )
		ELECTRIC CABLE DENOTING NUMBER OF CONDUCTORS
		ELECTRIC CABLE TO BE REMOVED
		ELECTRIC CABLE IDENTIFIER TAPE CODES (R= RED W= WHITE Y= YELLOW G= GREEN B= BLUE O= ORANGE)
		PEDESTRIAN PUSHBUTTON DETECTOR
		VIDEO DETECTION CAMERA
		EMERGENCY VEHICLE PREEMPTOR



REVISIONS	
NAME	DATE

ILLINOIS DEPARTMENT OF TRANSPORTATION  
**LEGEND FOR TRAFFIC SIGNAL DETAILS**  
 FAP 320 (ILLINOIS 10)  
 SECTION 24 TS-3

SCALE: VERT.      DRAWN BY    KDA  
 HORIZ.              CHECKED BY  
 DATE    SEPT '06

PLOT DATE = 10/25/2006  
 FILE NAME = c:\projects\652806\ts\_sheets.dgn  
 PLOT SCALE = 4.23524 / IN.  
 USER NAME = laughlin-1