

F.A.I. RTE.	SECTION	COUNTY	TOTAL SHEETS	SHEET NO.
55	D6 REHAB BR PAINTING 2007-1	LOGAN	7	1

STATE OF ILLINOIS
 DEPARTMENT OF TRANSPORTATION
 DIVISION OF HIGHWAYS

**PROPOSED
 HIGHWAY PLANS**

FAI ROUTE 55 (I-55)
 SECTION - D6 REHAB BR PAINTING 2007-1
 PROJECT C-96-014-07
 LOGAN COUNTY

FOR INDEX OF SHEETS, SEE SHEET NO. 2



SN 054-0038

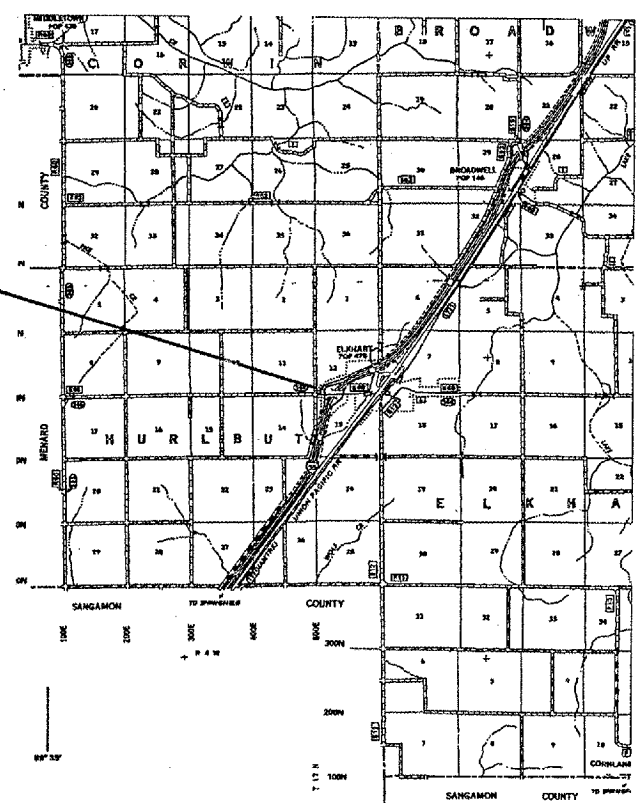

NET LENGTH OF SECTION: 314' = .06 MI

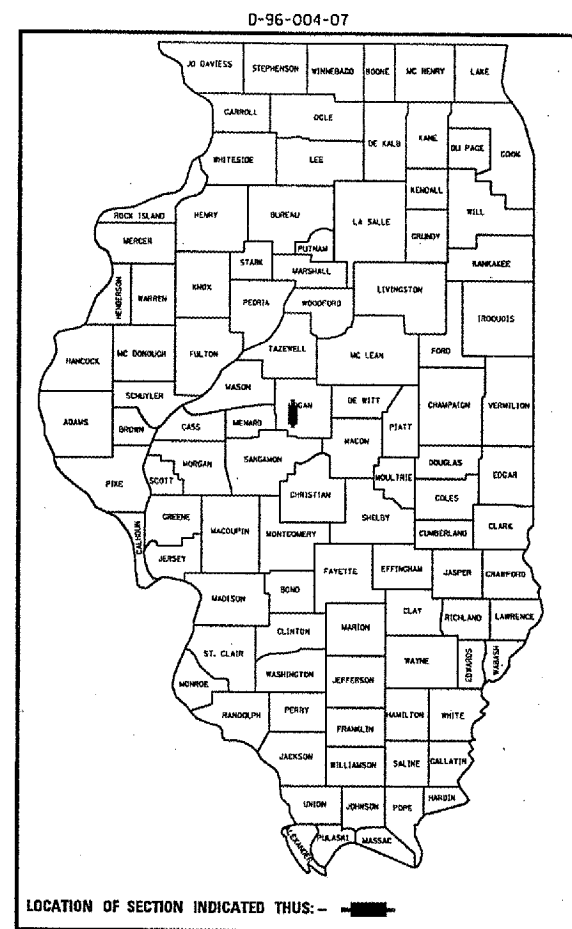

LOCATION OF SECTION INDICATED THUS: - [black rectangle] -

BRIDGE ENGINEER
 STEVE BERAN - (217) 785-9290

BRIDGE INSPECTION ENGINEER
 DAVE COPENBARGER - (217) 785-5306

J.U.L.I.E.
 JOINT UTILITY LOCATION INFORMATION FOR EXCAVATION
 1-800-892-0123

CONTRACT NO. 72A71

STATE OF ILLINOIS
 DEPARTMENT OF TRANSPORTATION
 DIVISION OF HIGHWAYS

SUBMITTED *October 26, 2006*
Chris M. Reed
 DEPUTY DIRECTOR OF HIGHWAYS, REGION ENGINEER

December 8, 2006
Eric E. Harn
 INTERIM ENGINEER OF DESIGN AND ENVIRONMENT

December 20, 2006
Melton R. Sees, P.E.
 DIRECTOR OF HIGHWAYS, CHIEF ENGINEER

PRINTED BY THE AUTHORITY
 OF THE STATE OF ILLINOIS