

B.M. # 34-2, El. 599.16, R.R. Spike  
in Pole Rt. Sta. 44+97

ROUTE NO.	SECTION	COUNTY	TOTAL SHEETS	SHEET NO.
F.A.I. - 55	54-1NB	LOGAN	60	25
PER. ROAD DIV. NO. 7		ILLINOIS	PROJECT E-55-4(75)24	

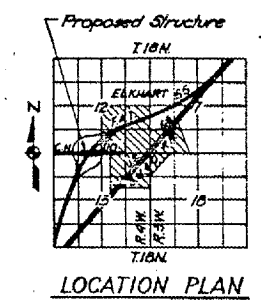
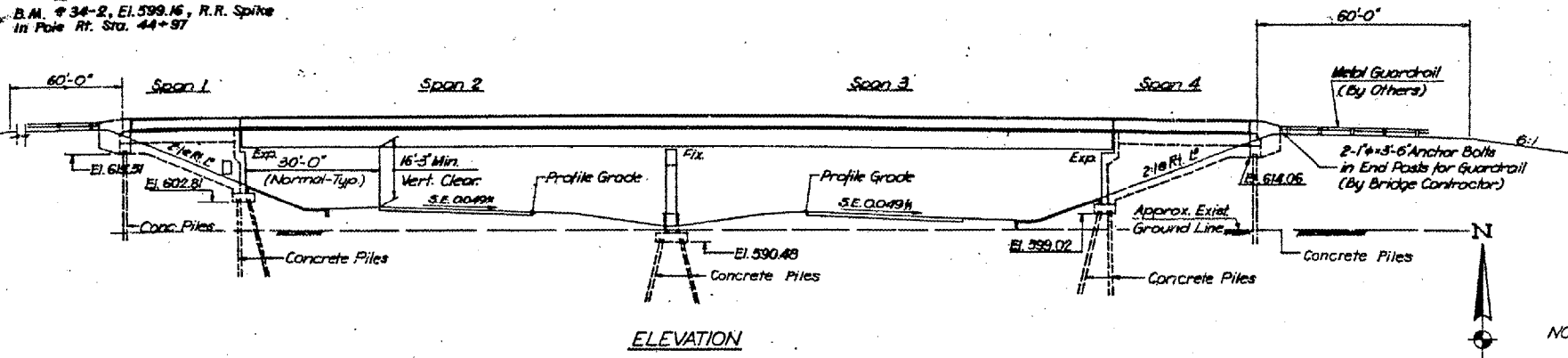

NOTE: See Special Provisions For Settlement Platform in the Embankment Construction At The East Abutment. See Sheet No. 4 For Detail.

STATION 611-56.07  
BUILT 197 BY  
STATE OF ILLINOIS  
F.A.I. RT. 55 SEC. 54-1NB  
F.A.I. PROJ. I-55-4(75)  
LOADING HS20

NAME PLATE  
See Std. 2/13

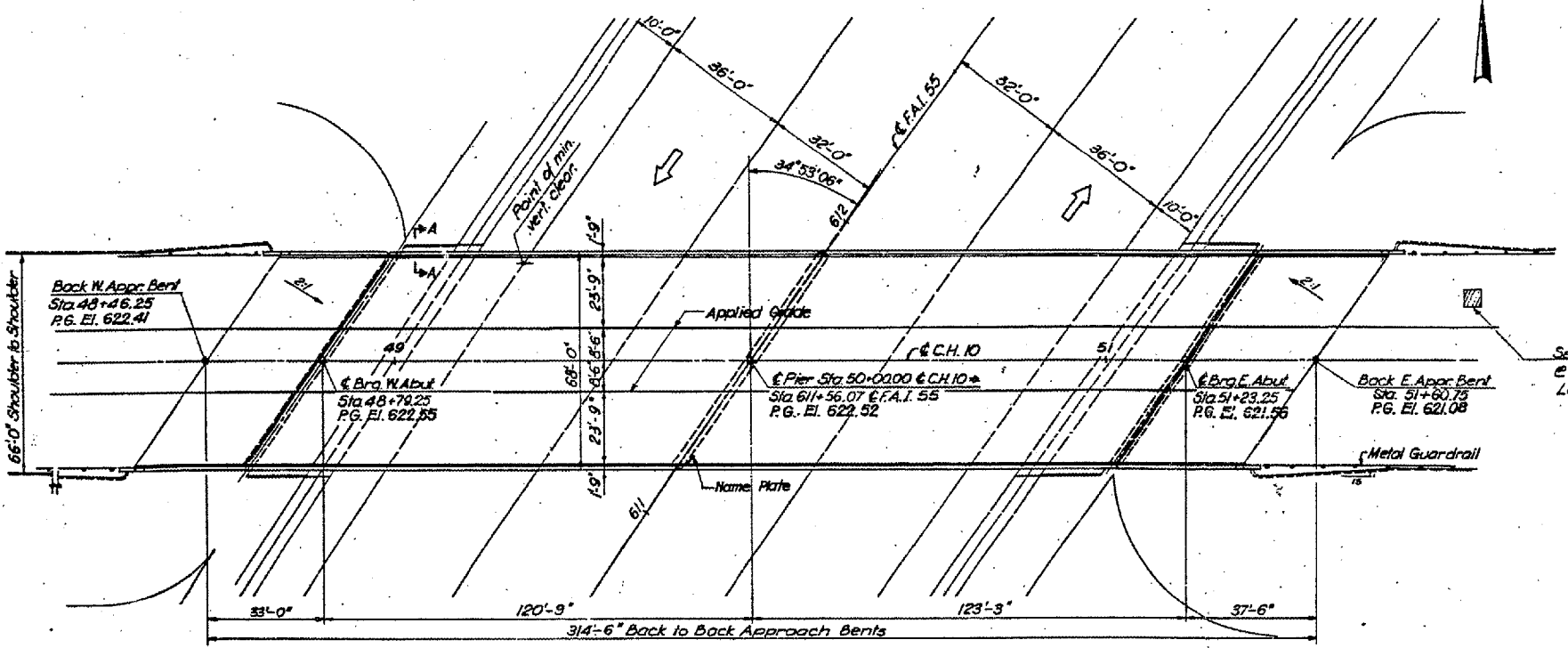

Settlement Platform  
e Sta. ± 52+00, 13 Ft.  
Left of C.H. 10

TOTAL BILL OF MATERIAL

Item	Unit	Super	Sub	Total
Structure Excavation	Cu Yds	—	108	108
Class X Concrete	Cu Yds	693.0	519.7	1,212.7
Protective Coat	Sq Yds	2,590	—	2,590
Furnishing and Erecting Structural Steel	Lump Sum	—	—	—
Reinforcement Bars	Lbs	182,360	49,990	232,350
Bridge Seat Sealer **	Lump Sum	—	—	—
Furnishing Concrete Piles	Lin. Ft.	—	7803	7803
Driving Concrete Piles	Lin. Ft.	—	7803	7803
Test Pile Concrete	Ea	—	3	3
Name Plates	Ea	—	1	1
Slope Wall 4"	Sq Yds	—	534	534
Sandblasting Concrete	Sq. Yds.	137	—	137
Stud Shear Connectors	Each	2,810	—	2,810
Furnishing and Erecting Precast Prestressed Concrete I-Beams (36")	Lin. Ft.	448	—	448

F.A.I. - 55 CURVE DATA

P.I. = Sta 615+26.56  
Δ = 55° 59' 57"  
D = 1' 45"  
R = 3274.05'  
L = 3192.95'  
T = 1740.01'  
P.C. = Sta 597+85.75  
P.T. = Sta 629+85.70

DESIGN STRESSES AND LOADS

f<sub>s</sub> = 248,000 psi. Prestressing Steel  
f<sub>si</sub> = 178,600 psi.  
f<sub>c</sub> = 5,000 psi. Prestressed Concrete  
f<sub>ci</sub> = 4,000 psi.  
f<sub>c</sub> = 1,200 psi. Superstructure  
f<sub>cs</sub> = 1,400 psi. Substructure  
f<sub>s</sub> = 20,000 psi. Structural Steel (A-36)  
f<sub>s</sub> = 20,000 psi. Reinforcement  
w = 75 psi. Footings  
Max. allow. Live Load Defl. =  $\frac{L}{160}$  (Corr.)  
LOADING: HS20-44  
Future Wearing Surface = 25' by Sq. Ft.  
\* Alternate f<sub>s</sub> = 270,000 psi is permitted

APPROVED  
FOR STRUCTURAL ADEQUACY ONLY  
C. E. T. [Signature]  
Engineer of Bridge & Traffic Structures

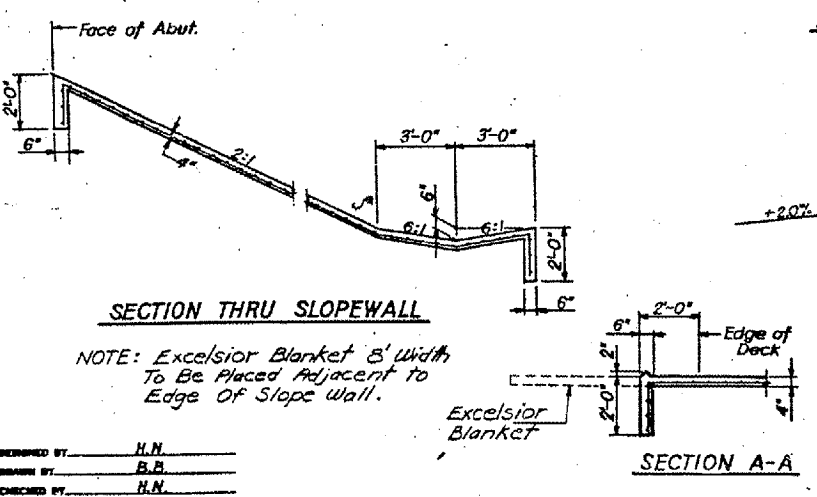

C.H. 10 - PROFILE GRADE

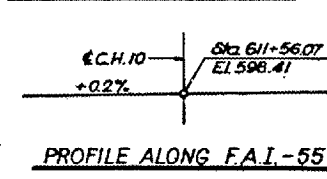

C-96-014-07  
SN 054-0038  
EXISTING BRIDGE PLANS  
FOR INFORMATION ONLY  
(NOT TO SCALE)

DESIGNED BY: H.N.  
DRAWN BY: B.B.  
CHECKED BY: H.N.