

FOR INDEX OF SHEETS AND HIGHWAY
STANDARDS, SEE SHEET 2.

STATE OF ILLINOIS
DEPARTMENT OF TRANSPORTATION
DIVISION OF HIGHWAYS

**PLANS FOR PROPOSED
CONTRACT MAINTENANCE**
FAI ROUTE 55 5 10.020-13.000/(FR I-55 EAST)
SECTION (68-2)Q-3,(68-3,4)Q
MONTGOMERY COUNTY
C96-015-07 / D96-005-07

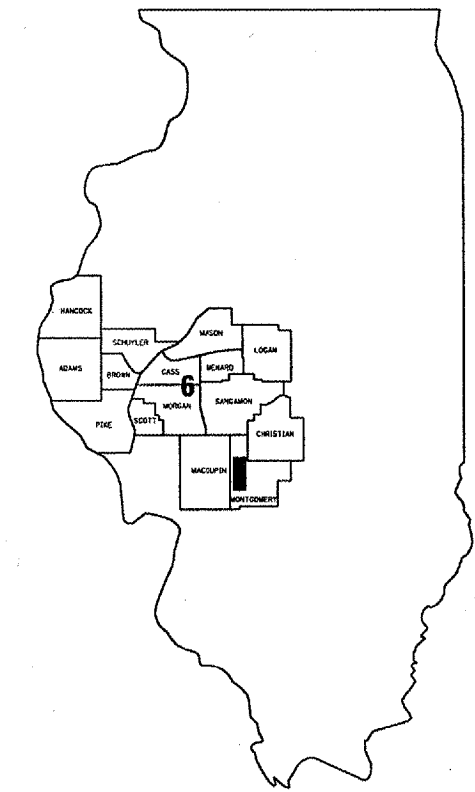

LOCATION OF SECTION INDICATED THUS: ■

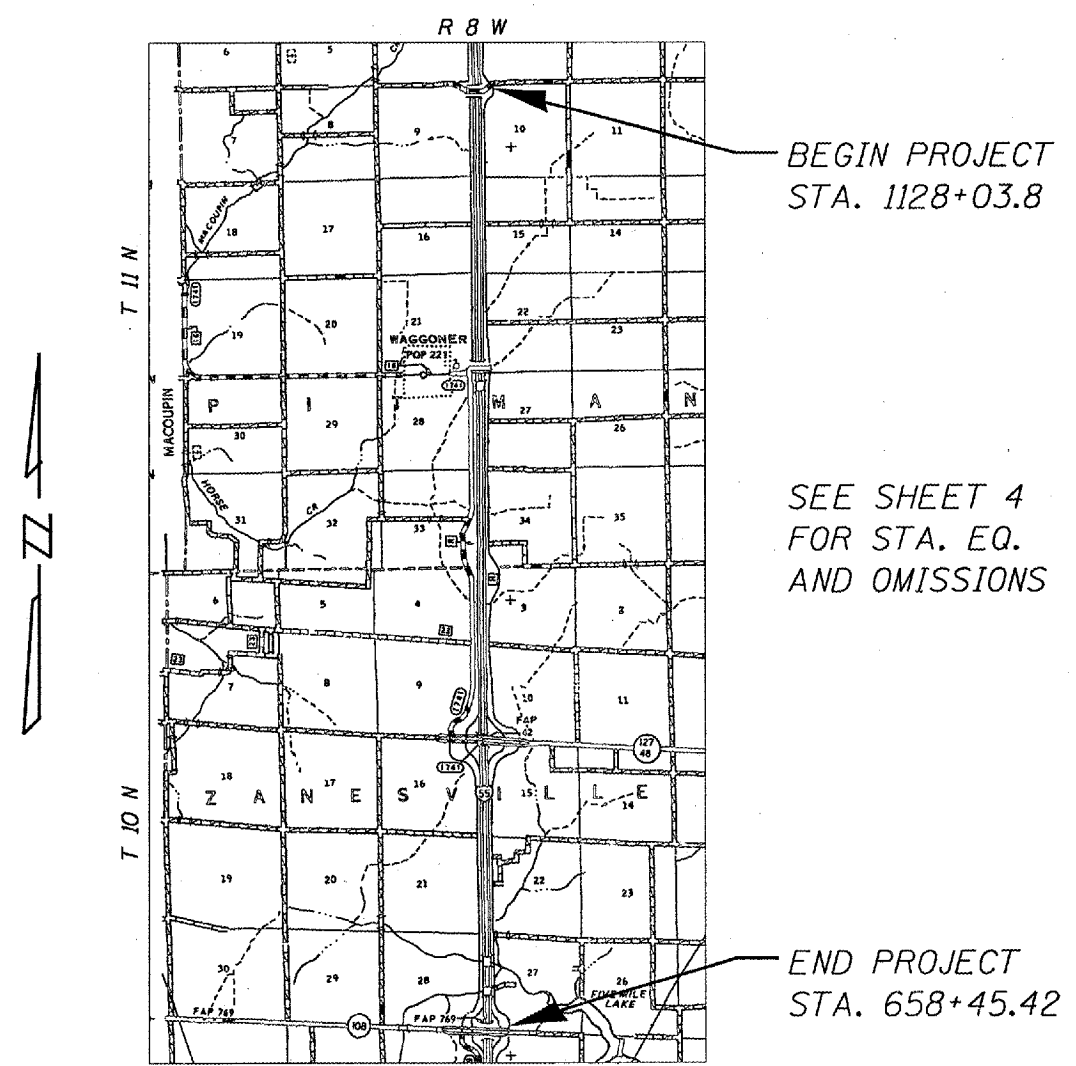

J. U. L. I. E.
JOINT UTILITY LOCATION INFORMATION FOR EXCAVATION
1-800-892-0123

PLANS & CONTRACT TECHNICIAN: TIMOTHY SHARP
PHONE: (217) 782-7743

CONTRACT NO. 72A72

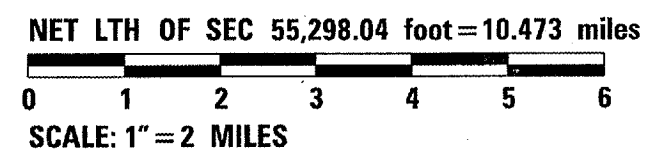

STATE OF ILLINOIS
DEPARTMENT OF TRANSPORTATION
DIVISION OF HIGHWAYS

SUBMITTED OCT. 18, 20 06

Christ M Reed
DEPUTY DIRECTOR OF HIGHWAYS, REGION FOUR ENGINEER

December 8, 20 06

Eric E. Hamm
Interim ENGINEER OF DESIGN AND ENVIRONMENT

December 8, 20 06

Milton R. Sees
DIRECTOR, DIVISION OF HIGHWAYS

INDEX

- 1 COVER
- 2 INDEX/STANDARDS/SIGNATURES
- 3 QUANTITIES
- 4 PLAN
- 5 TYPICAL SECTIONS

STANDARDS

- 701001-01
- 701006-02
- 701011-01
- 701201-02
- 701301-02
- 701306-01
- 701311-02
- 702001-06
- 780001-01

STATE OF ILLINOIS DEPARTMENT OF TRANSPORTATION DIVISION OF HIGHWAYS DISTRICT 6	
EXAMINED <u>October 17</u> 20 <u>06</u>	<u>[Signature]</u> ENGINEER OF OPERATIONS
EXAMINED <u>OCT 10</u> 20 <u>06</u>	<u>[Signature]</u> ENGINEER OF PROGRAM IMPLEMENTATION
EXAMINED <u>OCTOBER 11</u> 20 <u>06</u>	<u>[Signature]</u> ENGINEER OF PROGRAM DEVELOPMENT

INDEX/STANDARDS/SIGNATURES
FAI 55 5 10.020-13.000/(FR I-55 EAST)
SECTION (68-2)Q-3,(68-3,4)Q
MONTGOMERY COUNTY

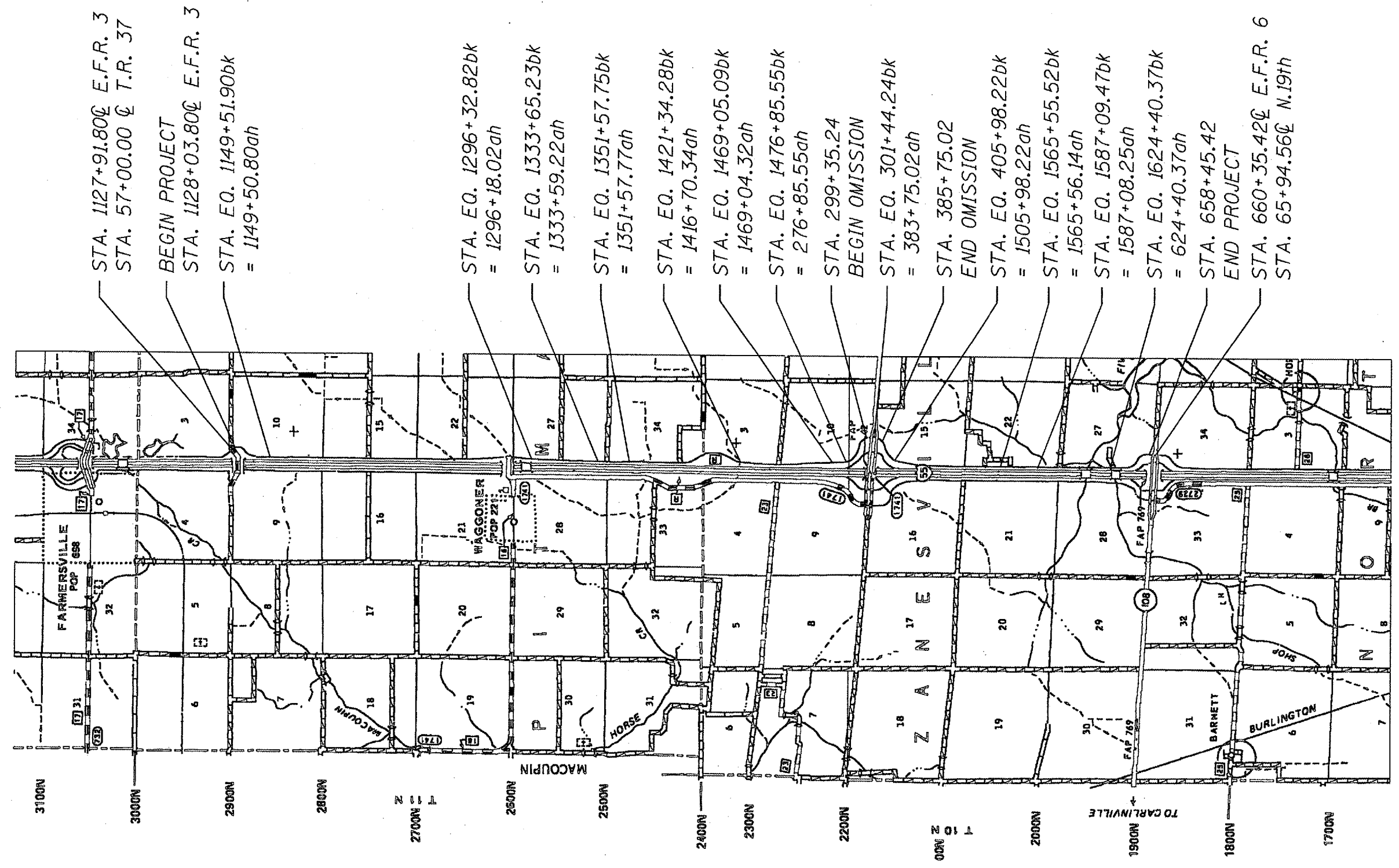

STA. 1127+91.80 @ E.F.R. 3
STA. 57+00.00 @ T.R. 37

BEGIN PROJECT
STA. 1128+03.80 @ E.F.R. 3
STA. EQ. 1149+51.90bk
= 1149+50.80ah

STA. EQ. 1296+32.82bk
= 1296+18.02ah

STA. EQ. 1333+65.23bk
= 1333+59.22ah

STA. EQ. 1351+57.75bk
= 1351+57.77ah

STA. EQ. 1421+34.28bk
= 1416+70.34ah

STA. EQ. 1469+05.09bk
= 1469+04.32ah

STA. EQ. 1476+85.55bk
= 276+85.55ah

STA. 299+35.24
BEGIN OMISSION

STA. EQ. 301+44.24bk
= 383+75.02ah

STA. 385+75.02
END OMISSION

STA. EQ. 405+98.22bk
= 1505+98.22ah

STA. EQ. 1565+55.52bk
= 1565+56.14ah

STA. EQ. 1587+09.47bk
= 1587+08.25ah

STA. EQ. 1624+40.37bk
= 624+40.37ah

STA. 658+45.42
END PROJECT
STA. 660+35.42 @ E.F.R. 6
STA. 65+94.56 @ N.19th

QUANTITIES
FAI 55 5 10.020-13.000/(FR 1-55 EAST)
SECTION (68-2)0-3,(68-3,4)0
MONTGOMERY COUNTY

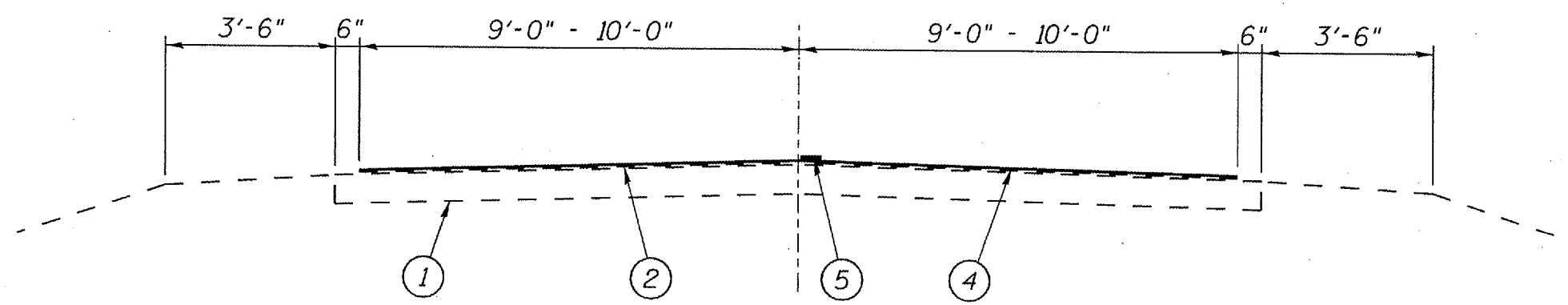

STA. EQ. 1149+51.9bk=1149+50.80ah

STA. 1128+03.80 TO 1208+03.00 - 9'-0"
STA. 1208+03.00 TO 1208+80.00 - 9'-0" to 10'-0"
STA. 1208+80.00 TO 1261+50.00 - 10'-0"

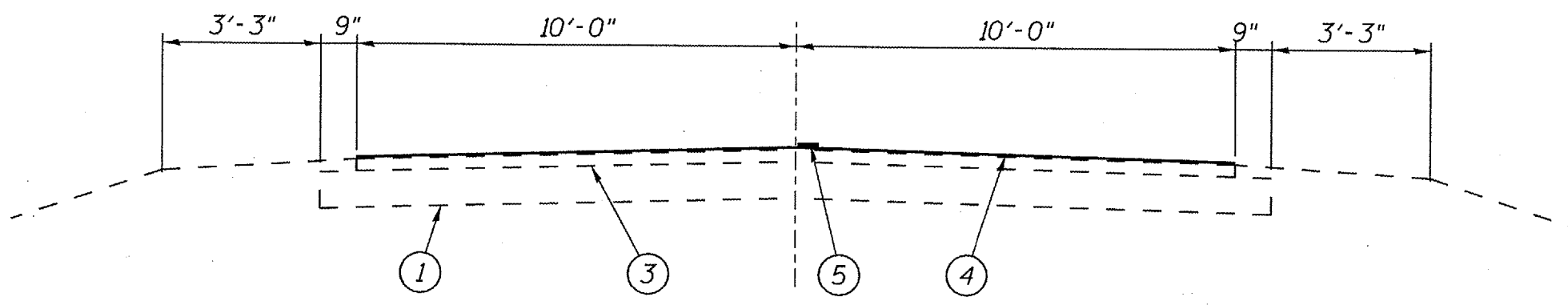

STA. EQ. 1296+32.82bk=1296+18.02ah
STA. EQ. 1333+65.23bk=1333+59.22ah
STA. EQ. 1351+57.75bk=1351+57.77ah
STA. EQ. 1421+34.28bk=1416+70.34ah
STA. EQ. 1469+05.09bk=1469+04.32ah
STA. EQ. 1476+85.55bk=276+85.55ah
OMISSION STA. 299+35.24 TO 301+44.24

STA. 1261+50.00 TO 1476+85.55
STA. 276+85.55 TO 299+35.24
STA. 385+75.02 TO 405+98.22
STA. 1505+98.22 TO 1624+40.37
STA. 624+40.37 TO 658+45.42

STA. EQ. 301+44.24bk=383+75.02ah
OMISSION STA. 383+75.02 TO 385+75.02
STA. EQ. 405+98.22bk=1505+98.22ah
STA. EQ. 1565+55.52bk=1565+56.14ah
STA. EQ. 1587+09.47bk=1587+08.25ah
STA. EQ. 1624+40.37bk=624+40.37ah

LEGEND

- 1 - EXIST. AGGREGATE BASE
- 2 - EXIST. BITUMINOUS SURFACE TREATMENT, A-3
- 3 - EXIST. BITUMINOUS MIXTURE COMPLETE 3"
- 4 - PROP. BITUMINOUS SURFACE TREATMENT, A-1
- 5 - PROP. PAINT PAVEMENT MARKING - LINE 5"

QUANTITIES
FAI 55 5 10.020-13.000(IFR I-55 EAST)
SECTION (68-2)0-3,(68-3,4)0
MONTGOMERY COUNTY