

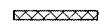





F.A.U. RTE.	SECTION	COUNTY	TOTAL SHEETS	SHEET NO.
9177	44-1BR	ST. CLAIR	29	11
STA.		TO STA.		
FED. ROAD DIST. NO.		ILLINOIS FED. AID PROJECT		

LEGEND

-  IMPACT ATTENUATOR
-  TEMPORARY CONCRETE BARRIER
-  DIRECTION INDICATOR BARRICADE WITH STEADY BURNING LIGHT
-  BARRELS OR BARRICADES WITH STEADY BURNING LIGHT
-  TYPE III BARRICADE
-  ARROW BOARD

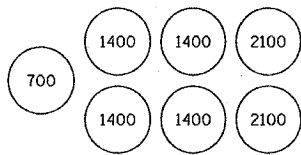

SAND MODULE IMPACT ATTENUATOR LAYOUT (IF OPTION USED)

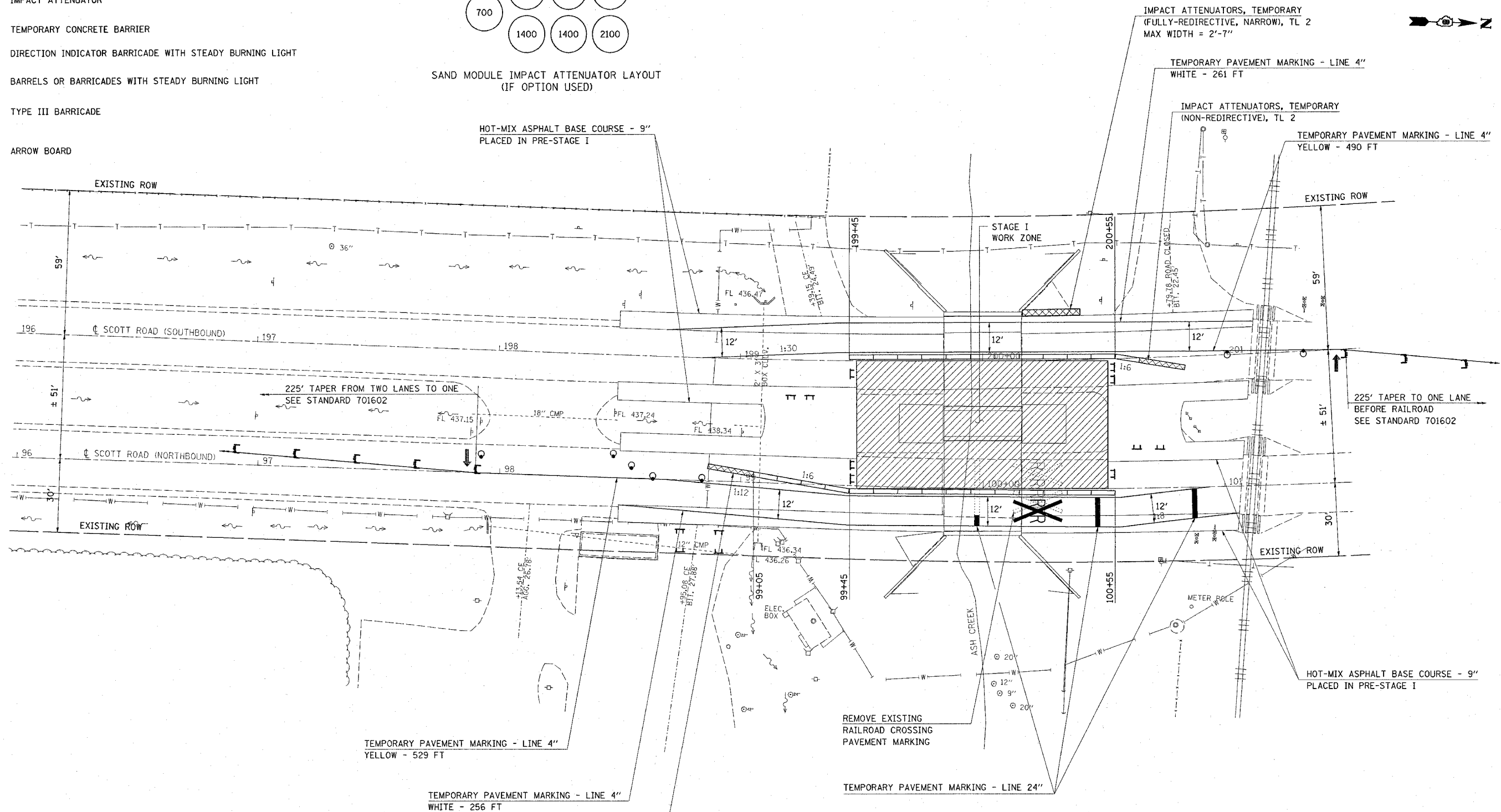

SEQUENCE OF CONSTRUCTION - STAGE I:

REMOVE CONFLICTING SKIP-DASH, SOLID EDGE AND RAILROAD PAVEMENT MARKINGS.

PLACE TEMPORARY PAVEMENT MARKINGS.

PLACE 275 FT TEMPORARY CONCRETE BARRIER, 2 EACH IMPACT ATTENUATORS, TEMPORARY, (NON-REDIRECTIVE), AND 1 EACH IMPACT ATTENUATOR, TEMPORARY (FULLY-REDIRECTIVE, NARROW).

SEE STANDARD 701321 FOR TEMPORARY CONCRETE BARRIER DETAILS AND SEE STANDARD 701602 FOR TAPER AND SIGN DETAILS NOT SHOWN ON PLANS.

IMPACT ATTENUATORS, TEMPORARY (NON-REDIRECTIVE), TL 2

REVISIONS	
NAME	DATE

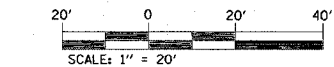

ILLINOIS DEPARTMENT OF TRANSPORTATION

STAGE I CONSTRUCTION

FAU ROUTE 9177
SECTION 44-1BR
ST. CLAIR COUNTY

PLOT DATE = 10/18/2006
 FILE NAME = c:\vpro\pnta\ed92482\plan\stg02482a.dgn
 PLOT SCALE = 28.0000 "/>