

SECTION	COUNTY	TOTAL SHEETS	SHEET NO.
02-00034-00-BT	DUPAGE	108	10
STA. TO STA.			
IDOT PROJECT NO. M-8003(216)			
SALT CREEK GREENWAY TRAIL			
CONTRACT NO. 83714			

PROP. CURVE CL1-3
 PI STA = 18+065.682
 N = 44,976.374
 E = 7,140.673
 $\Delta = 17^\circ 06' 20''$ (LT)
 R = 30,000 m
 T = 4.512 m
 L = 8.956 m
 E = 0.337 m

PROPOSED BICYCLE TRAIL
 AGGREGATE BASE COURSE, TYPE B, 150 mm
 BIT. CONC. SURF. COURSE, SUPERPAVE, MIX
 C N50, 50 mm
 PAINT PVT. MKG. - LINE 100 mm (SOLID
 YELLOW Φ)

STOP
 R1-1
 450mmX450mm
 3.05 m TY A POST
 1.8 SM DETECTABLE WARNING
 6 SM PCC SIDEWALK, 150 MM
 BEGIN CONSTRUCTION
 STA. 17+992.517
 (ELMHURST PARK DISTRICT NORTH SECTION)

LEGEND

- +— SWALE TIP
- +— DITCH SUMMIT
- +— DITCH CHECK
- +— PROPOSED CULVERT
- +— EXISTING CULVERT
- +— EXISTING MANHOLE
- +— EXISTING FENCE
- +— FLARED END SECTION
- +— INLET AND PIPE PROTECTION
- +— TREE REMOVAL
- +— PERIMETER EROSION BARRIER

PROP. CURVE CL1-1
 PI STA = 18+013.139
 N = 45,001.065
 E = 7,095.193
 $\Delta = 9^\circ 29' 36''$ (RT)
 R = 40,000 m
 T = 3.321 m
 L = 6.628 m
 E = 0.138 m

PROP. CURVE CL1-2
 PI STA = 18+038.954
 N = 44,993.341
 E = 7,119.841
 $\Delta = 21^\circ 45' 46''$ (RT)
 R = 30,000 m
 T = 5.767 m
 L = 11.395 m
 E = 0.549 m

PROP. CURVE CL1-4
 PI STA = 18+086.028
 N = 44,968.708
 E = 7,159.592
 $\Delta = 7^\circ 39' 12''$ (RT)
 R = 30,000 m
 T = 2.007 m
 L = 4.007 m
 E = 0.067 m

PROP. CURVE CL1-5
 PI STA = 18+098.155
 N = 44,962.695
 E = 7,170.130
 $\Delta = 31^\circ 39' 35''$ (RT)
 R = 30,000 m
 T = 8.506 m
 L = 16.577 m
 E = 1.183 m

PROP. CURVE CL1-6
 PI STA = 18+126.791
 N = 44,937.178
 E = 7,184.060
 $\Delta = 9^\circ 56' 49''$ (RT)
 R = 30,000 m
 T = 2.611 m
 L = 5.208 m
 E = 0.113 m

PROP. CURVE CL1-7
 PI STA = 18+184.696
 N = 44,882.312
 E = 7,202.613
 $\Delta = 17^\circ 51' 26''$ (RT)
 R = 100,000 m
 T = 15.711 m
 L = 31.167 m
 E = 1.227 m

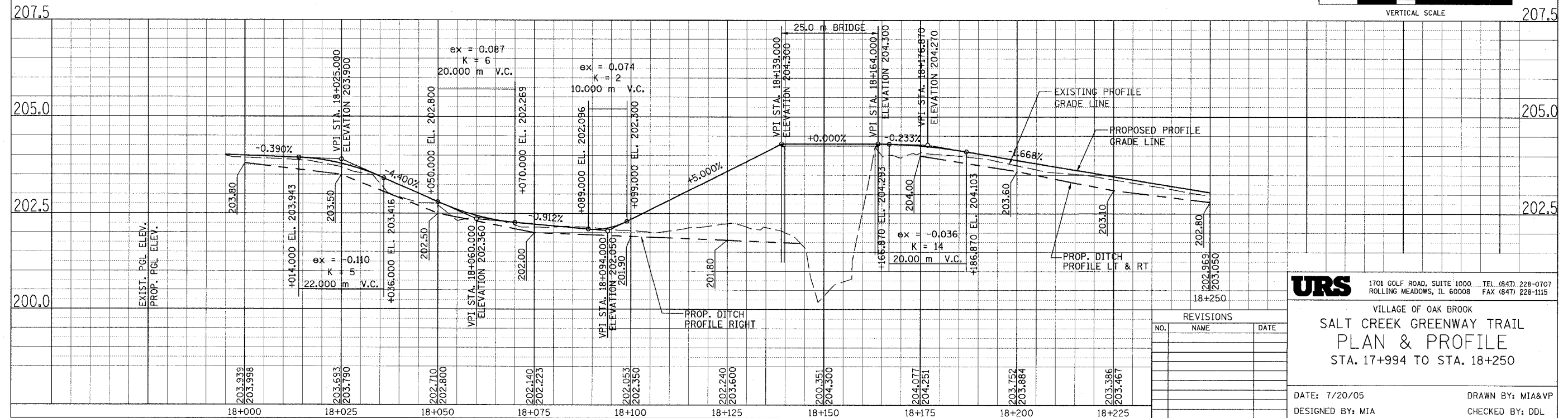
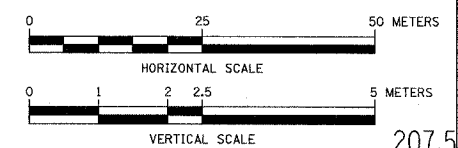

URS 1701 GOLF ROAD, SUITE 1000 TEL (847) 228-0707
 ROLLING MEADOWS, IL 60008 FAX (847) 228-1115

VILLAGE OF OAK BROOK
**SALT CREEK GREENWAY TRAIL
 PLAN & PROFILE**
 STA. 17+994 TO STA. 18+250

DATE: 7/20/05 DRAWN BY: MIA&VP
 DESIGNED BY: MIA CHECKED BY: DDL

REVISIONS		
NO.	NAME	DATE