

SECTION	COUNTY	TOTAL SHEETS	SHEET NO.
02-00034-00-BT	DUPAGE	108	17
STA. TO STA.			
IDOT PROJECT NO. M-8003(216)			
SALT CREEK GREENWAY TRAIL			

CONTRACT NO. 83714

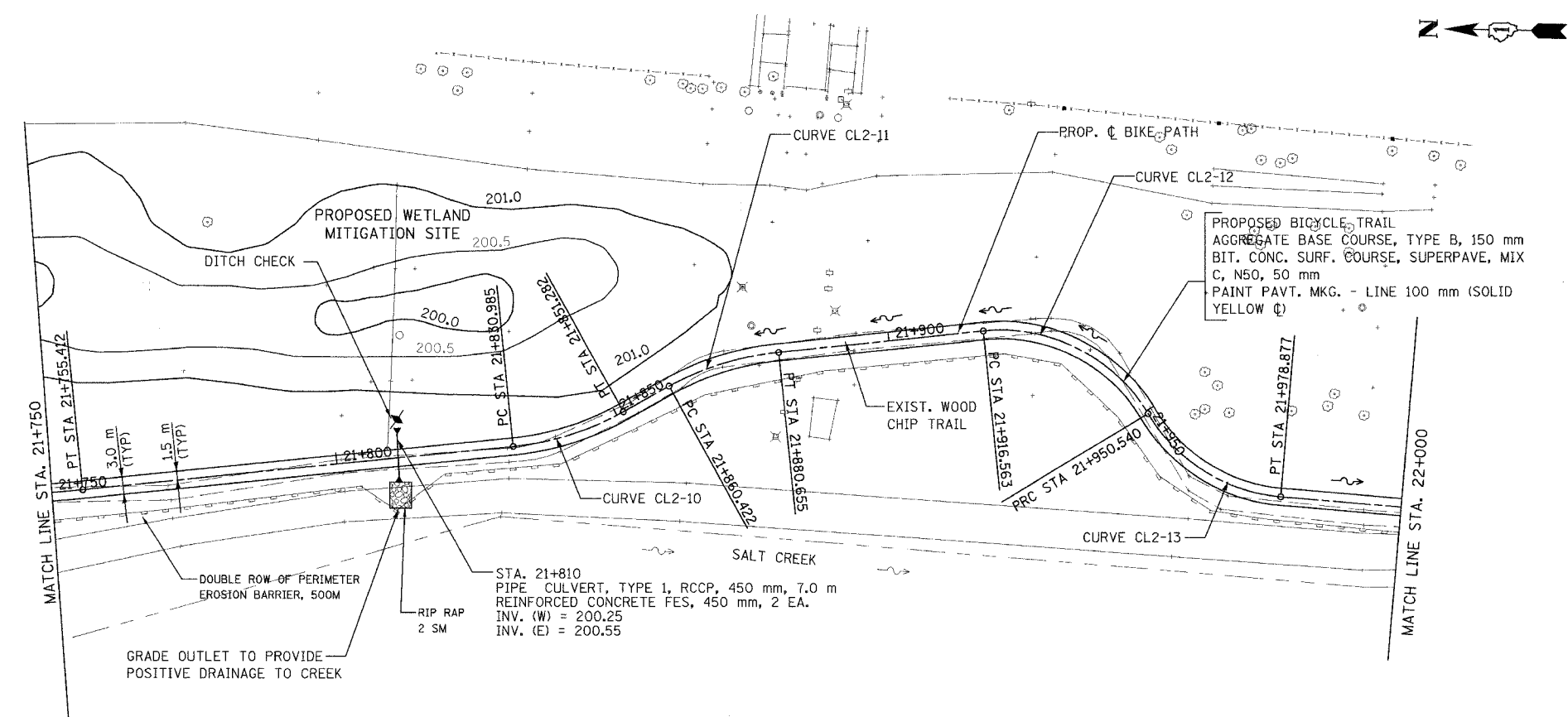

PROP. CURVE CL2-10 PI STA = 21+841.275 N = 42,346.754 E = 7,681.745 $\Delta = 23^\circ 15' 34''$ (LT) R = 50.000 m T = 10.291 m L = 20.298 m E = 1.048 m	PROP. CURVE CL2-11 PI STA = 21+870.679 N = 42,321.097 E = 7,696.679 $\Delta = 23^\circ 11' 05''$ (RT) R = 50.000 m T = 10.257 m L = 20.233 m E = 1.041 m
PROP. CURVE CL2-12 PI STA = 21+935.635 N = 42,256.348 E = 7,704.647 $\Delta = 64^\circ 53' 29''$ (RT) R = 30.000 m T = 19.072 m L = 33.977 m E = 5.549 m	PROP. CURVE CL2-13 PI STA = 21+965.865 N = 42,238.057 E = 7,675.516 $\Delta = 54^\circ 07' 05''$ (LT) R = 30.000 m T = 15.325 m L = 28.336 m E = 3.687 m

STA. 21+810
 PIPE CULVERT, TYPE 1, RCCP, 450 mm, 7.0 m
 REINFORCED CONCRETE FES, 450 mm, 2 EA.
 INV. (W) = 200.25
 INV. (E) = 200.55

DOUBLE ROW OF PERIMETER EROSION BARRIER, 500M

GRADE OUTLET TO PROVIDE POSITIVE DRAINAGE TO CREEK

RIP RAP 2 SM

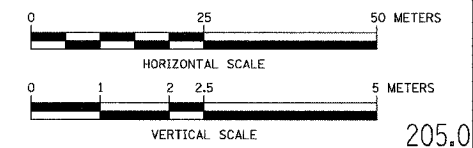

FOR LEGEND SEE SHEET NO. 15

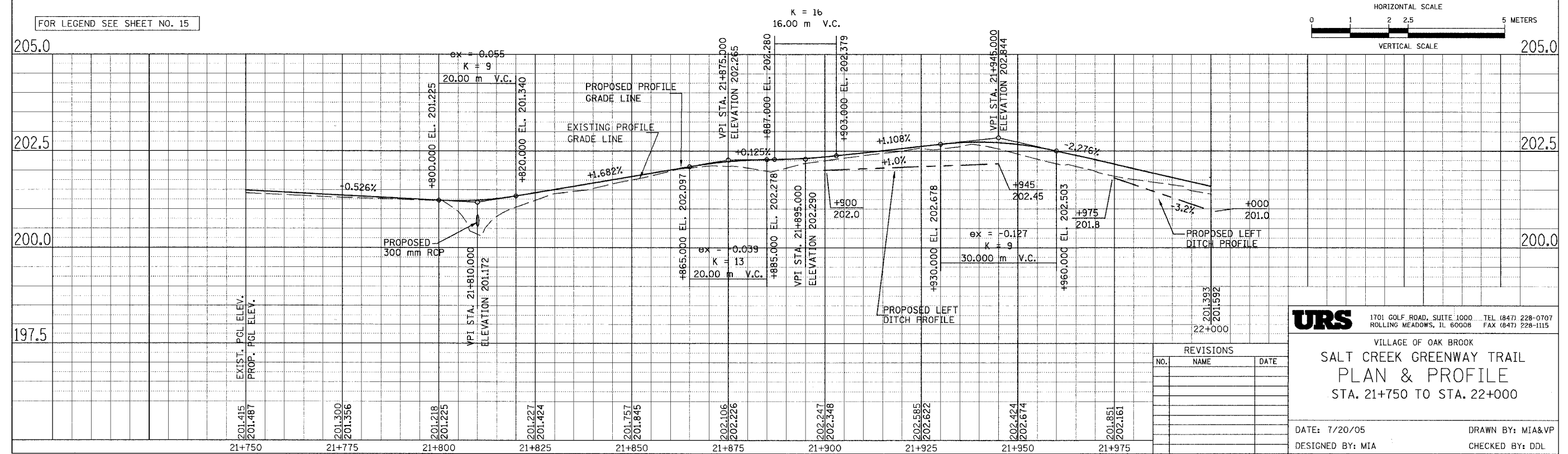

URS 1701 GOLF ROAD, SUITE 1000 TEL (847) 228-0707
 ROLLING MEADOWS, IL 60008 FAX (847) 228-1115

VILLAGE OF OAK BROOK
SALT CREEK GREENWAY TRAIL
PLAN & PROFILE
 STA. 21+750 TO STA. 22+000

DATE: 7/20/05 DRAWN BY: MIA&VP
 DESIGNED BY: MIA CHECKED BY: DDL

REVISIONS		
NO.	NAME	DATE