

SECTION	COUNTY	TOTAL SHEETS	SHEET NO.
94-F3000-05-BT	COOK	102	52
STA. TO STA.			
IDOT PROJECT NO. TE-0001(610)			
CENTENNIAL TRAIL			

CONTRACT NO. 83859

PROP. CURVE CL-7
 PI STA = 15+448.73
 N = 563,204.872
 E = 337,866.605
 $\Delta = 2^\circ 48' 23''$ (LT)
 R = 1000.000 m
 T = 24.496 m
 L = 48.982 m

PROP. CURVE CL-9
 PI STA = 15+579.09
 N = 563,304.799
 E = 337,950.303
 $\Delta = 3^\circ 10' 26''$ (LT)
 R = 1000.000 m
 T = 27.704 m
 L = 55.393 m

LIMITS OF REMOVE/REPLACE FENCE:
 STA. 15+309 TO STA. 15+315 = 6 m
 STA. 15+535 TO STA. 15+600 = 65 m

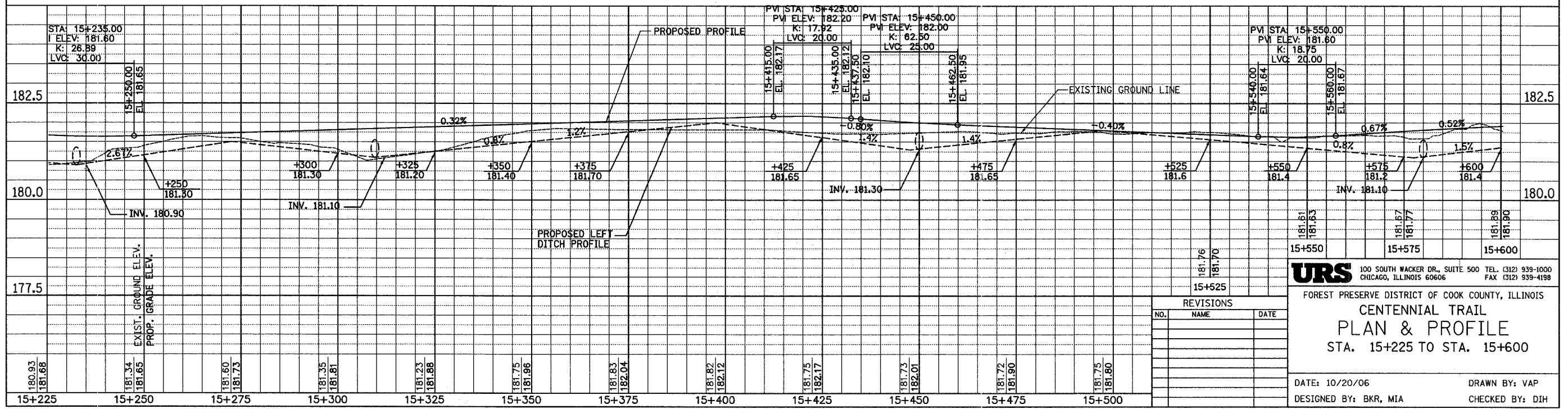
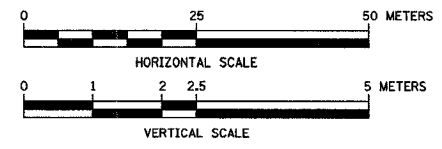
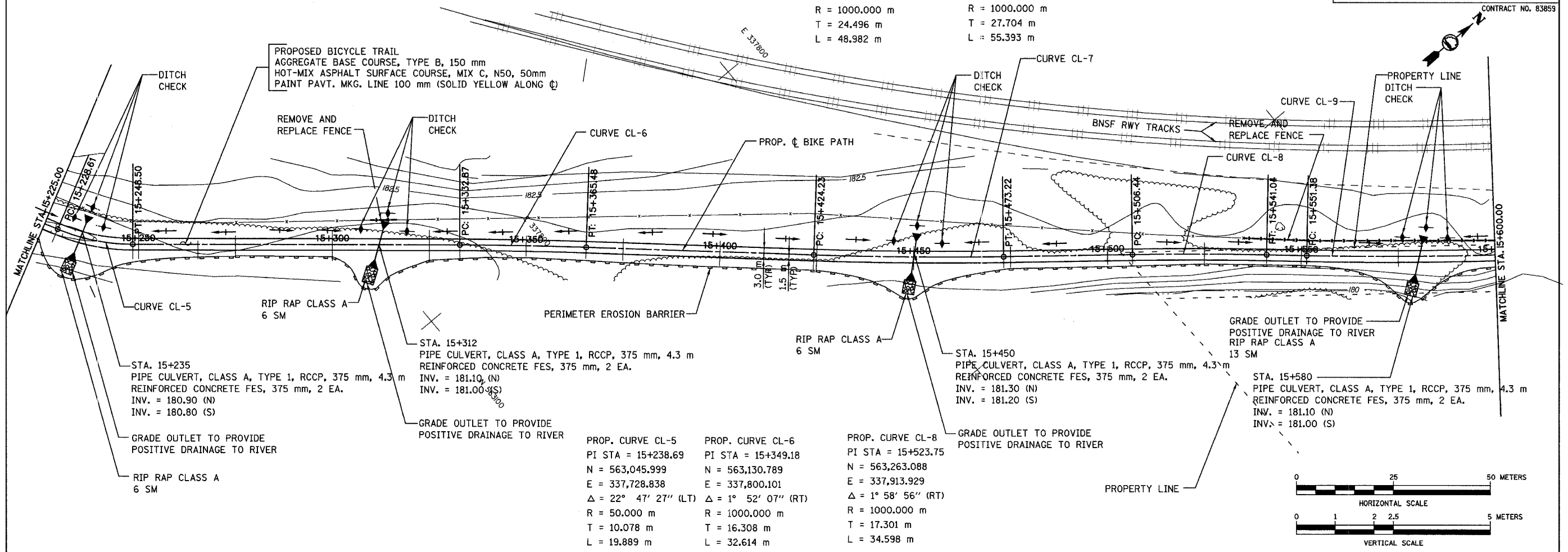

URS 100 SOUTH WACKER DR., SUITE 500 TEL. (312) 939-1000
 CHICAGO, ILLINOIS 60606 FAX (312) 939-4198

FOREST PRESERVE DISTRICT OF COOK COUNTY, ILLINOIS
CENTENNIAL TRAIL
PLAN & PROFILE
 STA. 15+225 TO STA. 15+600

DATE: 10/20/06 DRAWN BY: VAP
 DESIGNED BY: BKR, MIA CHECKED BY: DJH

REVISIONS		
NO.	NAME	DATE