

F.A.P. R.T.E.	SECTION	COUNTY	TOTAL SHEETS	SHEET NO.
1517	03-00247-00-BR	KANE	121	35
STA. 112+50	TO STA. 122+50			
FED. ROAD DIST. NO. 1		ILLINOIS	HIGHWAY PROJECT	
		E-03 OF E-09	CONTRACT #: 83867	

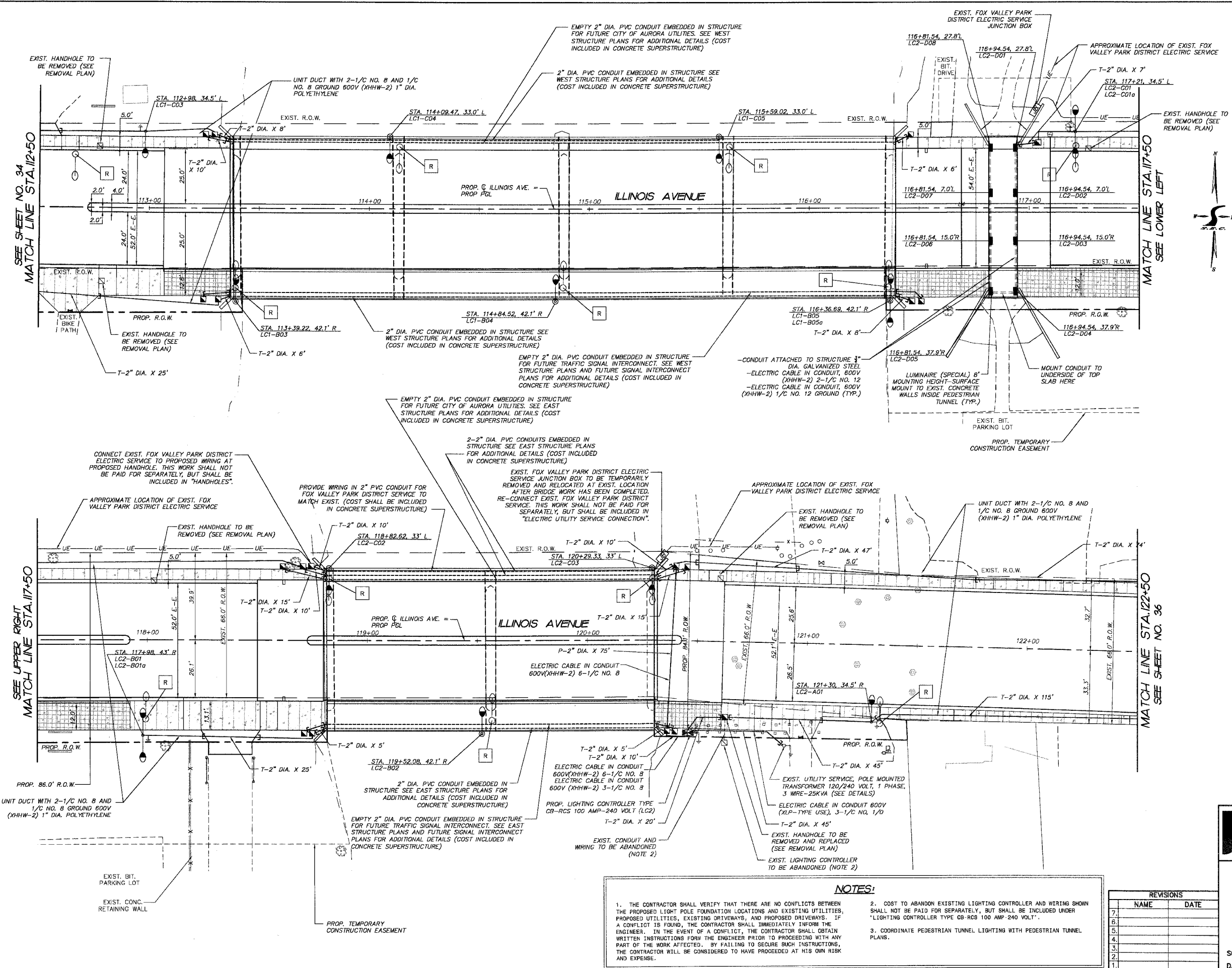

LEGEND:

- [R] REMOVAL OF EXISTING LIGHTING UNIT, SALVAGE
- EXISTING LIGHT POLE
- EXISTING LIGHT POLE WITH DOUBLE MAST ARM AND LUMINAIRE
- ⊠ EXISTING LIGHTING CONTROLLER
- ⊠ EXISTING HANDHOLE
- LIGHT POLE, STEEL, 31 FT M.H., 12 FT MAST ARM
- LIGHT POLE, STEEL, 31 FT M.H., 12 FT MAST ARM (BRIDGE MOUNTED)
- LIGHT POLE, STEEL, 31 FT M.H., 12 FT MAST ARM, TWIN
- LIGHT POLE, STEEL, 31 FT M.H., 12 FT MAST ARM, TWIN (BRIDGE MOUNTED)
- PROPOSED LUMINAIRE (SPECIAL)
- GROUND ROD, 5/8" DIA. X 10 FT.
- ⊠ PROPOSED HANDHOLE
- ⊠ PROPOSED LIGHTING CONTROLLER TYPE CB-RCS 100 AMP - 240 VOLT
- STA. XXX+XX.XX' R LC2-XXX POLE LOCATION
- POLE NUMBER
- LIGHTING CIRCUIT BREAKER DESIGNATION
- LIGHTING CONTROLLER DESIGNATION
- PVC CONDUIT EMBEDDED IN STRUCTURE
- ELECTRIC CABLE IN UNIT DUCT, NUMBER OF CONDUCTORS AND DIAMETER OF CONDUIT AS SHOWN
- T/P CONDUIT IN TRENCH (T) CONDUIT PUSHED (P) RIGID GALVANIZED STEEL (RGS) CONDUIT DIA. X LENGTH

NOTES:

- THE CONTRACTOR SHALL VERIFY THAT THERE ARE NO CONFLICTS BETWEEN THE PROPOSED LIGHT POLE FOUNDATION LOCATIONS AND EXISTING UTILITIES, PROPOSED UTILITIES, EXISTING DRIVEWAYS, AND PROPOSED DRIVEWAYS. IF A CONFLICT IS FOUND, THE CONTRACTOR SHALL IMMEDIATELY INFORM THE ENGINEER. IN THE EVENT OF A CONFLICT, THE CONTRACTOR SHALL OBTAIN WRITTEN INSTRUCTIONS FROM THE ENGINEER PRIOR TO PROCEEDING WITH ANY PART OF THE WORK AFFECTED. BY FAILING TO SECURE SUCH INSTRUCTIONS, THE CONTRACTOR WILL BE CONSIDERED TO HAVE PROCEEDED AT HIS OWN RISK AND EXPENSE.
- COST TO ABANDON EXISTING LIGHTING CONTROLLER AND WIRING SHOWN SHALL NOT BE PAID FOR SEPARATELY, BUT SHALL BE INCLUDED UNDER "LIGHTING CONTROLLER TYPE CB-RCS 100 AMP - 240 VOLT".
- COORDINATE PEDESTRIAN TUNNEL LIGHTING WITH PEDESTRIAN TUNNEL PLANS.

REVISIONS	
NAME	DATE
7.	
6.	
5.	
4.	
3.	
2.	
1.	

SMITH ENGINEERING CONSULTANTS, INC.
 CIVIL/STRUCTURAL ENGINEERS AND SURVEYORS
 4000 PRIME PARKWAY, SUITE 201
 McHENRY, ILLINOIS 60050
 PH: 815-385-1778 FAX: 815-385-1781
 www.smithengineering.com E-MAIL: sec@smithengineering.com
 McHENRY HUNTLEY YORKVILLE
 ILLINOIS PROFESSIONAL DESIGN FIRM # 184-000108

ILLINOIS DEPARTMENT OF TRANSPORTATION
 CITY OF AURORA
 ILLINOIS AVENUE OVER THE FOX RIVER
 LIGHTING PLANS AND DETAILS
 STA. 107+50 TO STA. 117+50
 SCALE: 1" = 20'
 DATE 07-28-2006
 DRAWN BY MPL
 CHECKED BY GB

PLOT FILE: STANDARD
 VIEW: LC2-35
 COMP. FILE: 050181-622.dwg