

F.A.U. RTE.	SECTION	COUNTY	TOTAL SHEETS	SHEET NO.
1321	0711 N-1	DUPAGE	54	1

STATE OF ILLINOIS
DEPARTMENT OF TRANSPORTATION
DIVISION OF HIGHWAYS

**PROPOSED
HIGHWAY PLANS**

**FAU ROUTE 1321 /IL ROUTE 19 (IRVING PARK ROAD)
AT BLOOMINGDALE ROAD
STATE SECTION: 0711 N-1
MFT SECTION: 06-00055-00-CH
ROADWAY WIDENING, RECONSTRUCTION,
REALIGNMENT, TRAFFIC SIGNAL INSTALLATION
PROJECT M-8003(697)
DuPAGE COUNTY
C-91-035-07**

D-91-237-06



LOCATION OF SECTION INDICATED THUS: -

FOR INDEX OF SHEETS, SEE SHEET NO. 2

DESIGN DESIGNATION:

3025 (14) MINOR ARTERIAL 1.76 (FD-10)

TRAFFIC DATA:

ADT IL. RTE. 19: 18,000 (2005)

ADT BLOOMINGDALE ROAD: 12,200 (2001)

ADT IL. RTE. 19: 32,000 (2020)

ADT BLOOMINGDALE ROAD: 10,000 (2020)

SPEED LIMIT: 35 MPH (IL 19)

DESIGN SPEED: 35 MPH (IL 19)

**PROJECT LOCATED IN
THE VILLAGE OF ITASCA**

**IL. ROUTE 19
PROJECT LIMIT
STA. 1000 + 89.2**

**BLOOMINGDALE RD
PROJECT LIMIT
STA. 2003 + 31.3**

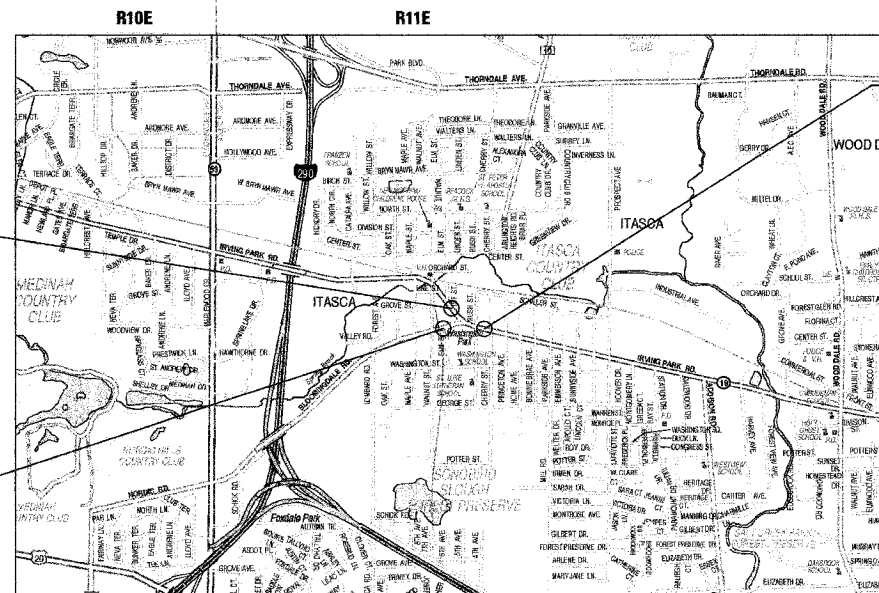

LOCATION MAP

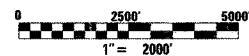

**GROSS LENGTH OF PROJECT = 1552.80 FT = 0.294 MILES
NET LENGTH OF PROJECT = 1552.80 FT = 0.294 MILES**

**IL. ROUTE 19
PROJECT LIMIT
STA. 1011 + 98.3**



SIGNATURE: *Joseph J. Enry* 8/17/06
CIVILTECH ENGINEERING, INC.
SHEETS FROM 25 TO 38

DATE: 8/17/06 EXP: 11/30/07



SIGNATURE: *Craig A. Lukowicz* DATE 8/15/06
CRAIG A. LUKOWICZ
ILLINOIS REGISTERED PROFESSIONAL ENGINEER NO. 062-041788
MY LICENSE EXPIRES ON 11-30-07.
BOLLINGER, LACH & ASSOCIATES, INC

STATE OF ILLINOIS
DEPARTMENT OF TRANSPORTATION
DIVISION OF HIGHWAYS

SUBMITTED Aug. 18 20 06
Diane O'Keefe/Cal
DEPUTY DIRECTOR OF HIGHWAYS, REGION ENGINEER

October 13, 20 06
Mike Sino
ENGINEER OF DESIGN AND ENVIRONMENT

October 13, 20 06
Milton R. Sees, P.E.
DIRECTOR OF HIGHWAYS, CHIEF ENGINEER

**PRINTED BY THE AUTHORITY
OF THE STATE OF ILLINOIS**

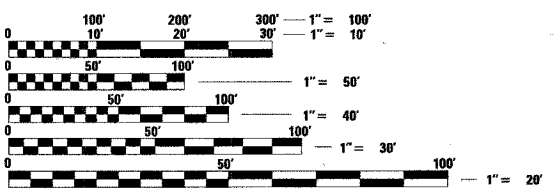

FULL SIZE PLANS HAVE BEEN PREPARED USING STANDARD ENGINEERING SCALES. REDUCED SIZED PLANS WILL NOT CONFORM TO STANDARD SCALES. IN MAKING MEASUREMENTS ON REDUCED PLANS, THE ABOVE SCALES MAY BE USED.

J.U.L.I.E.
JOINT UTILITY LOCATION INFORMATION FOR EXCAVATION
1-800-892-0123

CONTRACT NO. 83876

CONSULTING ENGINEERS & LAND SURVEYORS **Bollinger, Lach & Associates, Inc.**
1010 JORDAN BLVD. - OAK BROOK, IL 60523 • 630.950.1385

IDOT CONSULTANT PROJECT MANAGER: MR. MEL MANGOBA 847-705-4237 (DISTRICT 1)