

F.A.U. RTE.	SECTION	COUNTY	TOTAL SHEETS	SHEET NO.
1321	0711 N-1	DUPAGE	54	17
STA.	TO STA.			
FED. ROAD DIST. NO. 1	ILLINOIS	FED. AID PROJECT		

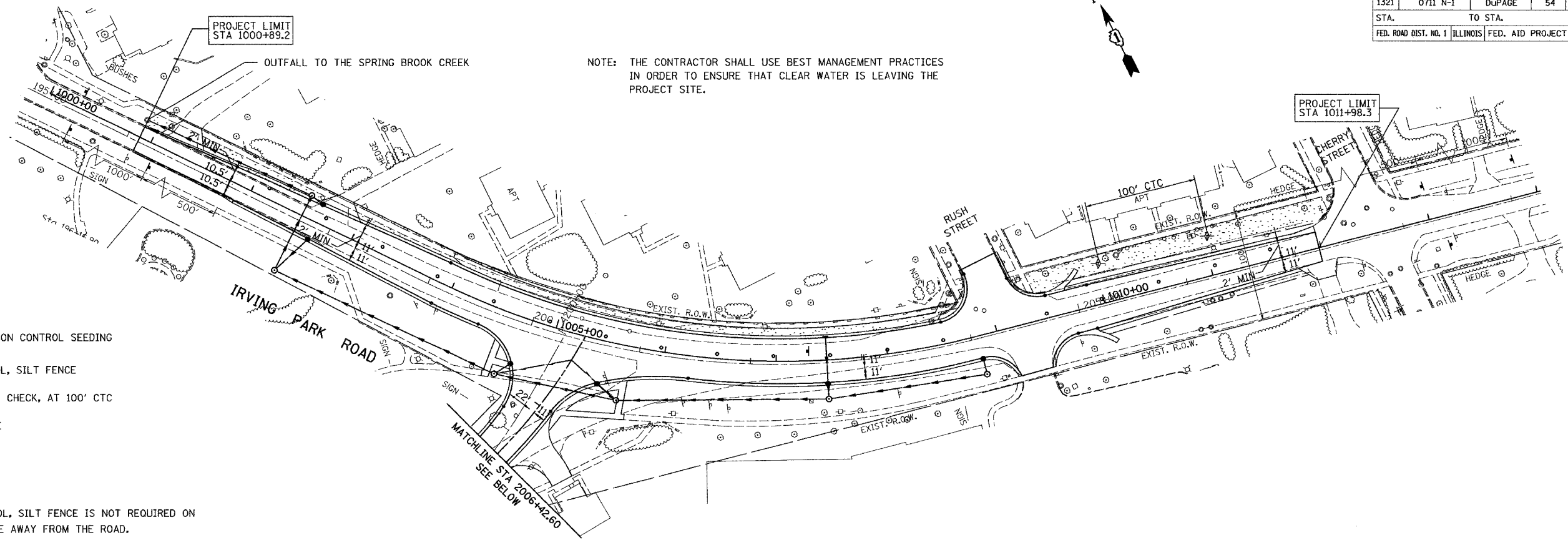

NOTE: THE CONTRACTOR SHALL USE BEST MANAGEMENT PRACTICES IN ORDER TO ENSURE THAT CLEAR WATER IS LEAVING THE PROJECT SITE.

LEGEND

- TEMPORARY EROSION CONTROL SEEDING
- SEDIMENT CONTROL, SILT FENCE
- TEMPORARY DITCH CHECK, AT 100' CTC
- TEMPORARY FENCE

NOTE: SEDIMENT CONTROL, SILT FENCE IS NOT REQUIRED ON AN UPWARD SLOPE AWAY FROM THE ROAD.

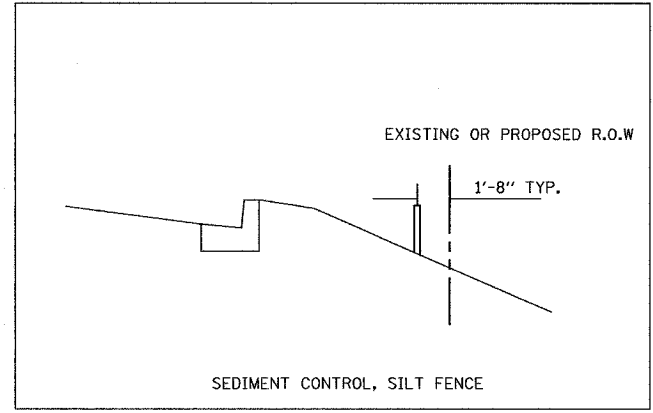
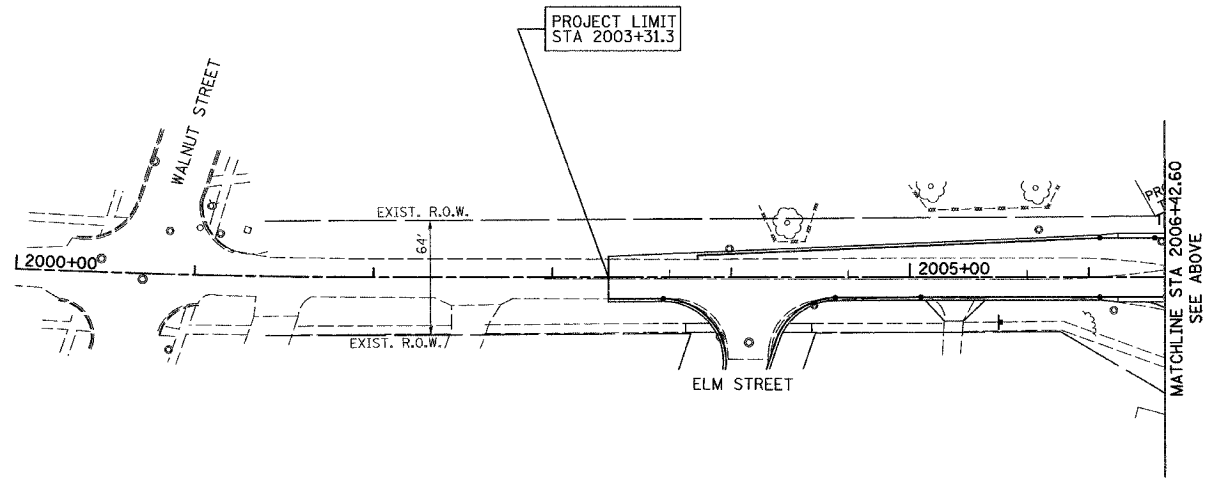

REVISIONS	
NAME	DATE

ILLINOIS DEPARTMENT OF TRANSPORTATION  
F.A.U. ROUTE 1321 (IL. ROUTE 19)

EROSION CONTROL PLAN  
STAGE 2

SCALE: 1"=50'  
DATE: 8/31/06

DRAWN BY: ES  
CHECKED BY: JJP

DATE = 8/31/06  
 PLOT NAME = FACILITY\Bloomingsdale\Proposed\Plans\Rev\Geom\VT Concept Plan\EROSION Stage 2.dgn  
 PLOT SCALE = 48600  
 USER NAME = JUSER