

F.A.U. RTE.	SECTION	COUNTY	TOTAL SHEETS	SHEET NO.
1321	0711 N-1	DU PAGE	54	25
STA. _____		TO STA. _____		
FED. ROAD DIST. NO. 7 ILLINOIS FED. AID PROJECT				

CABLE PLAN LEGEND

- |          |          |   |
|----------|----------|---|
| EXISTING | PROPOSED |   |
|          |          | 8" (200mm) TRAFFIC SIGNAL SECTION   |
|          |          | 12" (300mm) TRAFFIC SIGNAL SECTION  |
|          |          | 12" (300mm) PEDESTRIAN SIGNAL SECTION   |
|          |          | 12" (300mm) PEDESTRIAN SIGNAL SECTION   |
|          |          | CONTROLLER CABINET  |
|          |          | SERVICE INSTALLATION  |
|          |          | TELEPHONE CONNECTION  |
|          |          | MAGNETIC DETECTOR   |
|          |          | EMERGENCY VEHICLE LIGHT DETECTOR  |
|          |          | CONFIRMATION BEACON   |
|          |          | PUSHBUTTON DETECTOR   |
|          |          | VEHICLE DETECTOR, INDUCTION LOOP  |
|          |          | DENOTES NUMBER OF CONDUCTORS, ALL CABLE NO. 14 EXCEPT AS INDICATED. ALL LOOP DETECTOR CABLE TO BE SHIELDED. |
|          |          | MICROWAVE VEHICLE SENSOR  |
|          |          | SIGNAL FACE WITH BACKPLATE, "P" INDICATES PROGRAMMED HEAD   |
|          |          | RAILROAD CONTROL CABINET  |
|          |          | ILLUMINATED SIGN "NO LEFT TURN"   |
|          |          | ILLUMINATED SIGN "NO RIGHT TURN"  |
|          |          | GROUND ROD AT HANDHOLE (H), DOUBLE HANDHOLE (H), OR CONTROLLER (C).   |
|          |          | GROUND ROD AT POST (P), OR MAST ARM POLE (MA).  |
|          |          | GROUND ROD AT ELECTRIC SERVICE INSTALLATION   |
|          |          | GROUND CABLE IN CONDUIT NO. 6 SOLID COPPER (GREEN)  |
|          |          | FIBER OPTIC CABLE IN CONDUIT NO. 62.5/125 2-MMI2F SM12F   |

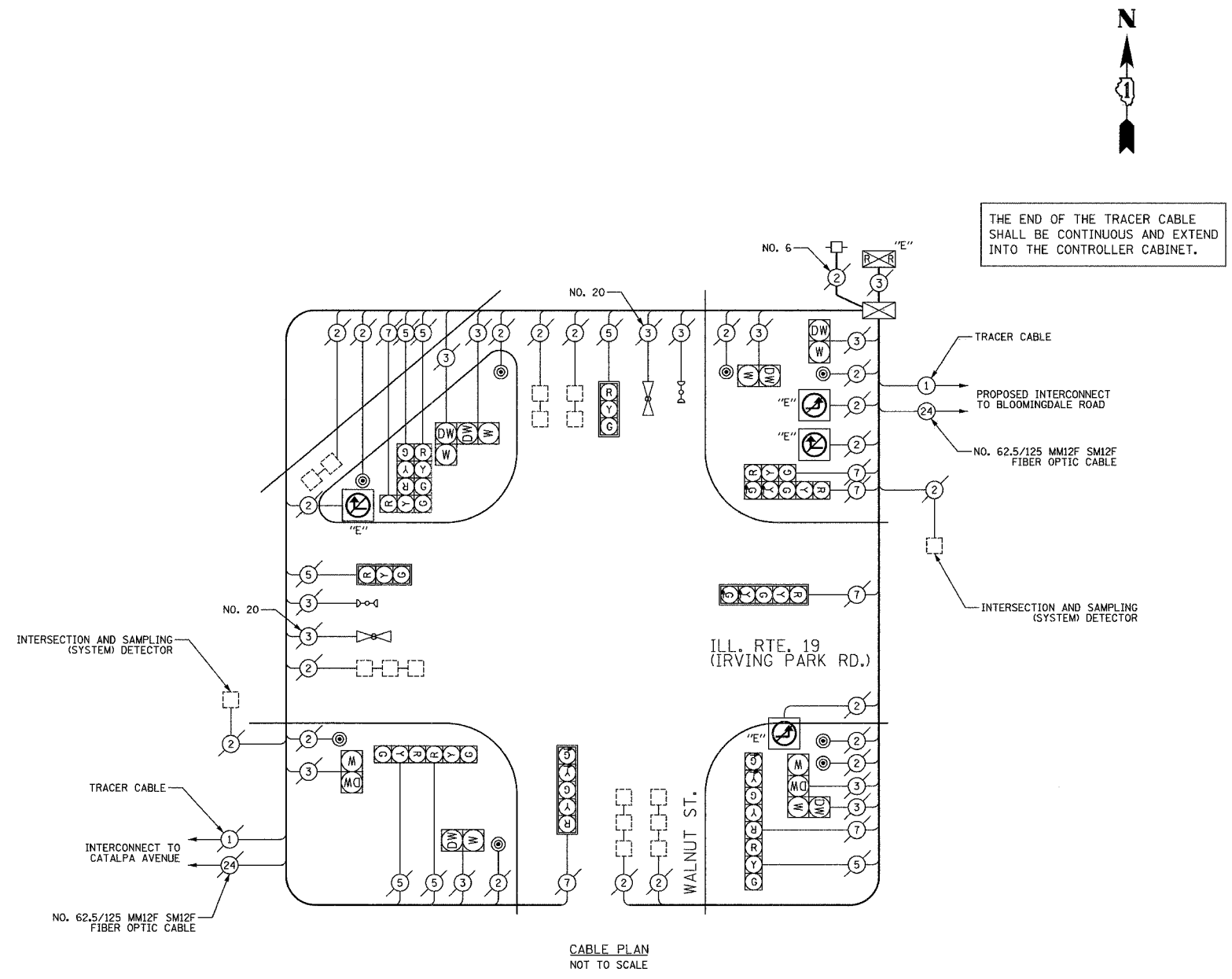

NOTE:  
THE TRAFFIC SIGNAL CONTROLLER EQUIPMENT FOR THIS PROJECT SHALL BE "EAGLE" TO MATCH THE EXISTING ADJACENT SYSTEM.

I.D.O.T. TRAFFIC SIGNAL INSTALLATION ELECTRICAL SERVICE REQUIREMENTS					TOTAL WATTAGE
TYPE	NO. LAMPS	WATTAGE INCAND.	LED	OPERATION	
SIGNAL (RED)	13	135		0.50	878
(YELLOW)	13	135		0.25	439
(GREEN)	13	135		0.25	439
ARROW	8	135		0.10	108
PED. SIGNAL	8	90		1.00	720
CONTROLLER	1	100		1.00	100
ILLUM. SIGN	4	84		0.05	17
FLASHER				0.50	
TOTAL =					2701

ENERGY COSTS TO: ILLINOIS DEPARTMENT OF TRANSPORTATION  
201 WEST CENTER COURT  
SCHAUMBURG, IL 60196-1096  
CONTACT: BOB BEATTY  
PHONE: 630-691-4721  
COMPANY: COM ED

ENERGY SUPPLY:

FOUNDATION (DEPTH)	FT. (m)	CABLE SLACK	FT. (m)	VERTICAL	FT. (m)
TYPE A - POST	4 (1.2)	HANDHOLE	6.5 (2.0)	ALL FOUNDATIONS	3.5 (2.0)
D- CONTROLLER	4 (1.2)	DOUBLE HANDHOLE	13 (4.0)	MAST ARM (L) POLE	20'-H-2' = (6m+L-0.6m)=
E- M. ARM POLE		SIGNAL POST	2 (1.0)	BRACKET MOUNTED	13 (4.0)
		24" (600mm)	10 (3.0)	PED. PUSHBUTTON	4 (1.2)
		30" (750mm)	15 (4.6)	ELECTRIC SERVICE	13.5 (4.1)
		36" (900mm)	15 (4.6)	SERVICE TO GROUND	13.5 (4.1)
		CONTROLLER CAB.	1 (0.5)	POST MOUNTED	6 (1.8)
		FIBER OPTIC	13 (4.0)		
		ELECTRIC SERVICE	1 (0.5)		
		GROUND CABLE	1 (0.5)		

REVISIONS		ILLINOIS DEPARTMENT OF TRANSPORTATION
NAME	DATE	
		<p align="center"><b>CABLE PLAN</b></p> <p align="center">ILL. RTE. 19 (IRVING PARK RD.) &amp; WALNUT STREET</p> <p>SCALE: NOT TO SCALE      DRAWN BY: BRD</p> <p>DATE: 8/23/2006      CHECKED BY: JJE</p>

PLOT DATE = #DATE#  
FILE NAME = #FILE#  
PLOT SCALE = #SCALE#  
REFERENCE = #REF#