

F.A.U. RTE.	SECTION	COUNTY	TOTAL SHEETS	SHEET NO.
1321	0711 N-1	DU PAGE	54	31
STA.		TO STA.		
FED. ROAD DIST. NO. 7		ILLINOIS FED. AID PROJECT		

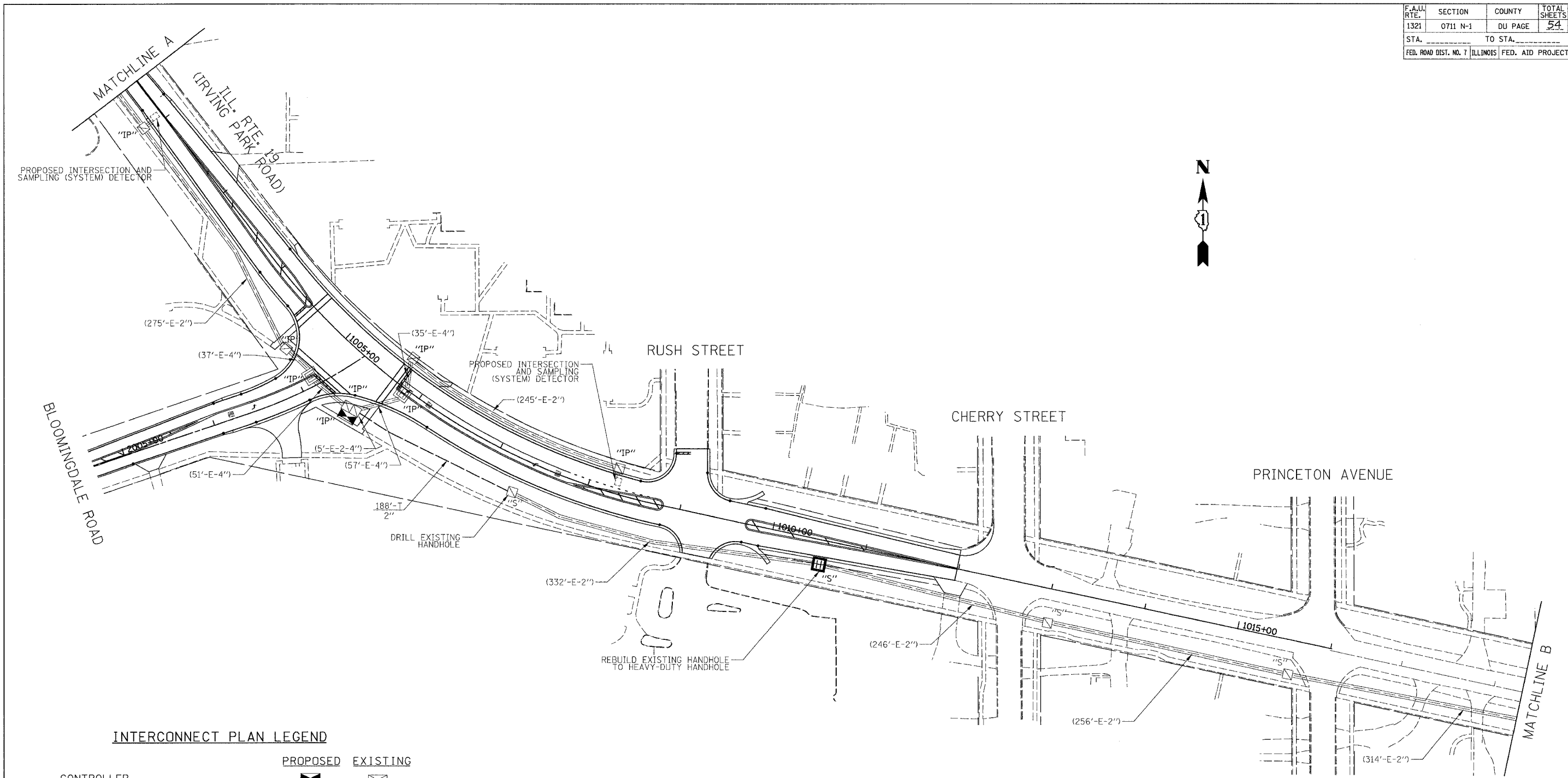

INTERCONNECT PLAN LEGEND

	PROPOSED	EXISTING
CONTROLLER		
HANDHOLE		
HEAVY DUTY HANDHOLE		
DOUBLE HANDHOLE		
G.S. CONDUIT IN TRENCH OR PUSHED		
DETECTOR LOOP		
SYSTEM	S	S
INTERSECTION	IP	I
UNIT DUCT	UD	
COMMON TRENCH	CT	

NOTE:
THE TRAFFIC SIGNAL CONTROLLER EQUIPMENT FOR THIS PROJECT SHALL BE "EAGLE" TO MATCH THE EXISTING ADJACENT SYSTEM.

REVISIONS	
NAME	DATE

ILLINOIS DEPARTMENT OF TRANSPORTATION
INTERCONNECT PLAN
 ILL. RTE. 19 (IRVING PARK RD.)
 WALNUT ST. TO PROSPECT AV.
 SHEET 2 OF 3
 SCALE: 1" = 50'
 DATE: 8/23/2006
 DRAWN BY: BRD
 CHECKED BY: JUE

PLOT DATE * DATE *
 PLOT SCALE * SCALE *
 REFERENCE * REF *