

| F.A.U. RTE.         | SECTION        | COUNTY                    | TOTAL SHEETS | SHEET NO. |
|---------------------|----------------|---------------------------|--------------|-----------|
| 2990                | 06-00078-00-RS | DUPAGE                    | 14           | 1         |
| FED. ROAD DIST. NO. |                | ILLINOIS FED. AID PROJECT |              |           |

CONTRACT NO: 83879

# STATE OF ILLINOIS DEPARTMENT OF TRANSPORTATION DIVISION OF HIGHWAYS

## PLANS FOR PROPOSED FEDERAL-AID URBAN PROJECT FAU RTE 2990 (STRUCKMAN BOULEVARD) FROM ILLINOIS RT 59 TO SOUTH BARTLETT ROAD RESURFACING (LAPP PROJECTS) SECTION NO. 06-00078-00-RS PROJECT NO: M-8003(696) JOB NO. C-91-015-07 VILLAGE OF BARTLETT, DuPAGE COUNTY

### INDEX OF SHEETS

- 1 COVER SHEET
- 2 LEGEND, GENERAL NOTES AND SUMMARY OF QUANTITIES
- 3 TYPICAL SECTIONS
- 4-8 PLAN SHEETS
- 9 CONSTRUCTION DETAILS
- 10 CURB OR CURB AND GUTTER REMOVAL AND REPLACEMENT
- 11 PAVEMENT PATCHING FOR BITUMINOUS SURFACED PAVEMENT
- 12 BUTT JOINT AND BITUMINOUS TAPER DETAILS
- 13 TRAFFIC CONTROL AND PROTECTION FOR SIDE ROADS, INTERSECTIONS, AND DRIVEWAYS
- 14 DISTRICT ONE TYPICAL PAVEMENT MARKINGS

### HIGHWAY STANDARDS

- 000001-04 STANDARD SYMBOLS ABBREVIATIONS & PATTERNS
- 424001-04 CURB RAMPS FOR SIDEWALKS
- 442201-04 CLASS C AND D PATCHES
- 606001-03 CONCRETE CURB TYPE B AND COMBINATION CONCRETE CURB AND GUTTER
- 701501-03 URBAN LANE CLOSURE 2L, 2W UNDIVIDED
- 701701-04 URBAN LANE CLOSURE MULTILANE INTERSECTION
- 701801-03 LANE CLOSURE MULTILANE 1W OR 2W CROSSWALK OR SIDEWALK CLOSURE
- 702001-06 TRAFFIC CONTROL DEVICES
- 780001-01 TYPICAL PAVEMENT MARKINGS
- 781001-02 TYPICAL APPLICATIONS RAISED REFLECTIVE PAVEMENT MARKERS (SNOW-PLOW RESISTANT)
- 886001 DETECTOR LOOP INSTALLATIONS
- 886006 TYPICAL LAYOUTS FOR DETECTION LOOPS

### TRAFFIC DATA

ADT = 6,430 (2006)

### POSTED SPEED LIMIT

35 M.P.H.

MINOR ARTERIAL ROAD

### FOR JOINT UTILITY INFORMATION

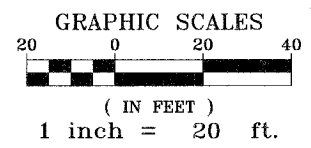

IMPROVEMENT BEGINS  
STA. 10+04  
STRUCKMAN BOULEVARD

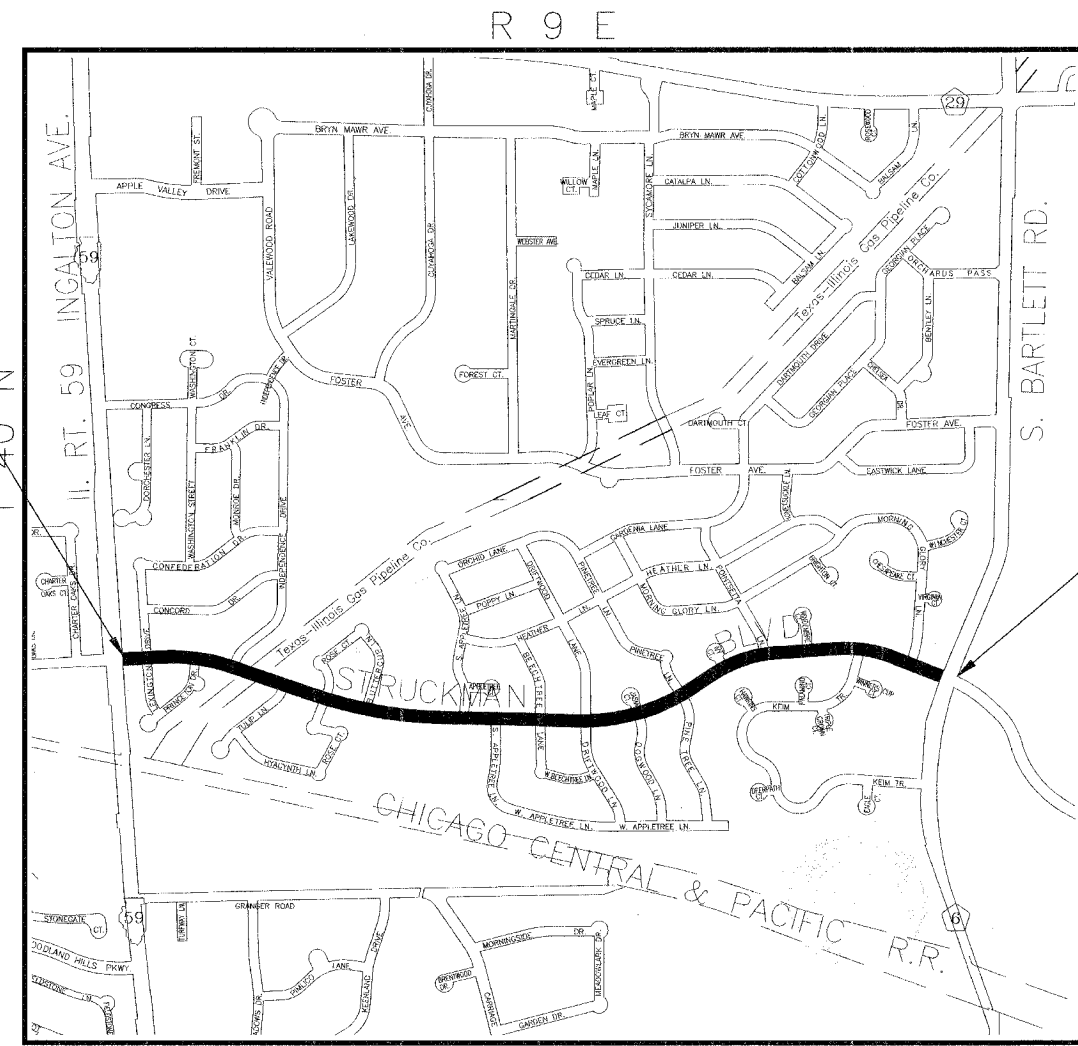

SCALE: NONE

IMPROVEMENT ENDS  
STA. 67+78  
STRUCKMAN BOULEVARD

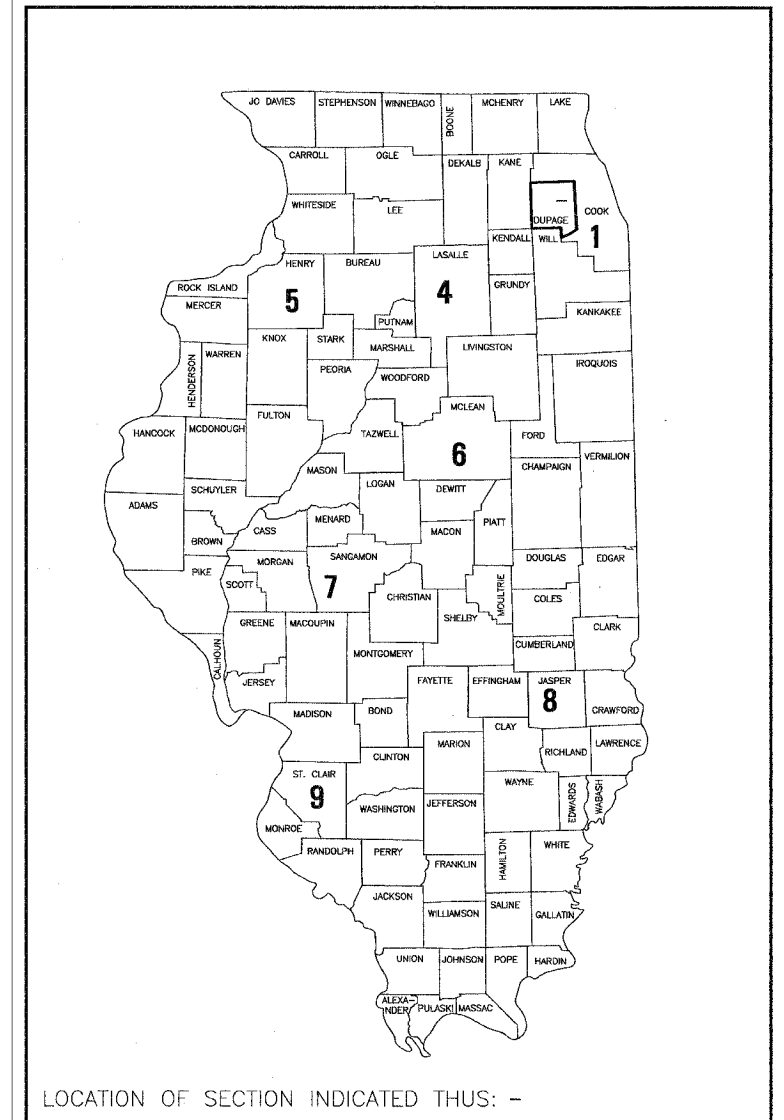

LENGTH OF IMPROVEMENT  
GROSS AND NET PROJECT LENGTH (STRUCKMAN BOULEVARD) = 5774 FEET = 1.094 MILES

|   |   |
|---|---|
| <b>STATE OF ILLINOIS<br/>DEPARTMENT OF TRANSPORTATION</b>   |   |
| APPROVED  | <i>October 9 20 06</i><br><i>[Signature]</i><br>DIRECTOR OF PUBLIC WORKS                      |
| PASSED  | <i>October 31 20 06</i><br><i>[Signature]</i><br>DISTRICT 1 ENGINEER OF LOCAL ROADS & STREETS |
| <i>Retaining for 60 Days on Limited Review</i><br><i>November 1 20 06</i><br><i>[Signature]</i><br>DEPUTY DIRECTOR OF HIGHWAYS, REGION 1 ENGINEER |   |

*[Signature]*  
DALE V. MARTING, P.E.  
No. 062-25264

**PAVIA-MARTING & Co.**  
910 WEST LAKE STREET  
ROSELLE, IL 60172-3352  
(630) 329-8000 FAX (630) 894-8910  
Design Firm Professional Registration #184802376

PMC PROJECT NO. 2812  
PRINTED BY AUTHORITY OF THE STATE OF ILLINOIS

IDOT FEDERAL AID DESIGN ENGINEER: ABIGAIL WILGREEN (847) 705-4233

10/9/2006 11:44 AM F:\2812\Code\2812 - COVER SHEET.DWG

CONTRACT NO: 83879