

LEGEND

- SIGNALIZED INTERSECTION
- 48" X 48" CONSTRUCTION WARNING SIGN WITH AMBER FLASHING LIGHT (NUMBER DENOTES TYPE)
- M4-9 SERIES DETOUR SIGN WITH ROAD NAME & DIRECTION PLATES (NUMBER DENOTES TYPE)
- OTHER DETOUR SIGN (NUMBER DENOTES TYPE)
- TYPE III BARRICADE WITH AMBER FLASHING LIGHTS
- DETOUR ROUTE

SCHEDULE OF SIGNS

SIGN NO.	SIGN TYPE	QUANTITY
1	ROAD CLOSED 500 FT	2
2	DETOUR 500 FT	7
3	DETOUR	16
4	DETOUR	5
5	DETOUR	5
6	DETOUR	3
7	DETOUR	3
8	END DETOUR	2
9	EAST	13
10	WEST	19
11	Monoville Rd	SPECIAL(O)-VAR/9 39
12	DETOUR	M4-10L(O)-4818 2
13	DETOUR	M4-10R(O)-4818 2
14	ROAD CLOSED	R11-2-4830 2
15	ROAD CLOSED 0.5 MILE AHEAD LOCAL TRAFFIC ONLY	R11-3-6030 2
16	ROAD CLOSED 1/3 MILE AHEAD LOCAL TRAFFIC ONLY	R11-3-6030 2
17		R3-2-2424 2
18	EASTBOUND MONAVILLE RD CLOSED TO THRU TRAFFIC USE ILL RTE 132	SPECIAL(O)-6030 2
19	WESTBOUND MONAVILLE RD CLOSED TO THRU TRAFFIC USE ILL RTE 132	SPECIAL(O)-6030 4
20	ROAD CLOSED 1500 FT	W20-3(O)-48 2
21	ROAD CLOSED 1000 FT	W20-3(O)-48 2
22	GOLF COURSE OPEN DURING CONSTRUCTION	SPECIAL(O)-4830 3

TYPICAL INTERSECTION AT POINT OF DETOUR

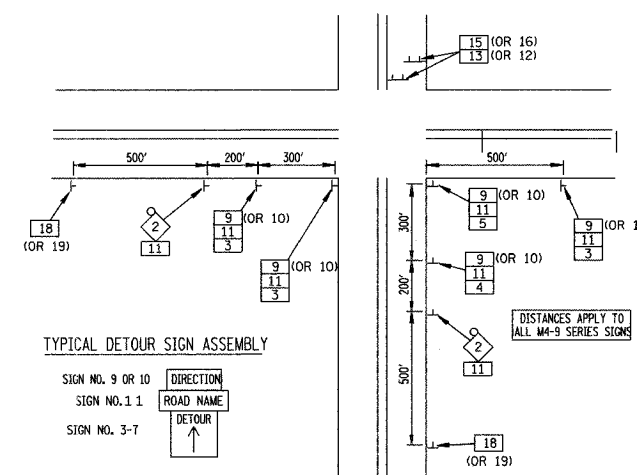

TYPICAL DETOUR SIGN ASSEMBLY

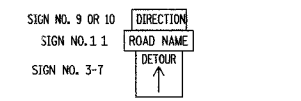

SPECIAL DETOUR NOTES:

1. THE CONTRACTOR SHALL PAY PARTICULAR ATTENTION TO THE DETOUR GENERAL NOTES ON SHEET 12.
2. SEE SHEET 12 FOR INFORMATION ON THE DESIGN AND LOCATION OF THE DETOUR INFORMATION SIGNS.
3. FOURTEEN (14) TYPE III BARRICADES WILL BE NEEDED FOR THIS DETOUR AND ROAD CLOSURE (SEE DETOUR GENERAL NOTE NO. 17). ADDITIONAL TYPE III BARRICADES ARE REQUIRED FOR PATH CLOSURES (SEE SHEETS NO. 7-9).
4. BEFORE AND AFTER THE DETOUR IS IN EFFECT, TRAFFIC CONTROL SHALL BE IN ACCORDANCE WITH THE TRAFFIC CONTROL DETAILS SHOWN ON SHEET NO. 23.
5. THE ROAD CLOSURE AND DETOUR SHALL NOT BEGIN BEFORE JUNE 19, 2007.

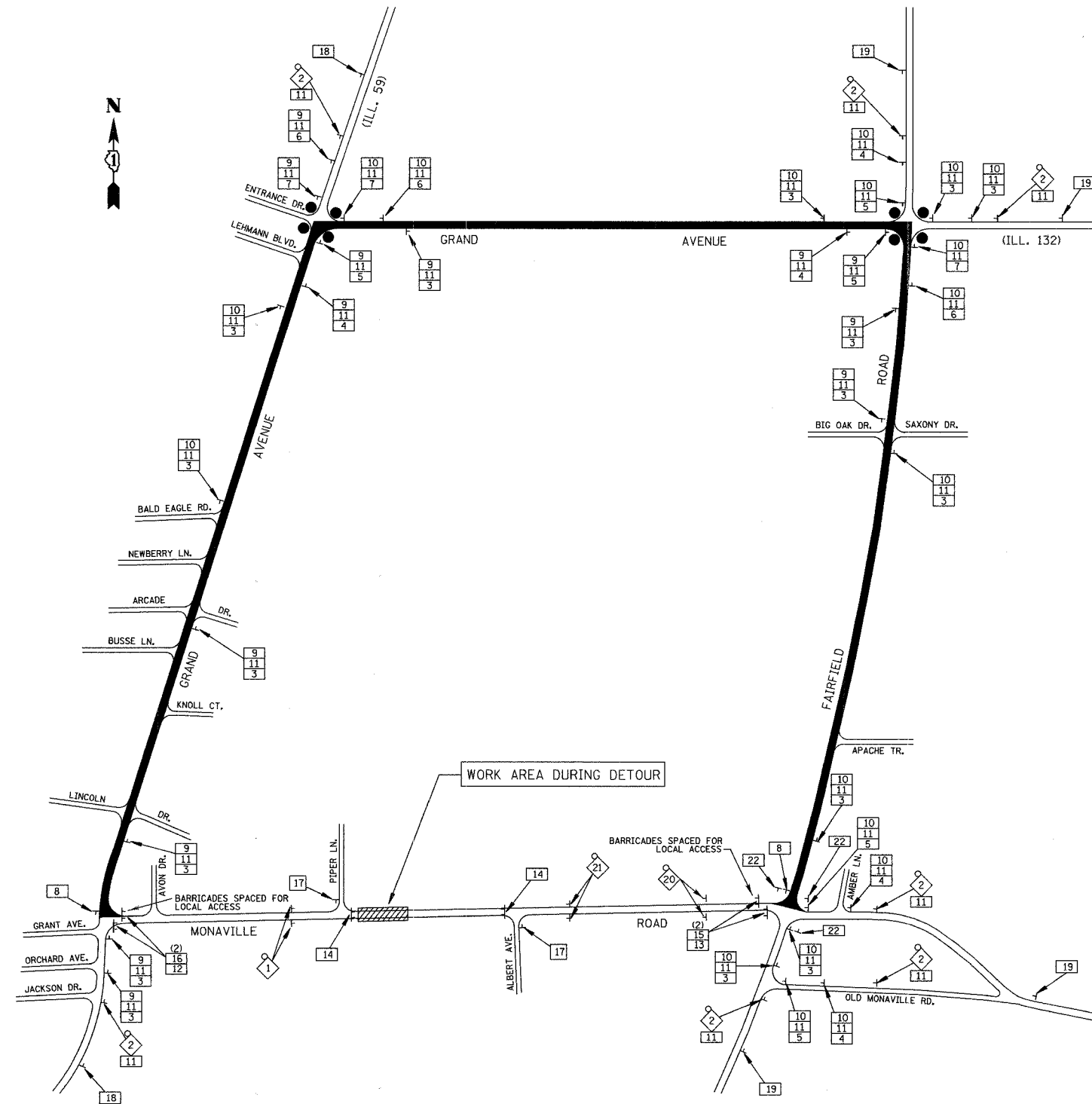

REVISIONS	
NAME	DATE

ILLINOIS DEPARTMENT OF TRANSPORTATION
 MONAVILLE ROAD BIKE PATH UNDERPASS
 DETOUR PLAN
 NOT TO SCALE
 DESIGNED BY: D.J.K.
 CHECKED BY: J.R.V.
 DATE: 10/18/06