

F.A.U. ROUTE NO.	SECTION	COUNTY	TOTAL SHEETS	SHEET NO.
05-00040-00-BT		COOK	10	6
STA.	TO STA.	ILLINOIS	FED AID PROJECT	
FED. ROAD DIST. NO. 1			CMM-8003 (529)	
CONTRACT NO. 83882				

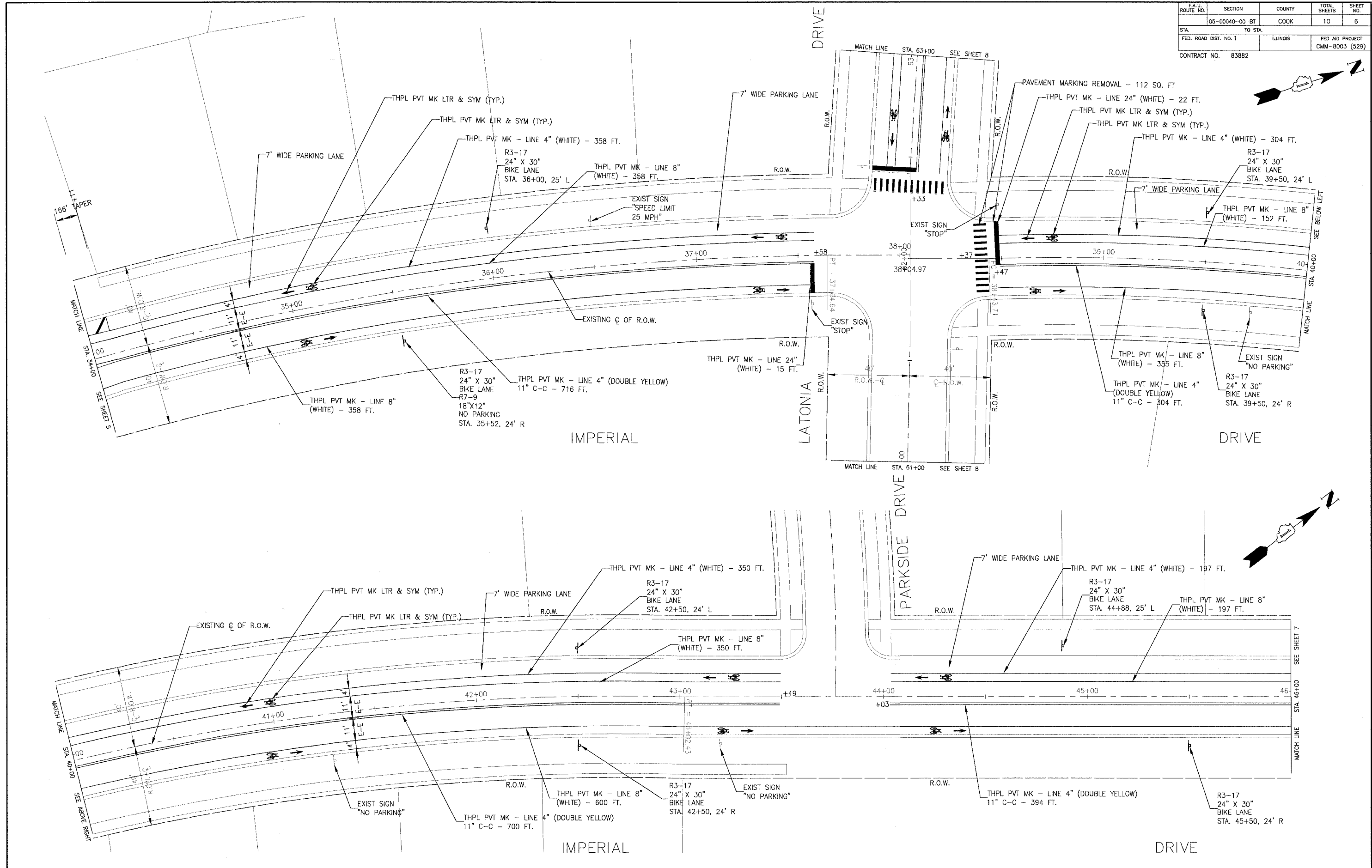
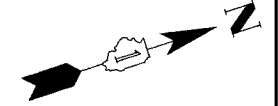

I:\RCHPK\050454-ator\imperial\kcp\DWG\50454\mapin.dwg - 5HT6  
 Plotted: 10-03-06 @ 1:11pm By: 354fjnp  
 Copyright © 2006, By Baxter & Woodman, Inc.  
 State of Illinois - Professional Design Firm  
 License No. - 184-001121 - Expires 4-30-07

CONSULTANTS	REV. NO.	DATE	DESCRIPTION
	1	9-29-06	PER IDOT COMMENTS 9-18-06
	2	10-3-06	PER IDOT COMMENTS 10-2-06

\* - REFER TO EQUIPMENT MANUFACTURER'S SHOP DRAWINGS

**Baxter & Woodman**  
 Crystal Lake, Illinois 815.453.1800  
 Burlington, Wisconsin 262.763.7504  
 Mokena, Illinois 708.478.2090  
 DeKalb, Illinois 815.787.3111  
 Graylake, Illinois 847.233.5088  
 Rockford, Illinois 815.483.1351  
 Plainfield, Illinois 815.603.7425

**VILLAGE OF RICHTON PARK, ILLINOIS**  
**LATONIA LANE/IMPERIAL DRIVE**  
**BIKEWAY**

**IMPERIAL DRIVE**  
**STA. 34+00 TO STA. 46+00**  
**PAVEMENT MARKING PLAN**

DESIGNED BY CAC	SCALE HORIZ. 1" = 20'
DRAWN BY SMS	PROJECT NO. 050454
CHECKED BY NJP	SHEET NO.
DATE 7-28-06	<b>6 OF 10</b>