

FAU ROUTE NO.	SECTION	COUNTY	TOTAL SHEETS	SHEET NO.
05-00040-00-BT	COOK	10	9	
STA.	TO STA.			
FED. ROAD DIST. NO. 1	ILLINOIS	FED AID PROJECT CMM-8003 (529)		
CONTRACT NO. 83882				

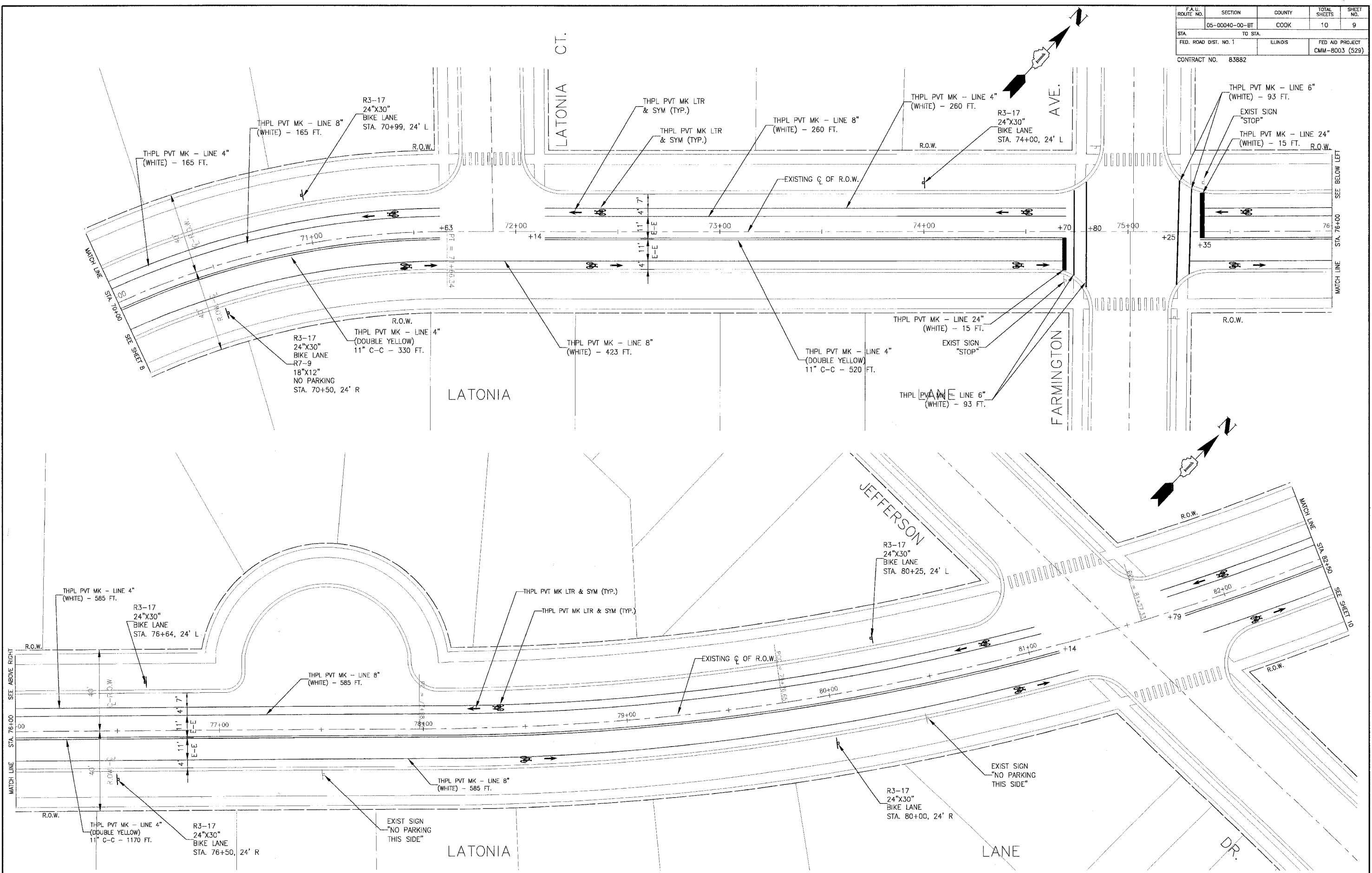

I:\PCHP\A\050454-10e\imperialbikeway\DWG\50454-01p1.dwg - S:\ITD
 Plotted: 10-03-06 @ 1:12pm by: baxter & woodman, inc.
 Copyright © 2005 by Baxter & Woodman, Inc.
 State of Illinois - Professional Design Firm
 License No. 154-00171 - Expires 4-30-07

CONSULTANTS	REV. NO.	DATE	DESCRIPTION
	1	9-29-06	PER IDOT COMMENTS 9-18-06
	2	10-3-06	PER IDOT COMMENTS 10-2-06

* - REFER TO EQUIPMENT MANUFACTURER'S SHOP DRAWINGS

BAXTER & WOODMAN
 Consulting Engineers

Baxter & Woodman
 Crystal Lake, Illinois 815.459.1260
 Burlington, Wisconsin 262.763.7834
 Mokena, Illinois 708.478.2090
 DeKalb, Illinois 815.787.3111
 Grayslake, Illinois 847.233.5088
 Rockford, Illinois 815.489.1551
 Plainfield, Illinois 815.609.7426

VILLAGE OF RICHTON PARK, ILLINOIS
LATONIA LANE/IMPERIAL DRIVE
BIKEWAY

LATONIA LANE
STA. 70+00 TO STA. 82+50
PAVEMENT MARKING PLAN

DESIGNED BY CAC	SCALE HORIZ. 1" = 20'
DRAWN BY SMS	PROJECT NO. 050454
CHECKED BY NJP	SHEET NO.
DATE 7-28-06	9 OF 10