

INDEX OF SHEETS

SHEET NO. 1	COVER SHEET AND SUMMARY OF QUANTITIES
SHEET NO. 2	TABULATION OF QUANTITIES
SHEET NO. 3	TYPICAL CROSS SECTIONS, MAILBOX TURNOUT, ENTRANCE DETAILS, BUTT JOINT AND TAPER DETAILS
SHEET NO. 4	INTERSECTION DETAILS, BARRICADE AND SIGN PLACEMENT MAP

COMMITMENTS: NONE

STANDARDS:

701311-02	LANE CLOSURE TWO LANE, TWO WAY MOVING OPERATIONS - DAY ONLY FOR SPEEDS LESS THAN 45 MPH
702001-06	TRAFFIC CONTROL DEVICES
780001-01	TYPICAL PAVEMENT MARKINGS
BLR 22-4	TYPICAL APPLICATION OF TRAFFIC CONTROL DEVICES TWO LANE, TWO WAY, RURAL, OVER ONE DAY

SUMMARY OF QUANTITIES
CONSTRUCTION CODE 1000

CODE NO.	UNIT	ITEM	QUANTITY
40600100	GALLON	BITUMINOUS MATERIALS (PRIME COAT)	4327.0
40600982	SQ YD	HOT MIX ASPHALT SURFACE REMOVAL - BUTT JOINT	480.0
40800050	TON	INCIDENTAL HOT-MIX ASPHALT SURFACING	287.0
48101200	TON	AGGREGATE SHOULDERS, TYPE B	2798.0
78001100	SQ FT	PAINT PAVEMENT MARKING - LETTERS & SYMBOLS	122.4
78001110	FOOT	PAINT PAVEMENT MARKING 4"	44062.0
78001180	FOOT	PAINT PAVEMENT MARKING 24"	100.0
40603310	TON	HOT-MIX ASPHALT SURFACE COURSE MIX "C", NSO	3117.0
40603080	TON	HOT-MIX ASPHALT BINDER COURSE, IL 19.0 NSO	5420.0
40600625	TON	LEVELING BINDER (MACHINE METHOD), NSO	1775.0
Z0048665	LSUM	RAILROAD PROTECTIVE LIABILITY INSURANCE	1.0
67100100	LSUM	MOBILIZATION	1.0
Δ SPECIALTY ITEMS			

PLANS PREPARED BY:
GEORGE P. MEISTER
COUNTY ENGINEER
REGISTERED PROFESSIONAL ENGINEER
George P. Meister
Reg. No. 62-35783
Exp. Date 11-30-07



J.U.L.I.E. 1-800-892-0123

STATE OF ILLINOIS
DEPARTMENT OF TRANSPORTATION
DIVISION OF HIGHWAYS
PLANS FOR PROPOSED FEDERAL AID
SECONDARY & TRUCK ACCESS ROUTE PROGRAM
FEDERAL AID SECONDARY 372

MARSHALL COUNTY SECTION 05-00087-00-RS
STARK COUNTY SECTION 05-00152-00-RS
JOB #C94-083-06
CONTRACT #89401
PROJECT RS-372(114)

FAS ROUTE NO.	COUNTY	SECTION	CONTRACT	CO. HWY. NO.	SHEET NO.	TOTAL SHEETS
372	MARSHALL	05-00087-00-RS	89401	6	1	4
372	STARK	05-00152-00-RS	89401	2	1	4

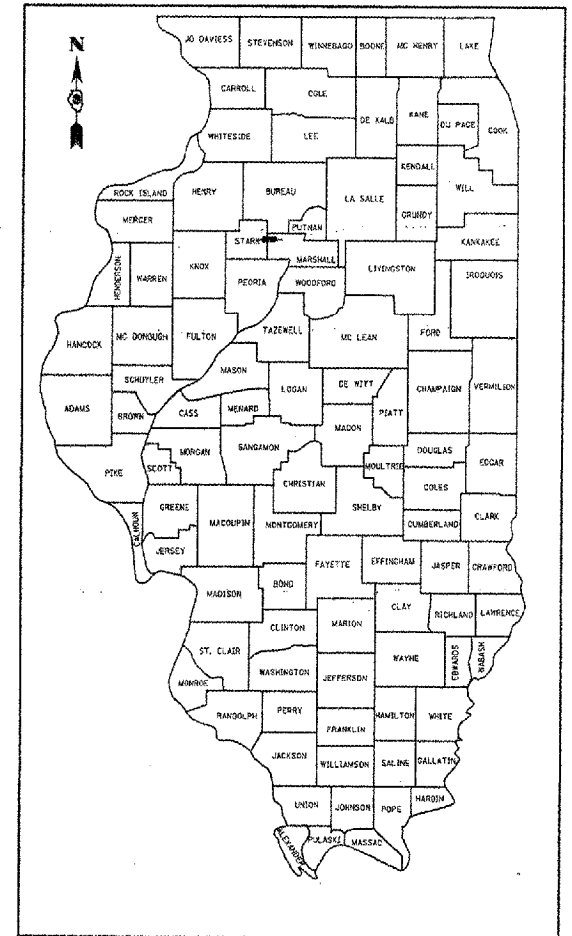

LOCATION OF SECTION INDICATED THUS: —

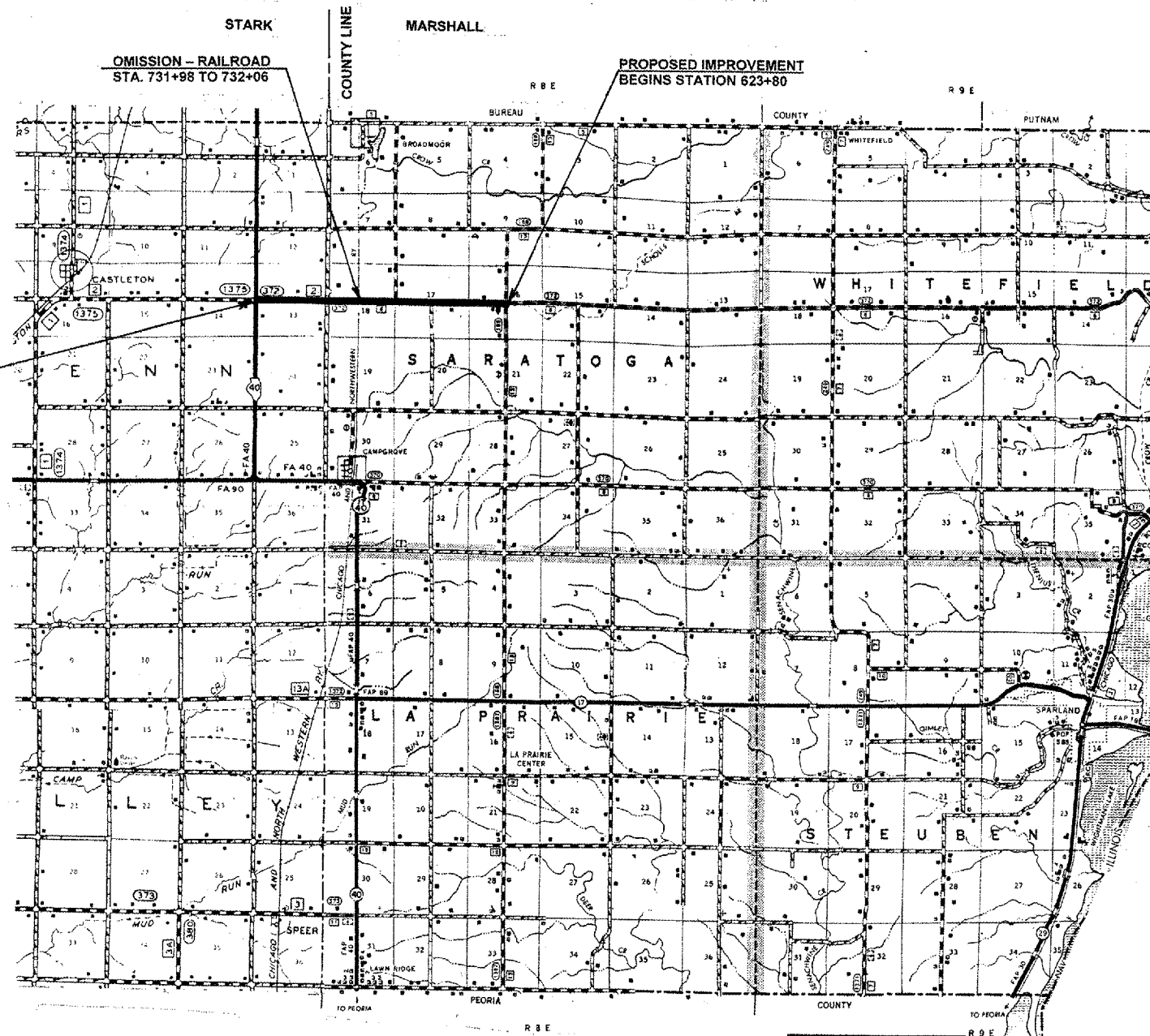

CLASS IV ROAD 20 YEAR DESIGN

	MARSHALL STA 623+80 TO 753+50	STARK STA 753+50 TO 806+70
CURRENT ADT (2000)	350	353
(20 year) DESIGN ADT (2026)	453	453
SDT	387	367
YEAR (2016)	334	334
P.C. 88%	ADT 27	27
S.L. 7%	ADT 27	27
M.L. 7%	ADT 27	27
T.F. =	0.134	0.134
I.B.R. =	3.0	3.0
D _r =	3.04	3.03
Provided	3.27	3.54

PROPOSED BITUMINOUS RESURFACING 1 1/4" SURFACE CSE. 1 1/4" SURFACE CSE.
2 1/4" BINDER CSE. 2 1/4" BINDER CSE.

FUNCTIONAL CLASSIFICATION MAJOR COLLECTOR

APPROVED *Nov 8 2006*
George P. Meister
MARSHALL COUNTY ENGINEER

PASSED *Nov 14 2006*
David E. Foppan
STARK COUNTY ENGINEER

Releasing For Bid Based on Limited Review *Nov 16 2006*
Deputy Director for Highways
REGION THREE ENGINEER

STATE OF ILLINOIS
DEPARTMENT OF TRANSPORTATION

GROSS LENGTH OF SECTION 18,290.00 FEET = 3.4640 MILES
NET LENGTH OF SECTION 18,282.00 FEET = 3.4625 MILES

TABULATION OF QUANTITIES

FAS ROUTE NO.	COUNTY	SECTION	CONTRACT	CO. HWY. NO.	SHEET NO.	TOTAL SHEETS
372	MARSHALL	05-00087-00-RS	89401	6	2	4
372	STARK	05-00152-00-RS	89401	2	2	4

40600100 BITUMINOUS MATERIALS (PRIME COAT)

LOCATION	WIDTH	MARSHALL QUANTITY REQUIRED	STARK QUANTITY REQUIRED
STA. 623+80 TO 753+50 (MAIN LANES)	21.0'	3026.3 GAL	0 GAL
STA. 753+50 TO 806+70 (MAIN LANES)	22.0'	0 GAL	1300.4 GAL
		3026.3 GAL	1300.4 GAL

RATE OF APPLICATION = 0.1 GAL/SQ YD TOTAL 4326.7 GAL (USE 4327 GAL)

40600982 HOT-MIX ASPHALT SURFACE REMOVAL - BUTT JOINT

LOCATION	WIDTH	MARSHALL QUANTITY REQUIRED	STARK QUANTITY REQUIRED
STA. 623+80	VAR	58.33 SQ YD	0 SQ YD
RT STA. 625+72.5	VAR	61.11 SQ YD	0 SQ YD
LT STA. 625+72.5	VAR	61.11 SQ YD	0 SQ YD
STA. 731+98	VAR	58.33 SQ YD	0 SQ YD
STA. 732+06	VAR	58.33 SQ YD	0 SQ YD
STA. 806+70	VAR	0 SQ YD	183.30 SQ YD
		297.21 SQ YD	183.30 SQ YD

TOTAL 480.51 SQ YD (USE 480 SQ YD)

40800050 INCIDENTAL HOT-MIX ASPHALT SURFACING

LOCATION	WIDTH	MARSHALL QUANTITY REQUIRED	STARK QUANTITY REQUIRED
RT STA. 625+72.5 (INTERSECTION)	VAR	36.8 TON	0 TON
LT STA. 625+72.5 (INTERSECTION)	VAR	36.8 TON	0 TON
LT STA. 679+32.5 (INTERSECTION)	VAR	28.5 TON	0 TON
RT STA. 705+50.7 (INTERSECTION)	VAR	28.5 TON	0 TON
RT STA. 753+78.5 (INTERSECTION)	VAR	0 TON	28.5 TON
LT STA. 753+78.5 (INTERSECTION)	VAR	0 TON	28.5 TON
STA. 806+70 (INTERSECTION)	VAR	0 TON	99.5 TON
		130.6 TON	156.5 TON

RATE OF APPLICATION = 112 LB./S.Y./IN. TOTAL 287.10 TON (USE 287 TON)

48101200 AGGREGATE SHOULDERS, TYPE B

LOCATION	WIDTH	MARSHALL QUANTITY REQUIRED	STARK QUANTITY REQUIRED
STA. 623+80 TO 753+50 (MAIN LANES)	3'	1978.4 TON	0 TON
STA. 753+50 TO 806+70 (MAIN LANES)	3'	0 TON	819.7 TON
		1978.4 TON	819.7 TON

RATE OF APPLICATION = 2.08T/C.Y. TOTAL 2798.10 TON (USE 2798 TON)

78001100 PAINT PAVEMENT MARKING-LETTERS AND SYMBOLS

LOCATION	WIDTH	MARSHALL QUANTITY REQUIRED	STARK QUANTITY REQUIRED
RT STA. 728+70	VAR.	61.2 SQ FT	0 SQ FT
LT STA. 735+30	VAR.	61.2 SQ FT	0 SQ FT
		122.4 SQ FT	0 SQ FT

TOTAL 122.4 SQ FT (USE 122.4 SQ FT)

78001110 PAINT PAVEMENT MARKING 4"

LOCATION	WIDTH	MARSHALL QUANTITY REQUIRED	STARK QUANTITY REQUIRED
STA. 623+80 TO 753+50 (EDGE LINES)	4"	25940.0 FT	0 FT
STA. 753+50 TO 806+70 (EDGE LINES)	4"	0 FT	10640.0 FT
STA. 623+80 TO 753+50 (CENTERLINE)	4"	3242.0 FT	0 FT
STA. 753+50 TO 806+70 (CENTERLINE)	4"	0 FT	1330.0 FT
STA. 623+80 TO 753+50 (NO PASSING)	4"	2910.0 FT	0 FT
STA. 753+50 TO 806+70 (NO PASSING)	4"	0 FT	0 FT
		32092.0 FT	11970.0 FT

TOTAL 44062.0 FT (USE 44062.0 FT)

78001180 PAINT PAVEMENT MARKING 24"

LOCATION	WIDTH	MARSHALL QUANTITY REQUIRED	STARK QUANTITY REQUIRED
RT STA. 728+70	24"	33.0 FT	0 FT
LT STA. 735+30	24"	33.0 FT	0 FT
RT STA. 806+50	24"	0 FT	34.0 FT
		66.0 FT	34.0 FT

TOTAL 100.0 FT (USE 100.0 FT)

40603310 HOT-MIX ASPHALT SURFACE COURSE, MIX "C" N50

LOCATION	WIDTH	MARSHALL QUANTITY REQUIRED	STARK QUANTITY REQUIRED
STA. 623+80 TO 731+98 (MAIN LANES)	21.0'	1766.9 TON	0 TON
STA. 732+06 TO 753+50 (MAIN LANES)	21.0'	350.2 TON	0 TON
STA. 753+50 TO 806+70 (MAIN LANES)	22.0"	0 TON	910.3 TON
ENTIRE SECTION (ENTRANCES)	VAR	64.3 TON	21.4 TON
ENTIRE SECTION (MAILBOX TURNOUTS)	VAR	3.6 TON	0 TON
		2185.0 TON	931.7 TON

RATE OF APPL. = 112 LB./S.Y./IN. TOTAL 3116.7 TON (USE 3117 TON)

40603080 HOT-MIX ASPHALT BINDER COURSE, IL-19.0, N50

LOCATION	WIDTH	MARSHALL QUANTITY REQUIRED	STARK QUANTITY REQUIRED
STA. 624+05 TO 731+73 (MAIN LANES)	21.0'	3165.8 TON	0 TON
STA. 732+31 TO 753+50 (MAIN LANES)	21.0'	623.0 TON	0 TON
STA. 753+50 TO 806+45 (MAIN LANES)	22.0'	0 TON	1630.8 TON
		3788.8 TON	1630.8 TON

RATE OF APPL. = 112 LB./S.Y./IN. TOTAL 5419.6 TON (USE 5420 TON)

40600625 LEVELING BINDER (MACHINE METHOD), N50

LOCATION	WIDTH	MARSHALL QUANTITY REQUIRED	STARK QUANTITY REQUIRED
STA. 624+95 TO 731+00 (MAIN LANES)	21.0'	1039.3 TON	0 TON
STA. 733+00 TO 753+50 (MAIN LANES)	21.0'	200.9 TON	0 TON
STA. 753+50 TO 805+55 (MAIN LANES)	22.0'	0 TON	534.4 TON
		1240.2 TON	534.4 TON

RATE OF APPL. = 112 LB./S.Y./IN. TOTAL 1774.6 TON (USE 1775 TON)

FAS ROUTE NO.	COUNTY	SECTION	CONTRACT	CO. HWY. NO.	SHEET NO.	TOTAL SHEETS
372	MARSHALL	05-00087-00-RS	89401	6	3	4
372	STARK	05-00152-00-RS	89401	2	3	4

ENTRANCE DETAIL
SCALE: 1" = 5'

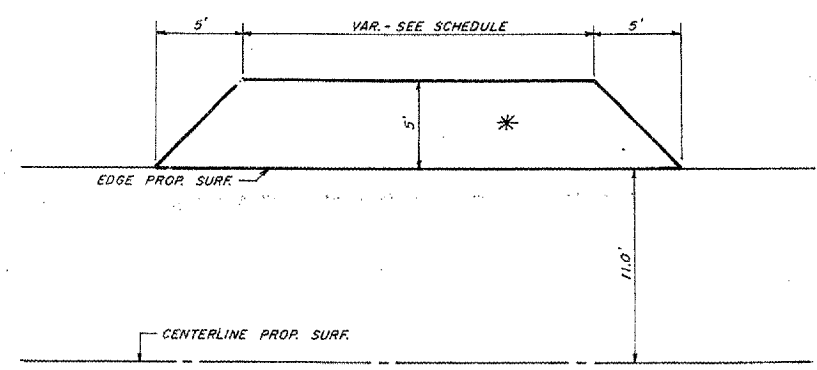

SCHEDULE OF ENTRANCES *
Marshall County

STATION	WIDTH	SQ YDS	TONS MIXT. REQUIRED
LT 627+56	22'	15.0	3.57
LT 629+68	22'	15.0	3.57
RT 632+58	22'	15.0	3.57
LT 633+43	22'	15.0	3.57
LT 639+36	22'	15.0	3.57
RT 642+76	44'	30.0	7.14
RT 652+77	22'	15.0	3.57
RT 666+00	22'	15.0	3.57
LT 666+00	44'	30.0	7.14
LT 681+75	22'	15.0	3.57
RT 685+80	22'	15.0	3.57
LT 704+00	22'	15.0	3.57
LT 710+00	22'	15.0	3.57
RT 710+00	22'	15.0	3.57
LT 724+20	22'	15.0	3.57
RT 724+20	22'	15.0	3.57
		270.0	64.28
		SQ YD	TON

SCHEDULE OF ENTRANCES *
Stark County

STATION	WIDTH	SQ YDS	TONS MIXT. REQUIRED
LT 733+35	22'	15.0	3.57
RT 776+63	22'	15.0	3.57
LT 779+88	22'	15.0	3.57
LT 781+28	22'	15.0	3.57
LT 790+35	22'	15.0	3.57
RT 793+60	22'	15.0	3.57
		90.0	21.42
		SQ YD	TON

*CONSISTS OF 4 1/4" Hot Mix Asphalt SURFACE COURSE, MIX "C" N50

MARSHALL COUNTY PROPOSED TYPICAL CROSS SECTION

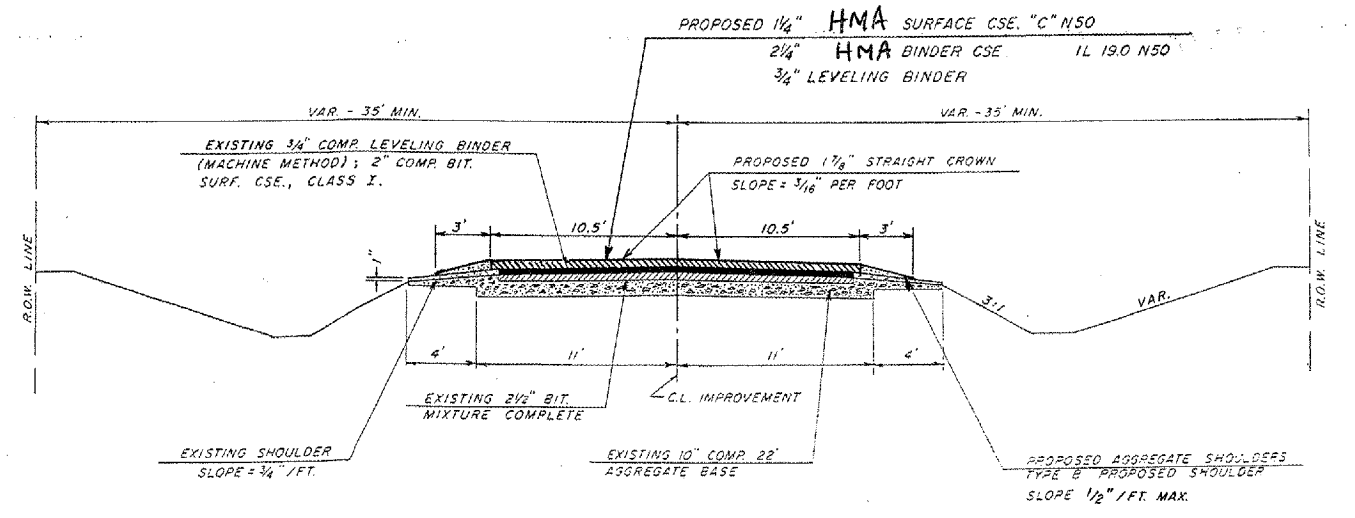

STARK COUNTY PROPOSED TYPICAL CROSS SECTION

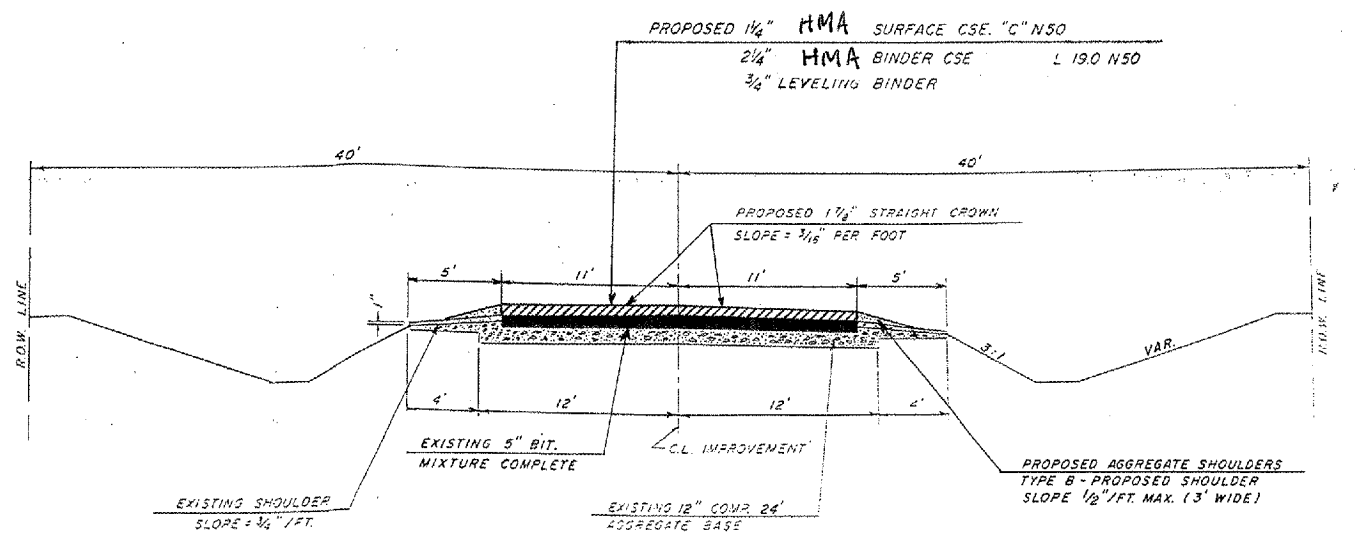

MAILBOX TURNOUT DETAIL
SCALE: 1" = 10'

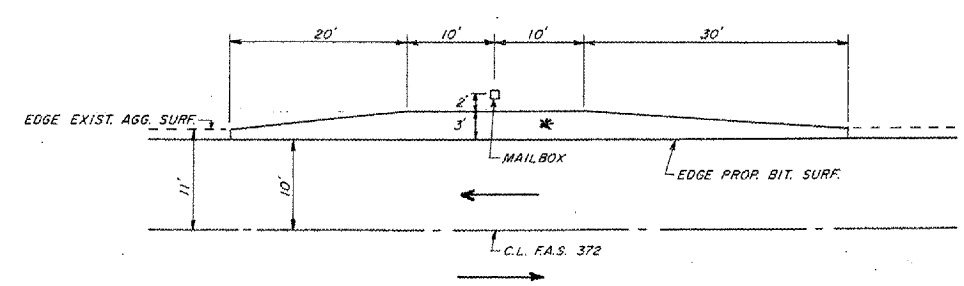

MAILBOX TURNOUTS
Marshall County

STATION	SQ YDS	TONS MIXT. REQUIRED
RT 664+73	15.0	3.57
	15.0	3.57
	SQ YD	TON

*CONSISTS OF 4 1/4" Hot Mix Asphalt SURFACE COURSE, MIX "C" N50

BUTT JOINT & TAPER DETAIL

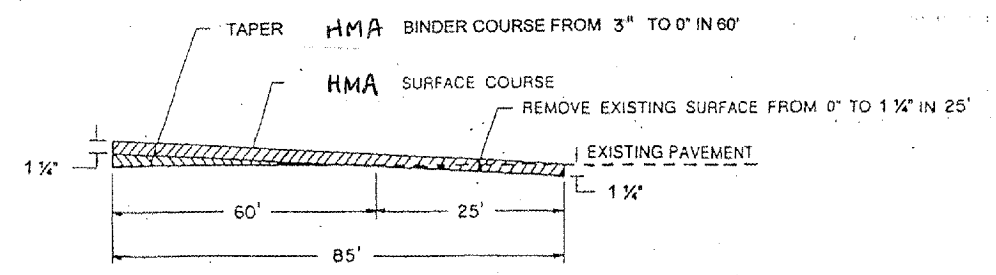

FAS ROUTE NO.	COUNTY	SECTION	CONTRACT	CO. HWY. NO.	SHEET NO.	TOTAL SHEETS
372	MARSHALL	05-00087-00-RS	89401	6	4	4
372	STARK	05-00152-00-RS	89401	2	4	4

BEGINNING INTERSECTION DETAIL
LT. & RT. STA. 625+72.5

Marshall County

Total Area 438.1 SQ YDS
Thickness Required 3" COMP.
▲ Incidental **HMA** Surfacing Required 73.6 TON
* **HMA** Surface Removal-Butt Joint 180.55 SQ YDS

42600982 Hot Mix Asphalt SURFACE REMOVAL - BUTT JOINT

LOCATION
* STA. 623+80
* RT STA. 625+72.5
* LT STA. 625+72.5

WIDTH QUANTITY REQUIRED
VAR 58.33 SQ YD
VAR 61.11 SQ YD
VAR 61.11 SQ YD

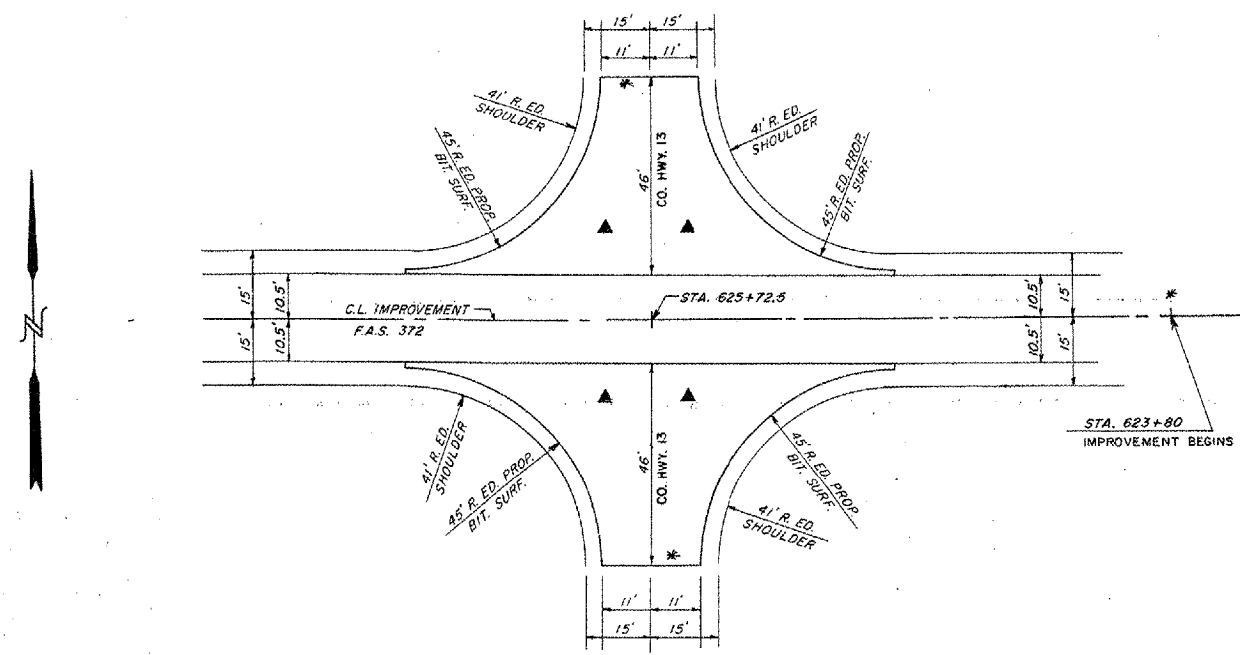

LOCATION MAP SHOWING REQUIRED BARRICADE AND SIGN PLACEMENT

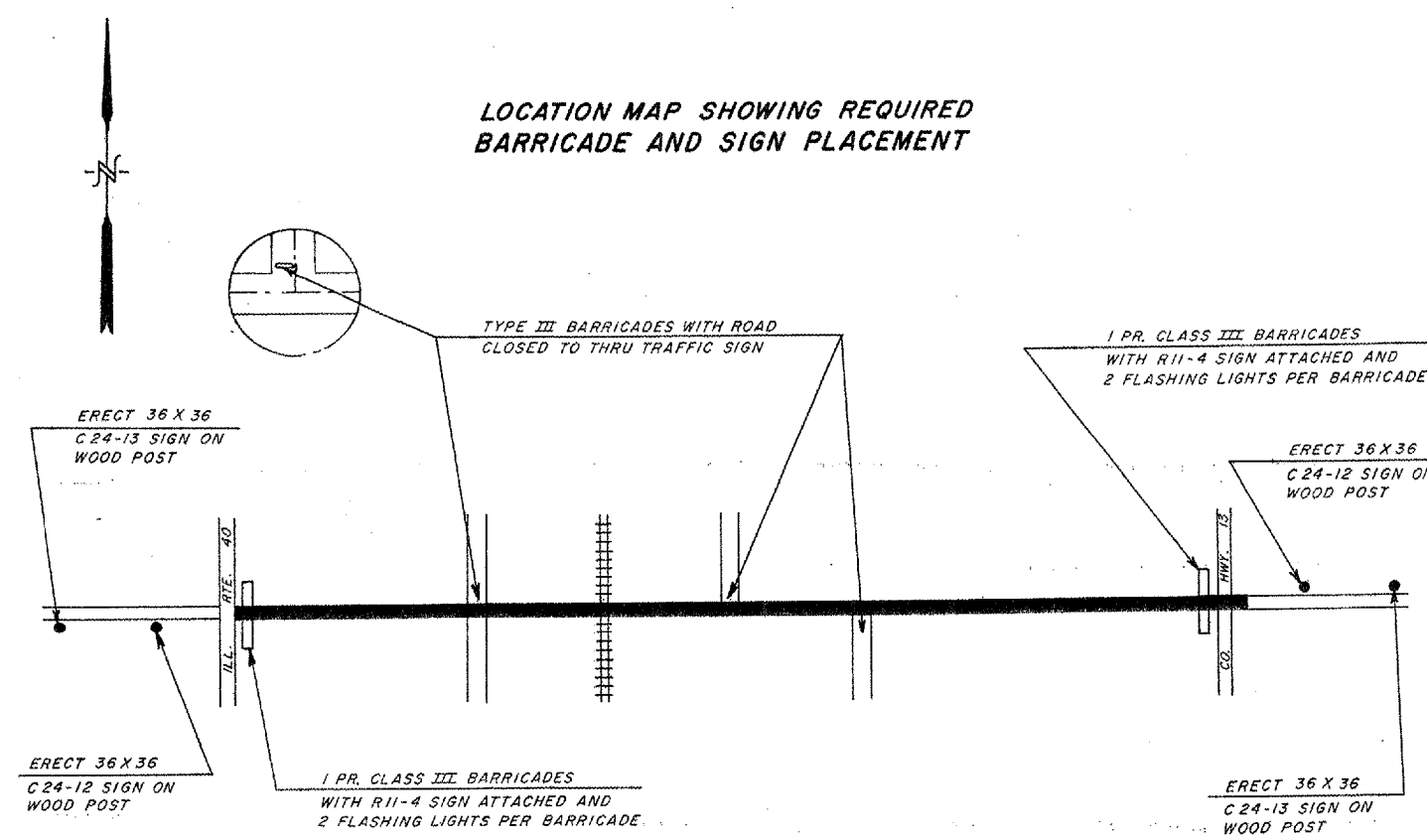

NOTE: REFER TO STANDARD 702001 FOR ERECTION OF SIGNS AND PLACEMENT OF TYPE III BARRICADES. TYPE A LOW INTENSITY LIGHTS ARE REQUIRED ABOVE THE FIRST WARNING SIGN FROM EACH DIRECTION AS PER STANDARD BLR 22-4

NOTE: CONTRACTOR SHALL PLACE TEMPORARY SIGNS ON STATE ROUTE 40 WHENEVER WORKING ON INTERSECTION

SIGN LEGEND

C 24-12	ROAD CLOSED 500 FT.
C 24-13	ROAD CLOSED 1000 FT.
R 11-4	ROAD CLOSED TO THRU TRAFFIC (WHITE)

ENDING INTERSECTION DETAIL
STA. 806+70

Stark County

Total Area 592.5 SQ YDS
Thickness Required 3" COMP.
▲ Incidental **HMA** Surfacing Required 99.5 TON
* **HMA** Surface Removal-Butt Joint 183.3 SQ YDS

NOTE: ANY BASE WIDENING REQUIRED SHALL BE DONE BY STARK COUNTY HIGHWAY FORCES

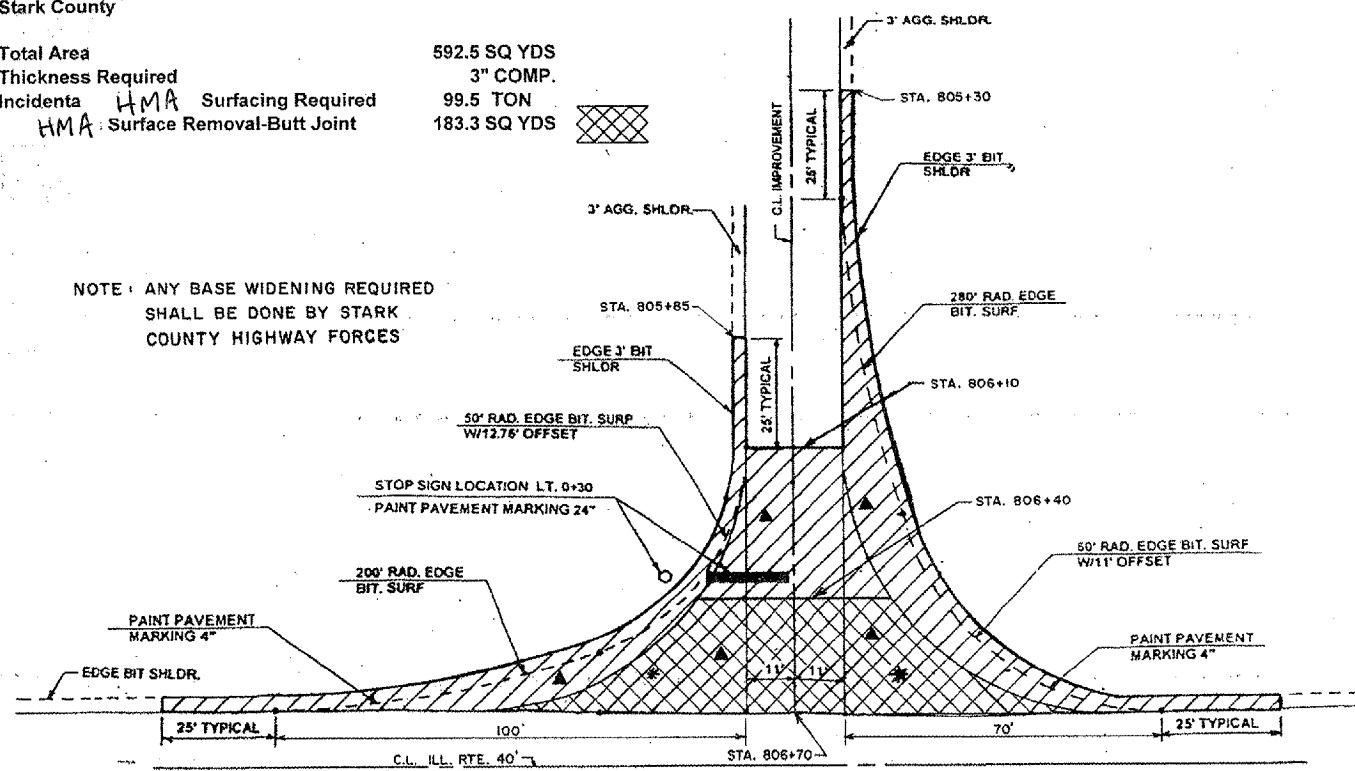

SIDE ROADS

* INCIDENTAL **HMA** SURFACING REQUIRED

STATION	SQ YDS	TONS MIXT. REQUIRED	TONS MIXT. REQUIRED
LT 679+32.5	169.7	28.50	
RT 705+50.7	169.7	28.50	
RT 753+78.5	169.7		28.50
LT 753+78.5	169.7		28.50
	678.8	57.0 TON	57.0 TON

(USE 114 TON)

* CONSISTS OF 3" Hot Mix Asphalt SURFACE COURSE. MIX "C" N50

