

F.A.P. RTE.	SECTION	COUNTY	TOTAL SHEETS	SHEET NO.
709	105BR-5	CHAMPAIGN	31	6
STA. 2074+53		TO STA. 2082+62		
FED. ROAD DIST. NO.		ILLINOIS FED. AID PROJECT		
SEC. 1, T 21 N / SEC. 36, T 22 N, R 8 E, 3rd P.M. CONTRACT 90933				

MATCH LINE STA 2075+00

MATCH LINE STA 2081+40

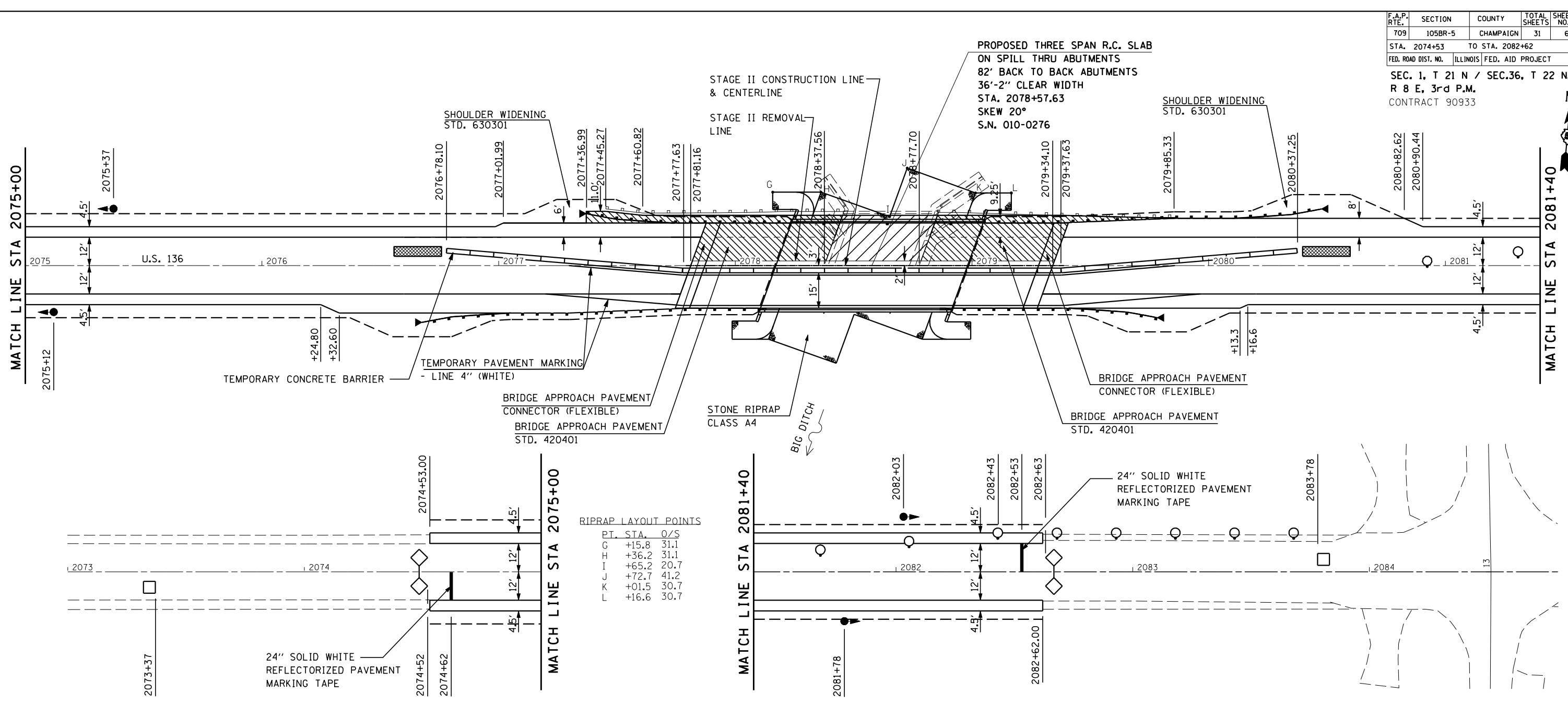

RIPRAP LAYOUT POINTS

PT.	STA.	O/S
G	+15.8	31.1
H	+36.2	31.1
I	+65.2	20.7
K	+72.7	41.2
L	+01.5	30.7
L	+16.6	30.7

TRAFFIC BARRIER TERMINAL, TYPE 6

STATION	TO	STATION	EACH
LT. 2077+93.04		LT. 2078+23.68	1
LT. 2079+04.68		LT. 2079+35.33	1
			TOTAL 2

PAVEMENT REMOVAL

STATION	TO	STATION	SQ. YD.
LT. 2077+81.16		LT. 2078+37.56	63
LT. 2078+77.70		LT. 2079+34.10	63
LT. 2077+36.99		LT. 2078+45.27	5 (B.C.O.)
LT. 2077+45.27		LT. 2077+60.82	7 (B.C.O.)
LT. 2077+60.82		LT. 2077+88.53	10 (B.C.O.)
LT. 2077+88.53		LT. 2078+41.96	48 (B.C.O.)
LT. 2078+82.00		LT. 2079+38.46	58 (B.C.O.)
LT. 2079+38.46		LT. 2079+85.33	9 (B.C.O.)
			TOTAL 263

BRIDGE APPROACH PAVEMENT

STATION	TO	STATION	SQ. YD.
LT. 2077+87.16		LT. 2078+17.16	62
LT. 2078+98.10		LT. 2079+28.10	62
			TOTAL 126

TEMP. PAVEMENT MARKING - LINE 4"

STATION	TO	STATION	FOOT
RT. 2077+20.00		RT. 2080+00.00	280
RT. 2077+30.00		RT. 2079+86.00	256
			TOTAL 536

NOTE: SEE STANDARD 701321 FOR ADDITIONAL INFORMATION

TRAFFIC BARRIER TERMINAL TYPE 1, SPECIAL (FLARED)

STATION	TO	STATION	EACH
LT. 2077+36.99		LT. 2077+74.29	1
LT. 2080+10.33		LT. 2080+47.62	1
			TOTAL 2

BRIDGE APPROACH PAVEMENT CONNECTOR (FLEXIBLE)

STATION	TO	STATION	SQ. YD.
LT. 2077+81.16		LT. 2077+87.16	12
LT. 2079+28.10		LT. 2079+34.10	12
			TOTAL 24

TEMPORARY RAMP

STATION	TO	STATION	SQ. YD.
RT. 2077+71.16		RT. 2077+81.16	20.00
RT. 2079+34.10		RT. 2079+42.10	16.00
RT. 2076+60.00		RT. 2076+65.00	6.75
RT. 2080+15.00		RT. 2080+20.00	6.75
			TOTAL 49.50

STONE RIPRAP, CLASS A4

STATION	TO	STATION	SQ. YD.
2077+98.65		2079+15.61	580
			TOTAL 580

- IMPACT ATTENUATOR, NON-REDIRECTIVE (TEMPORARY), TEST LEVEL 3
- BRIDGE DECK AND SUBSTRUCTURE REMOVAL
- PAVEMENT REMOVAL

STEEL PLATE BEAM GUARDRAIL, TYPE A

STATION	TO	STATION	FOOT
LT. 2077+74.29		LT. 2077+93.04	18.75
LT. 2079+35.33		LT. 2080+10.33	75.00
			TOTAL 93.75

GUARDRAIL REMOVAL

STATION	TO	STATION	FOOT
LT. 2077+45.27		LT. 2078+46.36	101.08
LT. 2078+85.33		LT. 2079+86.58	101.25
			TOTAL 202.33

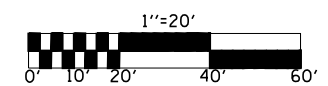

REVISIONS

NAME	DATE

ILLINOIS DEPARTMENT OF TRANSPORTATION
STAGE 2 CONSTRUCTION PLAN
US ROUTE 136 OVER BIG DITCH
FAP RTE. 709 SECTION 105BR-5
CHAMPAIGN COUNTY

SCALE: 1"=20'
DATE 11-2001
DRAWN BY RMH
CHECKED BY MJS



B.C.O. = BASE COURSE OPTION