

RTE.	SECTION	COUNTY	TOTAL SHEETS	SHEET NO.
C.H. 28	*	**	24	9
PROJECT BRS-1741(103)				
* 03-00085-00-BR & 03-00126-00-BR				
** MACOUPIN COUNTY & MONTGOMERY COUNTY				
Sheet 5 of 17				

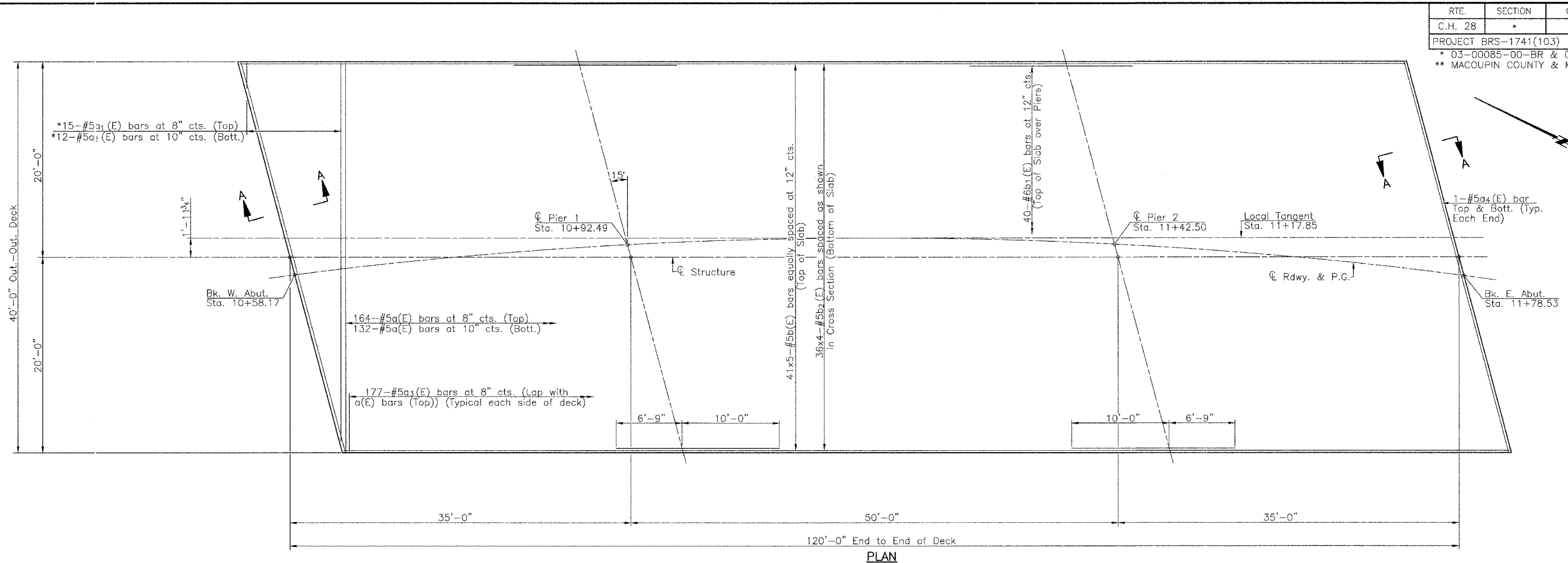

PLAN

Min. Bar Lap
#5 bars = 1'-8"

* Order a1(E) & a2(E) bars full length.
Cut to fit skew and use remainder of bars
in opposite end.

SUPERSTRUCTURE
BILL OF MATERIAL

Bar	No.	Size	Length	Shape
a(E)	296	#5	39'-9"	---
a1(E)	15	#5	40'-10"	---
a2(E)	12	#5	38'-5"	---
a3(E)	354	#5	7'-4"	---
a4(E)	4	#5	41'-1"	---
b(E)	205	#5	25'-8"	---
b1(E)	80	#6	16'-9"	---
b2(E)	144	#5	31'-7"	---
m(E)	10	#6	41'-1"	---
m1(E)	28	#6	8'-8"	---
m2(E)	36	#6	4'-2"	---
m3(E)	4	#6	1'-6"	---
m4(E)	48	#4	5'-2"	---
m5(E)	14	#8	5'-6"	---
s(E)	72	#4	9'-9"	□
s1(E)	60	#4	9'-8"	┌┐
Reinforcement Bars, Epoxy Coated			Pound	30960
Concrete Superstructures			Cu. Yd.	165.8

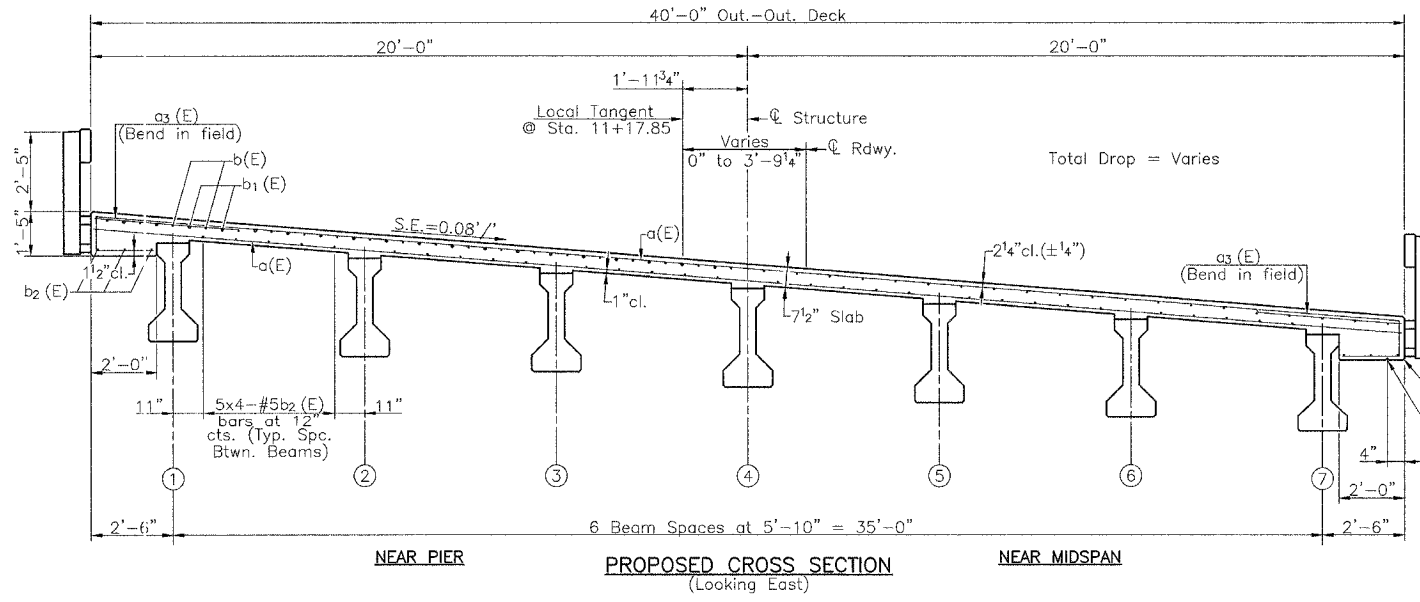

PROPOSED CROSS SECTION
(Looking East)

Notes: See Sheet No. 6 of 17 for Diaphragm Details and Section A-A.
Bars indicated thus 36 x 4-#5 etc. indicates 36 lines of bars with 4 lengths per line.
Reinforcement bars designated (E) shall be epoxy coated.
Reinforcement in the top of the deck may be placed with a 1 1/2" min. clearance in the area of the rail post anchor devices. The studs of the anchor devices shall be placed below the top reinforcement bars and outermost longitudinal reinforcement bar shall be placed directly above the studs of the rail post anchor device.

SUPERSTRUCTURE
C.H. 28 OVER MACOUPIN CREEK
SECTION 03-00085-00-BR
MACOUPIN COUNTY
SECTION 03-00126-00-BR
MONTGOMERY COUNTY