

ROUTE NO.	SECTION	COUNTY	TOTAL SHEETS	SHEET NO.	SHEET NO. 6 17 SHEETS
FAS 1732	*	MACOUPIN	22	9	
FED. ROAD DIST. NO. 7		ILLINOIS	FED. ROAD PROJECT		

*01-00081-00-BR

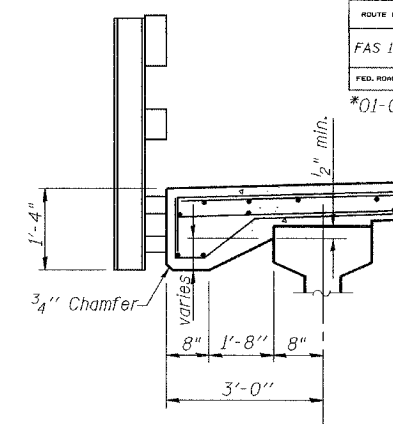
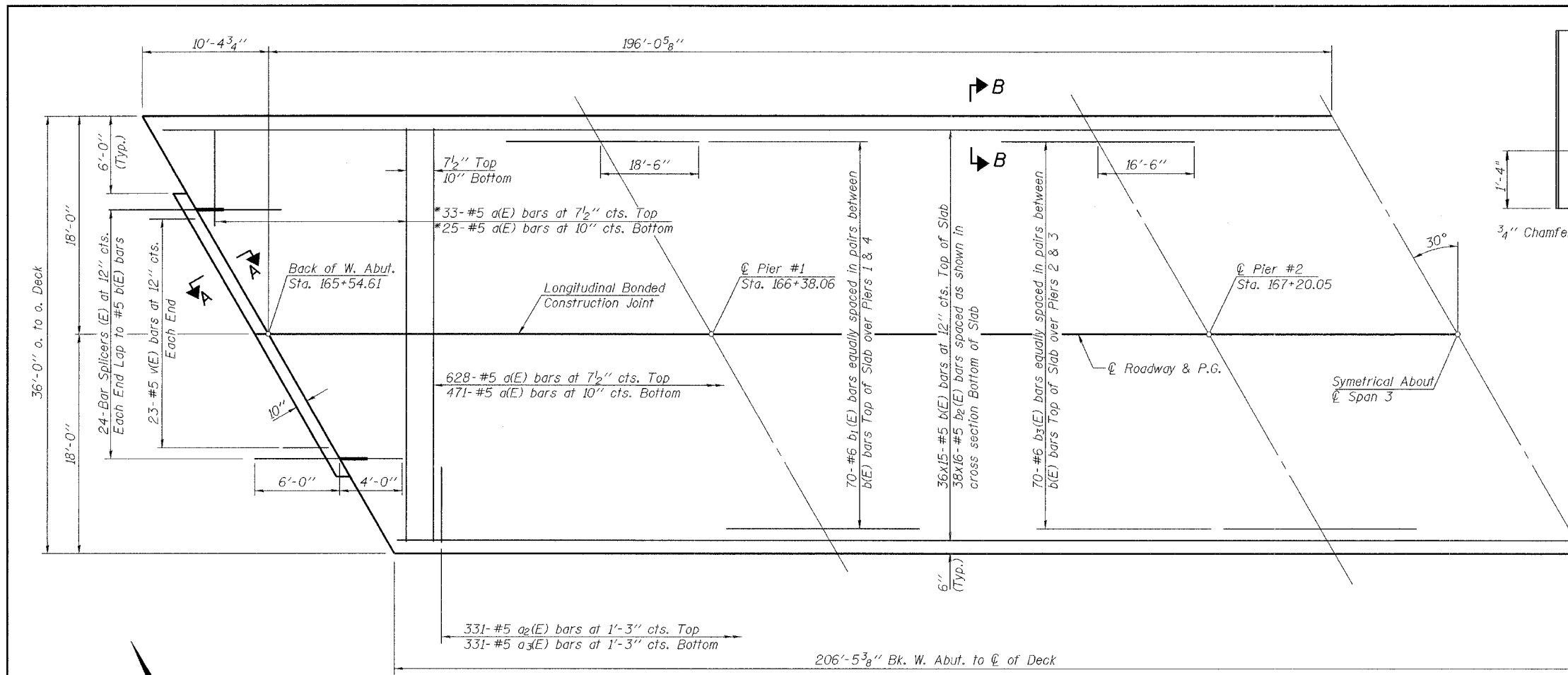

**SUPERSTRUCTURE
BILL OF MATERIAL**

Bar	No.	Size	Length	Shape
a(E)	1157	#5	35'-8"	—
a ₂ (E)	662	#5	5'-0"	—
a ₃ (E)	662	#5	5'-10"	—
b(E)	540	#5	29'-2"	—
b ₁ (E)	140	#6	37'-0"	—
b ₂ (E)	608	#5	27'-6"	—
b ₃ (E)	140	#6	33'-0"	—
m(E)	4	#6	27'-2"	—
m ₁ (E)	12	#6	22'-0"	—
m ₂ (E)	24	#6	9'-8"	—
m ₃ (E)	50	#6	4'-5"	—
m ₄ (E)	4	#6	2'-1"	—
m ₅ (E)	80	#4	6'-0"	—
m ₆ (E)	24	#8	6'-2"	—
s(E)	58	#4	11'-2"	—
s ₁ (E)	42	#5	5'-8"	—
s ₂ (E)	100	#4	10'-7"	—
v(E)	46	#5	3'-3"	—
Reinforcement Bars, Epoxy Coated			Pound	102,620
Concrete Superstructure			Cu. Yd.	459.6
Bar Splicers(E)			Each	48

*a(E) bars shall be ordered full length and cut to fit skew. Use remainder of bar in opposite end.

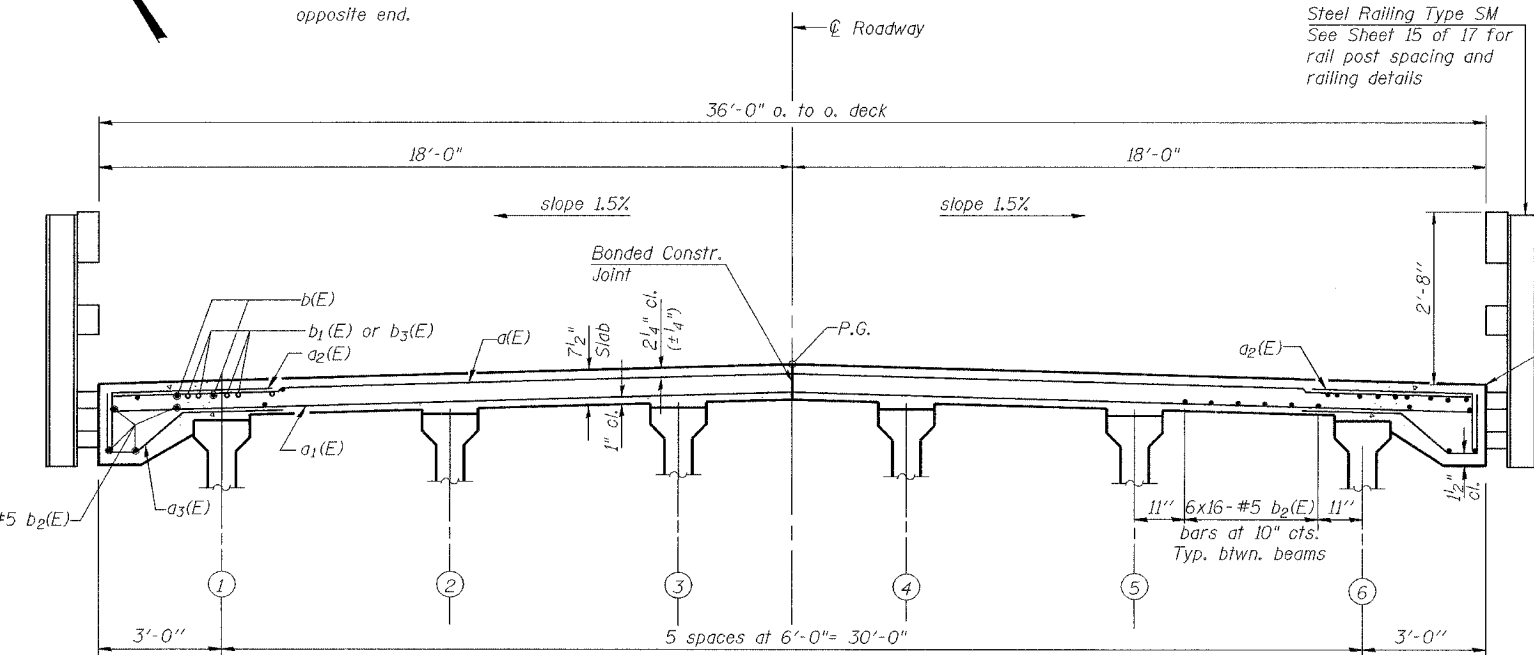

MIN. BAR LAP
#5 bars = 1'-8"

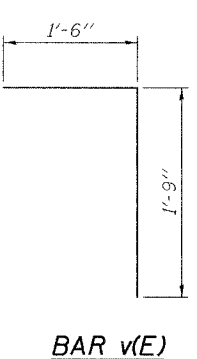
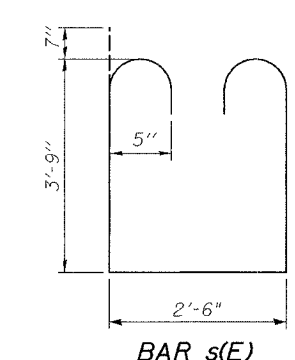
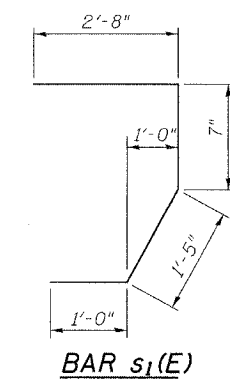
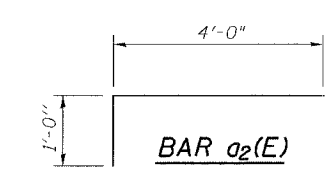
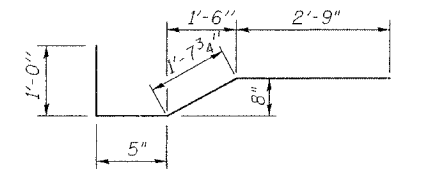

NOTES

Reinforcement bars in the top of the deck shall be placed with a 1/2" minimum clearance in the area of the rail post anchor devices. The studs of the anchor devices shall be placed below the top reinforcement bars and the outermost longitudinal reinforcement bar shall be placed directly above the studs of the rail post anchor device. See sheet #8 of 17 for superstructure details. See sheet #8 of 17 for section A-A & Section B-B. Reinforcement bars designated (E) shall be epoxy coated. Bars indicated thus 6 x 15- #5 etc. indicates 6 lines of bars with 15 lengths per line.

ILLINOIS DEPARTMENT OF TRANSPORTATION	
SHEET TITLE SUPERSTRUCTURE	
PROJECT FAS ROUTE 1732 (COUNTY ROUTE 11) SECTION 01-00081-00-BR MACOUPIN COUNTY STATION 167+61.06 STRUCTURE NUMBER 059-3331	PROJECT NO. 04081 SCALE DATE 07/07/06 DRAWN BY TFG CHECKED BY CB/ML/MCB DRAWING NO.
COOMBE-BLOXDORF P.C. Engineers / Land Surveyors Springfield, Illinois	
Design Firm License No. 184-002703	6 OF 17 SHTS

PLT DATE = 06/29/06
FILE NAME = 01-00081-00-BR-05-001.dwg
PLOT SCALE = 0.10000 1" = 10'
USER NAME = TFG