

# STATE OF ILLINOIS

## DEPARTMENT OF TRANSPORTATION

### DIVISION OF HIGHWAYS

# PLANS FOR PROPOSED HIGHWAY BRIDGE PROGRAM

|                            |                               |                   |                    |                |
|----------------------------|-------------------------------|-------------------|--------------------|----------------|
| ROUTE NO.<br>F.A.S.<br>712 | SECTION<br>02-00104<br>-00-BR | COUNTY<br>FAYETTE | TOTAL SHEETS<br>21 | SHEET NO.<br>1 |
| FED. ROAD DIST. NO.        |                               | ILLINOIS          | FED. AID PROJECT-  |                |

CONTRACT NO. 95469

- INDEX OF SHEETS**
- COVER SHEET
  - SUMMARY OF QUANTITIES, AND GENERAL NOTES
  - TYPICAL CROSS SECTIONS AND QUANTITIES SCHEDULES
  - PLAN AND PROFILE
  - 5.-6. DETOUR PLANS
  - 7.-13. STATION CROSS SECTIONS
  - 14.-20. BRIDGE PLANS
  21. BORINGS

- HIGHWAY STANDARDS**
- 000001-04 STANDARD SYMBOLS, ABBREVIATIONS, AND PATTERNS
  - 515001-02 NAME PLATE FOR BRIDGES
  - 630001-06 STEEL PLATE BEAM GUARDRAIL
  - 630301-03 SHOULDER WIDENING FOR TYPE 1, (SPECIAL) GUARDRAIL TERMINALS
  - 631026-02 TRAFFIC BARRIER TERMINAL, TYPE 5A
  - 635006-02 REFLECTOR AND TERMINAL MARKER PLACEMENT
  - 635011-01 REFLECTOR MARKER AND MOUNTING DETAILS
  - 702001-06 TRAFFIC CONTROL DEVICES
  - BLR 21-6 TYPICAL APPLICATIONS OF TRAFFIC CONTROL DEVICES FOR CONSTRUCTION ON RURAL LOCAL HIGHWAYS

**UTILITIES**

SOUTHWESTERN COOPERATIVE  
525 US ROUTE 40  
GREENVILLE, IL 62446  
(618)664-1025

FRONTIER COMMUNICATION  
801 WEST JACKSON  
ALTAMONT, IL 62411

FAYETTE CO. WATER CO.  
R.R.#1 BOX 714  
BROWNSTOWN, IL 62418

DESIGN FUNCTIONAL CLASSIFICATION: MAJOR COLLECTOR  
DESIGN TRAFFIC: 1550 ADT (2005) 2100 ADT (2025)  
DESIGN POLICIES: 3R  
DESIGN SPEED: 50 M.P.H.  
CONTRACT NO. 95469

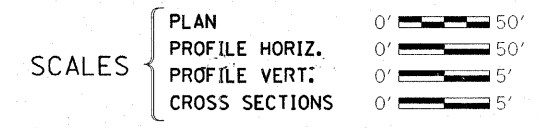

## PROJECT BRS-712(105)

### SECTION 02-00104-00-BR

### FAYETTE COUNTY

## F.A.S. 712 / C.H. 24 OVER ASH CREEK

### C-97-090-02

## PROPOSED STRUCTURE NO. 026-3431

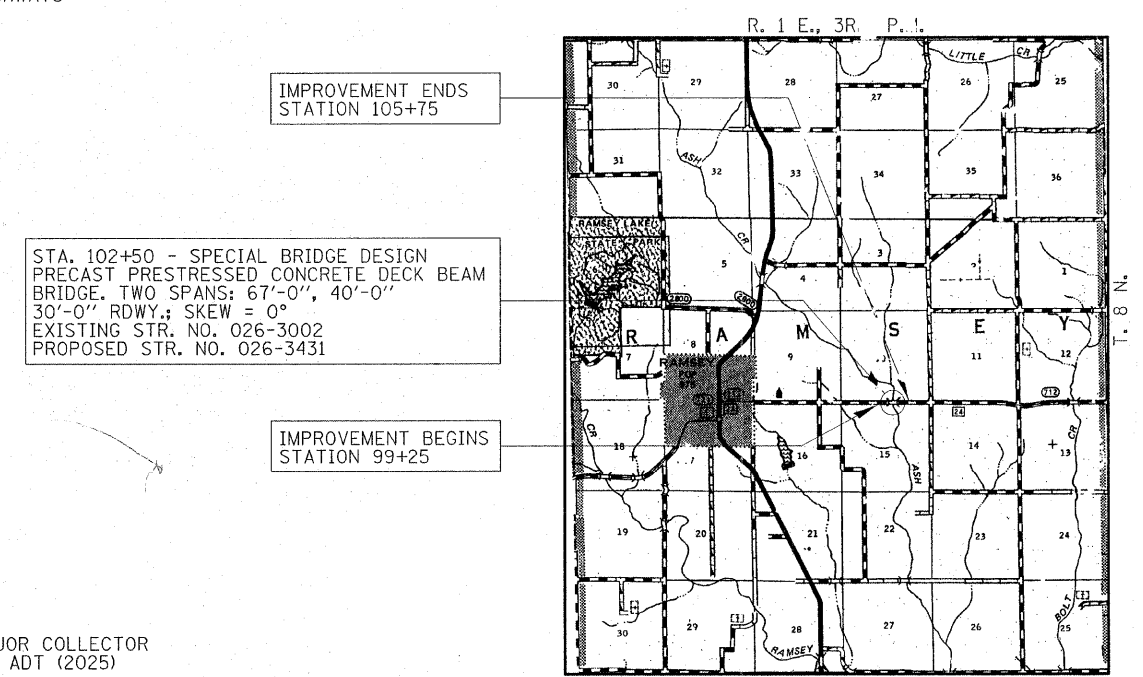
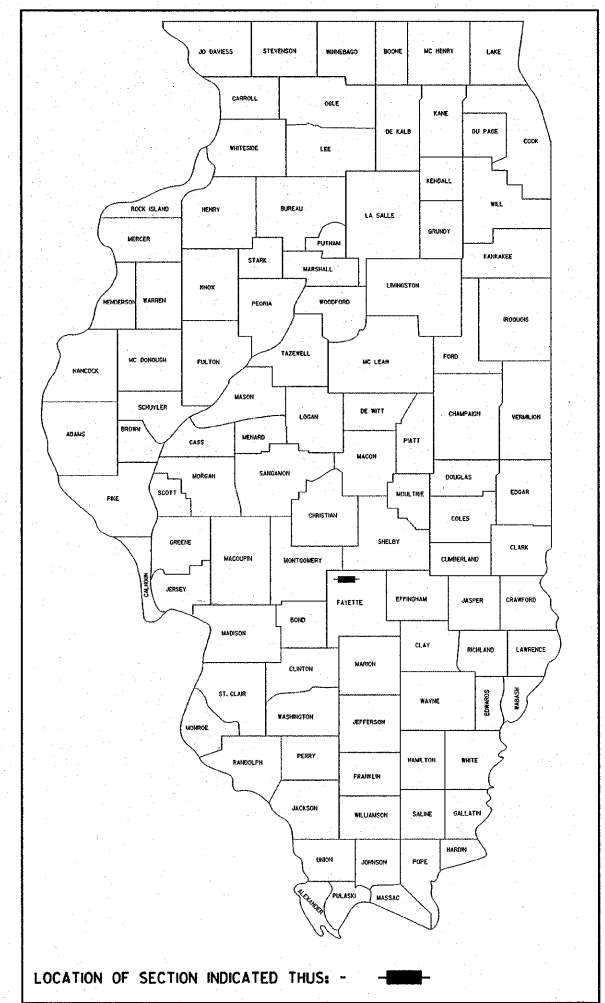

IMPROVEMENT ENDS  
STATION 105+75

STA. 102+50 - SPECIAL BRIDGE DESIGN  
PRECAST PRESTRESSED CONCRETE DECK BEAM  
BRIDGE. TWO SPANS: 67'-0", 40'-0"  
30'-0" RDWY.; SKEW = 0°  
EXISTING STR. NO. 026-3002  
PROPOSED STR. NO. 026-3431

IMPROVEMENT BEGINS  
STATION 99+25

**LAYOUT**

APPROXIMATE SCALE: 0 1 MILE

NET LENGTH OF SECTION = 650 FEET = 0.123 MILES



APPROVED 3-21 20 06  
*Michael A. May*  
COUNTY ENGINEER

PASSED 4-7 20 06  
*Maureen E. Keast*  
DISTRICT SEVEN ENGINEER OF  
LOCAL ROADS & STREETS

Releasing For  
Bid Based on  
Limited Review 4-7 20 06  
*Christine M. Reed*  
DEPUTY DIRECTOR OF HIGHWAYS,  
REGION FOUR ENGINEER  
STATE OF ILLINOIS  
DEPARTMENT OF TRANSPORTATION

DATE: March 14 2006

BY: *Steven W. Megginson*

LICENSE EXPIRES: NOVEMBER 30, 2007

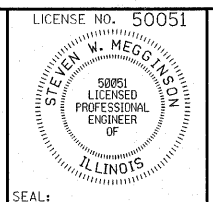

**HLR**

Rice, Berry and Associates  
A Division of Hampton,  
Lenzini and Renwick, Inc.  
Civil & Structural Engineers  
3085 Stevenson Drive  
Suite 201  
Springfield, Illinois 62703  
217-546-3400  
P.O. Box 1036  
DuQuoin, Illinois 62832  
618-790-4637