

ROUTE	SECTION	COUNTY	TOTAL SHEETS	SHEET NO.
CH 16	00-00115-01-BR	MARION	14	3
STA. 6+00.00 TO STA. 15+00.00		ILLINOIS FED. AID PROJECT		

EXISTING STRUCTURE: SINGLE SPAN BRIDGE WITH CAST-IN-PLACE CONCRETE DECK ON STEEL STRINGERS SUPPORTED ON CLOSED CAST-IN-PLACE CONCRETE ABUTMENTS. 22' BK. TO BK. ABUTMENTS, 20' OUT TO OUT OF DECK. EXISTING STRUCTURE NUMBER 061-3017. NO SALVAGE (SEE SPECIAL PROVISIONS)

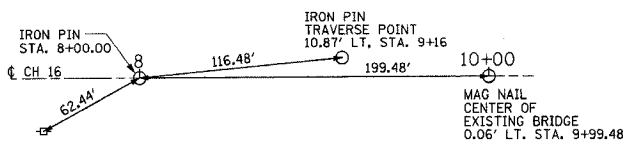

LINE TIES  
P.O.T. STA. 8+00.00

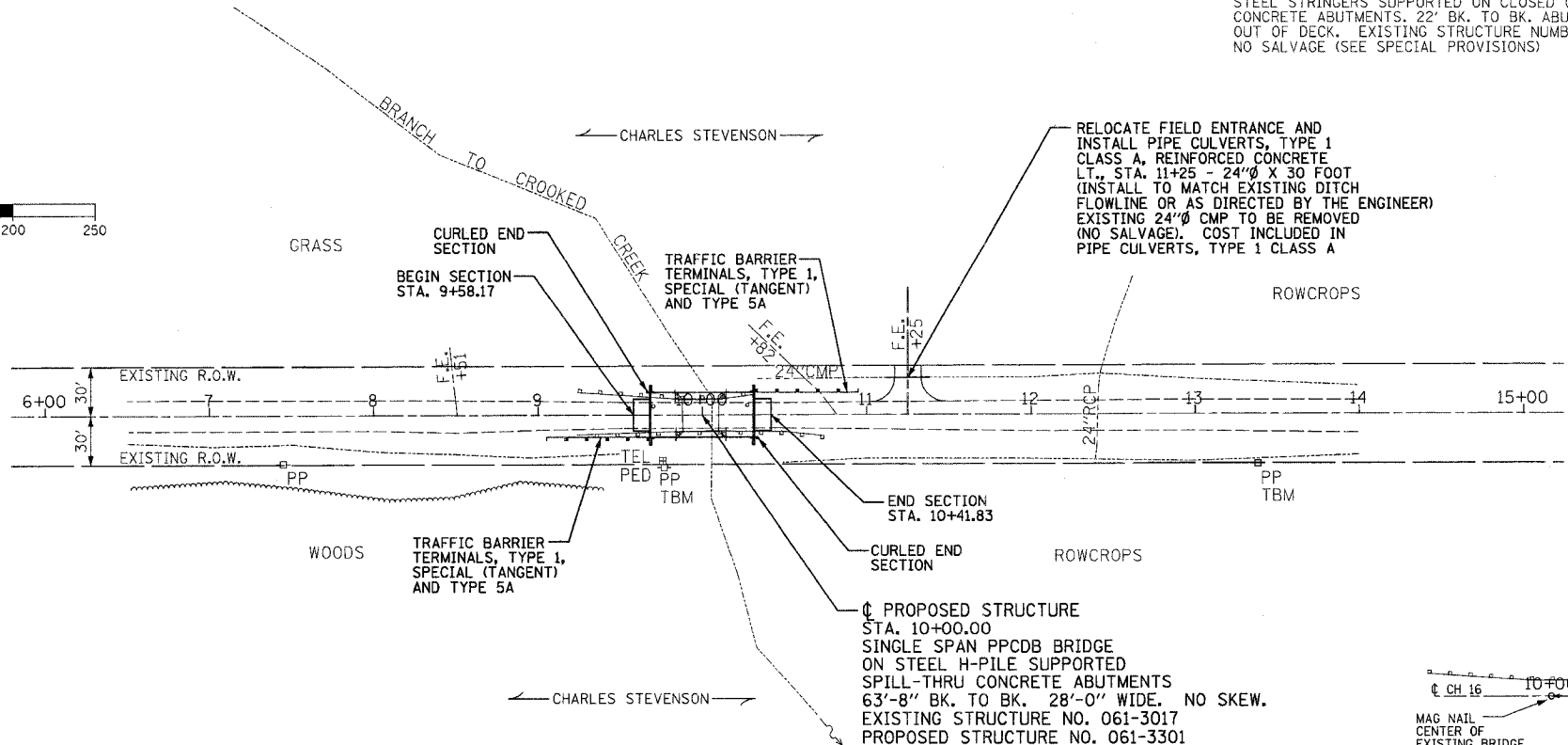
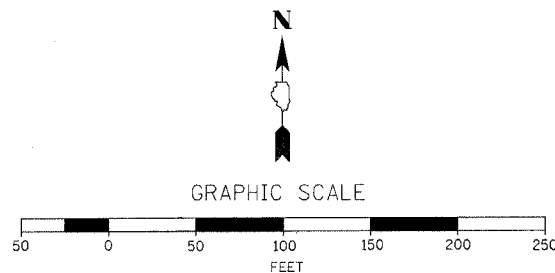
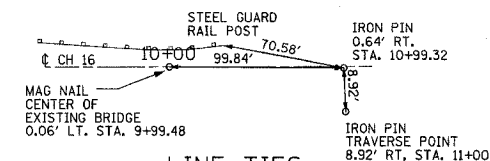

LINE TIES  
P.O.T. STA. 10+99.32

NOTE: ANY REQUIRED EXCAVATION OR EMBANKMENT, INCLUDING NECESSARY SHOULDER WIDENING FOR TRAFFIC BARRIER TERMINALS, CLEARING, GRUBBING, AND TRIMMING SHALL BE CONSIDERED INCIDENTAL TO THE COST OF CHANNEL EXCAVATION.

THE EXISTING RIGHT OF WAY SHOWN HEREON HAS BEEN PROTRACTED FROM EXISTING RECORDS AND IS TO BE USED FOR REFERENCE PURPOSES ONLY. FURTHERMORE, NO COMPLETE SURVEY OF SAID R.O.W. IS IMPLIED BY THIS DRAWING.

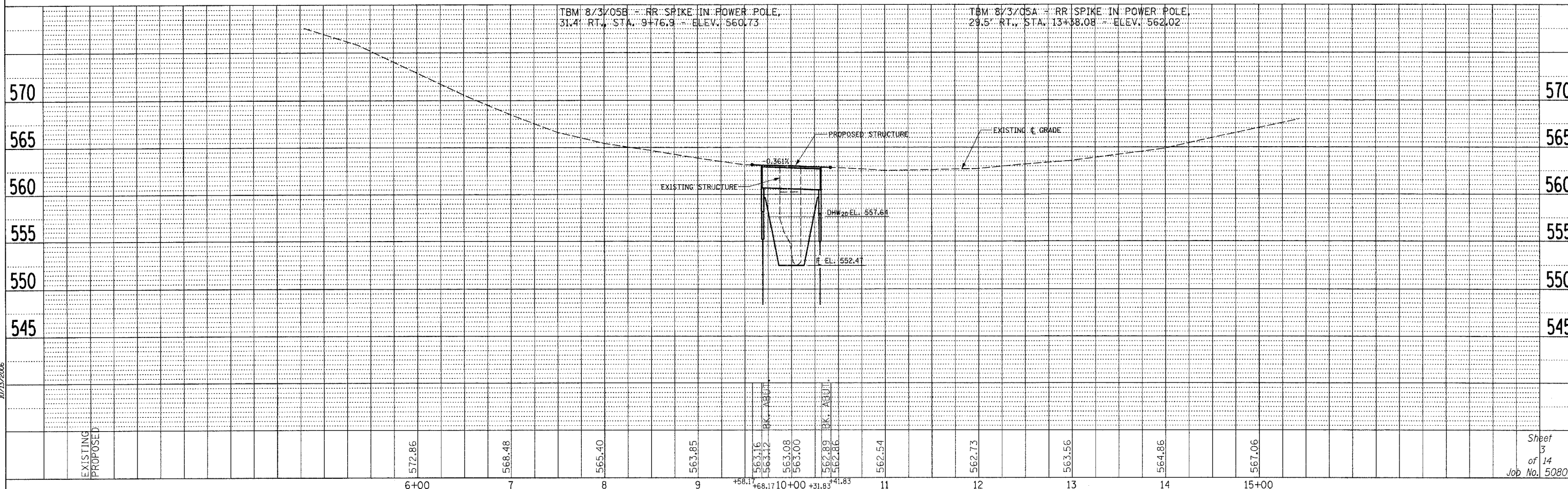

PLAN	DATE
BY	
REVISION	
PLOTTED	
NOTE BOOK	
NO.	

PROFILE	DATE
BY	
REVISION	
PLOTTED	
NOTE BOOK	
NO.	