

ROUTE NO.	SECTION	COUNTY	TOTAL SHEETS	SHEET NO.
F.A.P. 731	*	GREENE	30	10
FED. ROAD DIST. NO.		ILLINOIS	FED. AID PROJECT	
FEDERAL AID PROJECT				

\* 01-00071-00-BR  
**CONTRACT NO. 97289** Sheet No. 6 of 23 Sheets

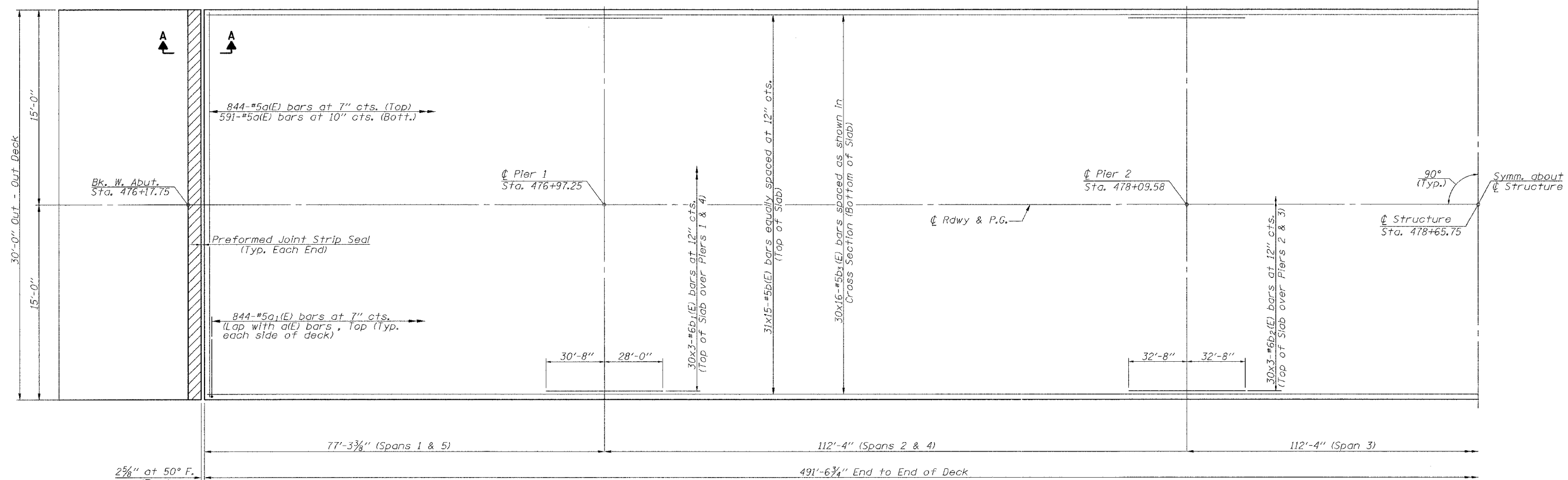

**MIN. BAR LAPS**  
 #5 bars = 1'-8"  
 #6 bars = 2'-0"

**Notes:**  
 See Sheet 7 of 23 for Section A-A, Rail Post Spacing, Deck Pouring Sequence & Bill of Material.  
 Bars indicated thus 31x5-5 etc. indicates 31 lines of bars with 5 lengths per line.  
 Reinforcement in the top of the deck may be placed with a 1/2" min. clearance in the area of the rail post anchor devices. The studs of the anchor devices shall be placed below the top reinforcement bars and outermost longitudinal reinforcement bar shall be placed directly above the studs of the rail post anchor device.  
 Reinforcement bars designated (E) shall be epoxy coated.

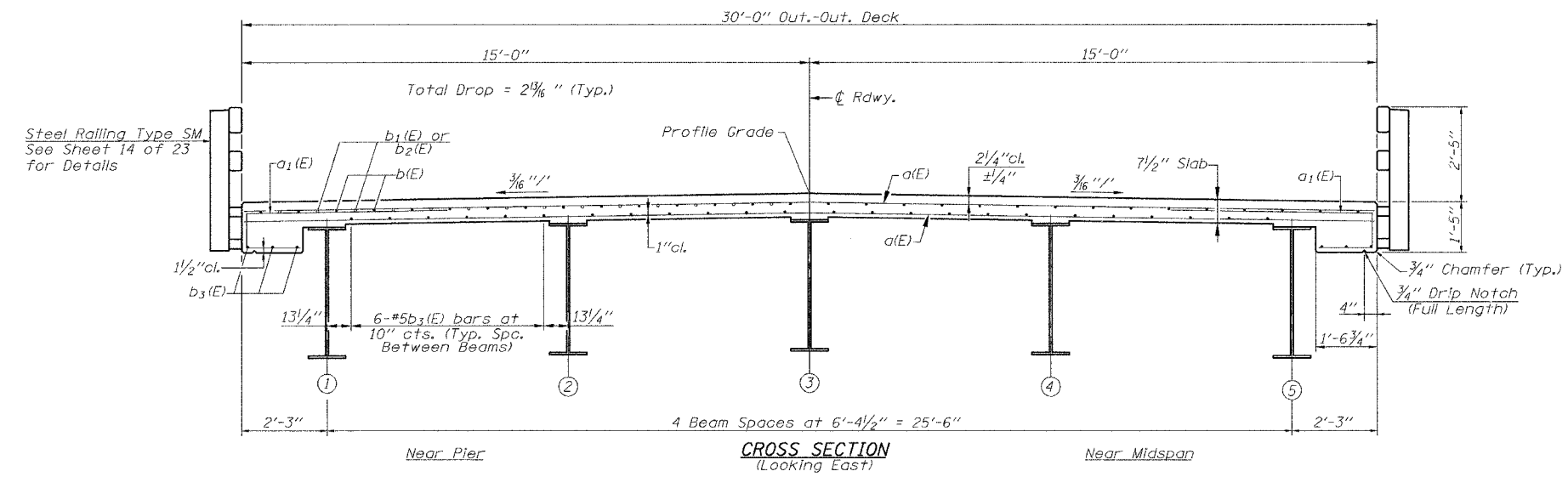

**SUPERSTRUCTURE**  
 F.A.S. 731 - C.H. 2  
 OVER APPLE CREEK  
 SECTION 01-00071-00-BR  
 GREENE COUNTY