

F.A.P. RTE.	SECTION	COUNTY	TOTAL SHEETS	SHEET NO.
331	3-2, 8X-1, 4-2	SALINE	233	56
STA.		TO STA.		
FED. ROAD DIST. NO.		ILLINOIS FED. AID PROJECT		

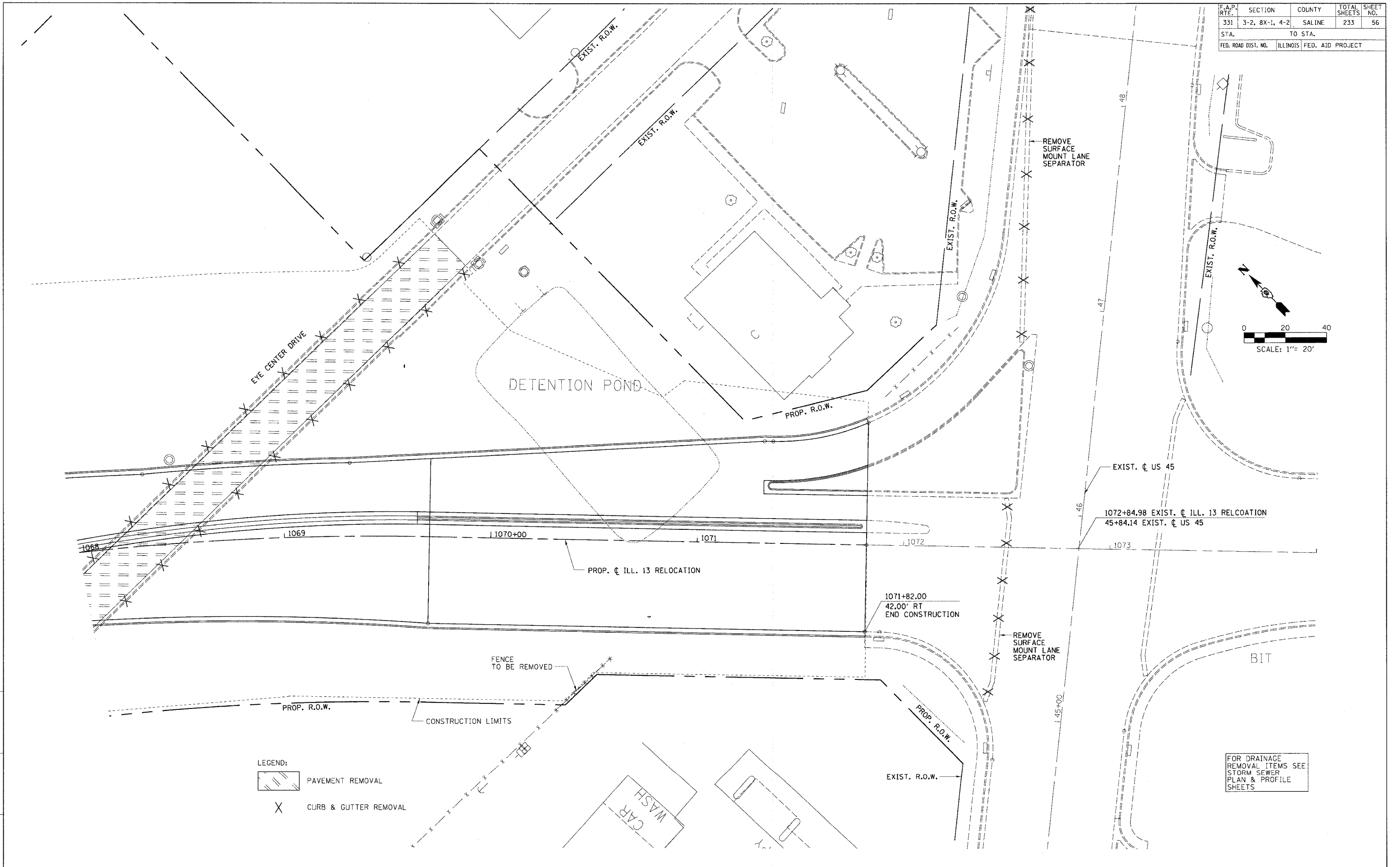

DRAWN BY: IS  
CHECKED BY: JS

PROJECTS/PROJ056/ROADWAY/CONTRACT 1/5 TRIPINIZ
ACT1 File
Reference Files

REMOVAL PLAN - STA. 1068 + 00.00 TO STA. 1071 + 82.00