

FAP R.T.E.	SECTION	COUNTY	TOTAL SHEETS	SHEET NO.
331	3-2, 8X-1, 4-2	SALINE	233	69
STA.	TO STA.			
FED. ROAD DIST. NO.	ILLINOIS FED. AID PROJECT			

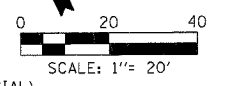

NOTE:  
FOR INTERSECTION GEOMETRY  
SEE GEOMETRICS SHEET 119.

NOTE:  
FOR VETERAN'S DRIVE  
PLAN/PROFILE SEE SHEETS 76.

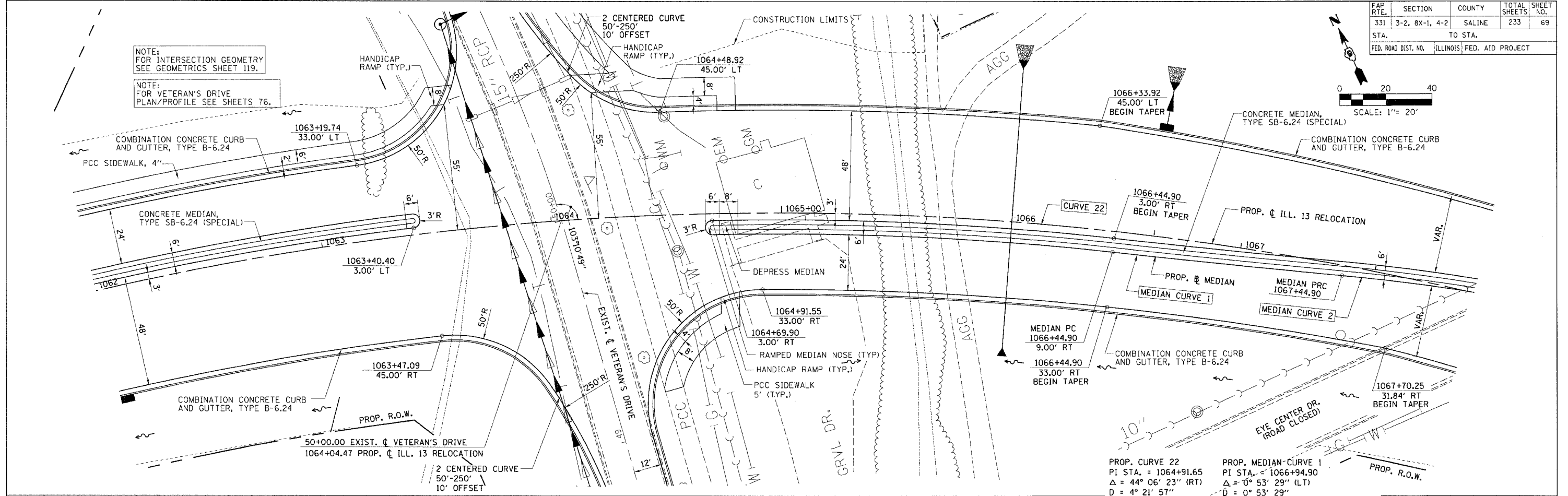

PROP. CURVE 22  
PI STA. = 1064+91.65  
 $\Delta = 44^\circ 06' 23''$  (RT)  
 $D = 4^\circ 21' 57''$   
 $R = 1,312.33'$   
 $T = 531.63'$   
 $L = 1,010.23'$   
 $E = 103.59'$   
 $\theta =$  NORMAL CROWN  
P.C. STA = 1059+60.01  
P.T. STA = 1069+70.25

PROP. MEDIAN-CURVE 1  
PI STA. = 1066+94.90  
 $\Delta = 0^\circ 53' 29''$  (LT)  
 $D = 0^\circ 53' 29''$   
 $R = 6,427.81'$   
 $T = 50.00'$   
 $L = 100.00'$   
 $E = 0.19'$   
P.C. STA = 1066+44.90\*  
P.R.C. STA = 1067+45.33\*  
\* REFERS TO STATIONING RELATIVE TO PROP.  $\phi$  ILL 13 RELOCATION

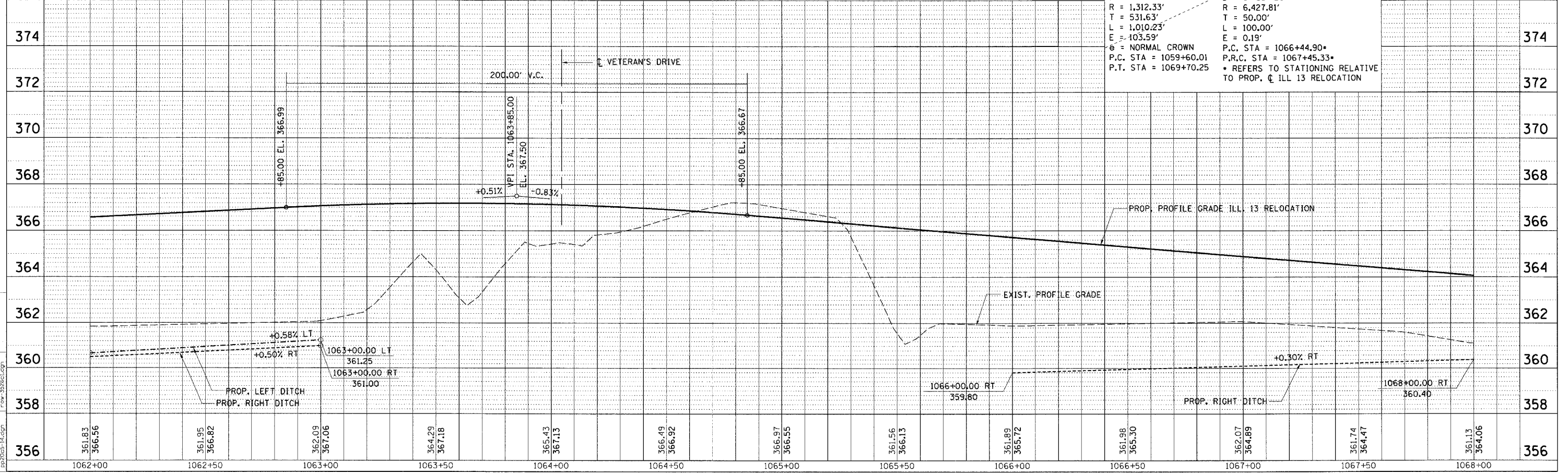

PLAN PROFILE - STA. 1062 + 00.00 TO STA. 1068 + 00.00

DATE: 10/13/2006

BY: [Signature]

REVISIONS:

NO.	DATE	DESCRIPTION
1		ISSUED FOR PERMITS
2		ISSUED FOR CONSTRUCTION

NOTE: ALL DIMENSIONS ARE IN FEET UNLESS OTHERWISE SPECIFIED.

PLAN & PROFILE CHECKED BY: [Signature]

DRAWN BY: [Signature]

DATE: 10/13/2006

BY: [Signature]

REVISIONS:

NO.	DATE	DESCRIPTION
1		ISSUED FOR PERMITS
2		ISSUED FOR CONSTRUCTION

NOTE: ALL DIMENSIONS ARE IN FEET UNLESS OTHERWISE SPECIFIED.

PROJECT: PROJ. 0526 ROADWAY/COMMON

FILE: 1062-1068.dgn

DATE: 10/13/2006

BY: [Signature]

REVISIONS:

NO.	DATE	DESCRIPTION
1		ISSUED FOR PERMITS
2		ISSUED FOR CONSTRUCTION