

FAP RTE.	SECTION	COUNTY	TOTAL SHEETS	SHEET NO.
331	3-2, 8X-1, 4-2	SALINE	233	96
STA.	TO STA.			
FED. ROAD DIST. NO.	ILLINOIS FED. AID PROJECT			

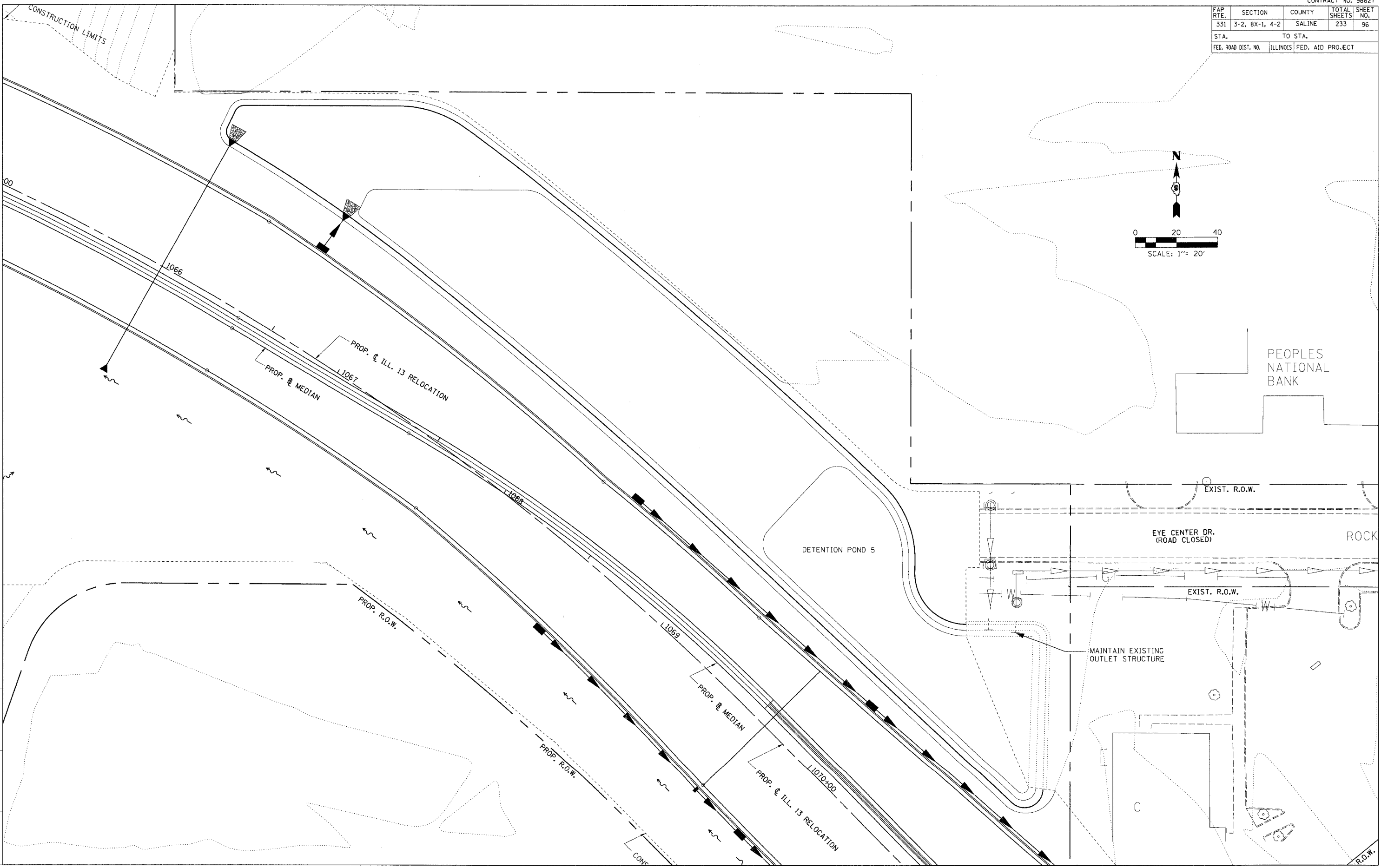
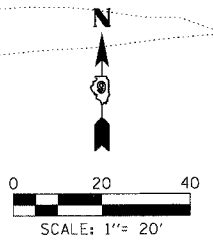

DRAWN BY
CHECKED BY

M:\PROJECTS\PROJ3526\ROADWAY\COMMON\
NOTICE TO PROCEED
FILE
ACT

GRADING PLAN - DETENTION POND 5