

CONTRACT NUMBER	COUNTY	TOTAL SHEETS	SHEET NO.
GR002	BOND	30	6

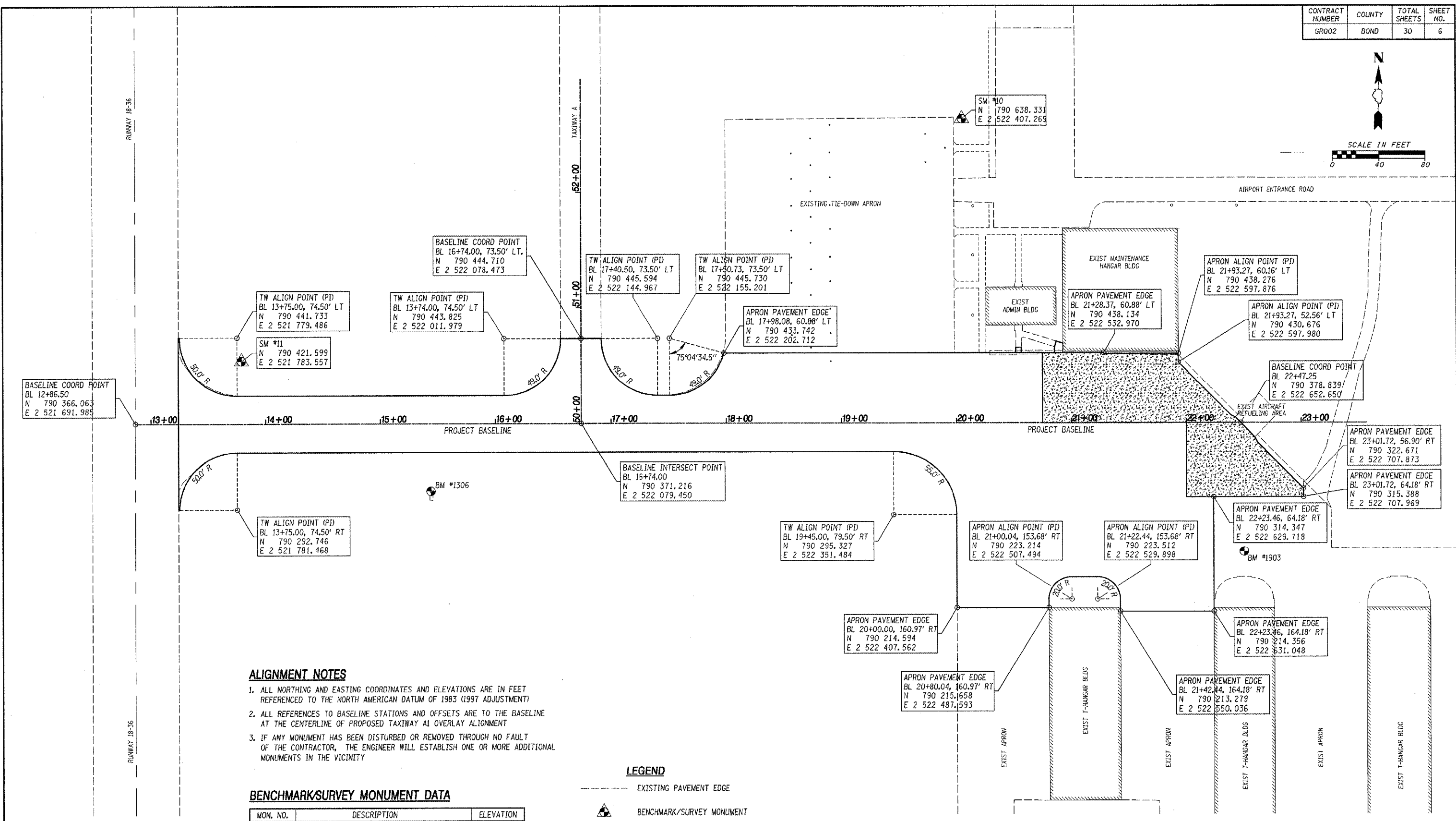
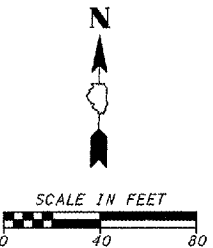

**ALIGNMENT NOTES**

1. ALL NORTHING AND EASTING COORDINATES AND ELEVATIONS ARE IN FEET REFERENCED TO THE NORTH AMERICAN DATUM OF 1983 (1997 ADJUSTMENT)
2. ALL REFERENCES TO BASELINE STATIONS AND OFFSETS ARE TO THE BASELINE AT THE CENTERLINE OF PROPOSED TAXIWAY A1 OVERLAY ALIGNMENT
3. IF ANY MONUMENT HAS BEEN DISTURBED OR REMOVED THROUGH NO FAULT OF THE CONTRACTOR, THE ENGINEER WILL ESTABLISH ONE OR MORE ADDITIONAL MONUMENTS IN THE VICINITY

**LEGEND**

- EXISTING PAVEMENT EDGE
- ▲ BENCHMARK/SURVEY MONUMENT
- PROPOSED BASELINE/CENTERLINE
- ▨ EXISTING BUILDINGS
- ▩ PROPOSED PCC PAVEMENT AREA
- PROPOSED AC PAVEMENT AREA

**BENCHMARK/SURVEY MONUMENT DATA**

MON. NO.	DESCRIPTION	ELEVATION
SM 10	5/8" IRON ROD WITH CAP N 790 638.331 E 2 522 407.269	537.715
SM 11	NGS CONTROL POINT (GPS) 1/2" STEEL ROD IN ALUMINUM CASING N 790 421.599 E 2 521 783.557	533.503
BM 1903	PAINTED "+" S.E. COR. INLET TOP	535.800
BM 1306	CHISELED "X" N.W. COR. CONCRETE HOLD SIGN PAD ON SOUTH SIDE TW A1	533.981

DATE	DESCRIPTION OF THE REVISIONS	BY
09-20-06	REVISED AND REPACKAGED FOR JAN. '07 LETTING	RGH

GREENVILLE AIRPORT AUTHORITY GREENVILLE, ILLINOIS

**HORIZONTAL ALIGNMENT AND MONUMENT LOCATIONS**

IL PROJ. NO.	GRE-3215
A.I.P. PROJ. NO.	3-17-0049-B4
FILE NAME	GA-HALIGN
DATE	01-19-2007

H.M.G. NO. 5636