

CONTRACT NUMBER	COUNTY	TOTAL SHEETS	SHEET NO.
GRO02	BOND	30	10

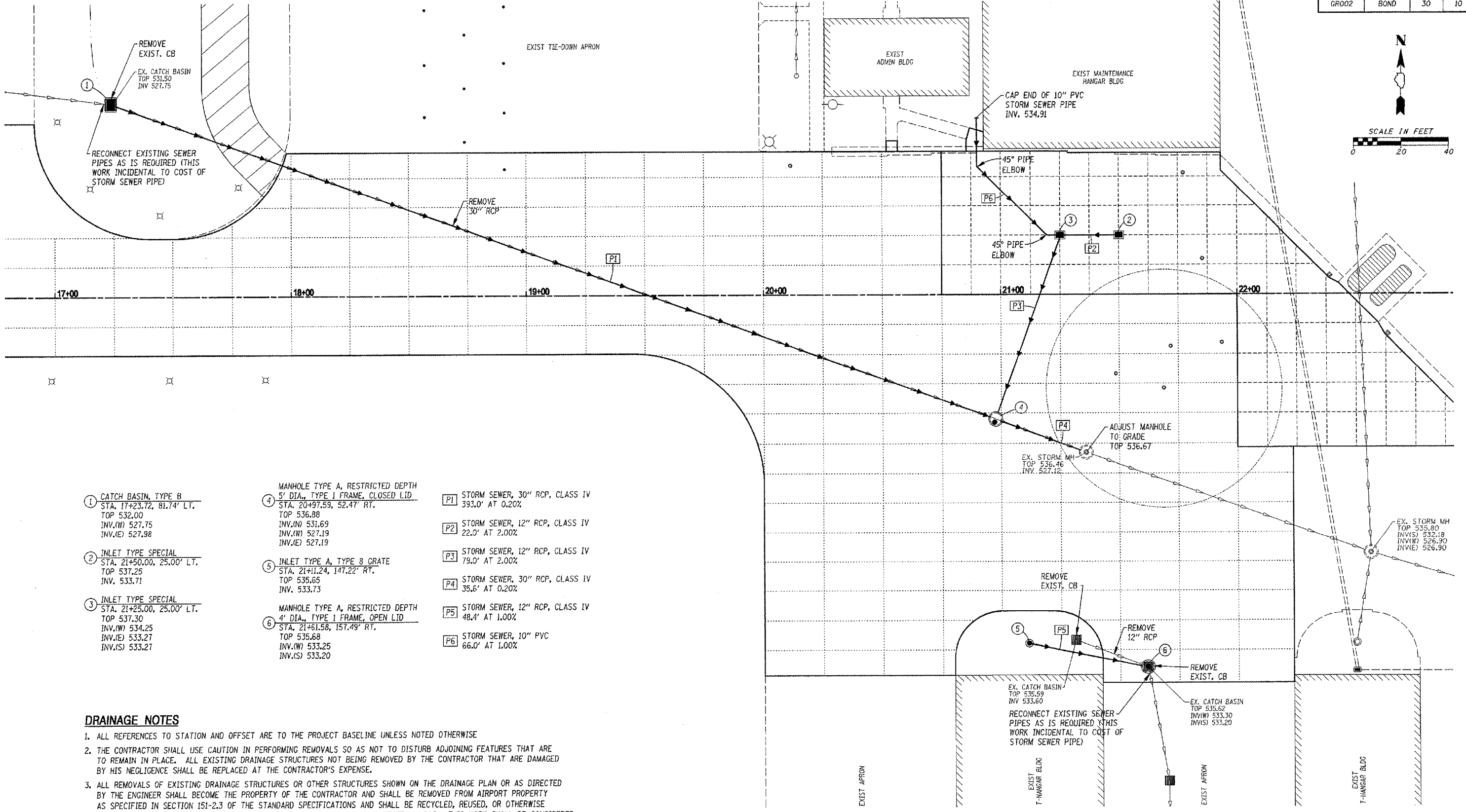
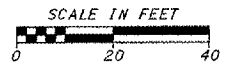

- ① CATCH BASIN, TYPE B
STA. 17+23.72, 81.74' LT.
TOP 532.00
INV.(W) 527.75
INV.(E) 527.98
- ② INLET TYPE SPECIAL
STA. 21+50.00, 25.00' LT.
TOP 537.25
INV. 533.71
- ③ INLET TYPE SPECIAL
STA. 21+25.00, 25.00' LT.
TOP 537.30
INV.(W) 534.25
INV.(E) 533.27
INV.(S) 533.27

- ④ MANHOLE TYPE A, RESTRICTED DEPTH
5' DIA., TYPE 1 FRAME, CLOSED LID
STA. 20+97.53, 52.47' RT.
TOP 536.88
INV.(W) 531.69
INV.(E) 527.19
INV.(S) 527.19
- ⑤ INLET TYPE A, TYPE 8 GRATE
STA. 21+11.24, 147.22' RT.
TOP 535.65
INV. 533.73
- ⑥ MANHOLE TYPE A, RESTRICTED DEPTH
4' DIA., TYPE 1 FRAME, OPEN LID
STA. 21+61.58, 157.49' RT.
TOP 535.68
INV.(W) 533.25
INV.(S) 533.20

- P1 STORM SEWER, 30" RCP, CLASS IV
393.0' AT 0.20%
- P2 STORM SEWER, 12" RCP, CLASS IV
22.0' AT 2.00%
- P3 STORM SEWER, 12" RCP, CLASS IV
79.0' AT 2.00%
- P4 STORM SEWER, 30" RCP, CLASS IV
35.6' AT 0.20%
- P5 STORM SEWER, 12" RCP, CLASS IV
48.4' AT 1.00%
- P6 STORM SEWER, 10" PVC
66.0' AT 1.00%

DRAINAGE NOTES

1. ALL REFERENCES TO STATION AND OFFSET ARE TO THE PROJECT BASELINE UNLESS NOTED OTHERWISE
2. THE CONTRACTOR SHALL USE CAUTION IN PERFORMING REMOVALS SO AS NOT TO DISTURB ADJOINING FEATURES THAT ARE TO REMAIN IN PLACE. ALL EXISTING DRAINAGE STRUCTURES NOT BEING REMOVED BY THE CONTRACTOR THAT ARE DAMAGED BY HIS NEGLIGENCE SHALL BE REPLACED AT THE CONTRACTOR'S EXPENSE.
3. ALL REMOVALS OF EXISTING DRAINAGE STRUCTURES OR OTHER STRUCTURES SHOWN ON THE DRAINAGE PLAN OR AS DIRECTED BY THE ENGINEER SHALL BECOME THE PROPERTY OF THE CONTRACTOR AND SHALL BE REMOVED FROM AIRPORT PROPERTY AS SPECIFIED IN SECTION 151-2.3 OF THE STANDARD SPECIFICATIONS AND SHALL BE RECYCLED, REUSED, OR OTHERWISE DISPOSED OF AS THE CONTRACTOR SEES FIT OR AS ALLOWED BY STATE OR FEDERAL LAWS. THIS WORK SHALL BE CONSIDERED INCIDENTAL TO THE VARIOUS PROPOSED DRAINAGE STRUCTURE ITEMS AND NO ADDITIONAL COMPENSATION WILL BE ALLOWED.
4. ALL OFFSETS FOR MANHOLES/INLETS SHOWN ARE TO THE CENTER OF THE STRUCTURE.
5. EROSION CONTROL SHALL BE PLACED AROUND INLETS AND MANHOLES IN ACCORDANCE WITH THE STANDARD SPECIFICATIONS OR AS DIRECTED BY THE ENGINEER.
6. THE CONNECTION OF THE PROPOSED STORM SEWER TO THE EXISTING SHOULD BE FREE OF VOIDS AND SHALL BE SEALED WITH MORTAR OR A CONCRETE COLLAR AS DIRECTED BY THE ENGINEER.

DATE	DESCRIPTION OF THE REVISIONS	BY
09-20-06	REVISED AND REPACKAGED FOR JAN. '07 LETTING	RGH

GREENVILLE AIRPORT AUTHORITY
GREENVILLE, ILLINOIS

HENRY, MEISENHEIMER & GENDE, INC.
ENGINEERS
CARLYLE, ILLINOIS 62281
www.hmgengr.com
(618) 694-3711 Fax (618) 694-8217

PROPOSED DRAINAGE PLAN

IL PROJ. NO.	GRE-3215
A.I.P. PROJ. NO.	3-17-0049-B4
FILE NAME	GA-DRAINPLN
DATE	01-19-2007

H.M.G. NO. 6596