

CONTRACT NUMBER	COUNTY	TOTAL SHEETS	SHEET NO.
GRO02	BOND	30	16

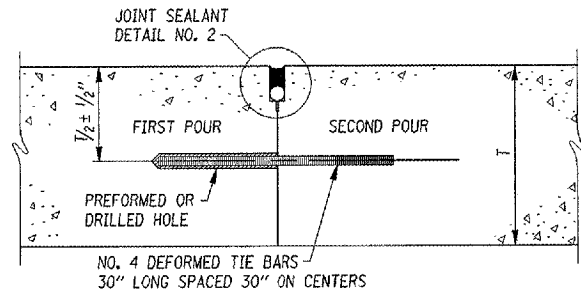

D TYPE D LONGITUDINAL CONSTRUCTION JOINT
NOT TO SCALE

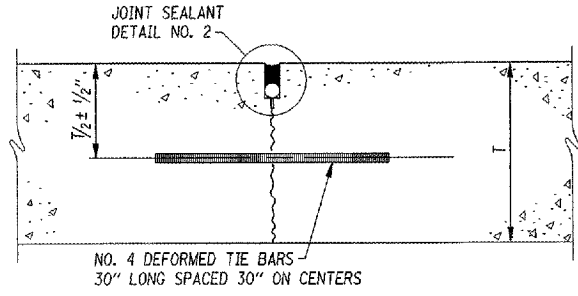

E TYPE E LONGITUDINAL SAWED JOINT
NOT TO SCALE

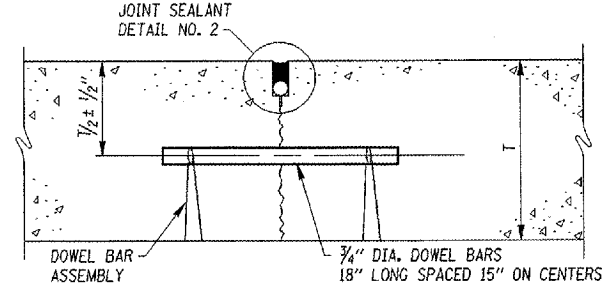

F TYPE F TRANSVERSE CONTRACTION JOINT
NOT TO SCALE

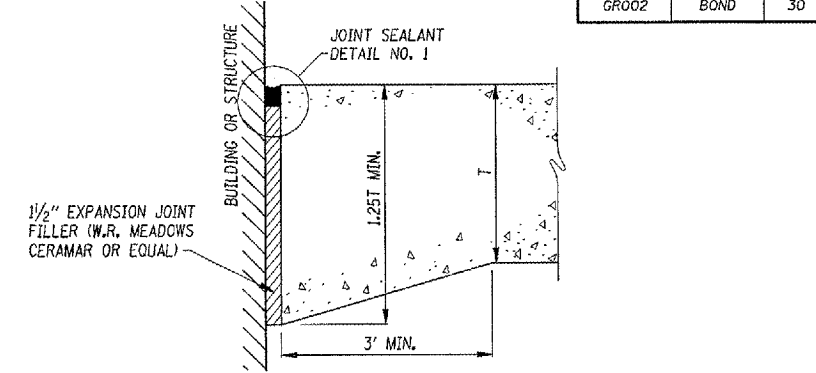

S TYPE S EXPANSION JOINT W/THICKENED EDGE AT STRUCTURE
NOT TO SCALE

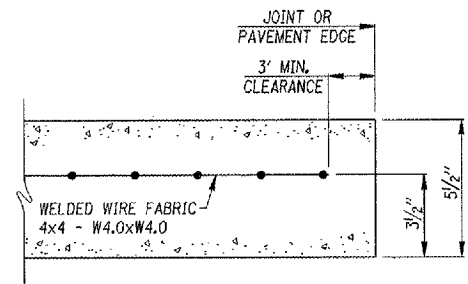

REINFORCED PAVEMENT DETAIL
NOT TO SCALE

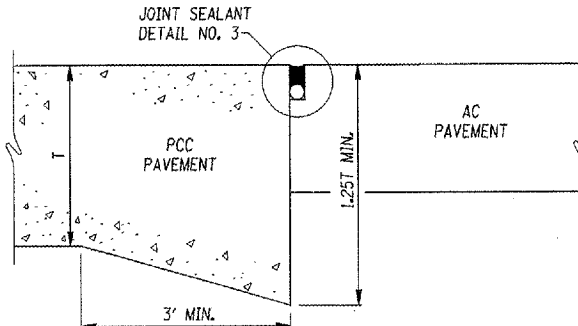

G TYPE G AC/PCC BUTT JOINT W/THICKENED EDGE
NOT TO SCALE

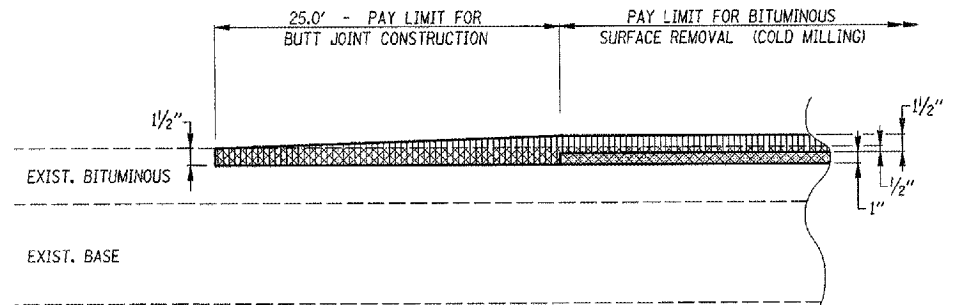

- COLD MILLING LIMITS
- BIT. SURFACE COURSE
- BIT. LEVEL BINDER

AC BUTT JOINT DETAIL
NOT TO SCALE

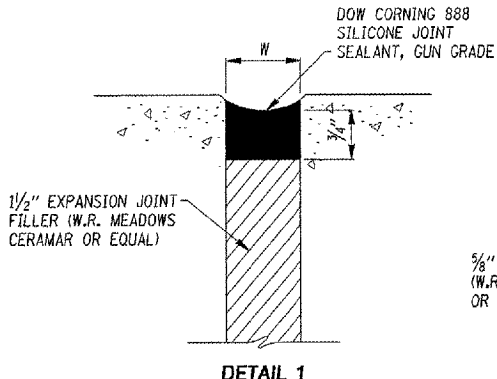

DETAIL 1

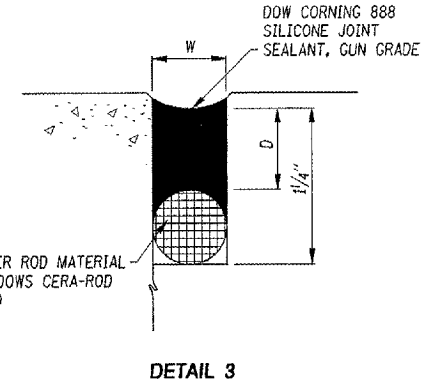

DETAIL 3

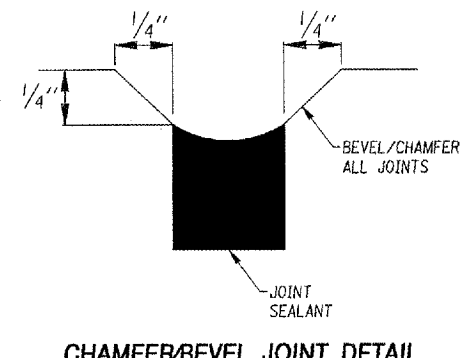

CHAMFER/BEVEL JOINT DETAIL
NOT TO SCALE

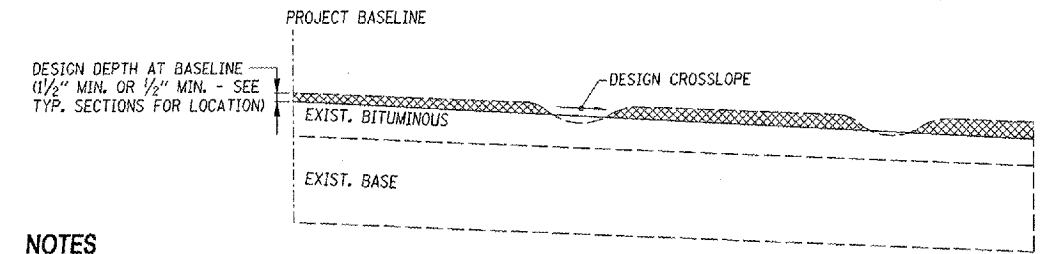

BITUMINOUS SURFACE REMOVAL DETAIL
NOT TO SCALE

- NOTES**
- MILLING SHALL BE DONE TO ATTAIN THE DESIGN SLOPE IN CROWN SECTIONS.
 - MILLING TO THE BOTTOM OF RUTS/IRREGULARITIES SHALL NOT BE NECESSARY UNLESS REQUIRED TO OBTAIN SLOPE OR THE DESIGN DEPTH AT CENTERLINE.

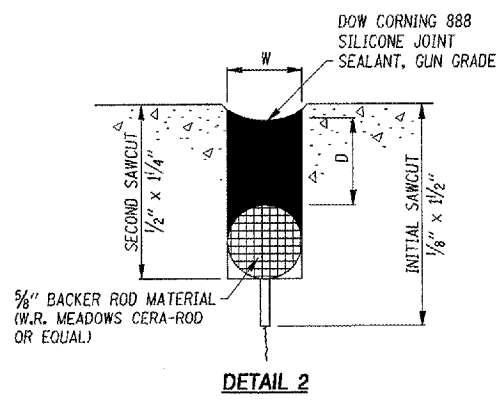

DETAIL 2

- NOTES**
- SEALANT RESERVOIR SIZED TO PROVIDE PROPER SHAPE FACTOR. W/D. FIELD POURED AND PREFORMED SEALANTS REQUIRE DIFFERENT SHAPE FACTORS FOR OPTIMUM PERFORMANCE.
 - SEPARATING TAPE OR BACKER MATERIAL REQUIRED TO PREVENT JOINT SEALANT FROM FLOWING INTO SAWCUT, TO SEPARATE NON-COMPATIBLE MATERIALS AND TO PREVENT SEALANT FROM BONDING TO BOTTOM OF RESERVOIR.
 - SEPARATING TAPE AND BACKER MATERIAL MUST BE COMPATIBLE WITH THE TYPE OF LIQUID SEALANT USED AND SIZED TO PROVIDE THE DESIRED SHAPE FACTOR.
 - W = WIDTH OF SEALANT RESERVOIR, 1/2" MIN. AND 3/8" MAX. EXCEPT FOR EXPANSION JOINTS WHERE W = 1/2" MIN. AND 1 1/2" MAX.
 - D = DEPTH OF SEALANT, 1.0 TO 1.5 TIMES W

DATE	DESCRIPTION OF THE REVISIONS	BY
09-20-06	REVISED AND REPACKAGED FOR JAN. '07 LETTING	RGH

GREENVILLE AIRPORT AUTHORITY GREENVILLE, ILLINOIS

HENRY, MEISENHEIMER & GENDE, INC.
ENGINEERS
CARLYLE, ILLINOIS 62231
www.hmgengineers.com
(618) 684-3711 Fax (618) 684-8217

PCC JOINT DETAILS AND MISCELLANEOUS BITUMINOUS DETAILS

IL. PROJ. NO.	GRE-3215
A.I.P. PROJ. NO.	3-17-0049-B4
FILE NAME	GA-JOINTDET
DATE	01-19-2007