

STAGE 2A NOTES

- NOTES:**
- RUNWAY 05-23 WILL BE CLOSED DURING STAGE 2A. THE CONTRACTOR IS TO COORDINATE THE RUNWAY CLOSURE WITH AIRPORT OPERATIONS THROUGH THE RESIDENT ENGINEER. THE CONTRACTOR IS TO PLACE RUNWAY CLOSED MARKERS AT EACH END OF THE RUNWAY WHEN CLOSURE BEGINS, AND REMOVE THE MARKERS EVERY EVENING WHEN THE RUNWAY IS REOPENED TO AIR TRAFFIC. THE CONTRACTOR MUST ENSURE THE RUNWAY AND SAFETY AREA MEET FAA CRITERIA PRIOR TO REOPENING THE RUNWAY.
 - THE CONTRACTOR MUST COMPLETE ALL WORK WITHIN STAGE 2A BEFORE BEGINNING STAGE 2B.
 - ALL CONTRACTOR'S ACTIVITIES SHALL BE LIMITED TO AREA WITHIN THE STAGE 2A LIMITS AS SHOWN. THE CONTRACTOR MUST MAINTAIN AN AIR TRAFFIC ROUTE TO RUNWAY 14-32 AT ALL TIMES.
 - ALL CONSTRUCTION EQUIPMENT WILL BE LIMITED TO A HEIGHT OF 15 FEET UNLESS PRIOR APPROVAL IS GIVEN BY THE ENGINEER.
 - SEE CONSTRUCTION AND SAFETY NOTES, SHEET 4.
 - THE CONTRACTOR HAS 11 DAYS TO COMPLETE ALL WORK IN STAGE 2A AND 2B. DAYS MAY NOT BE CONSECUTIVE.
- THE FOLLOWING ITEMS ARE TO BE COMPLETED IN STAGE 2A:**
- PROVIDE TEMPORARY BARRICADES AS SHOWN.
 - PROVIDE LATHING AND WARNING TAPE AS SHOWN.
 - INSTALL CABLE IN UNIT DUCT, HANDHOLES, SIGN BASES, AND SIGNS AS INDICATED ON THE PLANS WITHIN STAGE 2A LIMITS.
 - REGRADE SHOULDERS AND SWALES WHERE NECESSARY WITHIN STAGE 2A LIMITS.
 - TOPSOIL AND SEED WITHIN CONSTRUCTION LIMITS.
 - REMOVE LATHING AND WARNING TAPE, BARRICADES AND TEMPORARY EROSION CONTROL MEASURES AS NECESSARY.

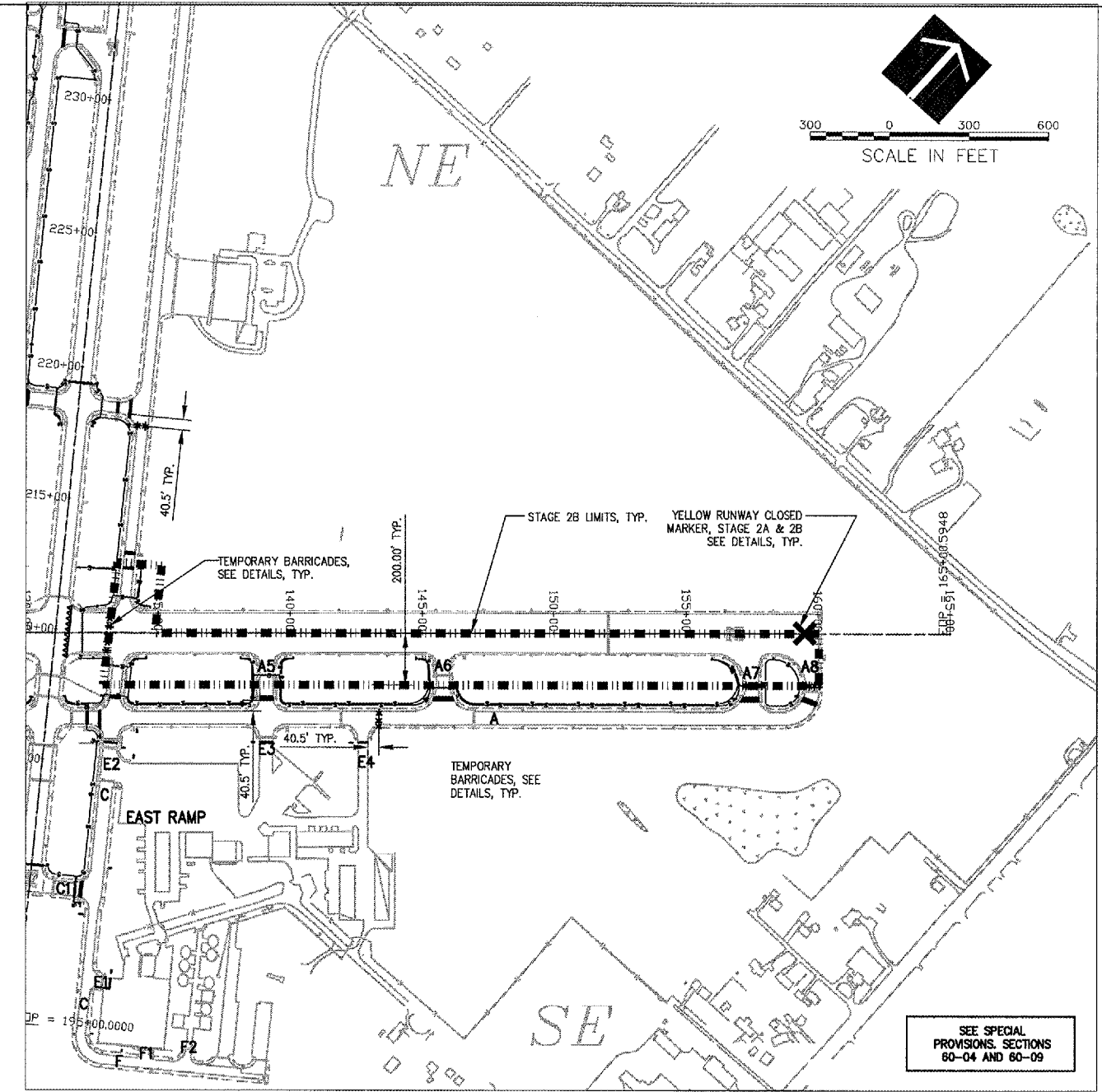

STAGE 2B NOTES

- NOTES:**
- RUNWAY 05-23 WILL BE CLOSED DURING STAGE 2B. THE CONTRACTOR IS TO COORDINATE THE RUNWAY CLOSURE WITH AIRPORT OPERATIONS THROUGH THE RESIDENT ENGINEER. THE CONTRACTOR IS TO PLACE RUNWAY CLOSED MARKERS AT EACH END OF THE RUNWAY WHEN CLOSURE BEGINS, AND REMOVE THE MARKERS EVERY EVENING WHEN THE RUNWAY IS REOPENED TO AIR TRAFFIC. THE CONTRACTOR MUST ENSURE THE RUNWAY AND SAFETY AREA MEET FAA CRITERIA PRIOR TO REOPENING THE RUNWAY.
 - ALL CONTRACTOR'S ACTIVITIES SHALL BE LIMITED TO AREA WITHIN THE STAGE 2B LIMITS AS SHOWN. THE CONTRACTOR MUST MAINTAIN AN AIR TRAFFIC ROUTE TO RUNWAY 14-32 AT ALL TIMES.
 - ALL CONSTRUCTION EQUIPMENT WILL BE LIMITED TO A HEIGHT OF 15 FEET UNLESS PRIOR APPROVAL IS GIVEN BY THE ENGINEER.
 - SEE CONSTRUCTION AND SAFETY NOTES, SHEET 4.
- THE FOLLOWING ITEMS ARE TO BE COMPLETED IN STAGE 2B:**
- PROVIDE TEMPORARY BARRICADES AS SHOWN.
 - PROVIDE LATHING AND WARNING TAPE AS SHOWN.
 - INSTALL CABLE IN UNIT DUCT, HANDHOLES, SIGN BASES, AND SIGNS AS INDICATED ON THE PLANS WITHIN STAGE 2B LIMITS.
 - REGRADE SHOULDERS AND SWALES WHERE NECESSARY WITHIN STAGE 2B LIMITS.
 - TOPSOIL AND SEED WITHIN CONSTRUCTION LIMITS.
 - REMOVE LATHING AND WARNING TAPE, BARRICADES AND TEMPORARY EROSION CONTROL MEASURES AS NECESSARY.

WA057



HANSON PROFESSIONAL SERVICES INC.
 815 Commerce Drive, Suite 200
 Oak Brook, Illinois 60023
 Telephone: 630.990.3800
 Fax: 630.990.3810



**WAUKEGAN REGIONAL AIRPORT
 WAUKEGAN PORT DISTRICT**
 3580 North McAree Road
 Waukegan, Illinois 60087
 Telephone: 847.244.0066
 Fax: 847.244.3813

AIRFIELD SIGNAGE IMPROVEMENTS
 AIP PROJECT NO. 3-17-0105-B35
 IDA PROJECT NO. UGN-3650

No.	Drawing Issue Description	Date	By

Date
 NOVEMBER 10, 2006
 Sheet Title

**CONSTRUCTION
 STAGING PLAN
 STAGE 2A AND 2B**

831-06A8004
 Project Number
 LDH 05/18/06
 Layout By Date
 LDH 05/18/06
 Designed By Date
 RMH 11/10/06
 Reviewed By Date
 LDH
 Drawn By Sheet No. **7**

Z:\06\055\00821\06A8004\DRAWINGS\SHEETS\07-STAGING PLANNING NOV 13, 2006 2:47PM LDH