

# THE CITY OF MORRIS, ILLINOIS

## MORRIS MUNICIPAL AIRPORT

### JAMES R. WASHBURN FIELD

#### INDEX OF SHEETS

PAGE NO.	DESCRIPTION
1	COVER SHEET
2	GENERAL NOTES AND SUMMARY OF QUANTITIES
3	CONSTRUCTION SAFETY PLAN
4	DEMOLITION PLAN
5	DIMENSIONAL LAYOUT PLAN
6	GRADING AND DRAINAGE PLAN
7-8	DETAILS

#### CONSTRUCTION PLANS FOR REHABILITATE AND EXPAND AIRPORT AUTOMOBILE PARKING LOT ILLINOIS PROJECT NO. C09-4629

LATITUDE 41°-25'-31.8" LONGITUDE 88°-25'-7.2"  
ELEVATION 585.01

DATE: OCTOBER 27, 2017  
RUNWAY CATEGORY B, GROUP II

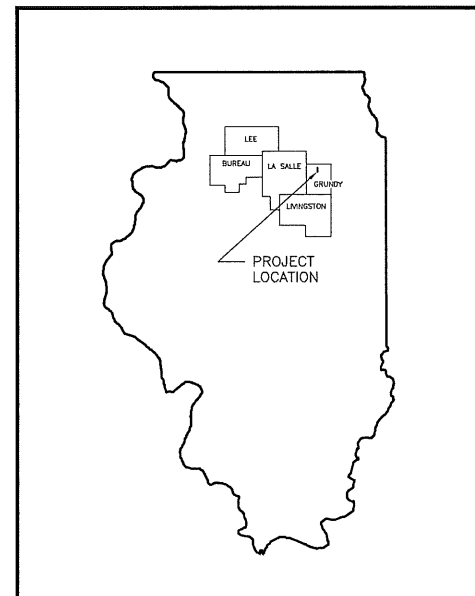

LOCATION MAP  
NOT TO SCALE

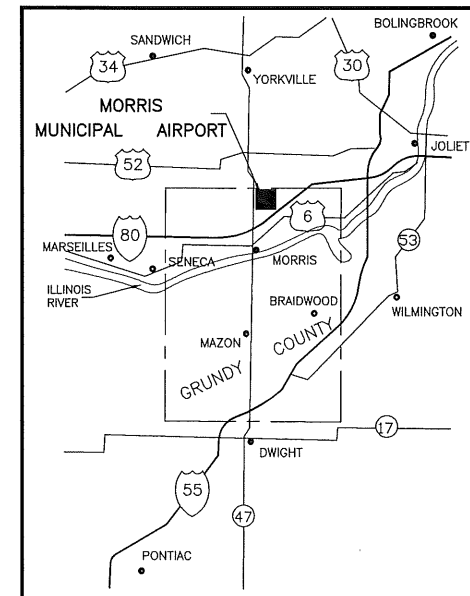

VICINITY MAP

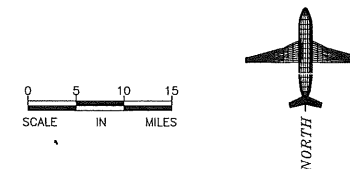

11/22/17  
date

Casey J. McCollom  
signature

PROFESSIONAL DESIGN FIRM  
LICENSE NO. 184-001717

BENCHMARK DATA		
DESCRIPTION	ELEVATION METRIC	ELEVATION ENGLISH
S.E. CORNER OF CONCRETE BASE FOR OLD WIND SOCK AT OFFICE BLDG.		(589.10)
BRASS PLUG IN WEST WALL @ GRACE LUTH. CHURCH		(589.84)

DESCRIPTION
MORRIS MUNICIPAL AIRPORT
SECTIONS 10 & 15, TOWNSHIP 34N., RANGE 7E. OF 3RD P.M. GRUNDY COUNTY, SARATOGA TOWNSHIP

UNDERGROUND UTILITY INFORMATION		
UTILITY SERVICE	PERSON TO CONTACT	TELEPHONE NO.
ELECTRIC - COMMONWEALTH EDISON	JULIE (JOINT UTILITY LOCATING INFORMATION FOR EXCAVATORS)	1-800-892-0123
TELEPHONE - AT&T	JULIE (JOINT UTILITY LOCATING INFORMATION FOR EXCAVATORS)	1-800-892-0123
NATURAL GAS - NICOR	JULIE (JOINT UTILITY LOCATING INFORMATION FOR EXCAVATORS)	1-800-892-0123

<p><b>CITY OF MORRIS</b></p> <p>APPROVED: <i>Robert P. Kysie</i> MAYOR DATE: <u>November 22</u> 20 <u>17</u></p>	<p><b>CHAMLIN ASSOCIATES</b> PERU ILLINOIS MORRIS</p> <p>SUBMITTED BY: <i>Casey J. McCollom</i> ENGINEER DATE: <u>November 22</u> 20 <u>2017</u></p> <p>JOB NO. 1002.76 PROFESSIONAL DESIGN FIRM LICENSE NO.: 184-001717</p>
--	--

CHAMLIN & ASSOCIATES, INC. © 2009  
 Drawing Name: C:\Users\mick\Documents\1212-00 Morris Airport Plan Set Imp 2017\CAD\001-COVER.dwg Last Modified: Nov 22, 2017 - 8:53am Plotted on: Nov 22, 2017 - 8:53am by mick

**Safety Plan**

- The closure of Runway 18/36 and all taxiways will be required during construction. Each day before entering the AOA, the Contractor shall obtain clearance from the Resident Engineer. Under no circumstances shall the Contractor's equipment or personnel enter the AOA before this clearance is granted. The AOA shall be assumed to be any area that is within 200 feet of the centerline of a runway or within 66 feet of the centerline of a taxiway. Any delays in the Contractor's daily work due to a reasonable delay in receiving clearance to enter the AOA, as determined by the Resident Engineer, will not be compensated.
- The Contractor shall be responsible for familiarizing himself and comply with the requirements of FAA Advisory Circular 150/5370-2F. As part of this compliance, the Contractor shall prepare and submit a Safety Plan Compliance Document in accordance with AC 150/5370-2F. This document should be submitted to the Airport Manager for review. Once approved, the Airport Manager will submit the document to the Illinois Division of Aeronautics for final approval. The Contractor's Notice to Proceed will not occur until the Safety Plan Compliance Document has been approved.
- All material storage, equipment parking, and employee parking shall occur in the area designated on the plans or as defined by the Resident Engineer as the Parking and Staging Area. Stockpiled materials shall not violate FAA Part 77 Airport surfaces. The material storage, equipment and employee parking shall be clearly delineated in the field.
- The Contractor shall limit the height of all equipment and material storage stockpiles to a maximum of 30 feet above the ground.
- The Contractor shall identify all vehicles and equipment with 3' Square Checkered flags (International Orange and White) while on airport property.
- The Contractor shall limit the number of vehicles traversing the designated work area. Under no circumstances shall the Contractor's employees be allowed to operate personal vehicles within the AOA.
- The Contractor shall limit the use of construction equipment on pavements to remain or completed proposed pavements.
- Only rubber tired vehicles may be operated on airport pavement that is to remain or has been completed.
- All trenches and excavations within the AOA shall be filled at the close of each work day. The work area shall be swept and free of dirt, gravel, or other loose materials. All runways and taxiways must be reopened each day by 1800 hours unless express authorization has been given by the Airport Manager.
- All barricades located in to AOA shall be low profile as provided in the plan details and shall be kept outside of the denoted Runway Safety Area (RSA) and Taxiway Safety Area (TSA).
- The Contractor shall provide a Safety Plan Compliance Document (SPCD) that details the Contractor's methods for compliance with the project safety plan and the requirements of the FAA Advisory Circular 150/5370-2F. The SPCD shall be provide with the proposed project schedule, both of which shall be provided a minimum of 5 business days prior to the preconstruction meeting. The SPCD shall include the following information:
  - Proposed Access Points and Storage Areas
  - Temporary Markings to be used
  - Location and type of Traffic Control Devices
  - Areas of construction operations and measures to prevent equipment and employees from entering restricted areas.
  - Any requested alternatives to the requirements of the plans and specifications.
- All Notice to Airmen (NOTAM) will be issued by the Airport Manager. A minimum of 72 Hours' notice to the Airport Manager will be required for the issuance of a NOTAM. No runway or taxiway shall be closed without authorization by the Airport Manager.

**General Notes**

- The Contractor shall notify the Resident Engineer a minimum of 7 days prior to the start of Construction.
- The Contractor shall provide a Construction Superintendent. The Superintendent shall be present on the site at any time work is being performed. Additionally, the Superintendent shall be available by phone 24 hours a day, 7 days a week until the project has been deemed complete.
- The Contractor shall be responsible for the protection, preservation, and repair to any existing facilities that are to remain in place. The cost of this protection, preservation, and repair will not be paid for separately but should be included in the adjacent pay items.
- The Contractor shall be responsible to verify the existing conditions of the work area prior to beginning construction. Should discrepancies between the condition in the field and the information provided on the plan be discovered, the Contractor shall immediately notify the Resident Engineer.
- The Contractor shall maintain consistent coordination with the Resident Engineer, Airport Manager, and his subcontractors. Proposed work schedules shall be provided to and approved by the Resident Engineer. Updated schedules shall be provided to the Resident Engineer as the project progresses. The sequence of work shall closely follow the approved schedule unless written permission is given from the Resident Engineer to vary from the proposed schedule.
- The Contractor shall not enter the Airfield Operations Area (AOA) without expressed authorization from the Airport Manager. This authorization shall be obtained each day entry into the AOA is required.
- Prior to the request for final inspection, the Contractor shall have all waste, surplus materials, and non-critical equipment removed from the Airport Property. All areas disturbed by the contractor shall be regraded, topsoiled and seeded.
- The Contractor shall provide all necessary traffic control and maintenance as specified in the plans and as directed by the Resident Engineer. Traffic Control and Maintenance may have to be adjusted from time to time to accommodate operations of the Airport. These adjustments must be made as quickly as practicable. All work and equipment associated with traffic control and maintenance and adjustments thereof, shall not be paid for separately but shall be included in the cost of the contract.
- All grades provided on the plans are to finished grade unless indicated otherwise.
- The Contractor shall be responsible for maintaining positive drainage throughout the progress of work. Any damage resulting from improper drainage or sediment deposited by uncontrolled drainage shall be repaired by the Contractor at his expense.
- The Contractor shall be responsible for the protection of all prepared bases that have been inspected and approved. Any damage to occur to a previously inspected and approved base shall be repaired by the Contractor at his expense.
- The Contractor shall locate or cause existing utilities to be located. The Contractor shall coordinate with the Airport Manager to have all on-site utilities located prior to the start of excavations. The Contractor will be responsible for the protection of all identified utilities. Should damage occur, it shall be the responsibility of the Contractor to repair or cause to have repaired the damaged utility to the satisfaction of the utility owner. The cost of locating, protection, and/or repair shall be at the Contractor's expense.
- The Contractor shall be responsible for supplying As-Built drawings to the resident Engineer.
- The Calendar Days for this contract were determined based on an approximated number of working days required to complete the proposed improvements. The number of available working days per month has been assumed to be as follows:

Month	Days	Month	Days
January	0	July	17
February	0	August	17
March	0	September	16
April	0	October	16
May	15	November	14
June	17	December	0

**SUMMARY OF QUANTITIES**

ITEM	DESCRIPTION	UNIT	ESTIMATE QUANTITY
AR106502	APRON LIGHT POLE W/DOUBLE FIXTURE	EA	4
AR108660	3/C #10 600 V UG CABLE N UD	LF	525
AR109210	VAULT MODIFICATIONS	LS	1
AR125902	REMOVE BASE MOUNTED LIGHT	EA	1
AR150520	MOBILIZATION	LS	1
AR152410	UNCLASSIFIED EXCAVATION	CY	750
AR152443	OFFSITE TOPSOILING	CY	125
AR156510	SILT FENCE	LF	250
AR156531	EROSION CONTROL BLANKET	SY	725
AR162508	CLASS E FENCE 8'	LF	1250
AR162604	CLASS E GATE - 4'	EA	1
AR162606	CLASS E GATE - 6'	EA	1
AR162626	CLASS E GATE - 26'	EA	1
AR162630	CLASS E GATE - 30'	EA	3
AR162900	REMOVE CLASS E FENCE	LF	153
AR162905	REMOVE GATE	EA	1
AR209610	CRUSHED AGG BASE COURSE - 10"	SY	1700
AR401611	BIT. SURFACE COURSE - METHOD I	TON	525
AR401620	BIT. SURFACE COURSE, LEVELING	TON	170
AR401650	BITUMINOUS PAVEMENT MILLING	SY	4075
AR401900	REMOVE BITUMINOUS PAVEMENT	SY	1700
AR403611	BITUMINOUS BASE COURSE - METHOD I	TON	375
AR501605	5" PCC SIDEWALK	SF	1170
AR602510	BITUMINOUS PRIME COAT	GAL	850
AR603510	BITUMINOUS TACK COAT	GAL	2310
AR620520	PAVEMENT MARKING - WATERBORNE	SF	1850
AR701010	10" PVC STORM SEWER	LF	63
AR701900	REMOVE PIPE	LF	30
AR801337	DETECTABLE WARNING SURFACE	SF	120
AR801339	REMOVE FLAG POLE AND FOUNDATION	EA	1
AR901525	SEEDING	LS	1

CHAMLIN & ASSOCIATES, INC. © 2017 Drawing Name: H:\A\ADBA\1\1212-00 Morris Airport Pkg Lot Imp 2017\CAD\002-SUMQ.dwg Last Modified: Dec 07, 2017 - 4:07pm Plotted on: Dec 07, 2017 - 4:08pm by nict

DRAWN BY: ARR	REVISIONS			
CHECKED BY: CJM	LEVEL	BY	DATE	DESCRIPTION
CREATED: 8/17				

**CHAMLIN & ASSOCIATES, INC.**  
PERU MORRIS ILLINOIS

**MORRIS MUNICIPAL AIRPORT**  
MORRIS, ILLINOIS

**GENERAL NOTES AND SUMMARY OF QUANTITIES**

100% NOVEMBER 24, 2017

CURRENT AS OF: 12/07/17	
SCALE: AS NOTED	SHEET 2
FILE NO.: 1212.00	OF 8

**LEGEND**

— BRL — BUILDING RESTRICTION LINE (BRL)  
 — BARRICADE PLACEMENT

CRITICAL POINT DATA				
PNT. LOCATION	LATITUDE	LONGITUDE	GRND. ELEV.	HEIGHT (AMSL)
CONSTRUCTION STAGING AREA ①	N. 41° 25' 50.67"	W. 88° 25' 20.78"	587.71	612.71

**BENCHMARKS:**

BRASS PLUG IN WEST WALL AT GRACE LUTHERAN CHURCH  
 S.E. CORNER OF CONCRETE BASE FOR OLD WIND SOCK AT OFFICE BUILDING

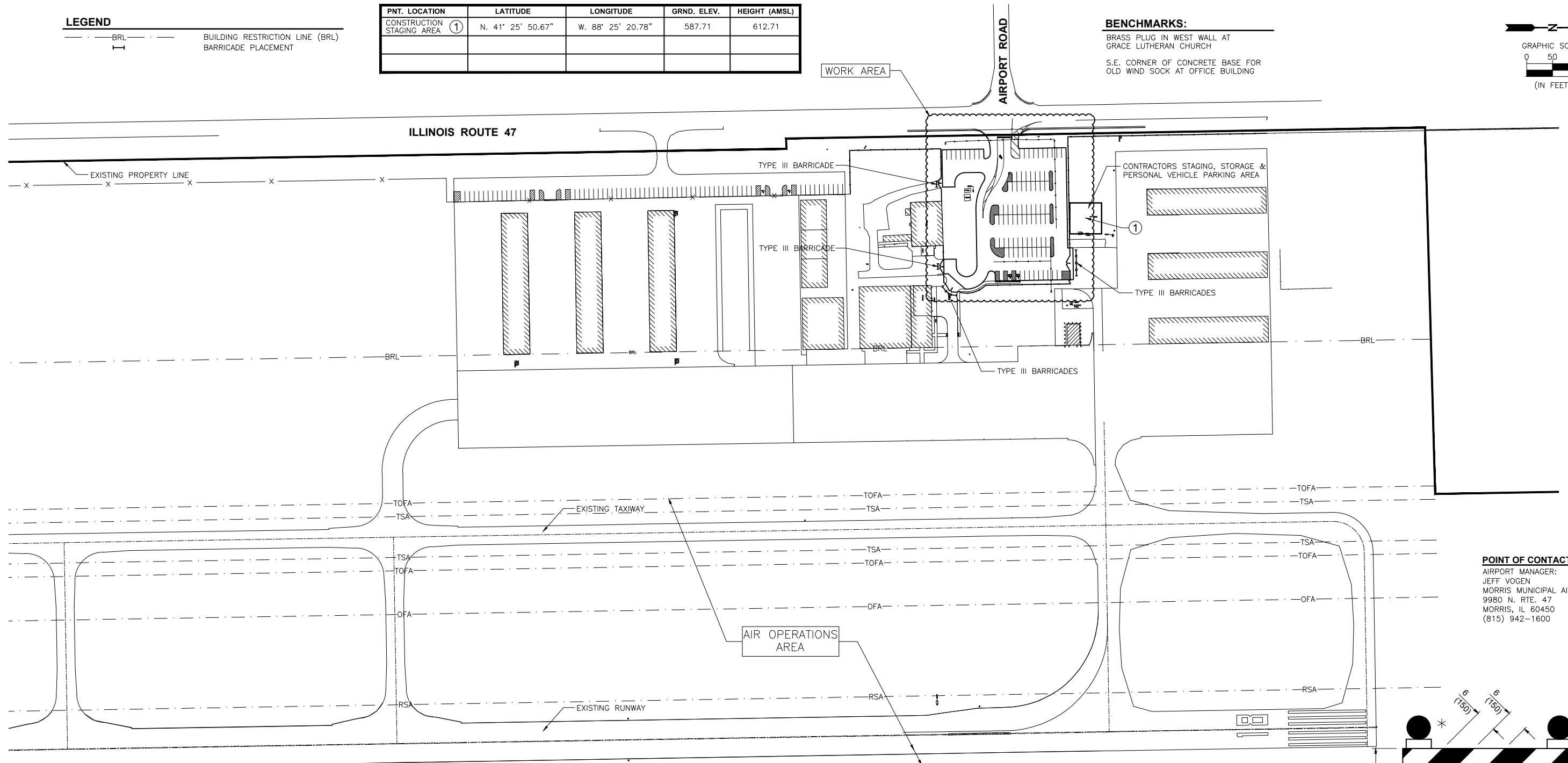
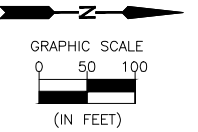

**POINT OF CONTACT**

AIRPORT MANAGER:  
 JEFF VOGEN  
 MORRIS MUNICIPAL AIRPORT  
 9980 N. RTE. 47  
 MORRIS, IL 60450  
 (815) 942-1600

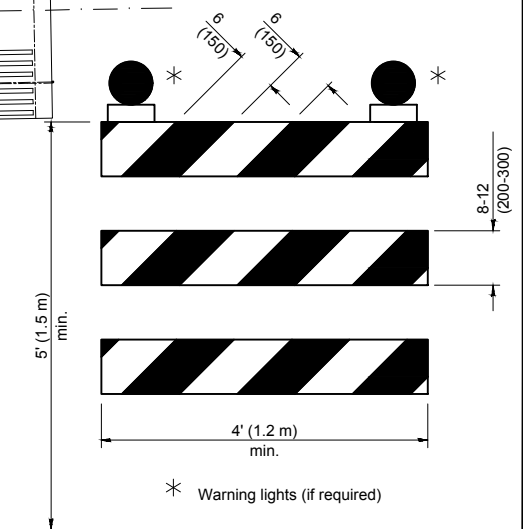

**TRAFFIC CONTROL TYPE III BARRICADE**

**GENERAL NOTES AND SCOPE OF WORK**

- SCOPE OF WORK:  
 THE PROJECT WILL CONSIST OF REHABILITATING AND EXPANDING THE AUTOMOBILE PARKING LOT AT MORRIS MUNICIPAL AIRPORT IN MORRIS, ILLINOIS. THE SCOPE OF THE PROJECT IS APPROXIMATELY 7900 SQUARE YARDS OF REHABILITATION AND EXPANSION OF THE EXISTING AUTOMOBILE PARKING LOT CONSISTING OF EARTH EXCAVATION, PAVEMENT REMOVAL, DRAINAGE IMPROVEMENTS, FENCING, AND, PARKING LOT LIGHTING.
- THE MAXIMUM ANTICIPATED CONSTRUCTION EQUIPMENT HEIGHT IS 30'-0".
- THE CONTRACTOR SHALL NOT ENTER THE AIRFIELD OPERATIONS AREA AT ANY TIME. ALL EQUIPMENT, MATERIALS AND PERSONNEL SHALL BE CONFINED TO THE DESIGNATED WORK AREA AT ALL TIMES.
- THE CONTRACTOR SHALL INVESTIGATE EXISTING DRAINAGE PIPES AND FIELD TILES TO DETERMINE THEIR EXTENT. ALL FIELD TILES AND DRAIN PIPES SHALL BE EXTENDED, REROUTED, OR MAINTAINED TO PROVIDE CONTINUOUS UNOBSTRUCTED DRAINAGE.
- DUE TO THE CLOSE PROXIMITY TO AIRCRAFT OPERATIONS, THE CONTRACTOR IS REQUIRED TO STRICTLY ADHERE TO THE GUIDELINES REGARDING CONSTRUCTION SAFETY AS SET FORTH IN FAA ADVISORY CIRCULAR 150/5370-2F

**SAFETY PLAN NOTES**

- BARRICADES SHALL BE PLACED AND MAINTAINED AS SHOWN HEREIN, AS INDICATED IN THE SPECIAL PROVISIONS AND AS DIRECTED BY THE ENGINEER. PLACEMENT AND MAINTENANCE OF BARRICADES ARE INCIDENTAL TO CONTRACT.
- ALL BARRICADES, MARKINGS, LATHE, FLAGGING, AND TRAFFIC CONTROL ITEMS ARE INCIDENTAL TO THE CONTRACT.
- ALL IDOT TYPE III BARRICADES SHALL HAVE FOUR STANDARD SIZE SAND BAGS PER LEG.
- THE CONTRACTOR SHALL NOT ENTER THE AIRFIELD OPERATIONS AREA (AOA) FOR ANY REASON DURING THIS PROJECT.
- THE RUNWAY AND ALL TAXIWAYS SHALL STAY OPEN AND OPERATIONAL DURING CONSTRUCTION.

**SEQUENCE OF CONSTRUCTION**

- INSTALL TEMPORARY BARRICADES AT ENTRANCES FROM PARKING LOT TO AERONAUTICAL OPERATIONS AREA (AOA) TO PREVENT ACCIDENTAL CONTRACTOR ENTRY.
- INSTALL EROSION CONTROL MEASURES.
- EXCAVATE AREA OF EXPANDED PARKING LOT PAVEMENT.
- PREPARE SUBGRADE, INSTALL CRUSHED AGGREGATE BASE COURSE.
- INSTALL HOT-MIX ASPHALT BINDER COURSE AND PCC SIDEWALK.
- REMOVE 1" OF EXISTING HOT-MIX ASPHALT SURFACE.
- DIRECTIONAL BORE CONDUIT FOR PROPOSED LIGHTING.
- CONSTRUCT LIGHTING FOUNDATIONS.
- INSTALL HOT-MIX ASPHALT LEVELING BINDER.
- INSTALL HOT-MIX ASPHALT SURFACE COURSE.
- MODIFY EXISTING ELECTRIC VAULT, INSTALL LIGHTING, COMPLETE ELECTRICAL WORK.
- INSTALL PAVEMENT MARKINGS.
- INSTALL PERIMETER FENCING.
- RESTORE DISTURBED AREAS.
- REMOVE TEMPORARY BARRICADES AT ENTRANCES FROM PARKING LOT AOA

CHAMLIN & ASSOCIATES, INC. © 2017  
 Drawing Name: H:\A\001\1212-00 Morris Airport Plg Lot Imp 2017\CAD\003-SAFETY.dwg Last Modified: Nov. 22, 2017 - 2:24pm Plotted on: Nov. 22, 2017 - 2:34pm by nick

DRAWN BY: NET	REVISIONS			
	LEVEL	BY	DATE	DESCRIPTION
CHECKED BY: CJM				
CREATED: 11/17				

**CHAMLIN & ASSOCIATES, INC.**  
 PERU MORRIS ILLINOIS

**MORRIS MUNICIPAL AIRPORT**  
 MORRIS, ILLINOIS

**CONSTRUCTION SAFETY PLAN**

100% NOVEMBER 24, 2017  
 CURRENT AS OF: 11/22/17  
 SCALE: AS NOTED SHEET 3  
 FILE NO.: 1212.00 OF 8

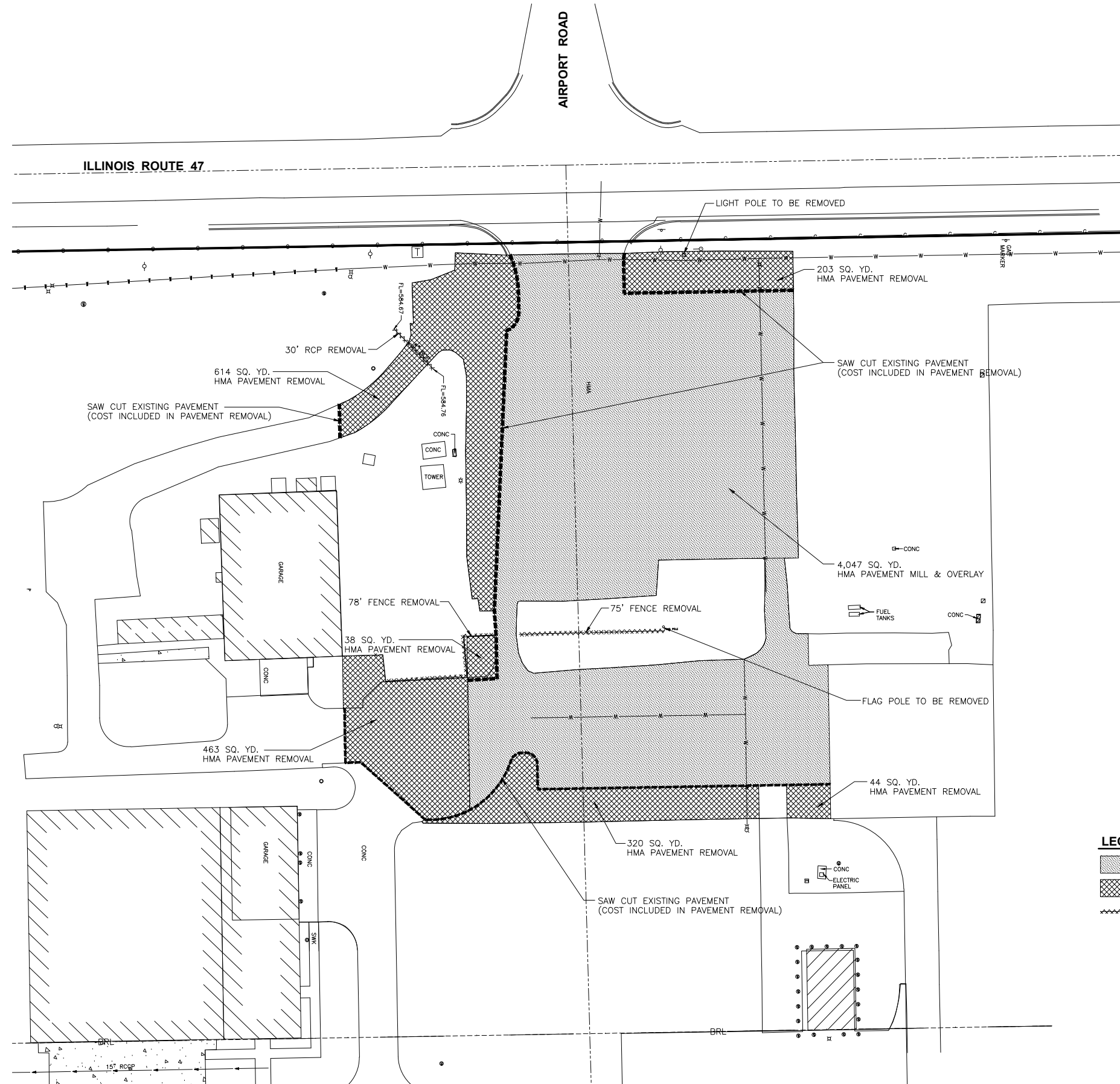
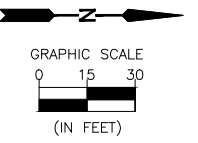

**LEGEND**

	HMA PAVEMENT MILLING, 1"
	HMA PAVEMENT REMOVAL
	FENCE REMOVAL

CHAMLIN & ASSOCIATES, INC. © 2017  
Drawing Name: H:\A\DBA\1212-00 Morris Airport Pkg Lot Imp 2017\CAD\004-DEMO.dwg Last Modified: Nov 22, 2017 - 2:24pm Plotted on: Nov 22, 2017 - 2:35pm by niclt

DRAWN BY: NET	REVISIONS			
CHECKED BY: CJM	LEVEL	BY	DATE	DESCRIPTION
CREATED: 8/17				

**CHAMLIN & ASSOCIATES, INC.**  
PERU MORRIS  
ILLINOIS

**MORRIS MUNICIPAL AIRPORT**  
MORRIS, ILLINOIS

**DEMOLITION PLAN**

100%  
NOVEMBER 24, 2017

CURRENT AS OF: 11/22/17	SHEET 4
SCALE: AS NOTED	OF 8
FILE NO.: 1212.00	

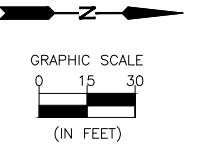

**PROPOSED COORDINATES**

A	N:1734716.342 E:959768.130
B	N:1734714.917 E:959683.175
C	N:1734891.682 E:959680.210
D	N:1734893.382 E:959781.534
E	N:1734894.060 E:959682.071
F	N:1734895.273 E:959754.431
G	N:1734919.270 E:959754.029
H	N:1734975.048 E:959680.713
I	N:1734983.327 E:959659.734
J	N:1735042.446 E:959658.814
K	N:1735042.400 E:959679.567
L	N:1734960.015 E:959798.119
M	N:1734961.857 E:959907.904
N	N:1734921.618 E:959893.977
O	N:1734897.621 E:959894.379
P	N:1734898.096 E:959922.720
Q	N:1734896.574 E:959867.446
R	N:1734897.779 E:959939.305
S	N:1734939.014 E:959952.147
T	N:1735143.118 E:959941.863
U	N:1735148.978 E:959933.760
V	N:1735147.909 E:959871.972
W	N:1735137.912 E:959872.230
X	N:1735134.548 E:959677.972
Y	N:1735138.182 E:959656.763

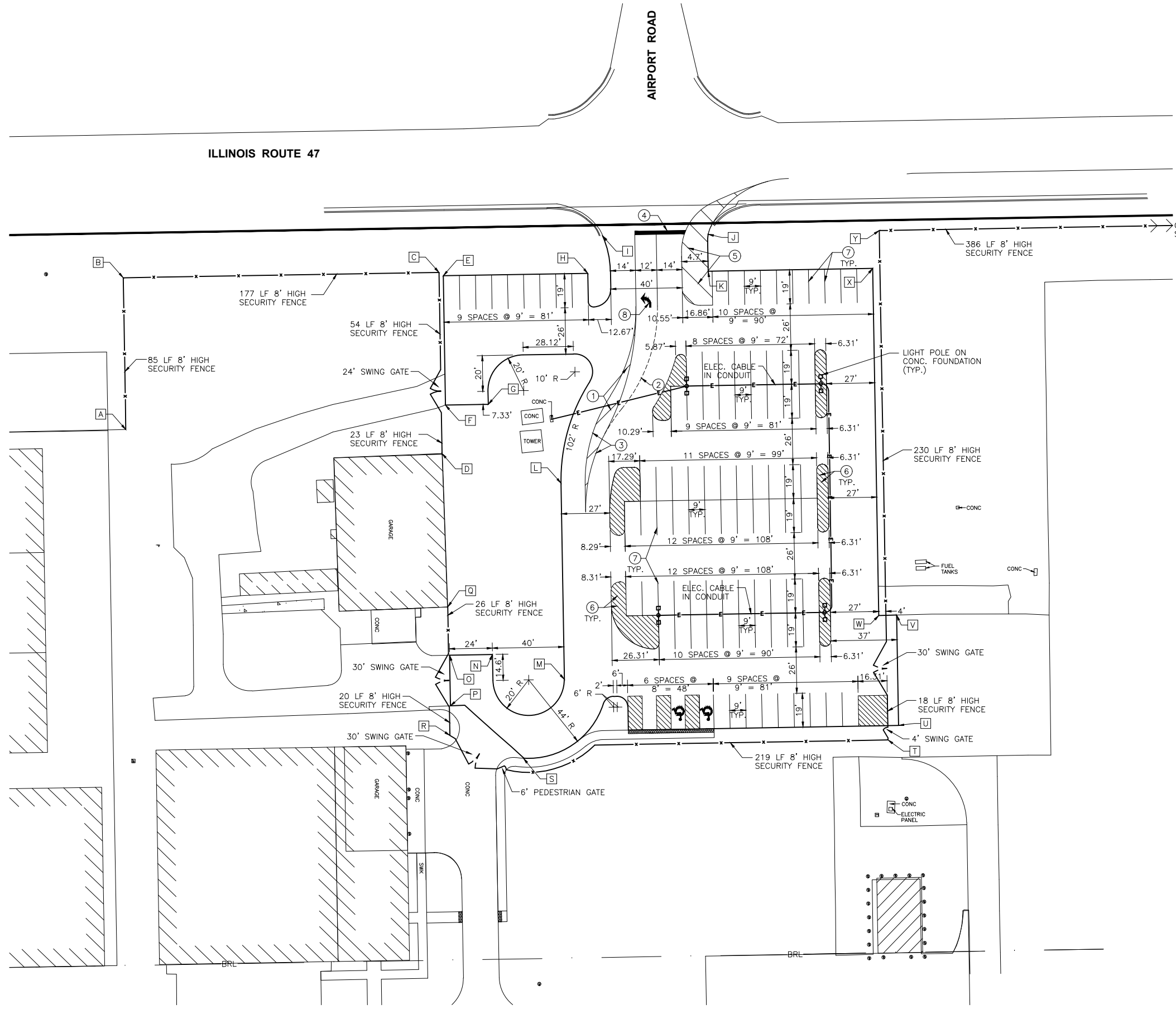

**PAVEMENT MARKING**

- ① 12" YELLOW PAVEMENT MARKING LINE, 10' O.C.
- ② 6" WHITE PAVEMENT MARKING LINE, 2' SKIP - 6' DASH
- ③ 4" DOUBLE YELLOW 11" C. TO C.
- ④ 24" WHITE PAVEMENT MARKING LINE
- ⑤ 12" WHITE PAVEMENT MARKING LINE, 10' O.C.
- ⑥ 4" YELLOW PAVEMENT MARKING LINE, 2' O.C.
- ⑦ 4" YELLOW PAVEMENT MARKING LINE
- ⑧ WHITE LETTER & SYMBOL PAVEMENT MARKING

CHAMLIN & ASSOCIATES, INC. © 2017  
 Drawing Name: H:\A\000-000-DIMLAY.dwg Last Modified: Nov 22, 2017 - 8:58am Plotted on: Nov 22, 2017 - 2:35pm by nick

DRAWN BY: NET	REVISIONS			
	LEVEL	BY	DATE	DESCRIPTION
CHECKED BY: CJM				
CREATED: 8/17				

PERU MORRIS  
 ILLINOIS

**MORRIS MUNICIPAL AIRPORT**  
 MORRIS, ILLINOIS

**DIMENSIONAL LAYOUT PLAN**

100%	CURRENT AS OF: 11/22/17
NOVEMBER 24, 2017	SCALE: AS NOTED
	SHEET 5
	OF 8
	FILE NO.: 1212.00

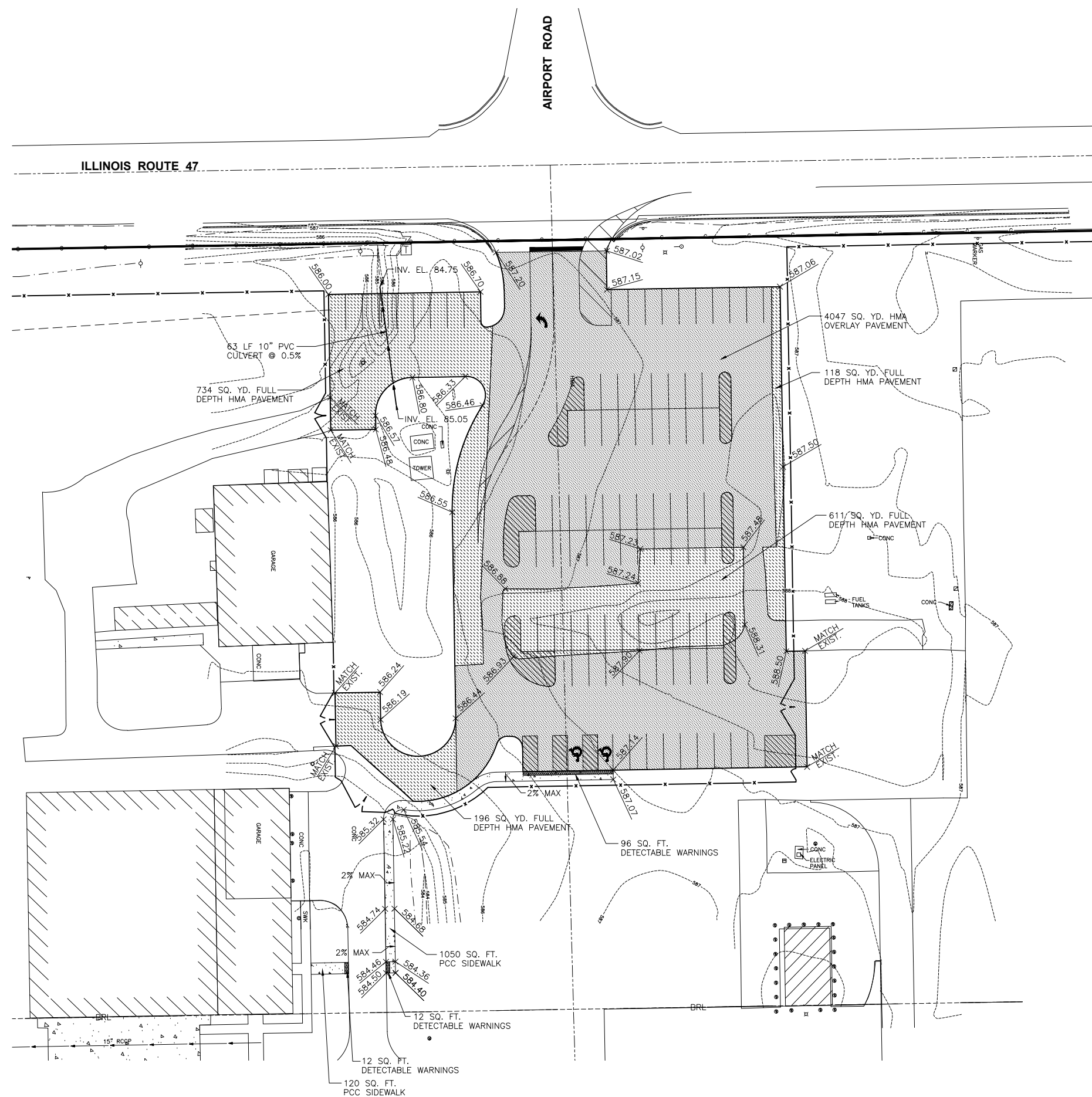
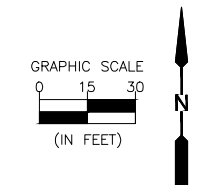

**LEGEND**

	PROPOSED MILL & OVERLAY PAVEMENT
	PROPOSED FULL DEPTH PAVEMENT
	PROPOSED PCC SIDEWALK

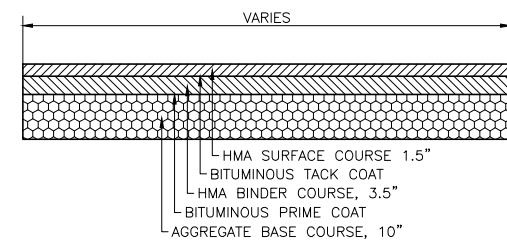

**FULL DEPTH PAVEMENT TYPICAL SECTION**

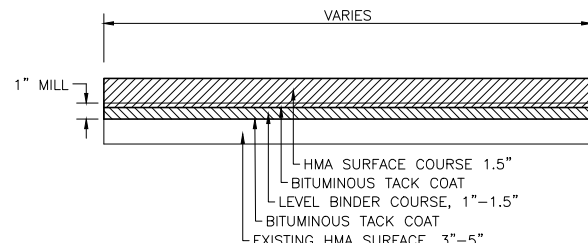

**MILL & OVERLAY TYPICAL SECTION**

CHAMLIN & ASSOCIATES, INC. © 2017  
 Drawing Name: H:\A\006\1212-00 Morris Airport Pkg Lot Imp 2017\CAD\006-GRADE.dwg Last Modified: Dec 07, 2017 - 4:09pm by nick  
 Dec 07, 2017 - 4:09pm Plotted on: Dec 07, 2017 - 4:09pm by nick

DRAWN BY: NET	REVISIONS			
CHECKED BY: CJM	LEVEL	BY	DATE	DESCRIPTION
CREATED: 8/17				

PERU MORRIS  
 ILLINOIS

**MORRIS MUNICIPAL AIRPORT**  
MORRIS, ILLINOIS

**GRADING & DRAINAGE PLAN**

100%	CURRENT AS OF: 12/07/17
NOVEMBER 24, 2017	SCALE: AS NOTED
	SHEET 6
	OF 8
	FILE NO.: 1212.00

**LUMINAIRE WIRING GENERAL NOTES**

Wiring for twin luminaire installation shown.  
Omit one fuse holder and one surge arrester with connections for single luminaire installation.

All conductors originating in pole shall be No. 10 unless noted otherwise.

Conductors extended into light poles shall be of a length sufficient for splices to be withdrawn 18 (450) out of pole handle.

Any voids in the foundation shall be filled with fine aggregate.

See Standard 836001 for Light Pole Foundation and ground rod.

All dimensions are in inches (millimeters) unless otherwise shown.

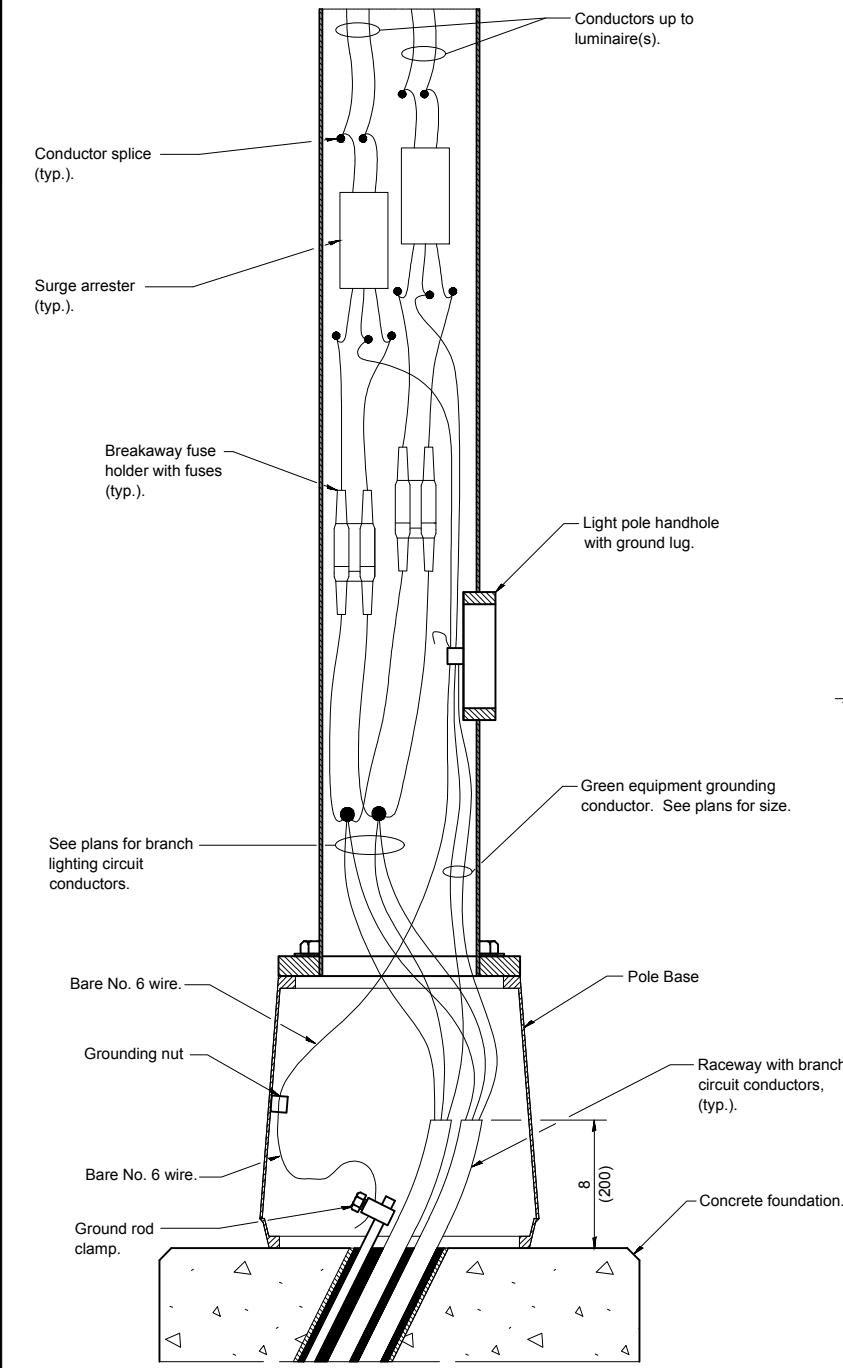

**LUMINAIRE WIRING ELEVATION AT POLE BASE WITH CONCRETE FOUNDATION**

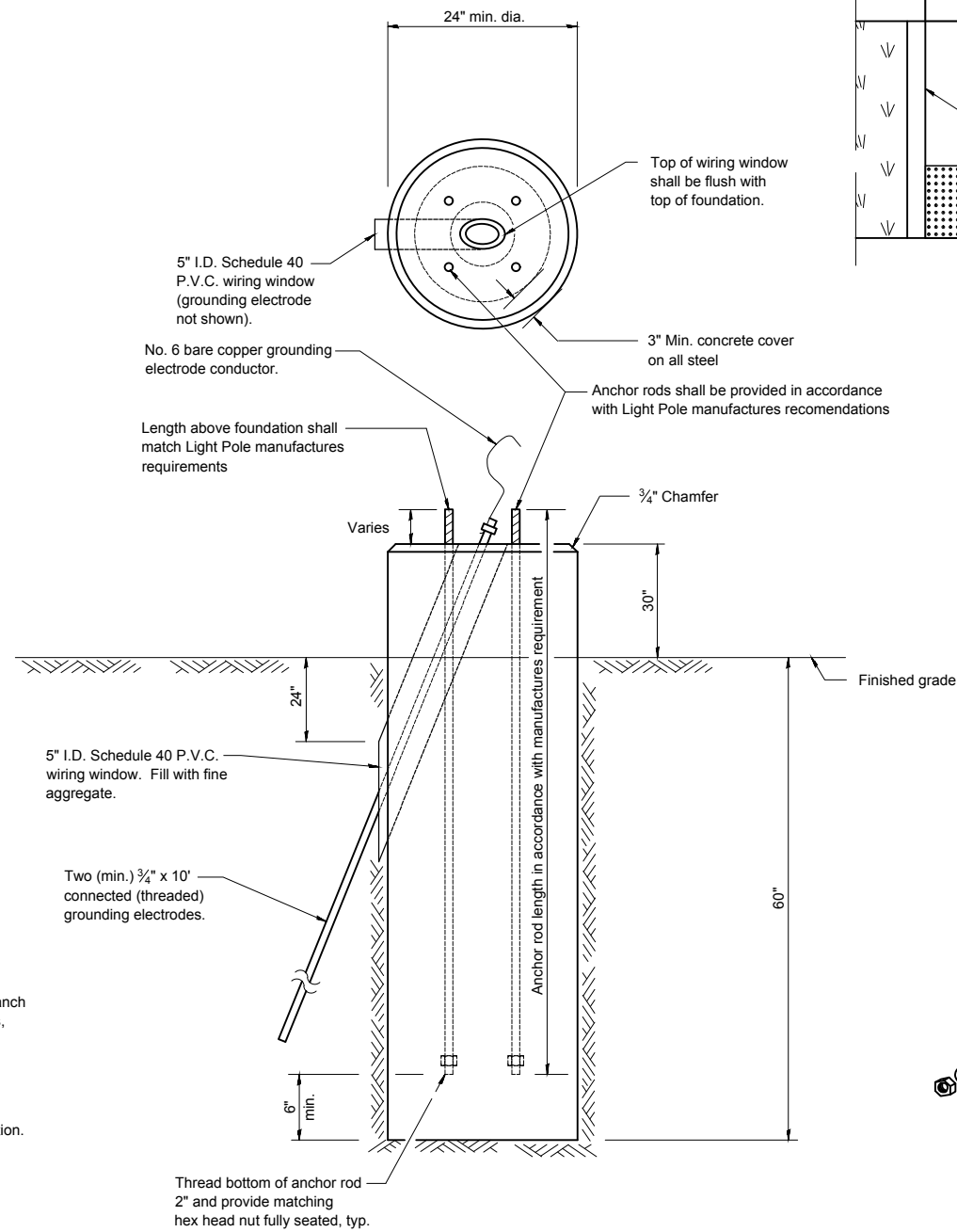

**LIGHT POLE CONCRETE FOUNDATION**

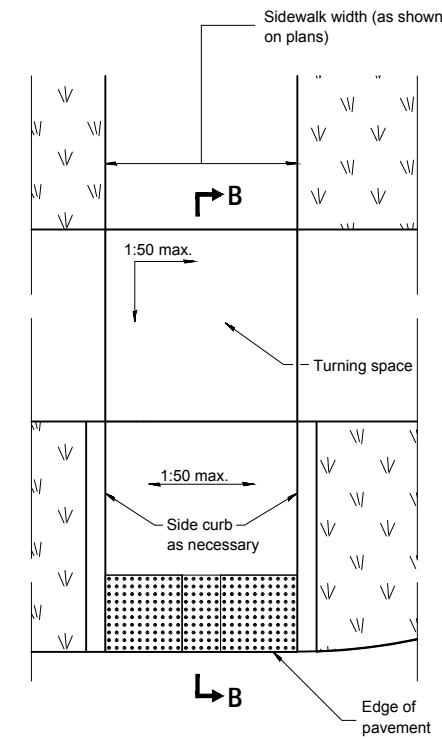

**PLAN VIEW**

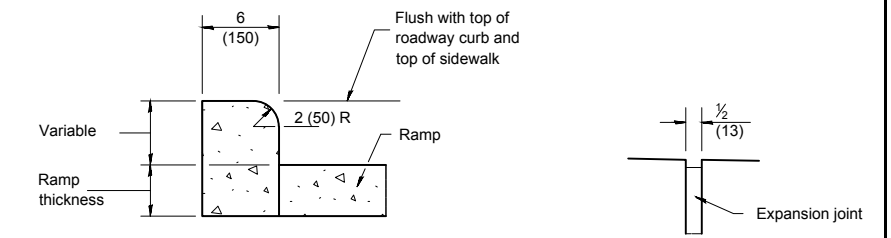

**SIDE CURB DETAIL**

**DETAIL A**

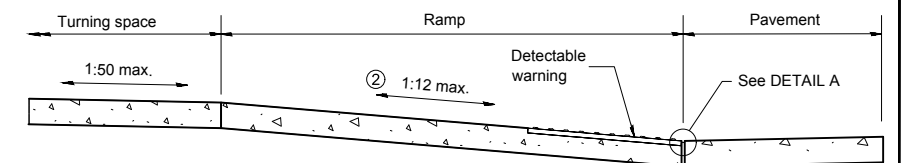

**SECTION B-B**

② The running slope of the curb ramp shall not require the ramp length to exceed 15' (4.5 m).

**CURB SIDEWALK RAMP**

Section modulus (minimum)	Axis A	Axis B
Steel	0.050 in. <sup>3</sup> (819 mm <sup>3</sup> )	0.105 in. <sup>3</sup> (1720 mm <sup>3</sup> )
Aluminum	0.150 in. <sup>3</sup> (2458 mm <sup>3</sup> )	0.315 in. <sup>3</sup> (5162 mm <sup>3</sup> )

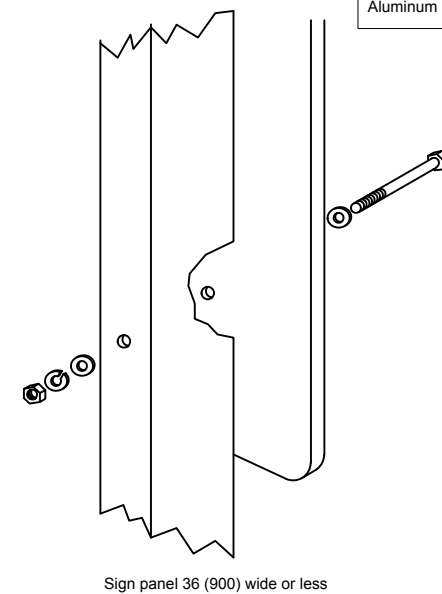

**TELESCOPING STEEL POSTS**

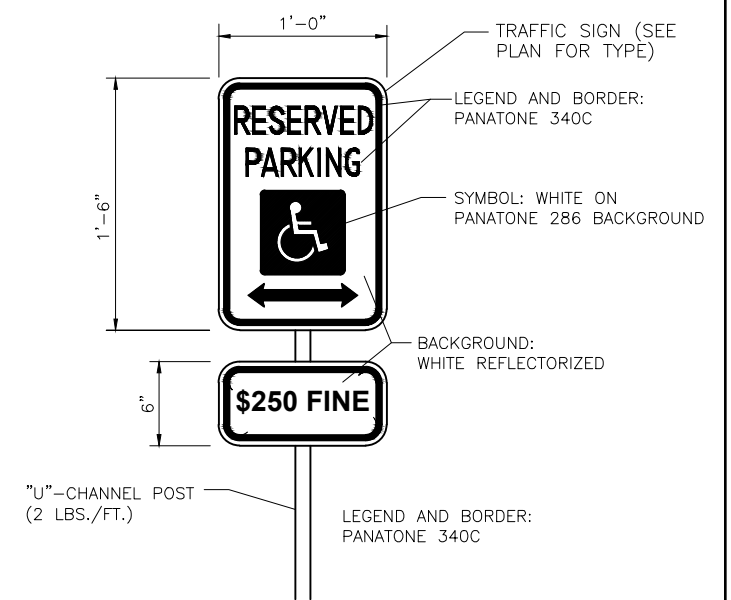

**HANDICAP SIGN ASSEMBLY**

CHAMLIN & ASSOCIATES, INC. © 2017. Drawing Name: H:\A\000\1\1212-00 Morris Airport Pkg Lot Imp 2017\CAD\007-DETAILS.dwg Last Modified: Nov 22, 2017 - 9:08am Plotted on: Nov 22, 2017 - 2:37pm by nickt

DRAWN BY: ARR	REVISIONS			
CHECKED BY: CJM	LEVEL	BY	DATE	DESCRIPTION
CREATED: 8/17				

**CHAMLIN & ASSOCIATES, INC.**  
PERU MORRIS ILLINOIS

**MORRIS MUNICIPAL AIRPORT**  
MORRIS, ILLINOIS

**DETAILS**

100%  
NOVEMBER 24, 2017

CURRENT AS OF: 11/22/17	SHEET 7
SCALE: AS NOTED	OF 8
FILE NO.:	

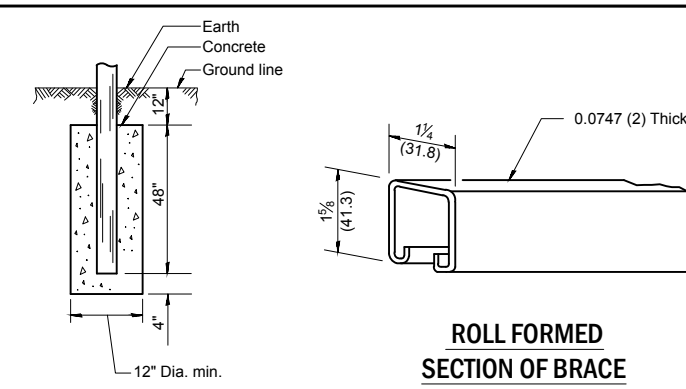
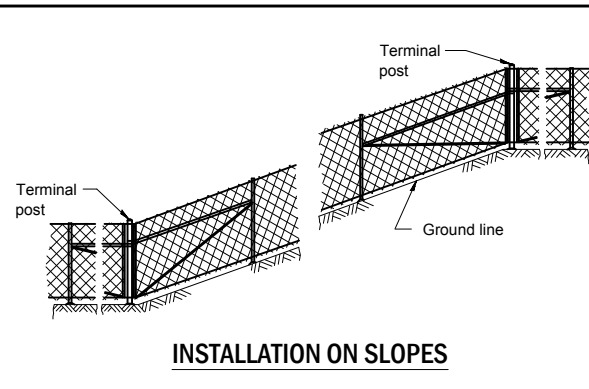
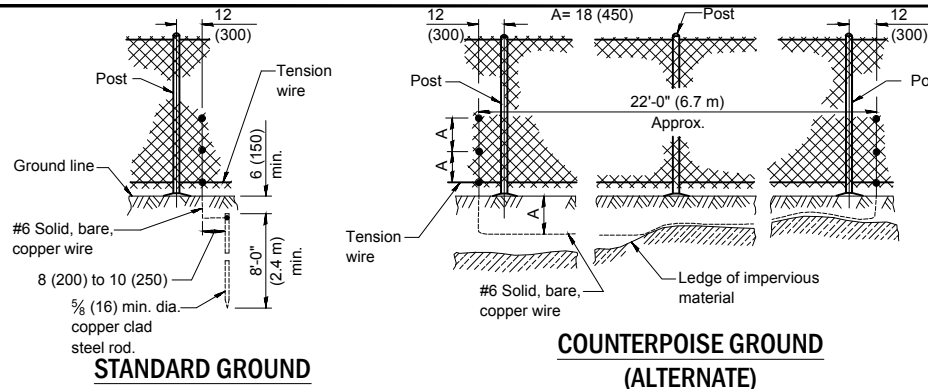

**GENERAL NOTES**  
 Pull posts shall be placed at locations determined by the Engineer. They shall be placed at 660' (200 m) intervals between posts to which the ends of the fabric are clamped or midway between such posts when the distance is less than 1320' (400 m) and greater than 660' (200 m).  
 X + Y shall not exceed 24 (600), 30 (750), or 36 (900), as applicable. When X is 0 - 9 (0 - 225), 15 (380), or 21 (525), then Y = 15 (375) and the post shall be shortened as required. When X exceeds 9 (225), 15 (380), or 21 (525), then Y shall be decreased correspondingly.  
 All dimensions are in inches (millimeters) unless otherwise shown.

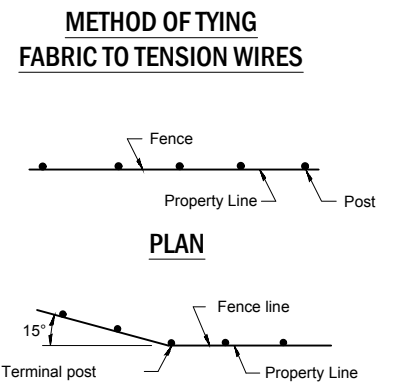
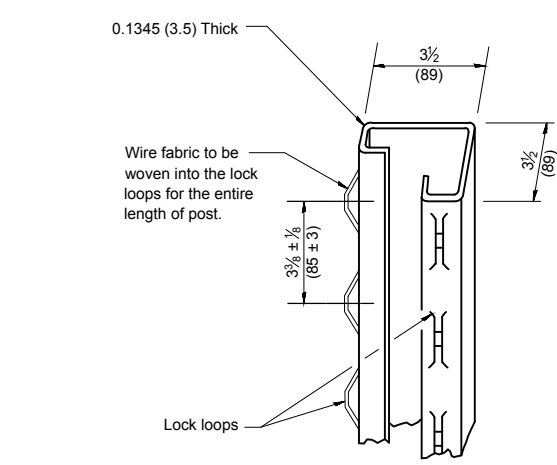
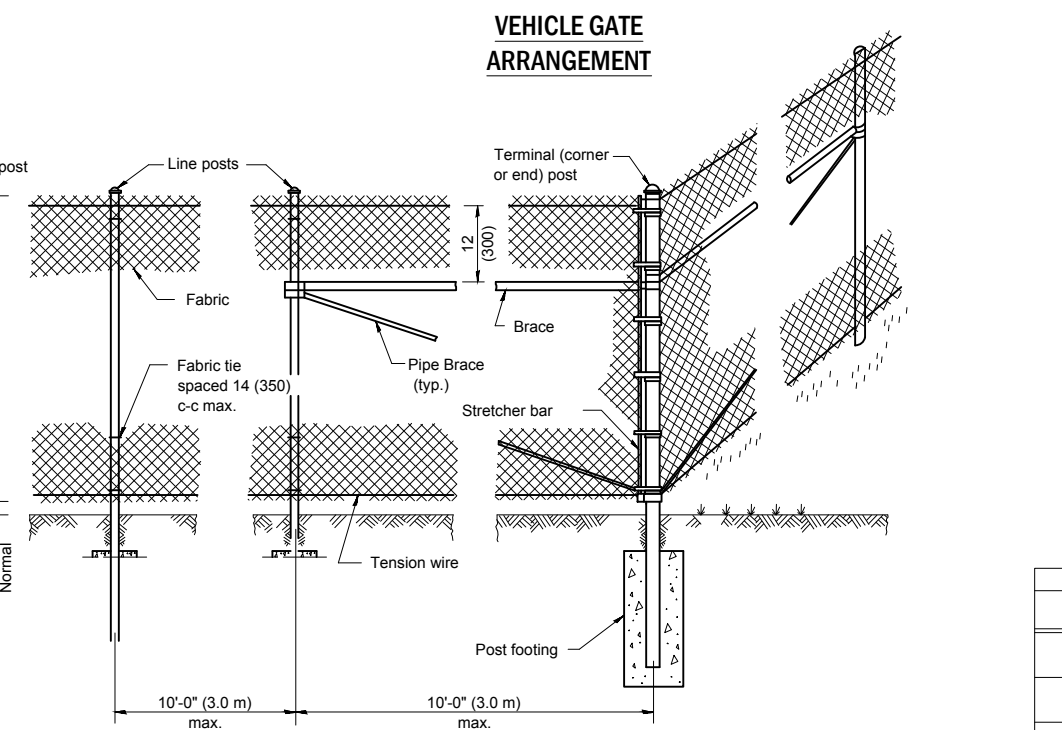
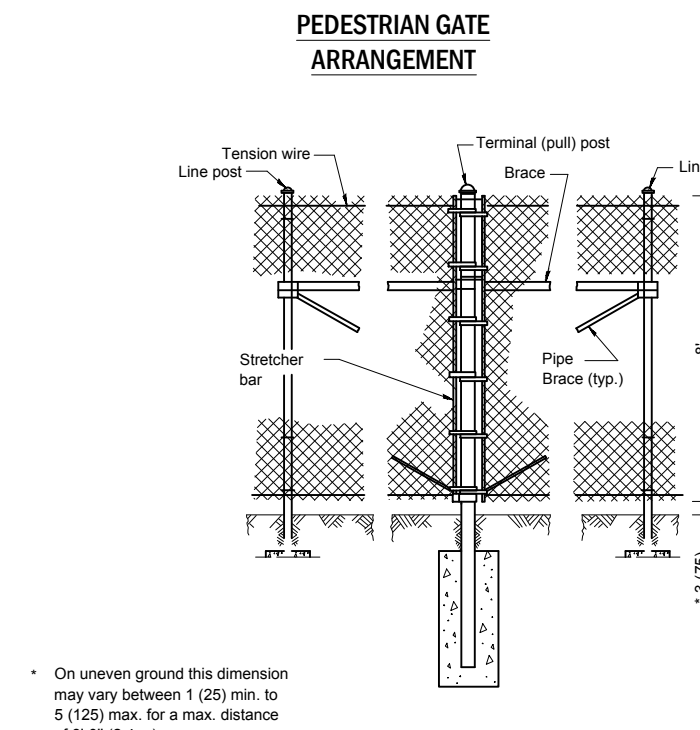
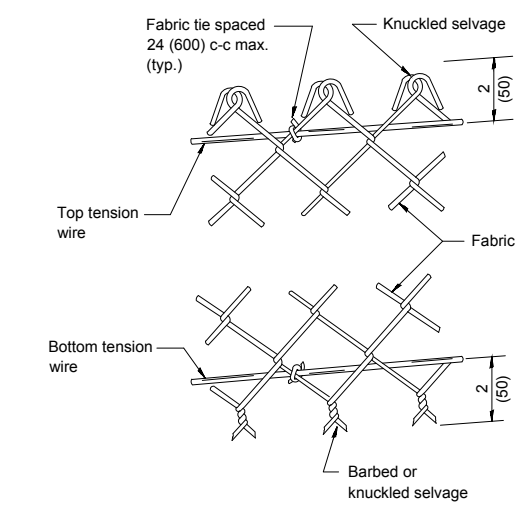
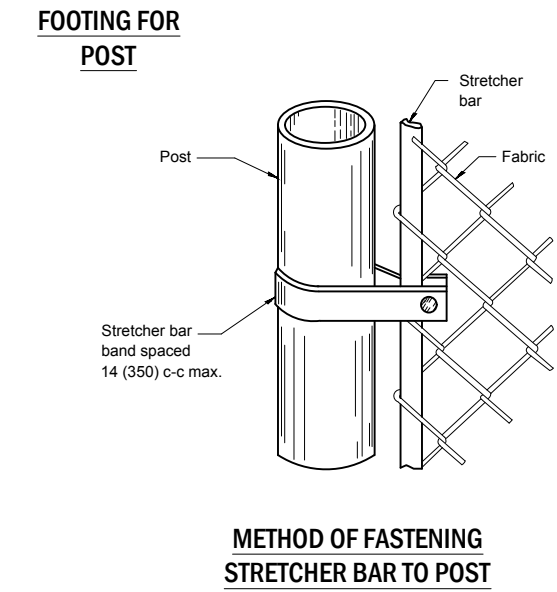
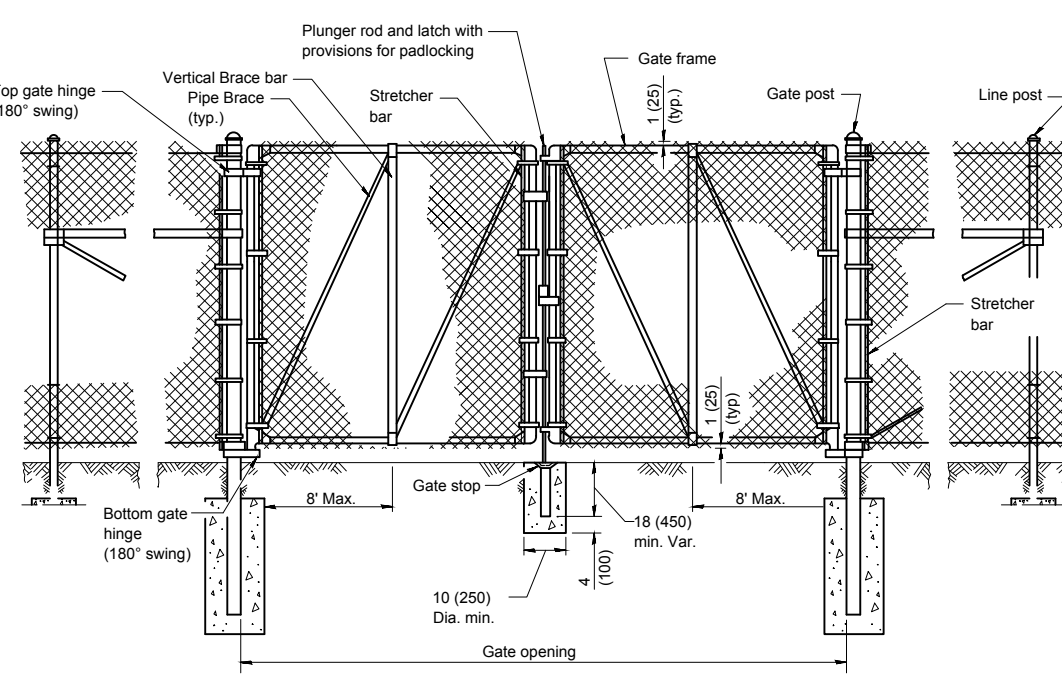
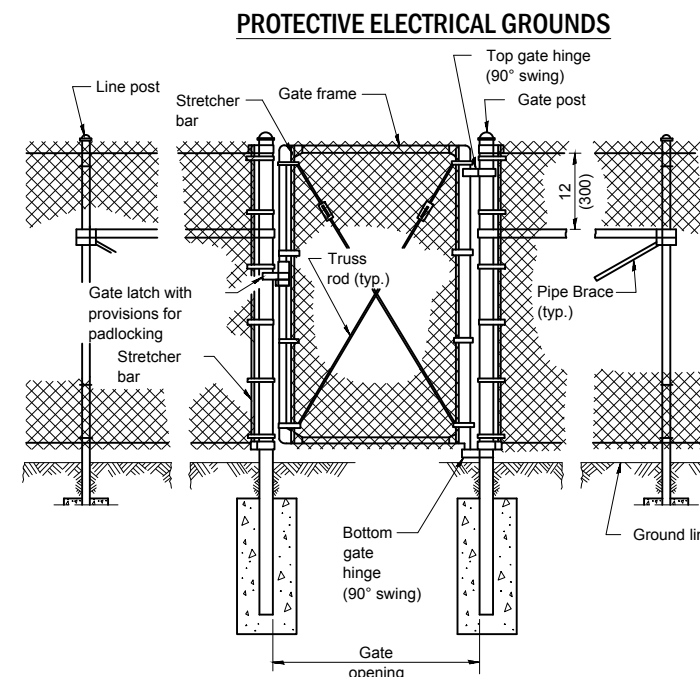

When fence line has a change in direction of 15° or more, a terminal post shall be placed as shown above.  
 Where angle is less than 15° and existing conditions require a terminal post, they shall be placed as directed by the Engineer.

\* On uneven ground this dimension may vary between 1 (25) min. to 5 (125) max. for a max. distance of 8'-0" (2.4 m).

POST & RAILS		
Section	Ty. A lbs./ft	Ty. A lbs./ft
Pipe 2.875" O.D.	5.80	4.64
Pipe 3.5" O.D.	7.58	5.71
Pipe 1.66" O.D.	2.27	1.84
Pipe 2" O.D.	2.75	N/A

GATE POSTS *			
Gate Opening * ft. (m)		Pipe Type A	
Single	Double	Size (O.D.)	lbs./ft. (kg/m)
Up to 4 (1.2)	Up to 8 (2.5)	2.375 (60.3)	5.79 (8.62)
Over 4 (1.2) to 8 (2.5)	Over 8 (2.5) to 16 (5.0)	2.875 (73.0)	5.79 (8.62)
Over 8 (2.5) to 12 (3.6)	Over 16 (5.0) to 24 (7.4)	3.5 (89.0)	7.58 (11.28)

CHAMLIN & ASSOCIATES, INC. © 2017. Drawing Name: H:\A\08\11\1212-00 Morris Airport Pkg Lot Imp 2017\CAD\007-DETAILS.dwg Last Modified: Nov 22, 2017 - 9:08am Plotted on: Nov 22, 2017 - 2:38pm by nickt

DRAWN BY: ARR	REVISIONS			
CHECKED BY: CJM	LEVEL	BY	DATE	DESCRIPTION
CREATED: 8/17				

**CHAMLIN & ASSOCIATES, INC.**  
 PERU MORRIS ILLINOIS

**MORRIS MUNICIPAL AIRPORT**  
 MORRIS, ILLINOIS

**DETAILS**

100% NOVEMBER 24, 2017  
 CURRENT AS OF: 11/22/17  
 SCALE: AS NOTED SHEET 8  
 FILE NO.: 1212.00 OF 8