



**GENERAL NOTES**

ALL EXCAVATED MATERIALS, WHICH INCLUDES DIGGING OR GRADING OF ANY SOIL OR FILL MATERIAL, WITH THE EXCEPTION OF AGGREGATE FILLS, MUST BE INCORPORATED WITHIN THE LIMITS OF THE IDOT RIGHT OF WAY.

**COMMITMENTS**

PRIOR TO BEGINNING ANY CONSTRUCTION WORK ON THIS PROJECT, THE CONTRACTOR SHALL COORDINATE PERMANENT PAVEMENT STRIPING WORK WITH THE IDOT, BUREAU OF OPERATIONS, TRAFFIC SECTION, PHONE (815) 434-8446.

**STATE OF ILLINOIS  
DEPARTMENT OF TRANSPORTATION  
DISTRICT THREE  
AS BUILT INFORMATION**

\_\_\_\_\_  
**SUPERVISING CONSTRUCTION FIELD ENGINEER**

\_\_\_\_\_  
**RESIDENT ENGINEER / TECHNICIAN**

**START & END DATES  
OF CONSTRUCTION:**

**INSPECTORS:**

MODEL: \$MODELNAME\$  
FILE NAME: \$FILE\$

USER NAME = \$USER\$	DESIGNED - RW	REVISED - ____
	DRAWN - RW	REVISED - ____
PLOT SCALE = \$SCALE\$	CHECKED - YP	REVISED - ____
PLOT DATE = \$DATE\$	DATE - 9/20/22023	REVISED - ____

**STATE OF ILLINOIS  
DEPARTMENT OF TRANSPORTATION**

**GENERAL NOTES**

SCALE: \_\_\_\_ SHEET 1 OF 1 SHEETS STA. \_\_\_\_ TO STA. \_\_\_\_

F.A.S. RTE.	SECTION	COUNTY	TOTAL SHEETS	SHEET NO.
1522	(31X)PP-2	FORD	8	2
			CONTRACT NO. 66N94	
		ILLINOIS	FED. AID PROJECT	

CODE NO.	ITEM	UNIT	TOTAL QUANTITY	CONSTRUCTION CODE	
				CONTRACT MAINTENANCE	100% STATE
				ROADWAY	
				0006	
				RURAL	
44200050	WELDED WIRE REINFORCEMENT	SQ YD	124	124	
44200994	CLASS B PATCHES, TYPE II, 12 INCH	SQ YD	132	132	
44200998	CLASS B PATCHES, TYPE III, 12 INCH	SQ YD	109	109	
44201063	CLASS B PATCHES, TYPE II, 18 INCH	SQ YD	54	54	
44201067	CLASS B PATCHES, TYPE III, 18 INCH	SQ YD	15	15	
44201297	DOWEL BARS 1"	EACH	120	120	
44201299	DOWEL BARS 1 1/2"	EACH	380	380	
44213200	SAW CUTS	FOOT	1493	1493	
67100100	MOBILIZATION	L SUM	1	1	
70100600	TRAFFIC CONTROL AND PROTECTION, STANDARD 701336	L SUM	1	1	
Z0030850	TEMPORARY INFORMATION SIGNING	SQ FT	42	42	

MODEL: \$MODELNAME\$  
FILE NAME: \$FILE\$

USER NAME = \$USERS\$	DESIGNED - RW	REVISED - _____
	DRAWN - RW	REVISED - _____
PLOT SCALE = \$SCALE\$	CHECKED - YP	REVISED - _____
PLOT DATE = \$DATE\$	DATE - 9/20/2023	REVISED - _____

**STATE OF ILLINOIS  
DEPARTMENT OF TRANSPORTATION**

SUMMARY OF QUANTITIES	
SCALE: _____	SHEET 1 OF 1 SHEETS STA. _____ TO STA. _____

F.A.S. RTE.	SECTION	COUNTY	TOTAL SHEETS	SHEET NO.
1522	(31X)PP-2	FORD	8	3
CONTRACT NO. 66N94				
ILLINOIS FED. AID PROJECT				

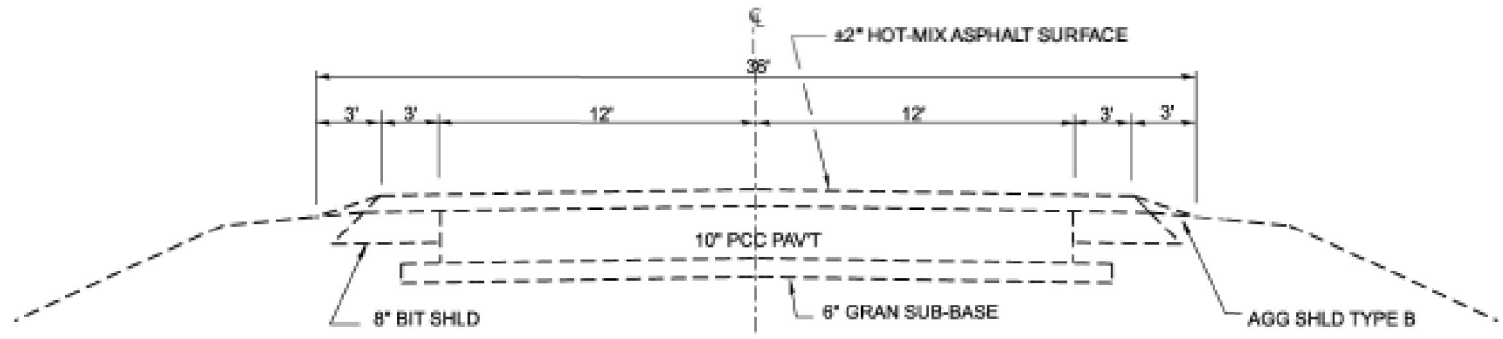

**EXISTING TYPICAL SECTION NO. 1**  
**L.M. 0.00 (FORD/CHAMPAIGN COUNTY LINE) TO L.M. 2.28**

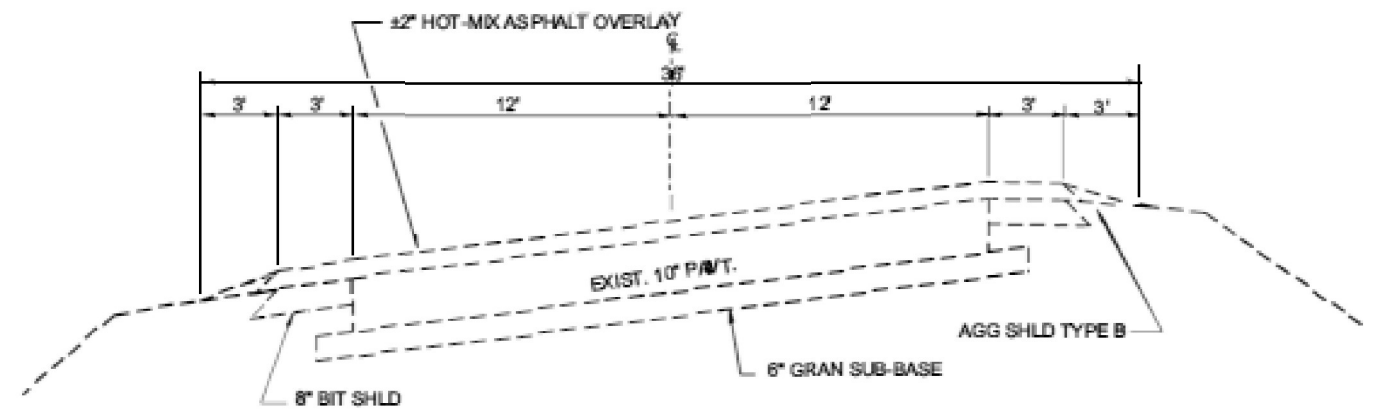

**EXISTING TYPICAL SECTION NO. 2**  
**L.M. 2.28 TO L.M. 2.57**

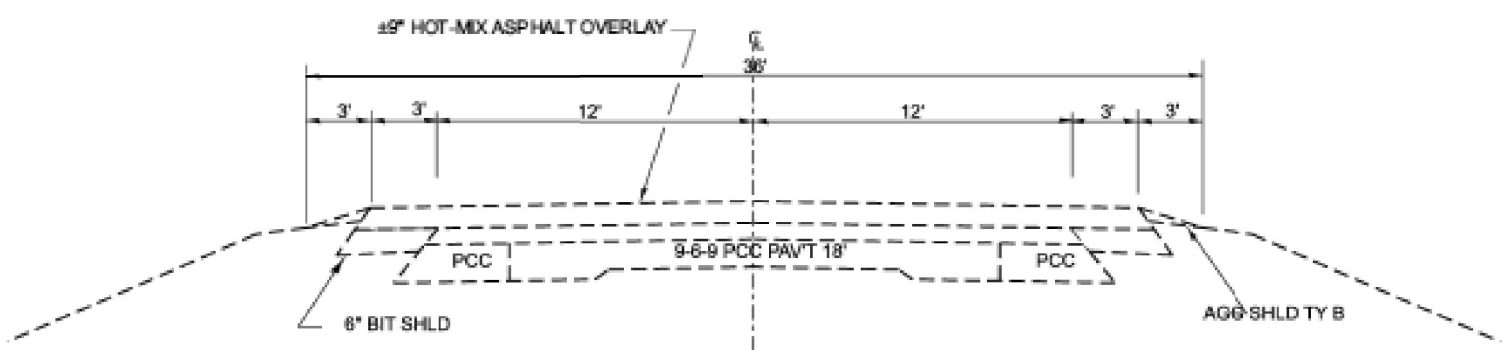

**EXISTING TYPICAL SECTION NO. 3**  
**L.M. 2.57 TO L.M. 3.28 (GREEN STREET IN PAXTON)**

MODEL: SMODELNAMES  
 FILE NAME: SPEL13

USER NAME = \$USERS	DESIGNED - RW	REVISED - ____
	DRAWN - RW	REVISED - ____
PLOT SCALE = \$\$SCALES	CHECKED - YP	REVISED - ____
PLOT DATE = \$DATES	DATE - 9/20/22023	REVISED - ____

**STATE OF ILLINOIS**  
**DEPARTMENT OF TRANSPORTATION**

<b>TYPICAL SECTIONS</b>	
SCALE: ____	SHEET 1 OF 1 SHEETS STA. ____ TO STA. ____

F.A.S. RTE.	SECTION	COUNTY	TOTAL SHEETS	SHEET NO.
1522	(31X)PP-2	FORD	8	4
CONTRACT NO. 66N94				
ILLINOIS FED. AID PROJECT				

**PATCHING SCHEDULE - NORTHBOUND LANE**

LOCATION	PATCH LENGTH	PATCH WIDTH	CLASS B		CLASS B		DOWEL BARS 1"	DOWEL BARS 1 1/4"	SAW CUTS	WELDED WIRE REINF.
			TYPE II 12"	TYPE III 12"	TYPE II 18"	TYPE III 18"				
LOG MILE	FEET	FEET	SQ YD	SQ YD	SQ YD	SQ YD	EACH	EACH	FOOT	SQ YD
0.00	FORD/CHAMPAIGN COUNTY LINE									
0.10	6	15	10					20	57	
0.30	7	15	12					20	59	
0.50	7	15	12					20	59	
0.80	6	15	10					20	57	
0.90	9	15		15				20	63	15
1.40	9	15		15				20	63	15
1.50	10	15		17				20	65	17
1.80	7	15	12					20	59	
1.90	7	15	12					20	59	
2.10	6	15	10					20	57	
2.30	9	15		15				20	63	15
2.40	6	15	10					20	57	
3.28	GREEN STREET IN PAXTON									
<b>TOTAL</b>			<b>88</b>	<b>62</b>				<b>240</b>	<b>718</b>	<b>62</b>

**PATCHING SCHEDULE - SOUTHBOUND LANE**

LOCATION	PATCH LENGTH	PATCH WIDTH	CLASS B		CLASS B		DOWEL BARS 1"	DOWEL BARS 1 1/4"	SAW CUTS	WELDED WIRE REINF.
			TYPE II 12"	TYPE III 12"	TYPE II 18"	TYPE III 18"				
LOG MILE	FEET	FEET	SQ YD	SQ YD	SQ YD	SQ YD	EACH	EACH	FOOT	SQ YD
3.28	GREEN STREET IN PAXTON									
3.28	6	15			10			20		57
3.18	6	15			10			20		57
2.88	7	15			12			20		59
2.83	7	15			12			20		59
2.68	6	15			10			20		57
2.66	9	15				15		20		63
2.48	9	15		15				20	63	15
2.38	10	15		17				20	65	17
1.98	7	15	12					20	59	
1.68	7	15	12					20	59	
1.38	6	15	10					20	57	
1.18	9	15		15				20	63	15
0.98	6	15	10					20	57	
0.00	FORD/CHAMPAIGN COUNTY LINE									
<b>TOTAL</b>			<b>44</b>	<b>47</b>	<b>54</b>	<b>15</b>		<b>120</b>	<b>140</b>	<b>775</b>

MODEL: \$MODELNAME\$  
FILE NAME: \$FILE\$

USER NAME = \$USERS\$	DESIGNED - RW	REVISED - _____
	DRAWN - RW	REVISED - _____
PLOT SCALE = \$SCALE\$	CHECKED - YP	REVISED - _____
PLOT DATE = \$DATE\$	DATE - 9/20/22023	REVISED - _____

**STATE OF ILLINOIS  
DEPARTMENT OF TRANSPORTATION**

**SCHEDULES**

SCALE: \_\_\_\_\_ SHEET 1 OF 1 SHEETS STA. \_\_\_\_\_ TO STA. \_\_\_\_\_

F.A.S. RTE.	SECTION	COUNTY	TOTAL SHEETS	SHEET NO.
1522	(31X)PP-2	FORD	8	5
CONTRACT NO. 66N94				
ILLINOIS FED. AID PROJECT				

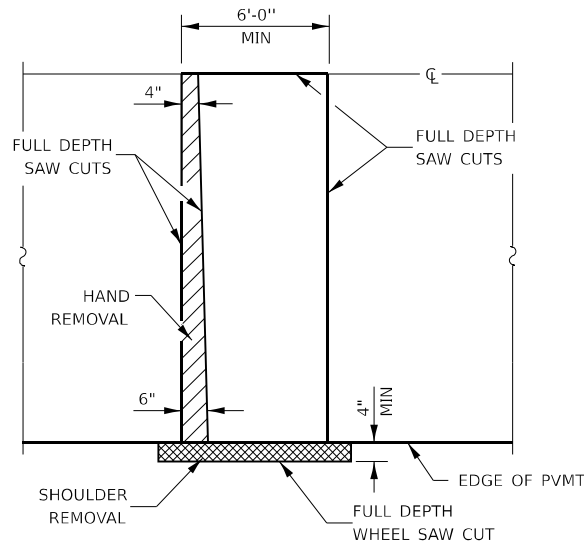

**PAVEMENT SAWING DETAIL**

(HMA SHOULDER)

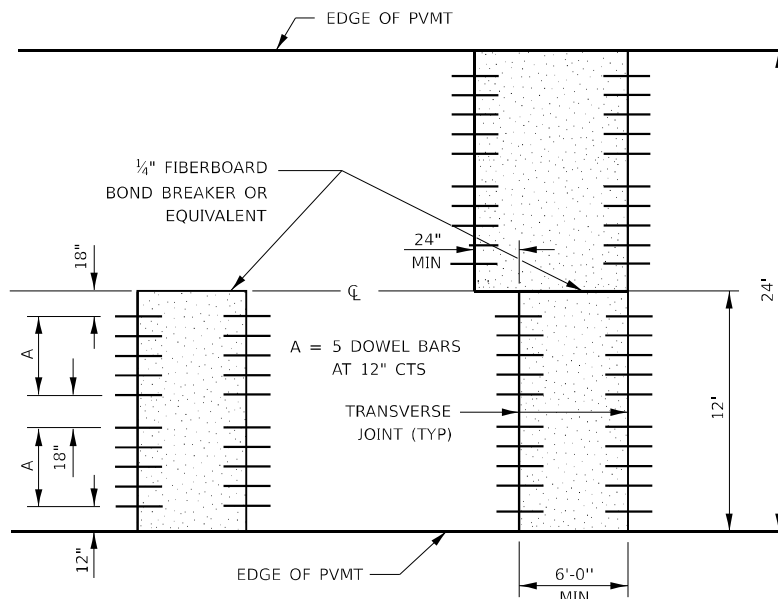

**12' WIDE LANES**

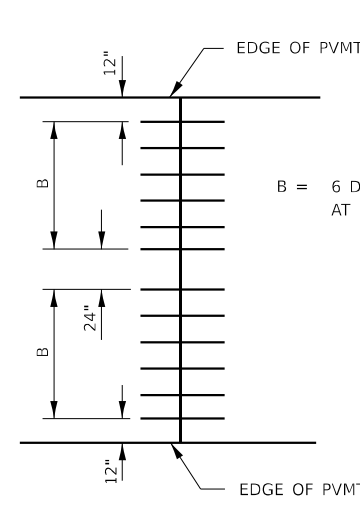

**14' WIDE RAMP**

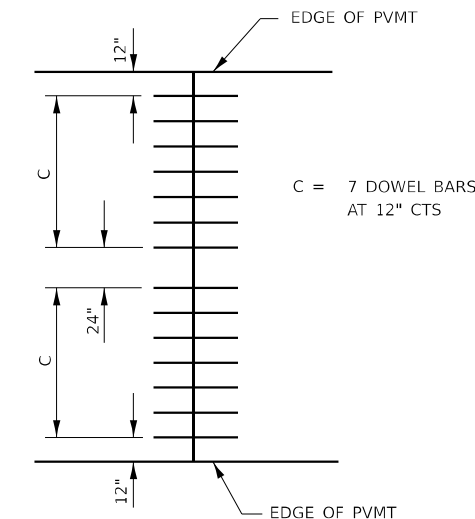

**16' WIDE RAMP**

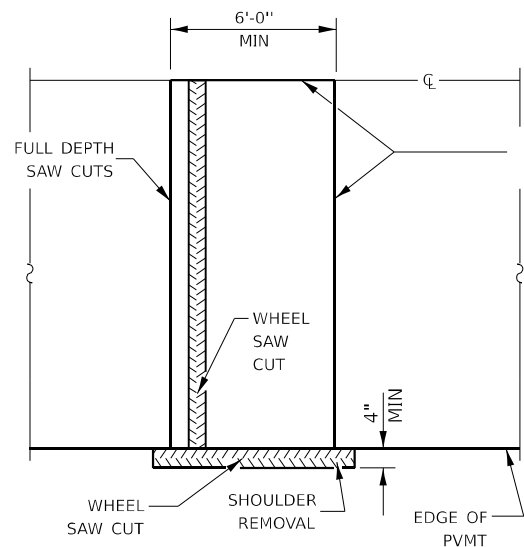

**ALTERNATE SAWING DETAIL**

(HMA SHOULDER)

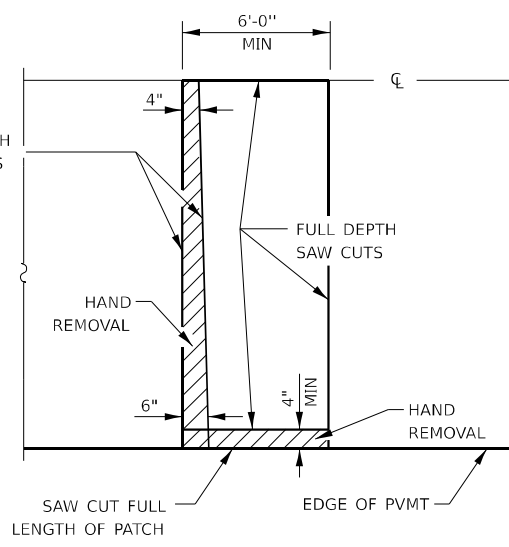

**PAVEMENT SAWING DETAIL**

(PCC SHOULDER)

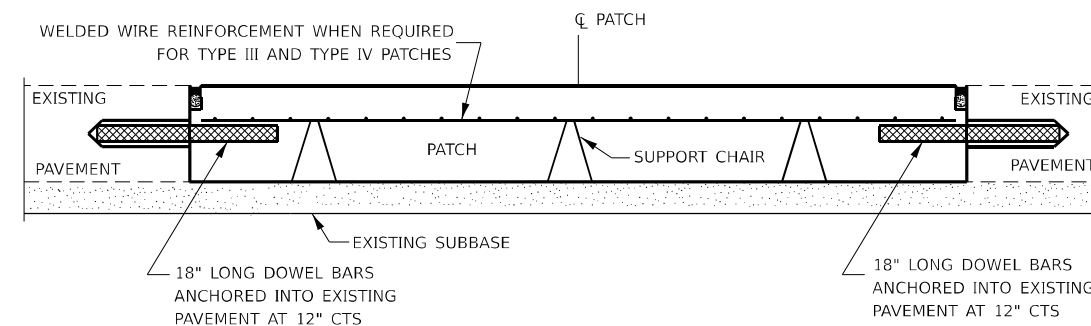

**PATCHING WITHOUT HMA OVERLAY**

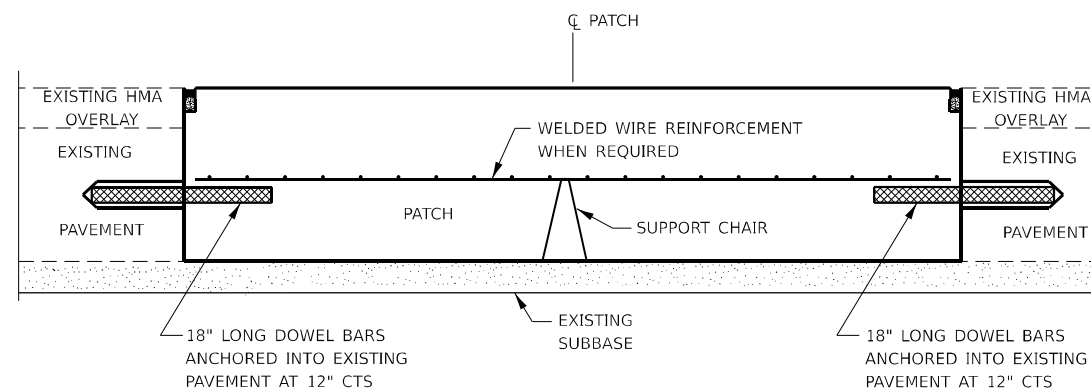

**PATCHING WITH HMA OVERLAY**

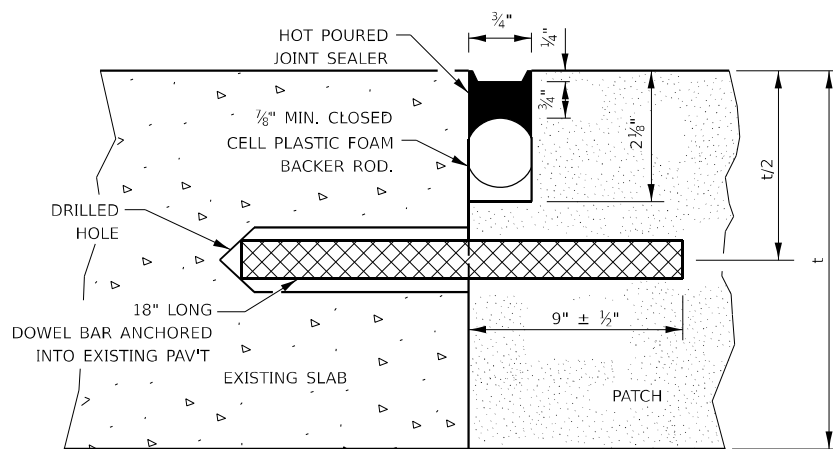

**TRANSVERSE JOINT**

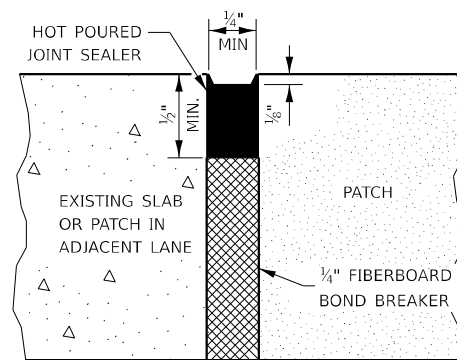

**CENTERLINE JOINT**

DOWEL BAR TABLE		
PAVEMENT THICKNESS	DOWEL BAR DIAMETER	HOLE DIAMETER
8" OR GREATER	1 1/2"	1 3/8"
7" THRU 7.99"	1 1/4"	1 3/8"
LESS THAN 7"	1"	1 1/8"

**GENERAL NOTES**

THE TRANSVERSE JOINTS FOR CLASS B PATCHES SHALL ALIGN WITH JOINTS OR CRACKS IN THE ADJACENT LANE WHENEVER POSSIBLE.

SEE STANDARD 420701 FOR DETAILS OF PAVEMENT WELDED WIRE REINFORCEMENT.

MODEL: SMOELNAMES  
FILE NAME: SPELES

USER NAME = \$USERS\$	DESIGNED - RW	REVISED -
PLOT SCALE = \$SCALES\$	DRAWN - RW	REVISED -
PLOT DATE = \$DATES\$	CHECKED - YP	REVISED -
	DATE - 9/20/22023	REVISED -

**STATE OF ILLINOIS  
DEPARTMENT OF TRANSPORTATION**

**CLASS B PATCHING DETAILS**

SCALE: \_\_\_\_\_ SHEET 1 OF 2 SHEETS STA. \_\_\_\_\_ TO STA. \_\_\_\_\_

F.A.S. RTE.	SECTION	COUNTY	TOTAL SHEETS	SHEET NO.
1522	(31X)PP-2	FORD	8	6
CONTRACT NO. 66N94				
ILLINOIS FED. AID PROJECT				

**TRANSVERSE EXPANSION JOINTS**

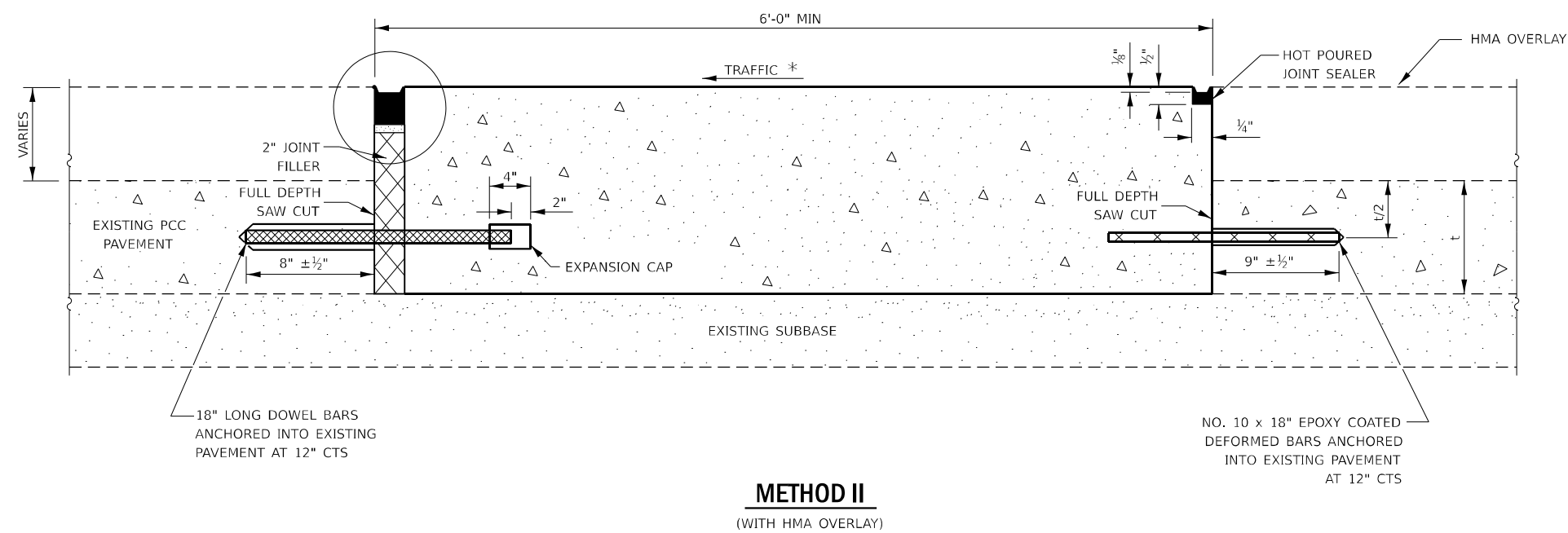
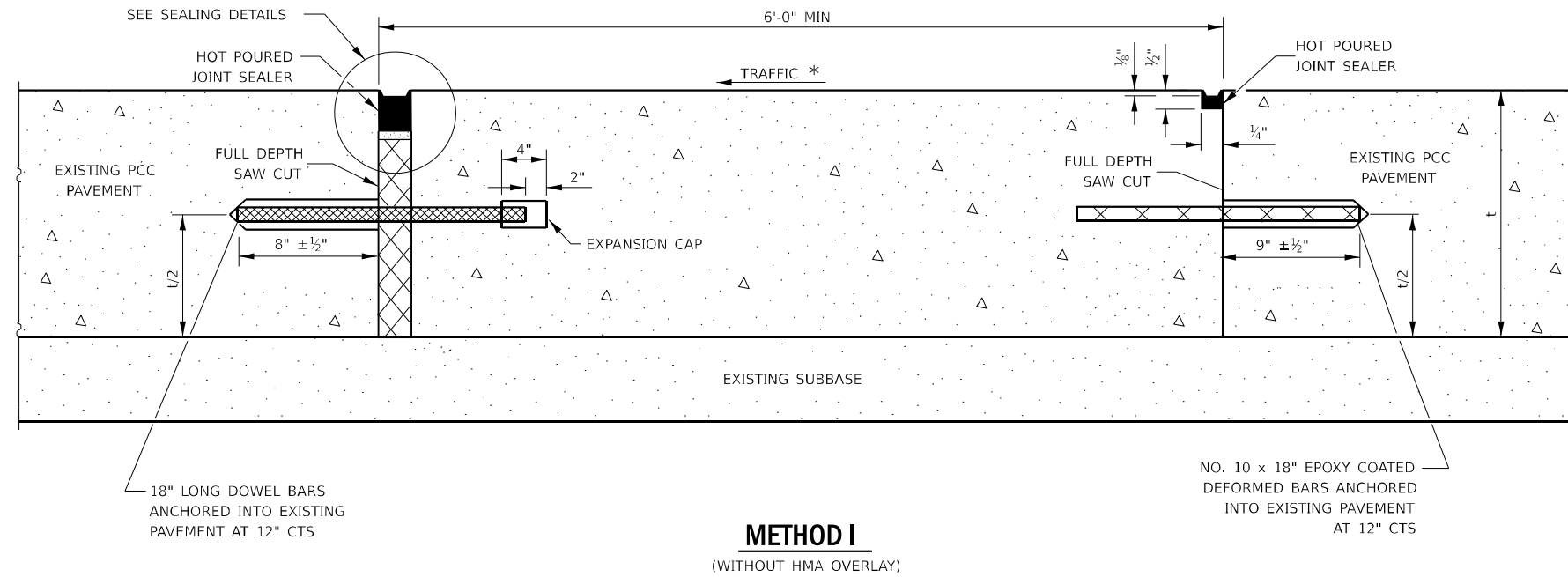

**NOTE**

\* WHEN RE-ESTABLISHING A TRANSVERSE EXPANSION JOINT ON A TWO-WAY ROAD, REVERSE THE ORIENTATION OF THE DOWEL BARS WITH RESPECT TO TRAFFIC FOR ONE OF THE PATCHES SUCH THAT THE JOINT WILL BE CONTINUOUS ACROSS BOTH LANES.

MODEL: \$MODELNAME\$  
FILE NAME: \$FILE\$

USER NAME = \$USER\$	DESIGNED - RW	REVISED - _____
	DRAWN - RW	REVISED - _____
PLOT SCALE = \$SCALE\$	CHECKED - YP	REVISED - _____
PLOT DATE = \$DATE\$	DATE - 9/20/2023	REVISED - _____

**STATE OF ILLINOIS**  
**DEPARTMENT OF TRANSPORTATION**

**CLASS B PASTCHING DETAILS**

SCALE: \_\_\_\_\_ SHEET 2 OF 2 SHEETS STA. \_\_\_\_\_ TO STA. \_\_\_\_\_

F.A.S. RTE.	SECTION	COUNTY	TOTAL SHEETS	SHEET NO.
1522	(31X)PP-2	FORD	7	8
CONTRACT NO. 66N94				
ILLINOIS FED. AID PROJECT				

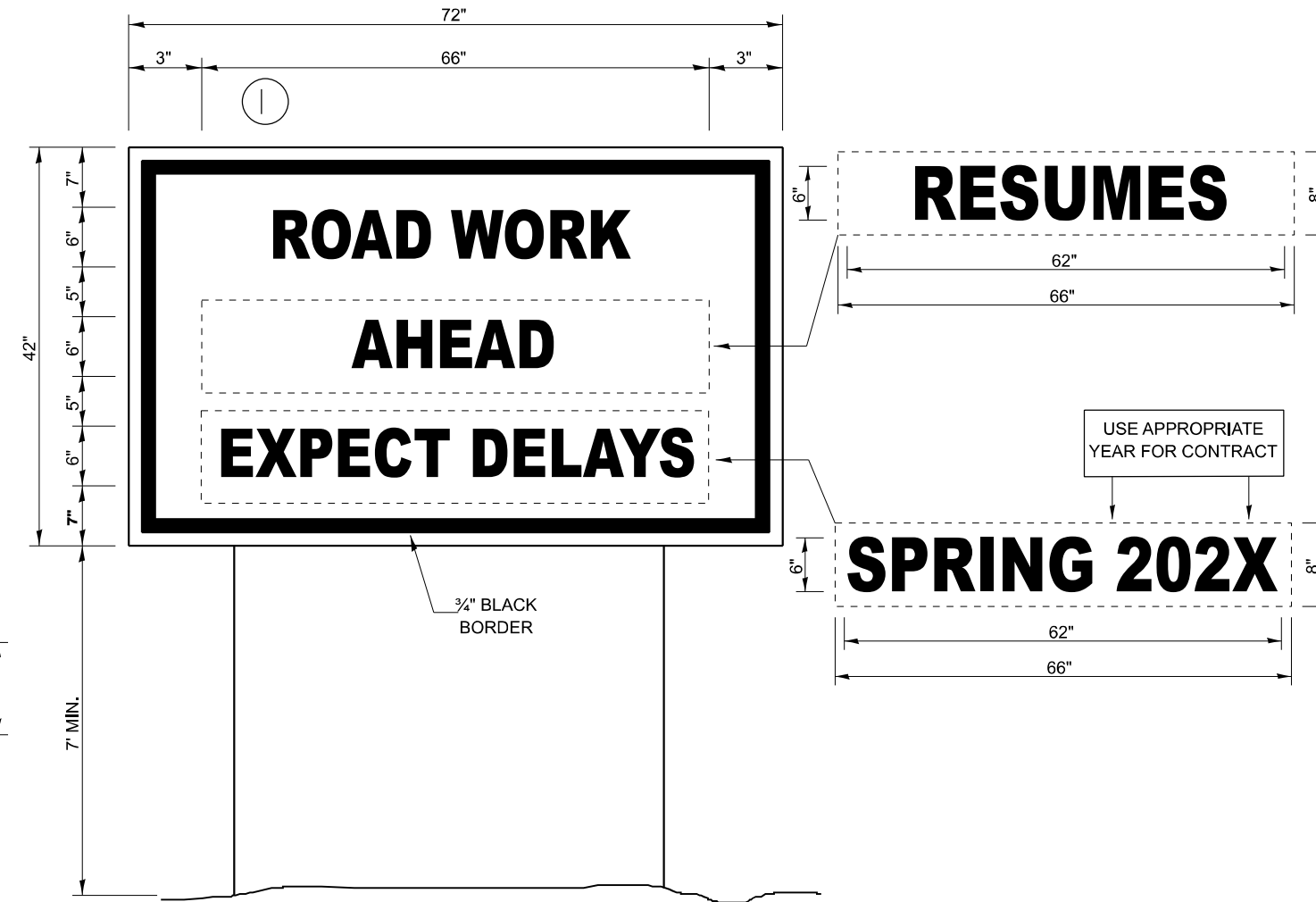
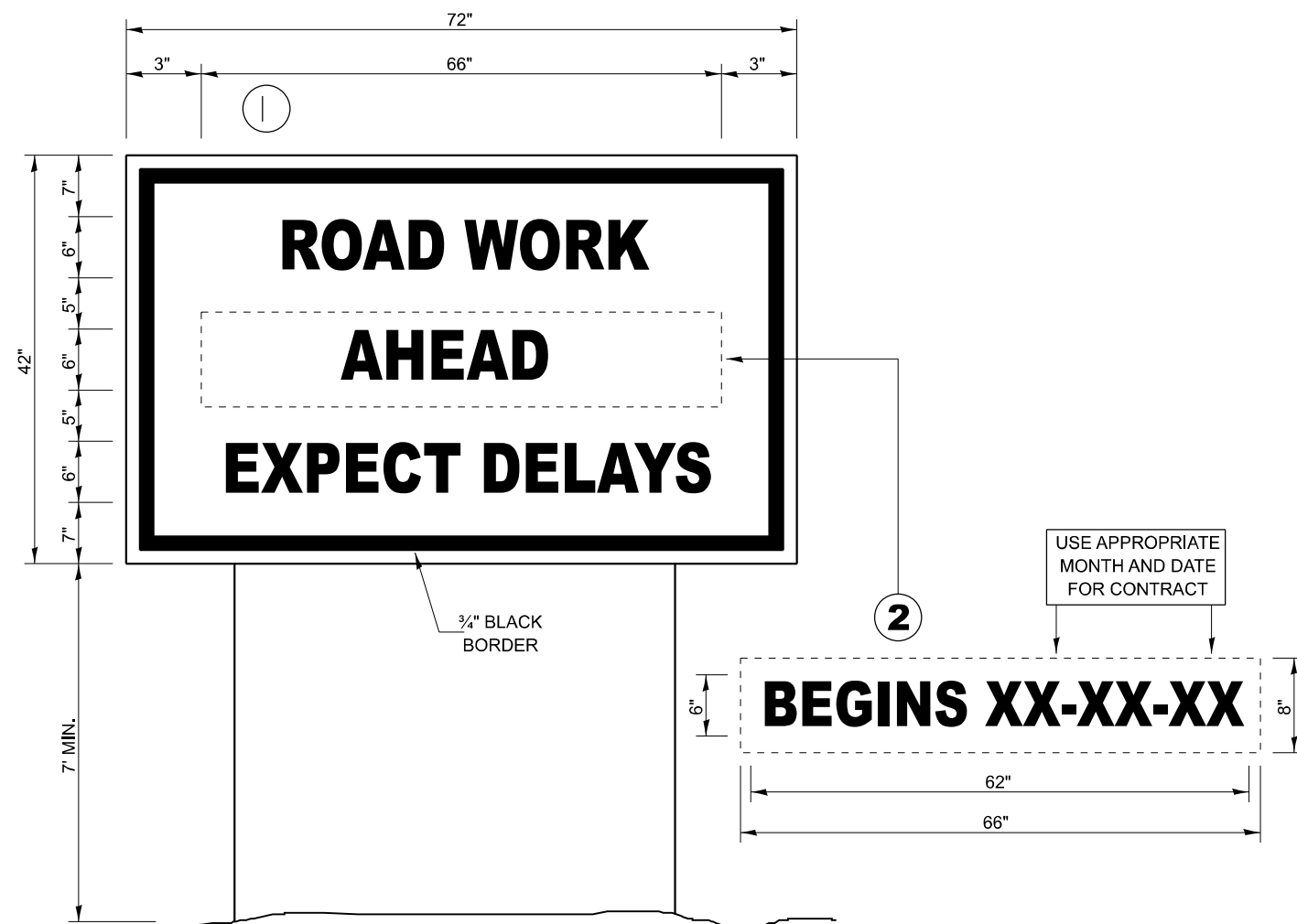

## TEMPORARY INFORMATION SIGNING

## WINTER SHUT DOWN SIGNING

### NOTES:

- USE 6" D BLACK LETTERING ON FLOURESENT ORANGE BACKGROUND.
- ERECT SIGNS AT LOCATIONS IN ADVANCE OF THE "ROAD CONSTRUCTION AHEAD" SIGNS AS DIRECTED BY THE ENGINEER.
- ERECT SIGN ① WITH INSTALLED PANEL ② A MINIMUM OF ONE WEEK PRIOR TO THE START OF THE LANE CLOSURE.
- REMOVE PANEL ② ON THAT DATE.
- SEE SPECIAL PROVISION "TEMPORARY INFORMATION SIGNING" FOR ADDITIONAL INFORMATION.
- WILL BE PAID FOR PER SQ FT AS "TEMPORARY INFORMATION SIGNING". EACH SIGN = 21 SQ FT AND THE DATE PANEL ② WILL NOT BE MEASURED SEPARATELY FOR PAYMENT.

MODEL: \$MODELNAME\$  
FILE NAME: \$FILES\$

USER NAME = \$USERS\$	DESIGNED - RW	REVISED - ____
	DRAWN - RW	REVISED - ____
PLOT SCALE = \$\$SCALE\$	CHECKED - YP	REVISED - ____
PLOT DATE = \$DATE\$	DATE - 9/20/22023	REVISED - ____

STATE OF ILLINOIS  
DEPARTMENT OF TRANSPORTATION

TEMPORARY INFORMATION SIGNING

SCALE: \_\_\_\_ SHEET 1 OF 1 SHEETS STA. \_\_\_\_ TO STA. \_\_\_\_

F.A.S. RTE.	SECTION	COUNTY	TOTAL SHEETS	SHEET NO.
1522	(31X)PP-2	FORD	8	8
CONTRACT NO. 66N94				
ILLINOIS FED. AID PROJECT				