

ROUTE	SECTION	COUNTY	TOTAL SHEETS	SHEET NUMBER
VARIOUS	2005-044 I	WILL	12	1

FOR INDEX OF SHEETS SEE SHEET 2

STATE OF ILLINOIS  
DEPARTMENT OF TRANSPORTATION  
DIVISION OF HIGHWAYS  
DISTRICT ONE

D-91-279-05

**PROPOSED HIGHWAY PLANS**

VARIOUS ROUTES  
AT BASCULE BRIDGES OVER DES PLAINES RIVER  
SECTION 2005-044 I  
TIMBER SIDEWALK REPLACEMENT  
WILL COUNTY  
C-91-279-05

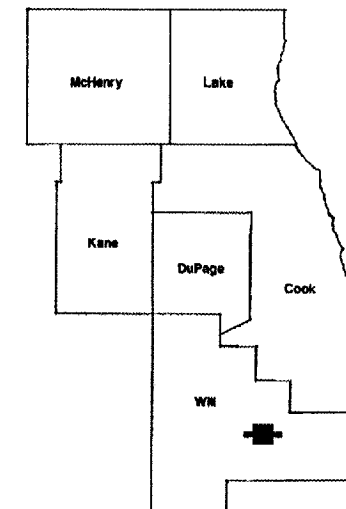

**IMPROVEMENTS  
ARE LOCATED IN  
THE CITY OF JOLIET**

**TRAFFIC DATA**

LOC 1- JACKSON ST (SN 099-0239)  
2004 ADT = 3,600 2 LANES TWO WAY  
POSTED SPEED LIMIT = 35 MPH

LOC 2- US 30 EB (SN 099-0166)  
2004 ADT = 9,800 4 LANES ONE WAY  
POSTED SPEED LIMIT = 35 MPH

LOC 3- US 30 WB (SN 099-0101)  
2003 ADT = 19,300 4 LANES ONE WAY  
POSTED SPEED LIMIT = 35 MPH

LOC. 1) SN 099-0239 JACKSON ST  
LOC. 2) SN 099-0166 US 30 EB (JEFFERSON ST)  
LOC. 3) SN 099-0101 US 30 WB (CASS ST)

LOCATION OF IMPROVEMENT INDICATED THUS:

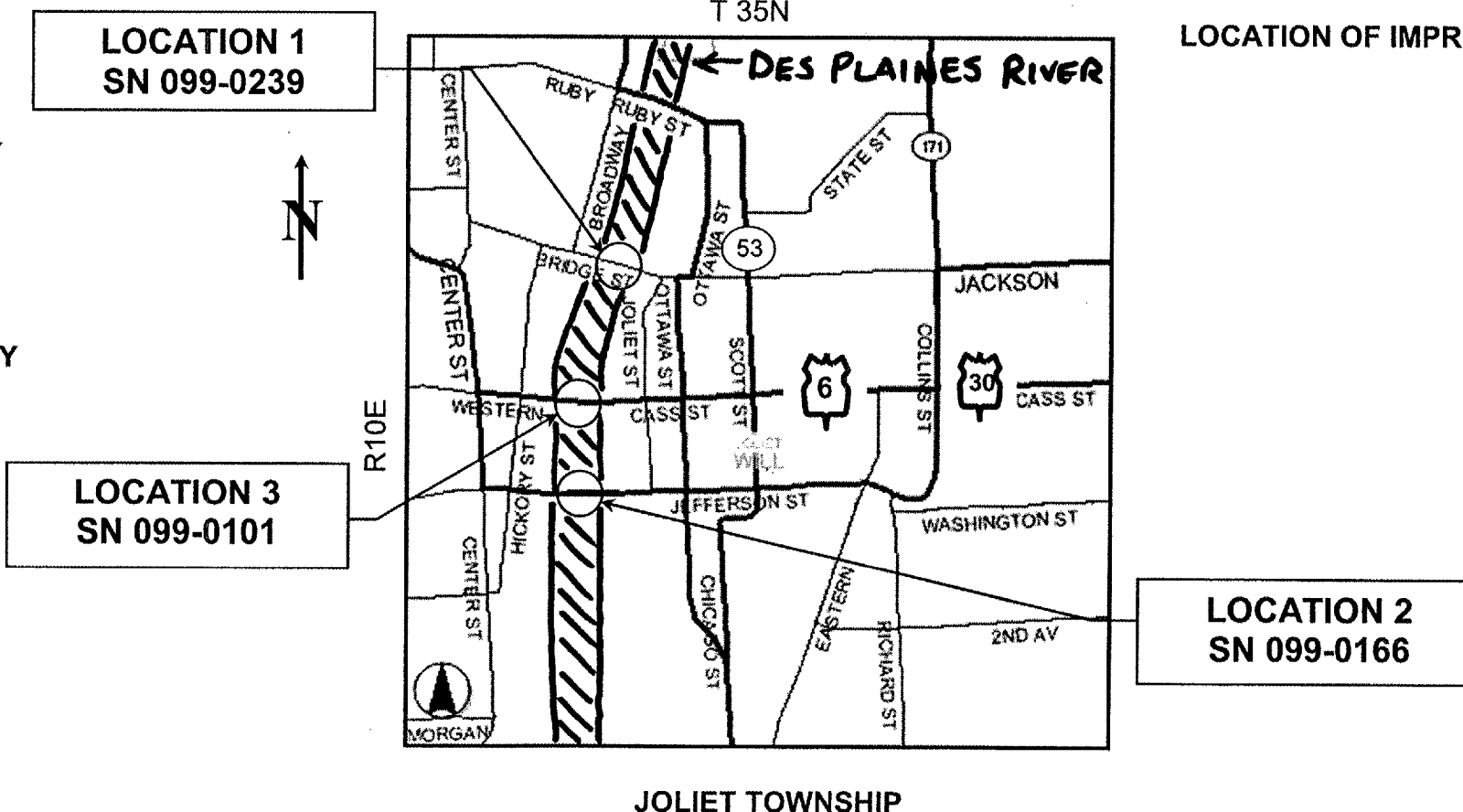

DISTRICT ONE DESIGN PLAN PREPARATION ENGINEER  
KEN ENG / R. BORO (847) 705-4178

STATE OF ILLINOIS  
DEPARTMENT OF TRANSPORTATION  
DIVISION OF HIGHWAYS  
SUBMITTED: Oct. 27 2005  
Diane M. O'Keefe / cd  
DEPUTY DIRECTOR OF HIGHWAY, REGION ENGINEER  
December 9, 2005  
Mikeltine / D  
ENGINEER OF DESIGN AND ENVIRONMENT  
December 9, 2005  
Eric Harm / D  
DEPUTY DIRECTOR, DIVISION OF HIGHWAYS

**PRINTED BY THE AUTHORITY  
OF THE STATE OF ILLINOIS**

J.U.L.I.E.: JOINT UTILITY LOCATION  
INFORMATION FOR EXCAVATION  
(800) 892-0123