

F.A.I. RTE.	SECTION	COUNTY	TOTAL SHEETS	SHEET NO.
80/94	*	COOK	231	27
STA.		TO STA.		
FED. ROAD DIST. NO. 1		ILLINOIS FED. AID PROJECT		
*(0203.1 & 0304) R-6		CONTRACT # 62105		

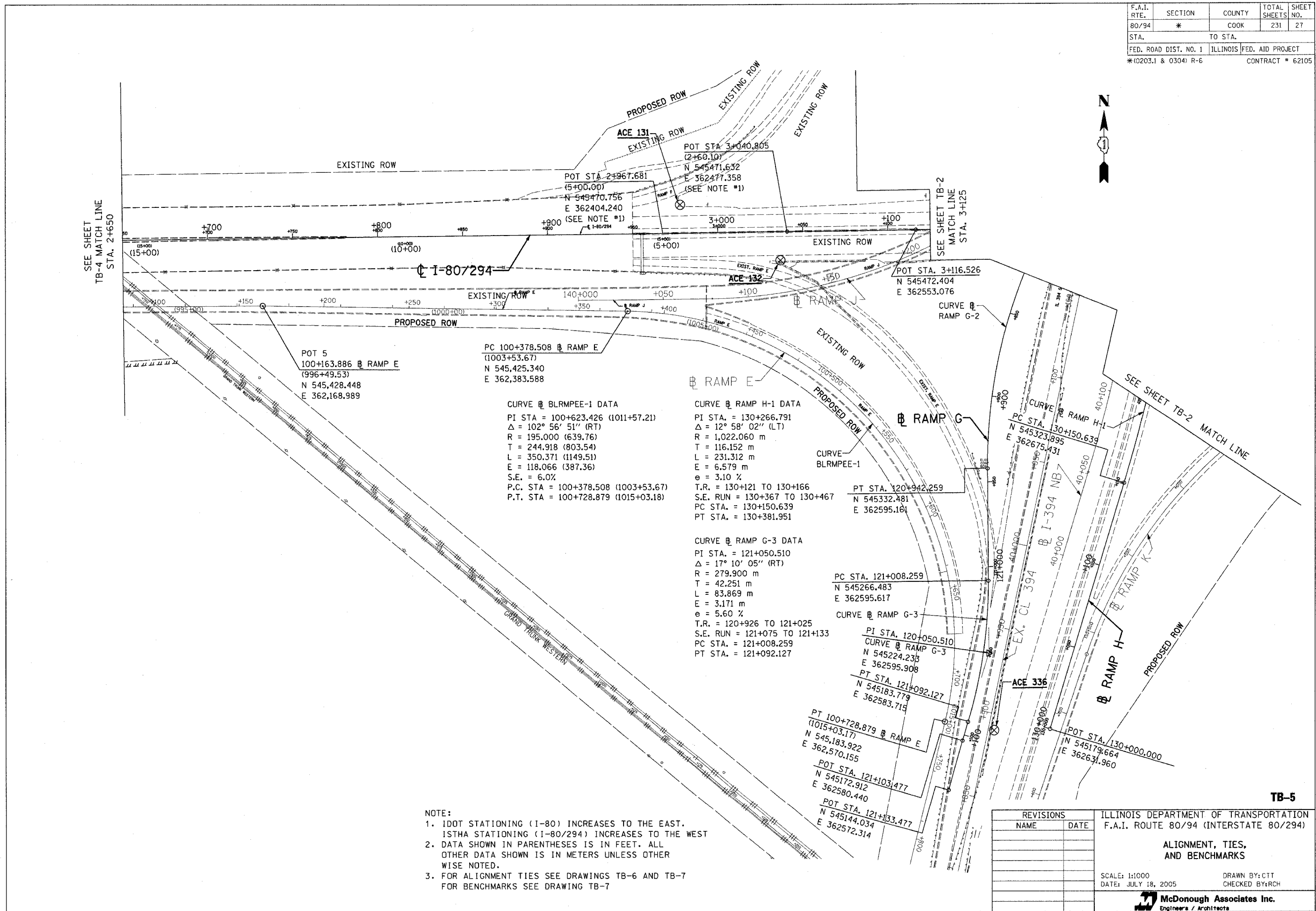

- NOTE:
- IDOT STATIONING (I-80) INCREASES TO THE EAST. ISTHA STATIONING (I-80/294) INCREASES TO THE WEST
 - DATA SHOWN IN PARENTHESES IS IN FEET. ALL OTHER DATA SHOWN IS IN METERS UNLESS OTHERWISE NOTED.
 - FOR ALIGNMENT TIES SEE DRAWINGS TB-6 AND TB-7 FOR BENCHMARKS SEE DRAWING TB-7

REVISIONS		ILLINOIS DEPARTMENT OF TRANSPORTATION F.A.I. ROUTE 80/94 (INTERSTATE 80/294)
NAME	DATE	
		ALIGNMENT, TIES, AND BENCHMARKS
		SCALE: 1:1000
		DATE: JULY 18, 2005
		DRAWN BY: CTT
		CHECKED BY: RCH
		McDonough Associates Inc. Engineers / Architects

TB-5