

|                       |         |                           |              |           |
|-----------------------|---------|---------------------------|--------------|-----------|
| F.A.I. RTE.           | SECTION | COUNTY                    | TOTAL SHEETS | SHEET NO. |
| 80/94                 | *       | COOK                      | 231          | 125       |
| STA. 3+825.00         |         | TO STA. 4+150.00          |              |           |
| FED. ROAD DIST. NO. 1 |         | ILLINOIS FED. AID PROJECT |              |           |
| *(0203.1 & 0304) R-6  |         | CONTRACT # 62105          |              |           |

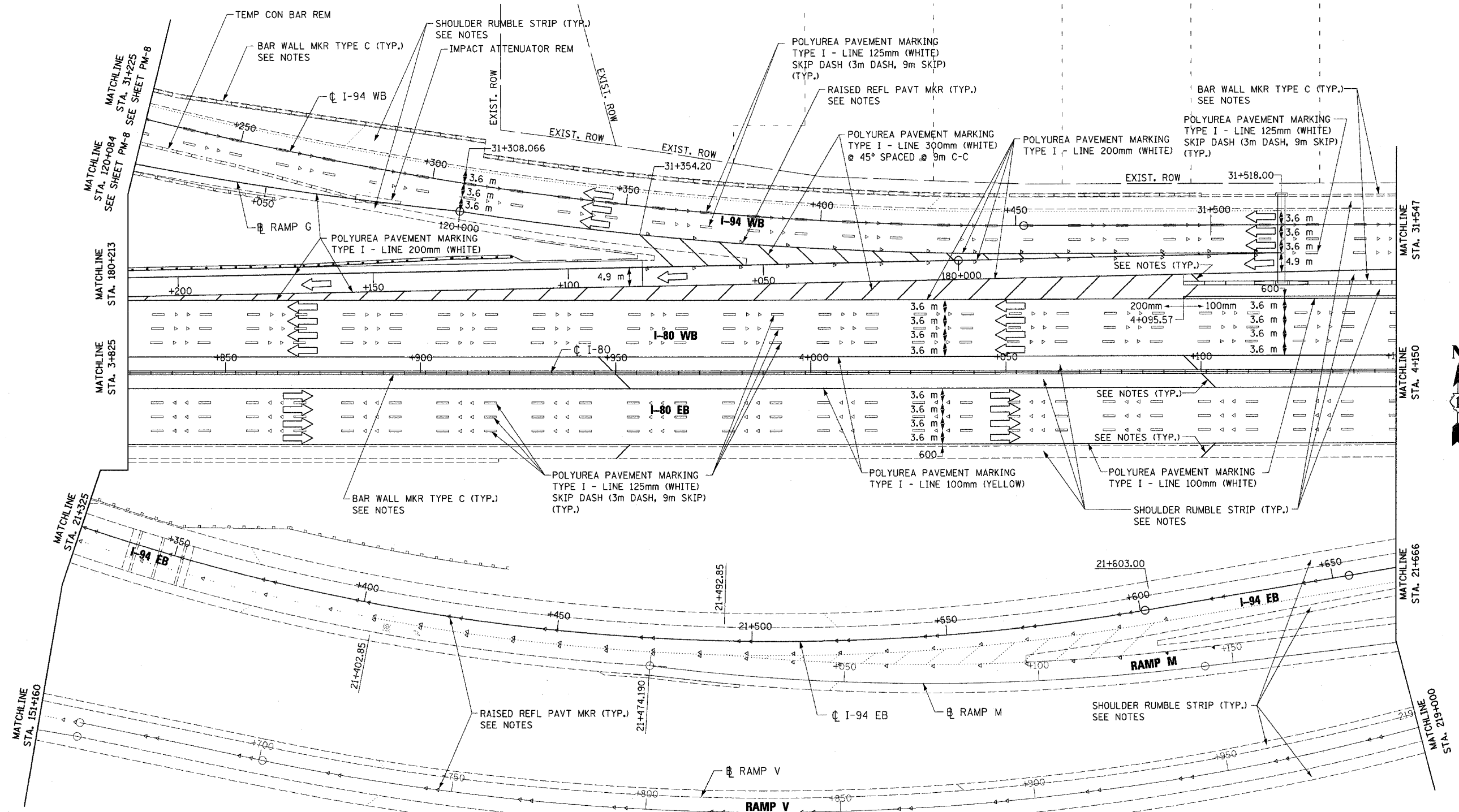

- NOTES:
- FOR SHOULDER DIAGONAL PLACEMENT, SPACING AND COLOR, SEE DETAIL TC-12. MATERIAL SHALL BE POLYUREA PAVEMENT MARKING TYPE I - LINE 300MM
  - FOR RAISED REFLECTIVE PAVEMENT MARKERS PLACEMENT, SPACING AND COLOR, SEE STANDARD TC-12.
  - FOR BARRIER WALL MARKERS, TYPE C PLACEMENT, SPACING AND COLOR, SEE STANDARD 635001 AND 635006.
  - FOR SHOULDER RUMBLE STRIP PLACEMENT AND SPACING, SEE STANDARD 642001.
  - FOR PAVEMENT MARKINGS AND SHOULDER RUMBLE STRIPS TO BE PLACED ON 4.2m PAVEMENT SEE "DETAILS FOR PLACEMENT OF PAVEMENT MARKING AND SHOULDER RUMBLE STRIPS ON 4.2m PAVEMENT" SHEET MD-10.

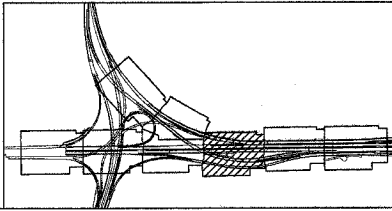

| REVISIONS |      |
|-----------|------|
| NAME      | DATE |
|           |      |
|           |      |
|           |      |

ILLINOIS DEPARTMENT OF TRANSPORTATION  
 F.A.I. ROUTE 80/94 (INTERSTATE 80/294)

**FINAL PAVEMENT MARKINGS**

DATE: JULY 18, 2005

DRAWN BY: CTT  
 CHECKED BY: RCH

**McDonough Associates Inc.**  
 Engineers / Architects

PM-4