

ALL DIMENSIONS IN METERS EXCEPT PAV
ITEMS AND UNLESS NOTED OTHERWISE.

F.A.I. RTE.	SECTION	COUNTY	TOTAL SHEETS	SHEET NO.
80/94	*	COOK	231	155F
STA.	TO STA.			
FED. ROAD DIST. NO. 1	ILLINOIS	FED. AID PROJECT		
* (0203.1 & 0304) R-6			CONTRACT #62105	

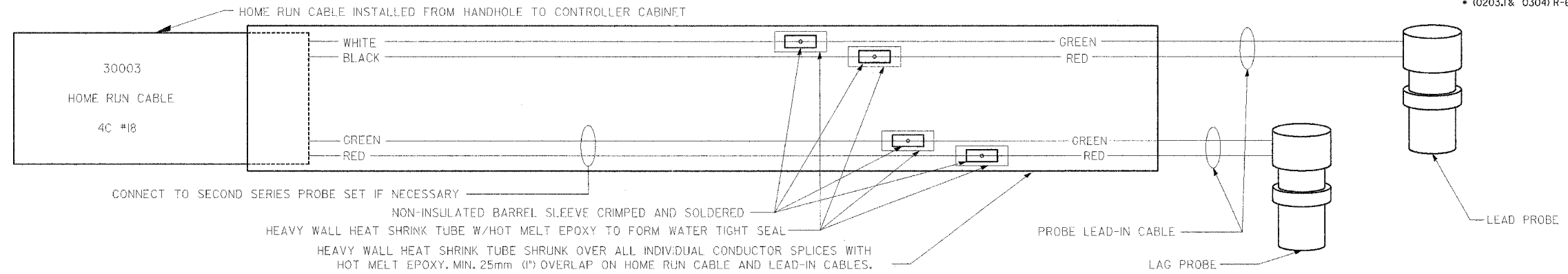

TYPICAL SINGLE MAGNETO-INDUCTIVE VEHICLE SENSOR SERIES SPLICING DETAIL

NOTES:

- PROBE SHALL BE POSITIONED IN THE CENTER OF EACH LANE. EXACT POSITIONING AND CONFIGURATION TO BE DETERMINED BY MANUFACTURER'S FIELD REPRESENTATIVE.
- SUFFICIENT NUMBER OF CARRIERS TO BE INSTALLED TO COVER THE DISTANCE FROM THE HANDHOLE TO THE FARTHEST PROBE. FIRST CARRIER INSERTED SHALL BE END CAP CARRIER.
- ANY DEVIATION IN CONDUIT ALIGNMENT SHALL BE LESS THAN 20mm PER METER.
- CONDUIT END CAP TO BE PRESS FITTED (NO ADHESIVE), 5mm (3/16\"), DRAINAGE HOLE TO BE DRILLED IN END CAP. HOLE TO BE POSITIONED AT BOTTOM.
- CONDUIT TO EXTEND APPROXIMATELY 75mm (3\") INTO HANDHOLE.
- LEAD PROBES SHALL USE ODD CHANNELS AND HAVE B/W WIRES; LAG PROBES SHALL USE EVEN CHANNELS AND HAVE R/G WIRES. CHANNELS SHALL BE USED IN INCREASING ORDER BEGINNING WITH LANE 1 OF NEAR LANES AND ENDING WITH OUTER-MOST LANE OF FAR LANES.

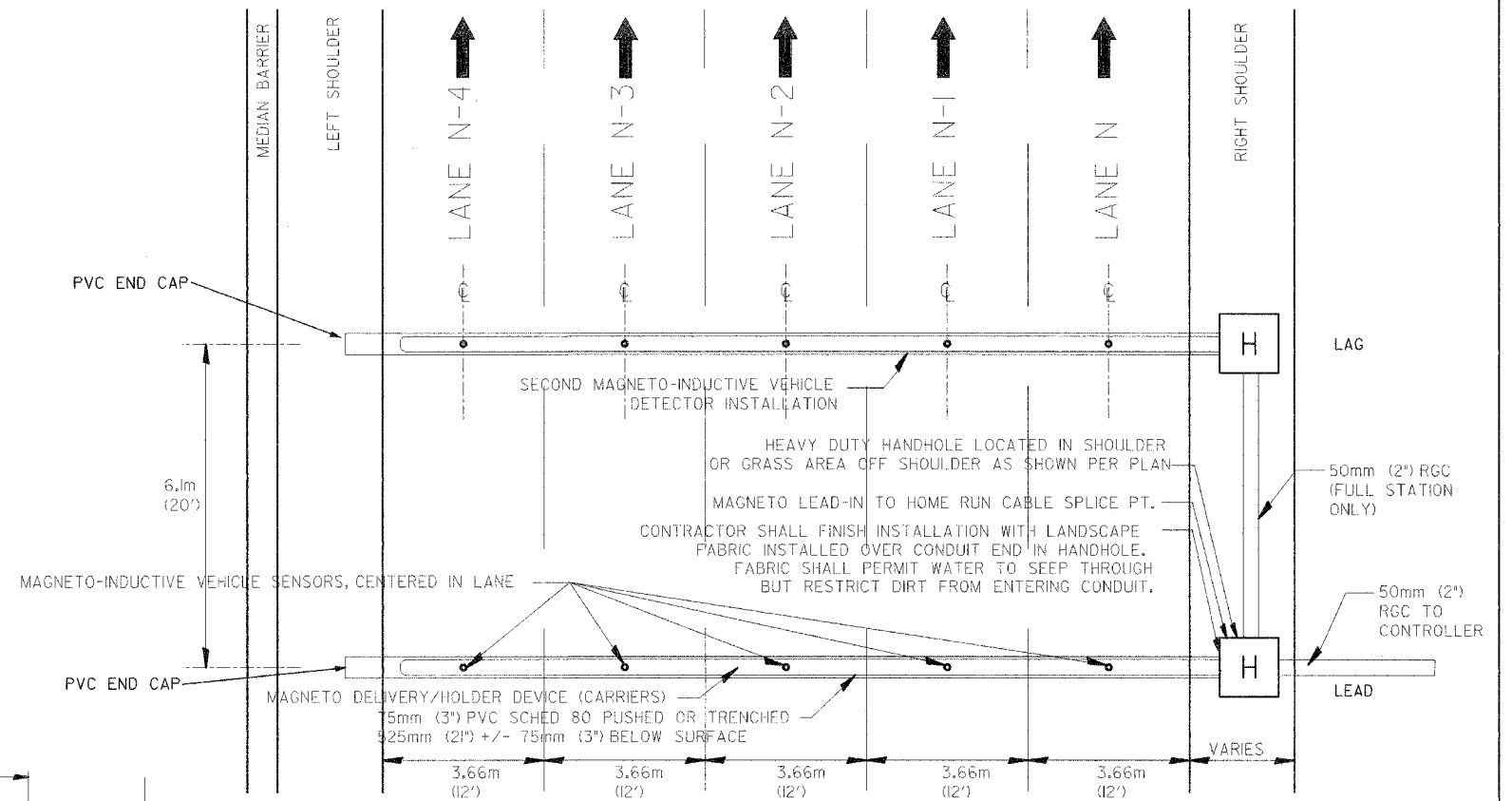

KINGERY-BORMAN TYPICAL MULTILANE LANE CROSS SECTION WITH NON-INVASIVE MAGNETO-INDUCTIVE VEHICLE SENSORS FULL STATION

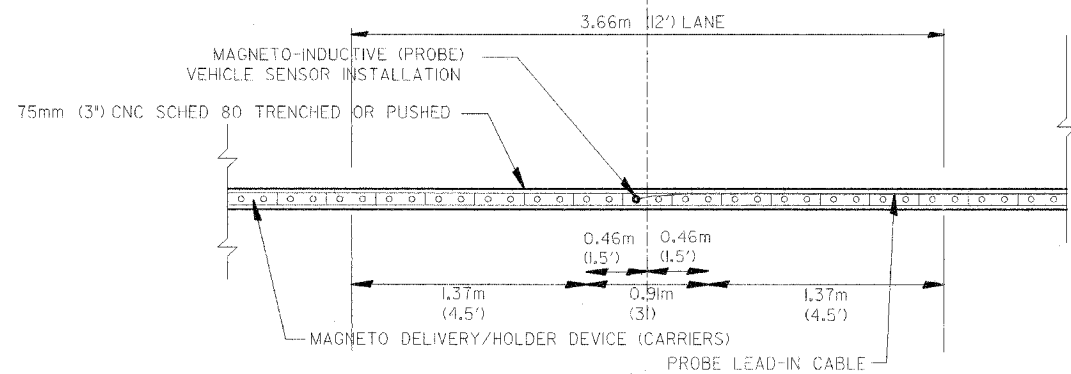

KINGERY-BORMAN TYPICAL MAINLINE/MULTILANE EXIT/MULTILANE ENTR. 3.66m (12') WITH SINGLE MAGNETO-INDUCTIVE VEHICLE SENSOR (PROBE) INSTALLATION PER LANE

FROM ELECTRICAL CONTRACT 62664 - FOR INFORMATION ONLY



REVISIONS	
NAME	DATE

MD22-10 (CONTRACT 62664)
ILLINOIS DEPARTMENT OF TRANSPORTATION
F.A.I. ROUTE 80/94 (INTERSTATE 80/294)
KINGERY-BORMAN EXPRESSWAY
TYPICAL SINGLE MAGNETO-INDUCTIVE VEHICLE SENSOR (FULL INSTALLATION/SPEED TRAP)
SCALE N.T.S. DRAWN BY JRH/MAP
DATE 08-22-05 CHECKED BY DEM/CMW