

F.A.I. RTE.	SECTION	COUNTY	TOTAL SHEETS	SHEET NO.
80/94		COOK	631	365
STA.	TO STA.			
FED. ROAD DIST. NO.	ILLINOIS	FED. AID PROJECT		
• (2425 & 2626) R-2		CONTRACT NO. 62111		

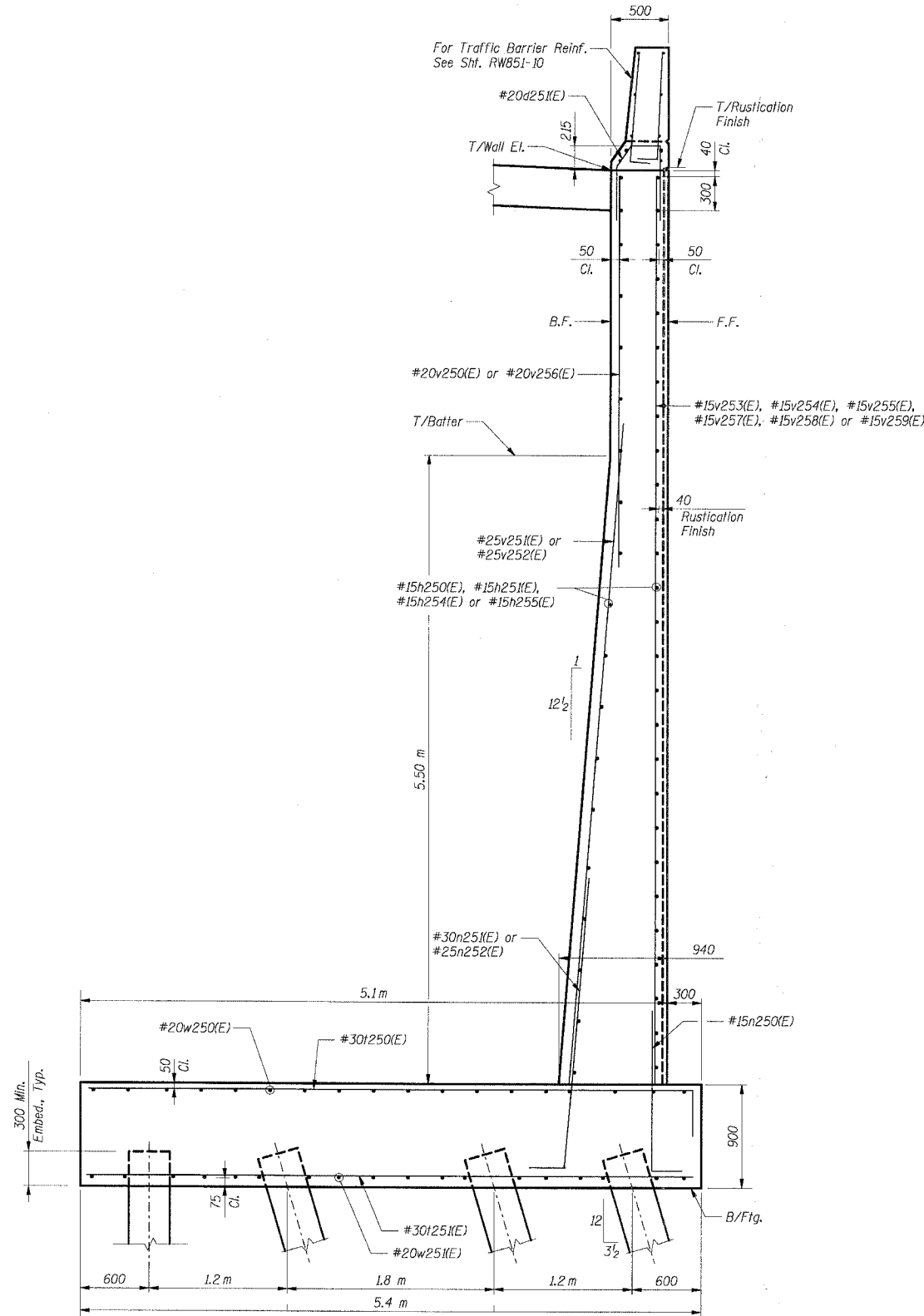

Bar	A	B
n252(E)	400	890
n250(E)	260	1.47 m
n253(E)	400	2.15 m
n254(E)	400	1.52 m
n255(E)	320	1.52 m
l250(E)	500	5.30 m
l252(E)	400	4.10 m

Bar	A	B	C
n25(E)	500	2.15 m	170
n252(E)	400	2.15 m	170

Bar Cutting Diagram

Bar	N Bars	A	B	C	D	E
v260(E)	13	6.75 m	5.88 m	870	3.48 m	3.27 m
v261(E)	12	8.8 m	5.88 m	2,92 m	4.4 m	4.4 m
v263(E)	8	3.65 m	2.78 m	870	1.9 m	1.75 m
n257(E)	17	11.94 m	11.25 m	690	690	11.25 m

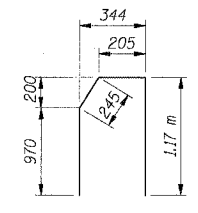
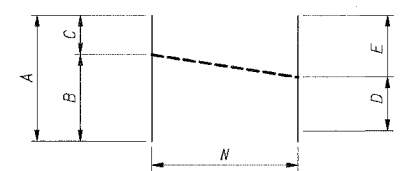

Bars #25(E)

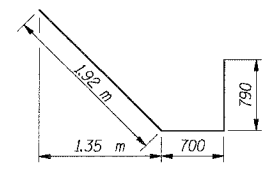

Bar #254(E)

- Notes:
- All dimensions are in millimeters (mm) except as noted.
 - Reinforcement bars designated (E) shall be epoxy coated.
 - All edges shall have a 20 mm chamfer unless noted otherwise.
 - E.F. indicates each face.
B.F. indicates back face.
F.F. indicates front face.
 - For Traffic Barrier details see Sht. RW851-10.
 - For Rustication Finish & joint details see Sht. RW851-12.
 - For Concrete Pile details see Sht. RW851-13.
 - For location of bars and quantity see Footing Plans & Wall Elevations.

SECTION A-A

I:\DOCUMENTS\PROJECTS\STRUCTURE\DRAWINGS\851\02A.DWG
 7-2-2005, 08:25:13
 1, 2, 3, 4, 5, 6, 7, 8, 9, 10, 11, 12, 13, 14, 15, 16, 17, 18, 19, 20, 21, 22, 23, 24, 25, 26, 27, 28, 29, 30, 31, 32, 33, 34, 35, 36, 37, 38, 39, 40, 41, 42, 43, 44, 45, 46, 47, 48, 49, 50, 51, 52, 53, 54, 55, 56, 57, 58, 59, 60, 61, 62, 63
 BA, ZERKJ

Shah Engineering, Inc.
 ONE TIM PLAZA SUITE 300
 CHICAGO, IL 60611
 TEL: 312-678-9000
 Consulting Engineers

SHT. RW851-7 OF 14	
REVISIONS	
NAME	DATE

ILLINOIS DEPARTMENT OF TRANSPORTATION
 F.A.I. ROUTE 80/94 (KINGERY EXPRESSWAY)
 EB & WB INSIDE LANES (MAINLINE) CONSTRUCTION
 RETAINING WALL - STRUCTURE NO. 016-W851
 SECTION (2425 & 2626) R-2
 COOK COUNTY

WALL SECTIONS & DETAILS I

DATE: 7/18/2005
 DRAWN BY: CHECKED BY: MJK
TENG
 TENG & ASSOCIATES, INC.
 ENGINEERS/ARCHITECTS/PLANNERS
 CHICAGO, ILLINOIS