

F.A.I. RTE.	SECTION	COUNTY	TOTAL SHEETS	SHEET NO.
80/94		COOK	631	460
STA.	TO STA.			
FED. ROAD DIST. NO.	ILLINOIS	FED. AID PROJECT		
		• (2425 & 2626) R-2		
			CONTRACT NO. 62111	

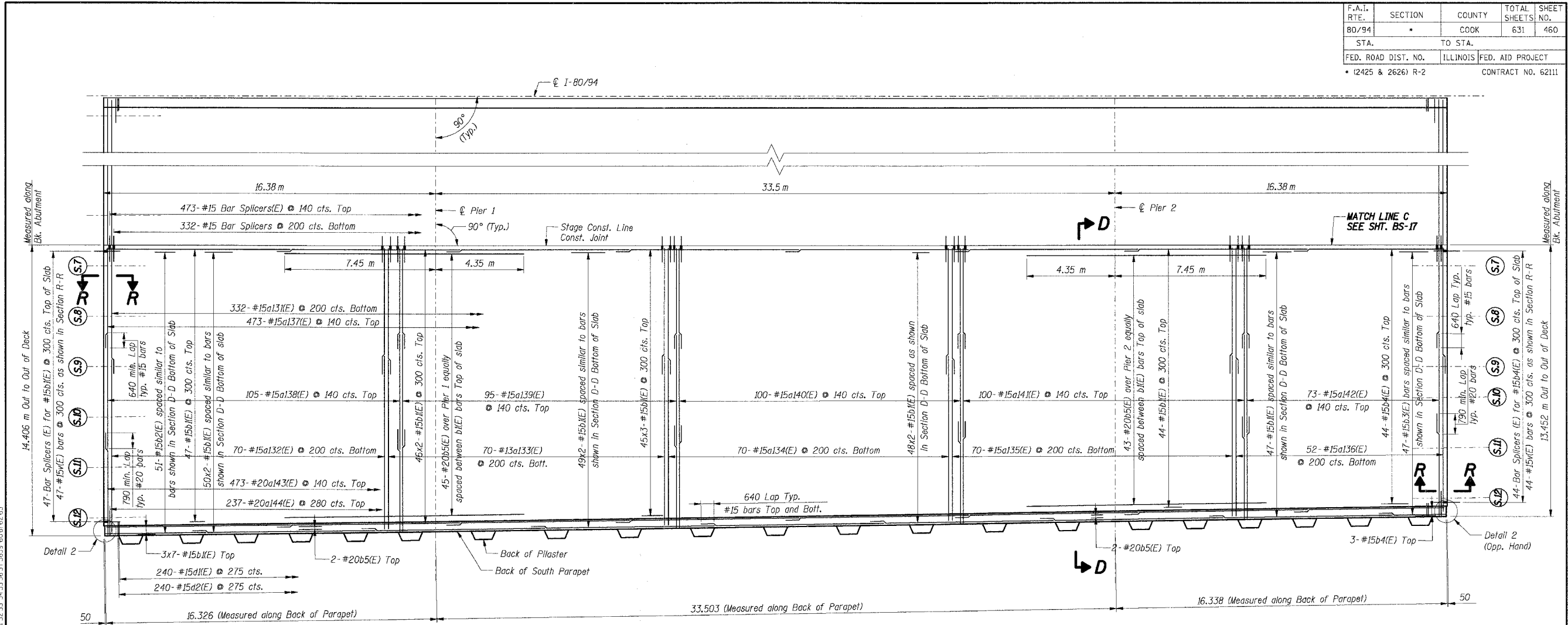

BA/ZEK1  
 50515253 545556575859 60616263  
 S:\9902A.DGN, S:\9902A.DGN, S:\9902A.DGN, S:\9902A.DGN, S:\9902A.DGN, S:\9902A.DGN, S:\9902A.DGN, S:\9902A.DGN, S:\9902A.DGN, S:\9902A.DGN  
 7-2-2005, 08:26:37  
 2-3-2005 18:59:10 12 13 14 15 16 17 18 19 20 21 22 23 24 25 26 27 28 29 30 31 32 33 34 35 36 37 38 39 40 41 42 43 44 45 46 47 48 49 50 51 52 53 54 55 56 57 58 59 60 61 62 63

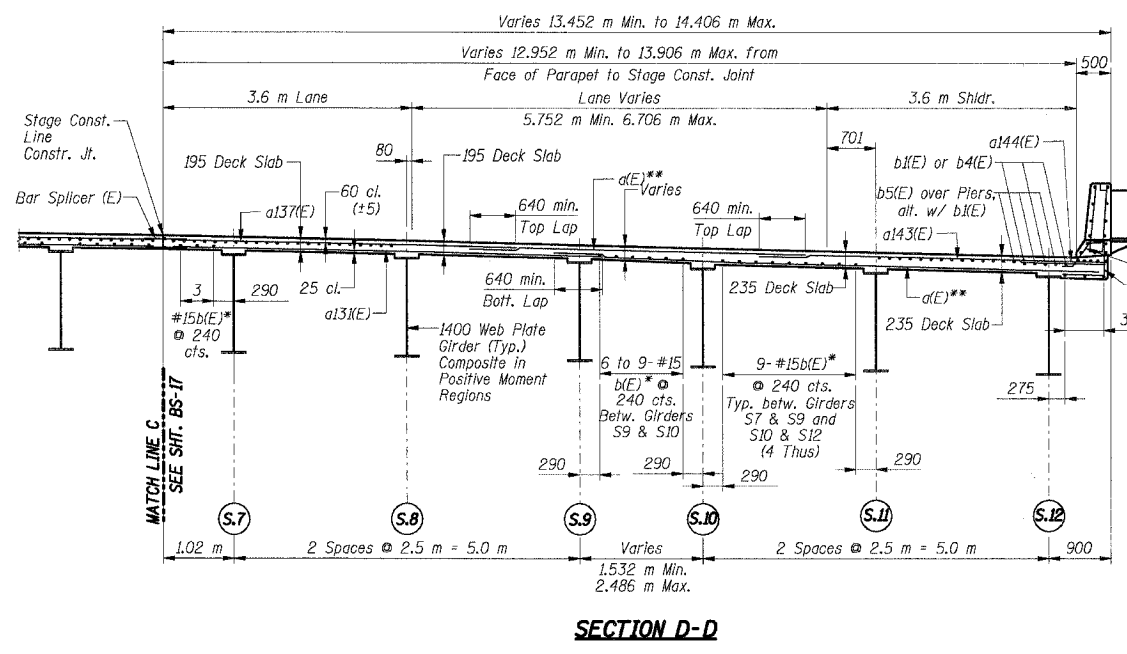

PLAN-IV

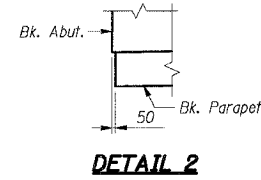

DETAIL 2

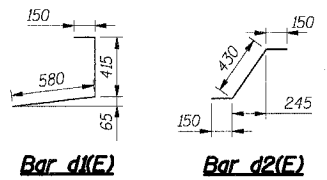

Bar d1(E)

Bar d2(E)

- Notes:**
- All dimensions are in millimeters (mm) except as noted.
  - Reinforcement bars designated (E) shall be epoxy coated.
  - Bars indicated thus 74x10-#15 etc. indicates 74 lines of bars with 10 lengths per line.
  - For Parapet Elevation, see Sht. BS-25.
  - For Reinforcement Bar List & Bill of Material, see Sht. BS-23.
  - Work this Sheet with Shts. BS-17, BS-20, BS-22, BS-23 & BS-25.
  - I.F. Denotes Inside Face.
  - O.F. Denotes Outside Face.
  - All edges shall have a 20 mm chamfer unless noted otherwise.
  - For Section R-R, see Sht. BS-21.

\*b1(E), b2(E) or b3(E) bars.  
See Plan for location of bars.

\*\*a132(E), a133(E), a134(E), a135(E) a136(E), a138(E), a139(E), a140(E), a141(E) or a142(E) bars.  
See Plan for location of bars.

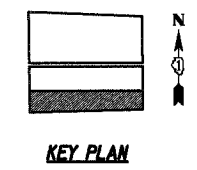

KEY PLAN

SHT. BS-18 OF 60

REVISIONS	
NAME	DATE

ILLINOIS DEPARTMENT OF TRANSPORTATION  
 F.A.I. ROUTE 80/94 (KINGERY EXPRESSWAY)  
 EB & WB INSIDE LANES (MAINLINE) CONSTRUCTION  
 1-80/94 OVER BURNHAM AVENUE  
 STRUCTURE NO. 016-2791 STA. 6+772.591  
 SECTION 1977-121-R  
 COOK COUNTY

**DECK PLAN  
 DECK CROSS SECTION - IV**

DATE: 7/18/2005

DRAWN BY: LAR  
 CHECKED BY: MAJ

**TENG**  
 TENG & ASSOCIATES, INC.  
 ENGINEERS/ARCHITECTS/PLANNERS  
 CHICAGO, ILLINOIS