





F.A.P. RTE.	SECTION	COUNTY	TOTAL SHEETS	SHEET NO.
599	*	ROCK ISLAND	90	23
STA.		TO STA.		
FED. ROAD DIST. NO.		ILLINOIS FED. AID PROJECT		

STAGING SHEETS

-  = WORK ZONE
-  = TRAFFIC SIGNAL
-  = INDUCTION LOOP DETECTOR
-  = IMPACT ATTENUATORS, TEMPORARY (NON-REDIRECTIVE), TEST LEVEL 3

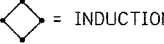
EXIST. CURVE 220
 P.I. STA. = 1080+91.84
 $\Delta = 16^\circ 22' 06''$ (LT)
 $D = 1^\circ 00' 04''$
 $R = 5,723.53'$
 $T = 823.15'$
 $L = 1,635.10'$
 $E = 58.89'$
 $\theta = \dots$
 $T.R. = \dots$
 $S.F. RUN = \dots$
 $P.C. STA. = 1072+68.69$
 $P.T. STA. = 1089+03.78$

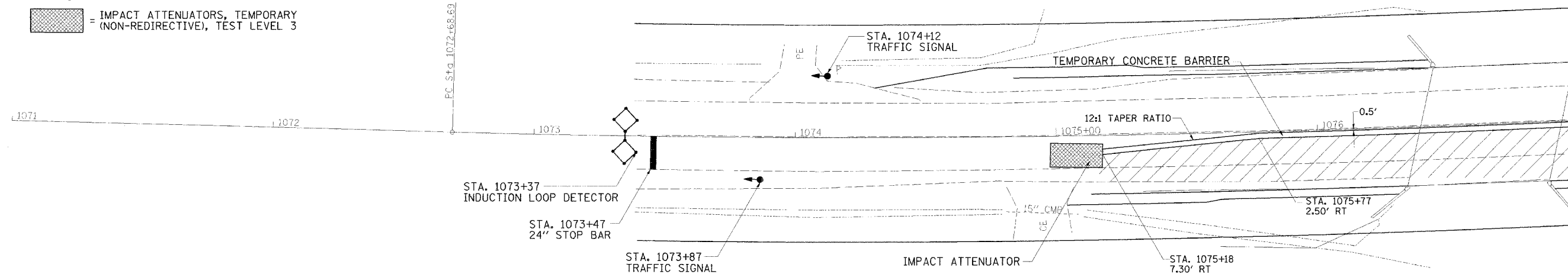

NOTE:



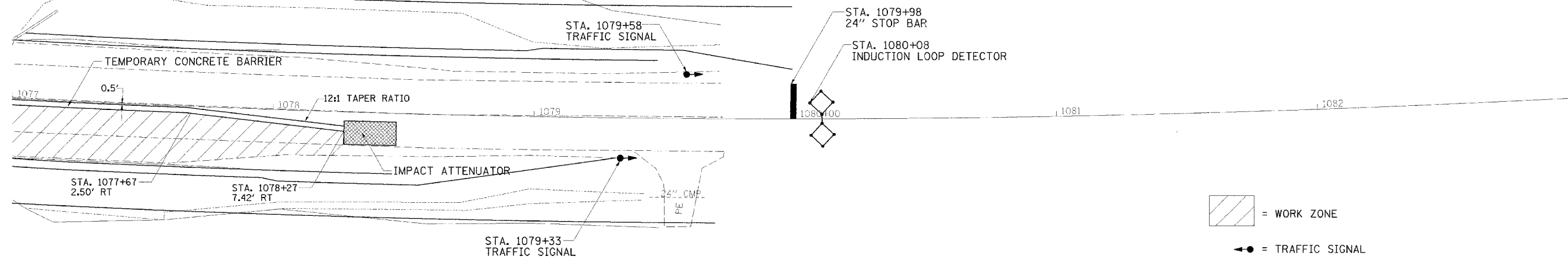

THIS TRAFFIC CONTROL AND PROTECTION SHALL BE SET UP AND PAID FOR ACCORDING TO STANDARD 701321

EXIST. CURVE 220
 P.I. STA. = 1080+91.84
 $\Delta = 16^\circ 22' 06''$ (LT)
 $D = 1^\circ 00' 04''$
 $R = 5,723.53'$
 $T = 823.15'$
 $L = 1,635.10'$
 $E = 58.89'$
 $\theta = \dots$
 $T.R. = \dots$
 $S.F. RUN = \dots$
 $P.C. STA. = 1072+68.69$
 $P.T. STA. = 1089+03.78$

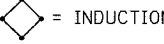

NOTE:

THIS TRAFFIC CONTROL AND PROTECTION SHALL BE SET UP AND PAID FOR ACCORDING TO STANDARD 701321

-  = WORK ZONE
-  = TRAFFIC SIGNAL
-  = INDUCTION LOOP DETECTOR
-  = IMPACT ATTENUATORS, TEMPORARY (NON-REDIRECTIVE), TEST LEVEL 3

PLOT DATE = 6/3/2003
 PLOT SCALE = 1/8\"/>