

F.A.I. RTE.	SECTION	COUNTY	TOTAL SHEETS	SHEET NO.
I-80	06-4RA-M	BUREAU	14	1

STATE OF ILLINOIS
DEPARTMENT OF TRANSPORTATION
DIVISION OF HIGHWAYS

**PROPOSED
HIGHWAY PLANS**

F.A.I. 80 (I-80)
SECTION 06-4RA-M (PAVEMENT)

BUREAU COUNTY
C 92-024-06

INDEX OF SHEETS

- 1 COVER SHEET & INDEX OF SHEETS AND STANDARDS
- 2 SUMMARY OF QUANTITIES
- 3 GENERAL NOTES
- 4 SCHEDULE OF QUANTITIES
- 5 CLASS B PATCHING SCHEDULE
- 6-8 EASTBOUND PLAN SHEETS
- 9-11 WESTBOUND PLAN SHEETS
- 12 INLETS, SPECIAL, NO. 7 DETAIL
- 13 TRAFFIC CONTROL FOR ROAD CLOSURE DETAIL
- 14 SUBGRADE REPLACEMENT (DIST STD 97.4)

STATE STANDARDS

- 000001-04 STANDARD SYMBOLS, ABBREVIATIONS, AND PATTERNS
- 001001 AREAS OF REINFORCEMENT BARS
- 001006 DECIMAL OF AN INCH AND OF A FOOT
- 420001-06 PAVEMENT JOINTS
- 420701-01 PAVEMENT FABRIC
- 442101-05 CLASS B PATCHES
- 701101-01 OFF-ROAD OPERATIONS, MULTILANE, 15' TO 24" FROM EDGE OF PAVEMENT
- 702001-05 TRAFFIC CONTROL DEVICES
- 780001-01 TYPICAL PAVEMENT MARKINGS

WYANET TOWNSHIP, SECTIONS 9, 10

J.U.L.I.E.
JOINT UTILITY LOCATION INFORMATION FOR EXCAVATION
1-800-892-0123

CONTRACT NO. 64B91

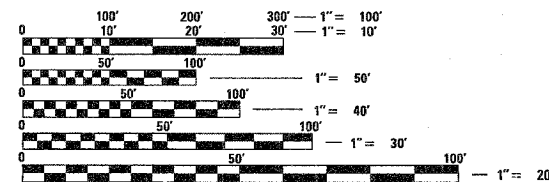
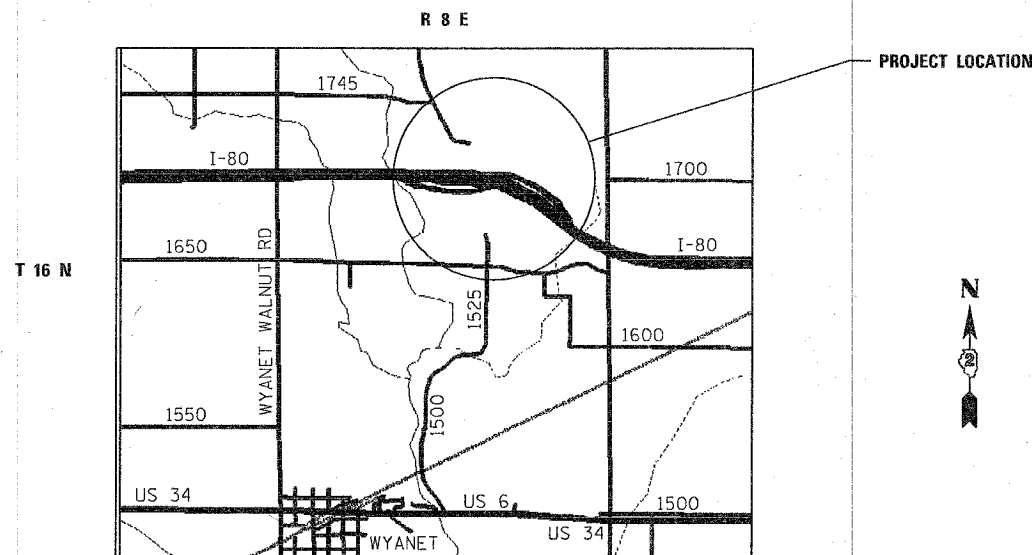

FULL SIZE PLANS HAVE BEEN PREPARED USING STANDARD ENGINEERING SCALES. REDUCED SIZED PLANS WILL NOT CONFORM TO STANDARD SCALES. IN MAKING MEASUREMENTS ON REDUCED PLANS, THE ABOVE SCALES MAY BE USED.

D-92-012-06



LOCATION OF SECTION INDICATED THUS: [Symbol]

STATE OF ILLINOIS
DEPARTMENT OF TRANSPORTATION
DIVISION OF HIGHWAYS

SUBMITTED October 26, 20 05
Gregory L. Mounts
DEPUTY DIRECTOR OF HIGHWAYS, REGION ENGINEER

December 9, 20 05
Mike Hine
ENGINEER OF DESIGN AND ENVIRONMENT

December 9, 20 05
Eric Harn
DEPUTY DIRECTOR OF HIGHWAYS, CHIEF ENGINEER

**PRINTED BY THE AUTHORITY
OF THE STATE OF ILLINOIS**