

F.A.P.	SECTION	COUNTY	TOTAL SHEETS	SHEET NO.
623	32-2 HBR	GRUNDY	171	92
Sta.	TO Sta.			
FED. ROAD DIST. NO.	ILLINOIS	FED. AID PROJECT		
CONTRACT NO. 66412				
SHEET W01 OF W02				

HIGHWAY CLASSIFICATION
Route: Seneca Road (FAP 0623)
Class: Minor Arterial
ADT: 1,960 (2000)
ADT: 3,610 (2024)
DHV: 361
ADTT: 310 (2000)
ADTT: 550 (2024)
Design Speed: 60 mph
Posted Speed 45 mph

Route: FAI 80
Design Speed: 70 mph
Posted Speed 65 mph
ADT: 23,700 (1999)
ADT: 42,600 (2024)
DHV: 4260
ADTT: 7,100 (1999)
Class: Interstate

DESIGN SPECIFICATIONS

2002 AASHTO Standard Specifications for Highway Bridges

SEISMIC DATA

S.P.C. = A
A = 0.04g
S = 1.0

DESIGN STRESSES

FIELD UNITS
f'c = 4,500 psi (MSE Panels)
f'c = 3,500 psi (Leveling Slab)
fy = 60,000 psi (Reinf.)

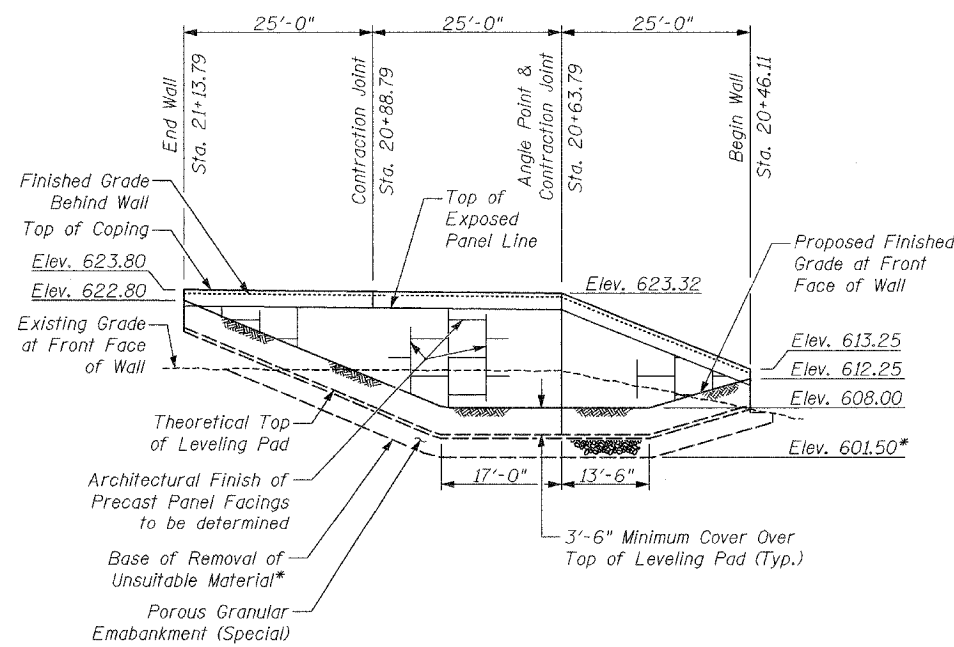
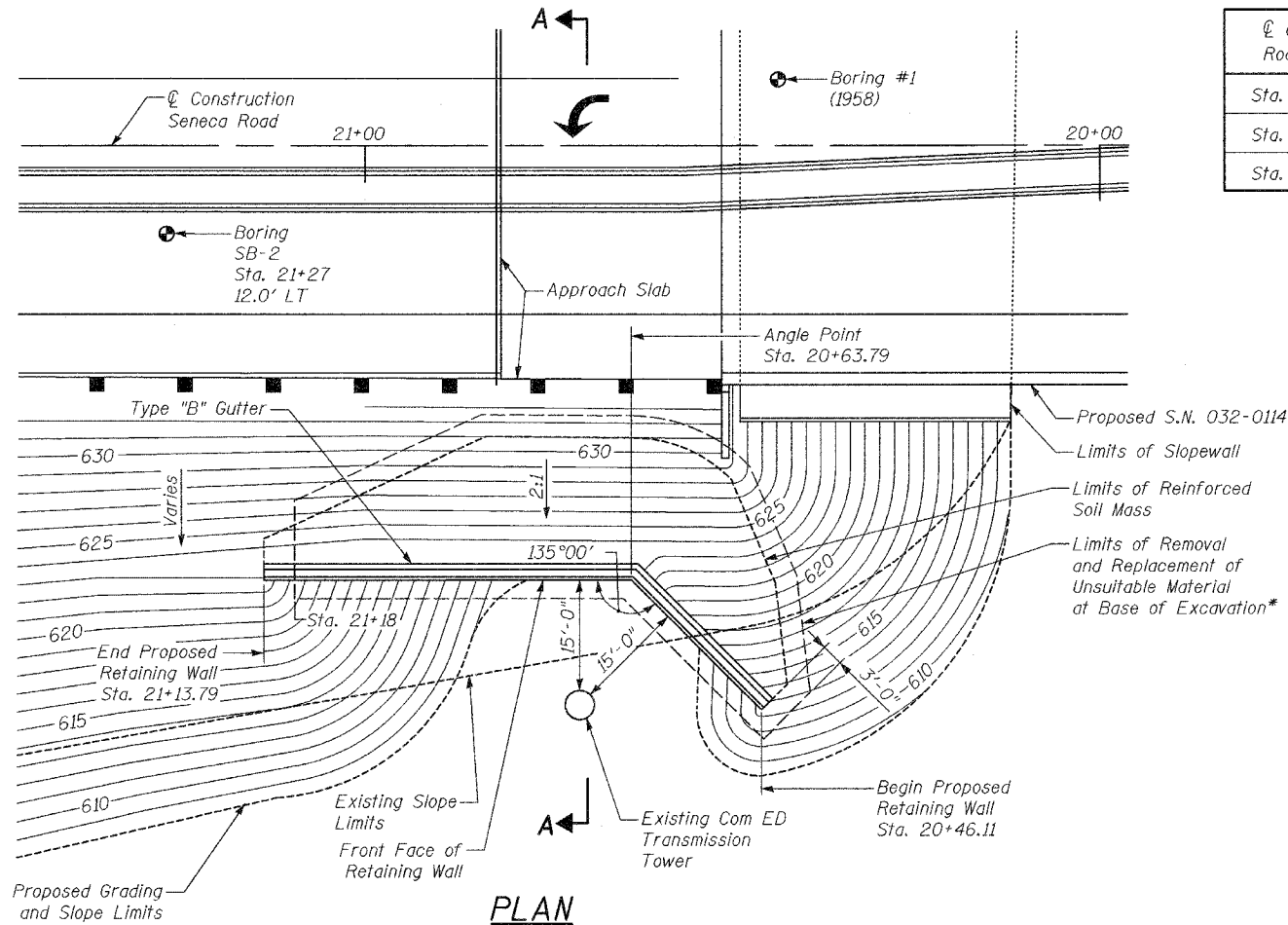
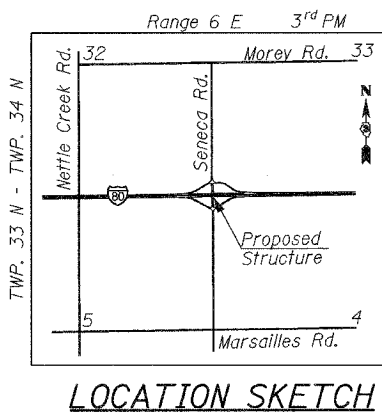
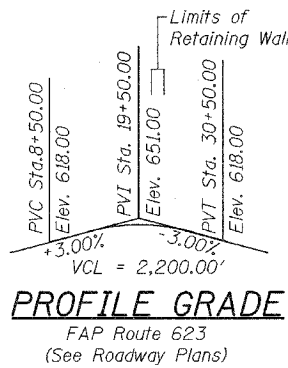
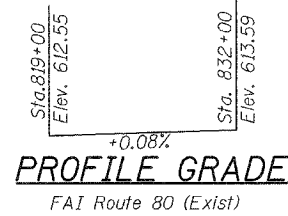

All longitudinal dimensions are along the front face of precast MSE wall panels

STATION / OFFSET TABLE

℄ of Seneca Road Station	Offset (Left) to Front Face of MSE Wall
Sta. 20+46.11	76.76'
Sta. 20+63.79	59.08'
Sta. 21+13.79	59.08'

GENERAL NOTES

See Special Provisions for Mechanically Stabilized Earth Retaining Wall design and construction requirements.

The Contractor shall coordinate the construction of the MSE Wall with the construction of the bridge (SN 032-0114) to allow for Structure Excavation for the MSE Wall without need for a temporary soil retention system.

Over-excavation will not be measured for payment, and shall be backfilled with the same material specified for roadway embankment or with granular material.

*The limits and quantities of removal and replacement shown are based on the boring data and may be modified by the District Geotechnical and Field Engineers for variable subsurface conditions encountered in the field.

TOTAL BILL OF MATERIAL

Item	Unit	Total
Structure Excavation	Cu. Yd.	590
Removal and Disposal of Unsuitable Material	Cu. Yd.	179
Porous Granular Embankment (Special)	Cu. Yd.	179
Mechanically Stabilized Earth Retaining Walls	Sq. Ft.	926
Type "B" Gutter	Foot	77

APPROVED
FOR STRUCTURAL ADEQUACY ONLY
Robert E. Adams
ENGINEER OF BRIDGES AND STRUCTURES



Notes:
See Sheet W02 of W02 for Section A-A.
See Sheet S19 for boring log of Boring SB-2.

Louis Berger & Associates, Inc.
1001 Elm Street, Suite 300
Manchester, NH 03101

REVISIONS	NAME	DATE

ILLINOIS DEPARTMENT OF TRANSPORTATION
M.S.E. RETAINING WALL
SENECA ROAD OVER F.A.I. 80
F.A.P. 623 SEC. 32-2 HBR GRUNDY CO.
STRUCTURE NO. 032-W001
STA 20+46.11 TO STA 21+13.79
GENERAL PLAN & ELEVATION

SCALE: NONE
DATE: DECEMBER, 2005
DRAWN BY: NJH
CHECKED BY: JLG