

F.A.I. RTE.	SECTION	COUNTY	TOTAL SHEETS	SHEET NO.
80	32-2HBR	GRUNDY	171	30
STA.		TO STA.		
FED. ROAD DIST. NO.	ILLINOIS	FED. AID PROJECT		
CONTRACT NO. 66412				

PROPOSED WESTBOUND ACCESS ROAD ALIGNMENT		
POINT DESCRIPTION	NORTHING	EASTING
P.O.T. STA. 50+00.00	1,716,119.9121	907,444.5742
P.I. CURVE WAC-1	1,716,124.0102	907,610.8695
P.C. WAC-1 STA. 50+74.15	1,716,121.7388	907,518.6989
P.T. WAC-1 STA. 52+17.69	1,716,031.8117	907,610.9162
P.I. CURVE WAC-2	1,715,669.6275	907,611.0995
P.C. WAC-2 STA. 54+55.08	1,715,794.4244	907,611.0363
P.T. WAC-2 STA. 56+79.89	1,715,610.9529	907,721.2429
P.I. CURVE WAC-3	1,715,576.8805	907,785.2033
P.C. WAC-3 STA. 56+79.89	1,715,610.9529	907,721.2429
P.T. WAC-3 STA. 58+21.50	1,715,579.3733	907,857.6301
P.O.T. STA. 59+51.06	1,715,583.8299	907,987.1158

PROPOSED WESTBOUND APPROACH ALIGNMENT		
POINT DESCRIPTION	NORTHING	EASTING
P.I. CURVE WAP-1	1,715,573.2719	907,880.0140
P.C. WAP-1 STA. 157+79.22	1,715,581.1934	907,815.4261
P.T. WAP-1 STA. 158+86.41	1,715,508.2125	907,881.2819
P.O.T. STA. 159+87.22	1,715,407.4289	907,883.2459

PROPOSED EASTBOUND ACCESS ROAD ALIGNMENT		
POINT DESCRIPTION	NORTHING	EASTING
P.O.T. STA. 10+00.00	1,714,483.9314	907,476.8716
P.I. CURVE EAC-1	1,715,238.0463	907,389.0343
P.C. EAC-1 STA. 17+64.90	1,715,208.3320	907,389.5135
P.R.C. EAC-1 STA. 18+20.09	1,715,255.6743	907,365.1045
P.I. CURVE EAC-2	1,715,271.8656	907,343.1194
P.R.C. EAC-2 STA. 18+20.09	1,715,255.6743	907,365.1045
P.T. EAC-2 STA. 18+70.78	1,715,299.1703	907,342.7281
P.O.T. STA. 19+69.56	1,715,397.9344	907,341.3130

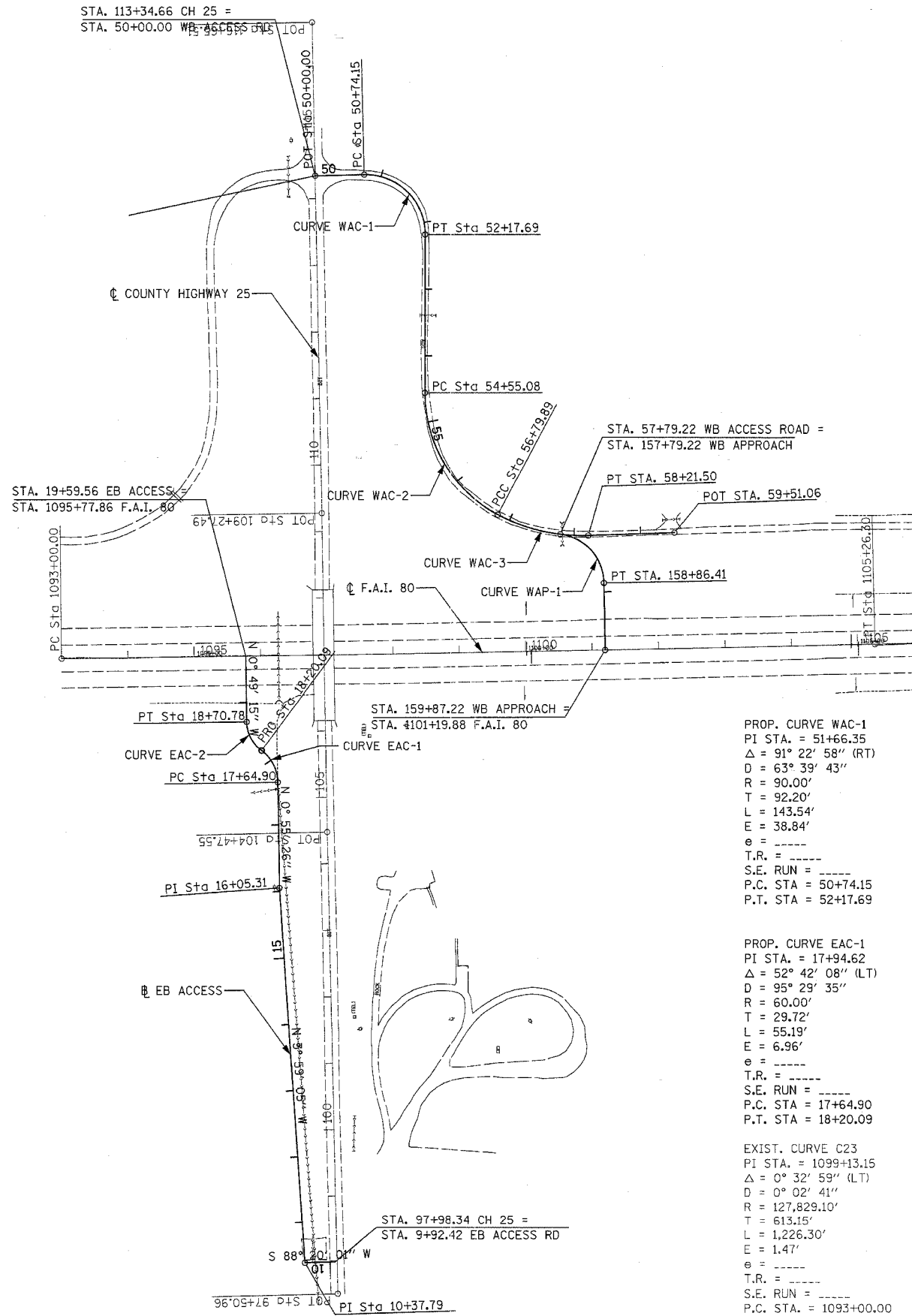

PROP. CURVE WAC-1 PI STA. = 51+66.35 $\Delta = 91^\circ 22' 58''$ (RT) $D = 63^\circ 39' 43''$ $R = 90.00'$ $T = 92.20'$ $L = 143.54'$ $E = 38.84'$ $e =$ $T.R. =$ $S.E. RUN =$ P.C. STA = 50+74.15 P.T. STA = 52+17.69	PROP. CURVE WAC-2 PI STA. = 55+79.88 $\Delta = 61^\circ 55' 35''$ (LT) $D = 27^\circ 32' 46''$ $R = 208.00'$ $T = 124.80'$ $L = 224.81'$ $E = 34.57'$ $e =$ $T.R. =$ $S.E. RUN =$ P.C. STA = 54+55.08 P.T. STA = 56+79.89	PROP. CURVE WAC-3 PI STA. = 57+52.36 $\Delta = 30^\circ 00' 57''$ (LT) $D = 21^\circ 11' 47''$ $R = 270.31'$ $T = 72.47'$ $L = 141.61'$ $E = 9.55'$ $e =$ $T.R. =$ $S.E. RUN =$ P.C. STA = 56+79.89 P.T. STA = 58+21.50	PROP. CURVE WAP-1 PI STA. = 158+44.29 $\Delta = 81^\circ 53' 29''$ (RT) $D = 76^\circ 23' 40''$ $R = 75.00'$ $T = 65.07'$ $L = 107.20'$ $E = 24.29'$ $e =$ $T.R. =$ $S.E. RUN =$ P.C. STA = 157+79.22 P.T. STA = 158+86.41
---	---	---	--

PROP. CURVE EAC-1 PI STA. = 17+94.62 $\Delta = 52^\circ 42' 08''$ (LT) $D = 95^\circ 29' 35''$ $R = 60.00'$ $T = 29.72'$ $L = 55.19'$ $E = 6.96'$ $e =$ $T.R. =$ $S.E. RUN =$ P.C. STA = 17+64.90 P.T. STA = 18+20.09	PROP. CURVE EAC-2 PI STA. = 18+47.40 $\Delta = 52^\circ 48' 18''$ (RT) $D = 104^\circ 10' 27''$ $R = 55.00'$ $T = 27.31'$ $L = 50.69'$ $E = 6.41'$ $e =$ $T.R. =$ $S.E. RUN =$ P.C. STA = 18+20.09 P.T. STA = 18+70.78
---	--

EXIST. CURVE C23 PI STA. = 1099+13.15 $\Delta = 0^\circ 32' 59''$ (LT) $D = 0^\circ 02' 41''$ $R = 127,829.10'$ $T = 613.15'$ $L = 1,226.30'$ $E = 1.47'$ $e =$ $T.R. =$ $S.E. RUN =$ P.C. STA. = 1093+00.00 P.T. STA. = 1105+26.30
---

REVISIONS	
NAME	DATE

ILLINOIS DEPARTMENT OF TRANSPORTATION  
**I-80 (F.A.I. 80) AT  
 SENECA ROAD (F.A.P. 623)  
 GRUNDY COUNTY**  
 ALIGNMENT, TIES, AND BENCHMARKS  
 SCALE: 1" = 100'  
 DATE 10/14/05  
 DRAWN BY NMR/BJG  
 CHECKED BY DJL/JPL