

FAP RTE	SECTION	COUNTY	TOTAL SHEETS	SHEET NO.
315	102X-BR-2	McLEAN	44	37
STA.		TO STA.		
FED. ROAD DIST. NO.		ILLINOIS FED. AID PROJECT		

NO. 119	McLEAN	153	66	SHEET NO. 8
				9 SHEETS

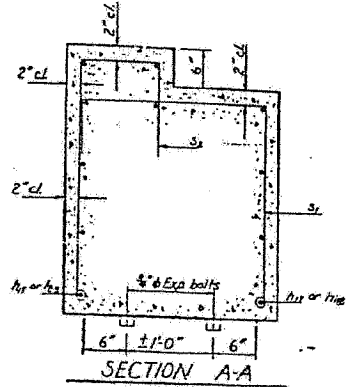
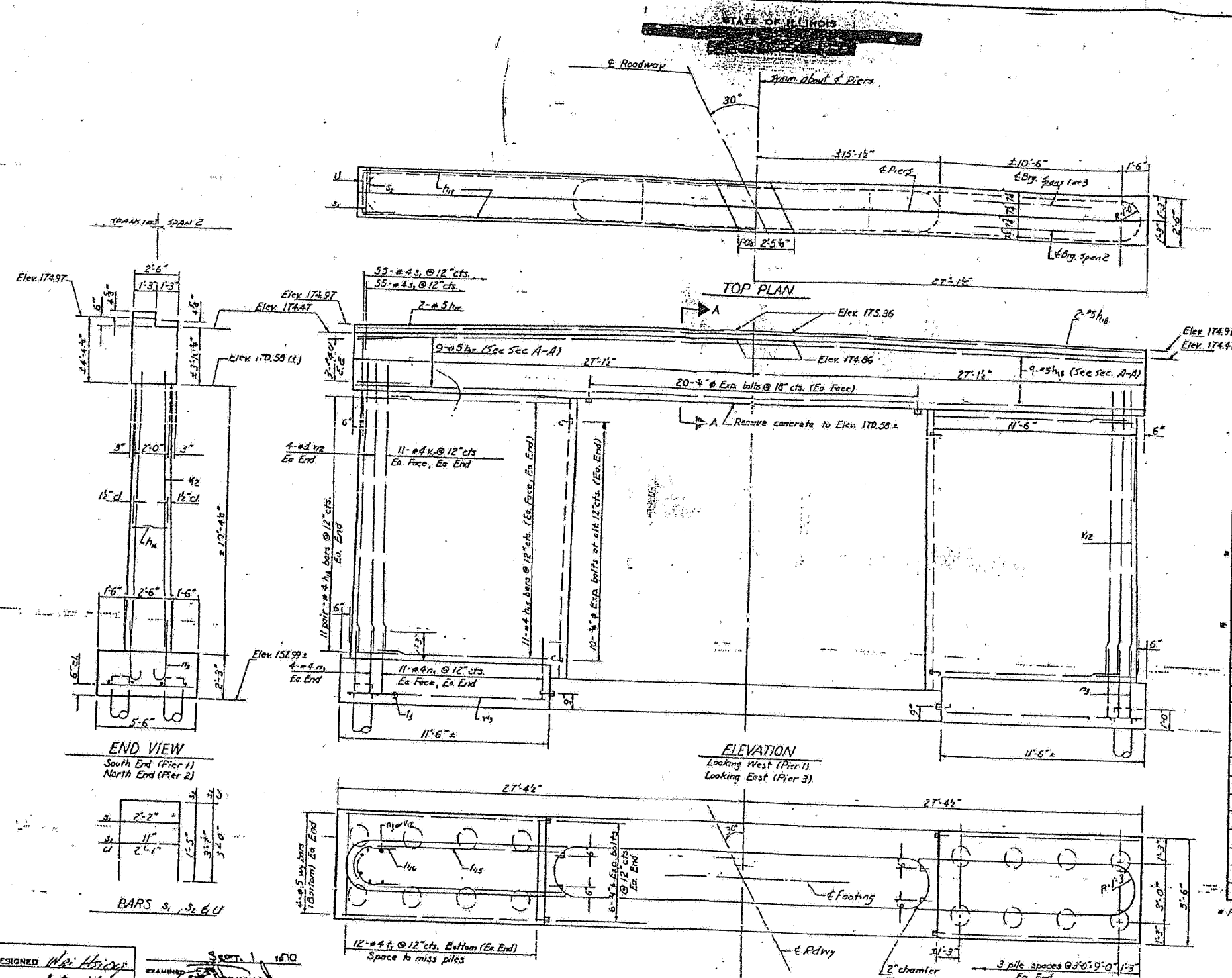

2 PIERS
BILL OF MATERIALS

Bar	No.	Size	Length	Shape
h_1	88	#4	9'-6"	—
h_2	88	#4	4'-0"	—
h_3	22	#5	20'-3"	—
h_4	22	#5	35'-0"	—
h_5	104	#4	3'-7"	—
h_6	110	#4	9'-4"	□
h_7	110	#4	3'-9"	□
h_8	48	#4	5'-3"	—
h_9	12	#4	8'-1"	□
h_{10}	104	#4	11'-9"	—
h_{11}	16	#5	11'-3"	—
Class A Concrete		Cu. Yds.	1075.22	
Reinforcement Bars		Lbs.	45200	
Creosoted Piles (up to 20')		Lin. Ft.	3334	
Expansion Bolts (4" dia)		Each	1444	
Concrete Removal		Cu. Yds.	99	

* For details of bars h_9 and h_{10} , see sheet # 9

DESIGNED *W.H. Hoyer*
 CHECKED *R.D. BAFFORD*
 DRAWN *L.B.M.*
 EXAMINED *Richard H. Galt*
 PARAPED *Richard H. Galt*

PILE DATA:
 Type, Creosoted
 Est length, 12'-0"
 No. req'd, 32

Expansion bolts that consist of self drilling expansion anchors and 4" dia. heated bolts.

PIERS 1 & 3
 F.A. RT. 119, SEC. 102 X-1
 McLEAN COUNTY
 STA: 616+99